

CANOPY CALCULATION CHART - FOXCOTTE TOTAL SITE

TREE #	TREE SPECIES	# OF TREES	SOIL VOLUME (m³) (SHARED)	CROWN AREA (m²)	CANOPY AREA (m²)
Large Stature Trees (14 m spread)					
P01	Full-Sized Deciduous Tree (to be determined)	1	15m³	154	91.5
P02	Full-Sized Deciduous Tree (to be determined)	1	15m³	154	154
P03	Full-Sized Deciduous Tree (to be determined)	1	15m³	154	35
P04	Full-Sized Deciduous Tree (to be determined)	1	15m³	154	94
P05	Full-Sized Deciduous Tree (to be determined)	1	15m³	154	154
P06	Full-Sized Deciduous Tree (to be determined)	1	15m³	154	95.5
P10	Full-Sized Deciduous Tree (to be determined)	1	15m³	154	154
P11	Full-Sized Deciduous Tree (to be determined)	1	15m³	154	145.5
P33	Full-Sized Deciduous Tree (to be determined)	1	15m³	154	154
SUBTOTAL					1077.5
Medium Stature Trees (10-13 m spread)					
P12	Medium-Sized Deciduous Tree (to be determined)	1	16m³	78.5	58.5
P13	Medium-Sized Deciduous Tree (to be determined)	1	30m³	78.5	76
P14	Medium-Sized Deciduous Tree (to be determined)	1	30m³	78.5	78.5
P15	Medium-Sized Deciduous Tree (to be determined)	1	30m³	78.5	78.5
P16	Medium-Sized Deciduous Tree (to be determined)	1	30m³	78.5	63
P17	Medium-Sized Deciduous Tree (to be determined)	1	16m³	78.5	78.5
P21	Medium-Sized Deciduous Tree (to be determined)	1	19m³	78.5	78.5
P22	Medium-Sized Deciduous Tree (to be determined)	1	16m³	78.5	36
P23	Medium-Sized Deciduous Tree (to be determined)	1	30m³	78.5	76
P24	Medium-Sized Deciduous Tree (to be determined)	1	30m³	78.5	78.5
P25	Medium-Sized Deciduous Tree (to be determined)	1	30m³	78.5	76
P26	Medium-Sized Deciduous Tree (to be determined)	1	30m³	78.5	66
P27	Medium-Sized Deciduous Tree (to be determined)	1	16m³	78.5	48
P28	Medium-Sized Deciduous Tree (to be determined)	1	15m³	78.5	78.5
SUBTOTAL					970.5
Small Stature Trees (3-9 m spread)					
P07	Small-Sized Deciduous Tree (to be determined)	1	15m³	7	0
P08	Small-Sized Deciduous Tree (to be determined)	1	15m³	7	7
P09	Small-Sized Deciduous Tree (to be determined)	1	15m³	7	1
P18	Small-Sized Deciduous Tree (to be determined)	1	19m³	7	1.5
P19	Small-Sized Deciduous Tree (to be determined)	1	19m³	7	7
P20	Small-Sized Deciduous Tree (to be determined)	1	19m³	7	7
P29	Small-Sized Deciduous Tree (to be determined)	1	15m³	7	7
P30	Small-Sized Deciduous Tree (to be determined)	1	15m³	7	7
P31	Small-Sized Deciduous Tree (to be determined)	1	15m³	7	7
P32	Small-Sized Deciduous Tree (to be determined)	1	15m³	7	0
P34	Small-Sized Deciduous Tree (to be determined)	1	15m³	7	0
P35	Small-Sized Deciduous Tree (to be determined)	1	15m³	7	6.5
P36	Small-Sized Deciduous Tree (to be determined)	1	15m³	7	7
P37	Small-Sized Deciduous Tree (to be determined)	1	15m³	7	7
P38	Small-Sized Deciduous Tree (to be determined)	1	15m³	7	7
SUBTOTAL					72
Existing Trees Overhanging Site					
E01	Thuja occidentalis	1			28
SUBTOTAL OF EXISTING OVERHANGING CANOPY					28
Total # of trees		39	Total Canopy Area (m²)		2120
CANOPY SUMMARY					
Site Area (m²)		4989			
Site Canopy Cover		42.5%			
Site Canopy Cover Target		20%			

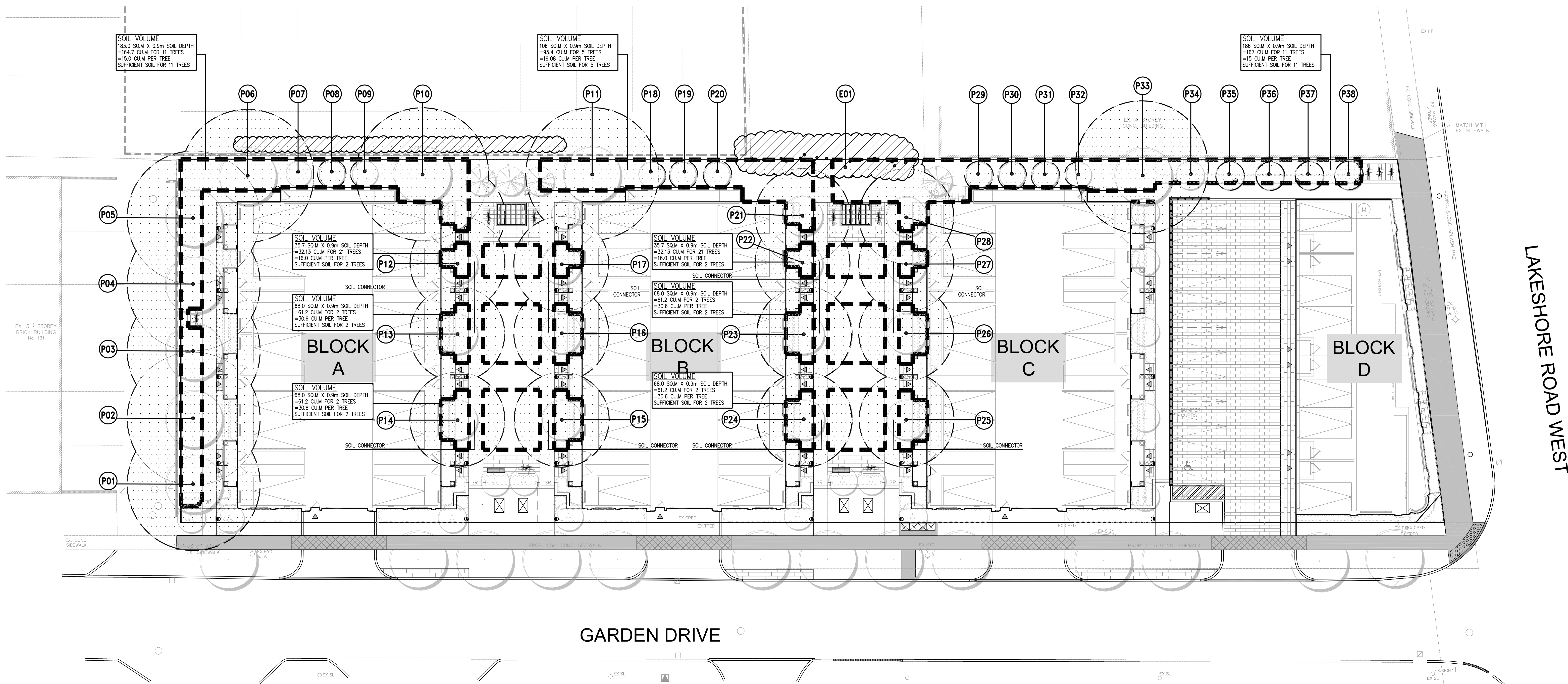

- GENERAL NOTES**
- VERIFY ALL DIMENSIONS.
 - DO NOT SCALE DRAWINGS.
 - REPORT ANY DISCREPANCIES, DISCOVERED ERRORS, OR OMISSIONS TO THE LANDSCAPE ARCHITECT BEFORE PROCEEDING.
 - IT IS ADVISED THAT CONTRACTORS CONTACT THE LANDSCAPE ARCHITECT PRIOR TO CONSTRUCTION TO ENSURE THE USE OF THE LATEST REVISED DRAWINGS.
 - DRAWINGS AND SPECIFICATIONS ARE THE PROPERTY OF THE LANDSCAPE ARCHITECT.

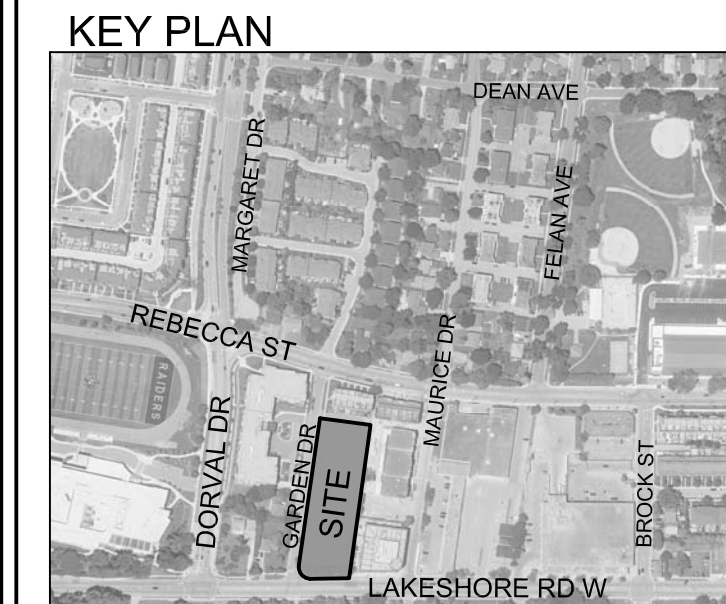

- LEGEND**
- PROPOSED DECIDUOUS TREE
 - PROPOSED CONIFEROUS TREE
 - PROPOSED SHRUBS
 - PROPOSED HEDGE
 - PROPOSED DECIDUOUS TREE
 - OAKVILLE CANOPY COVER LIMIT
 - AREA OF SOIL VOLUME

No.	DATE	REVISION	BY
2	JULY 3/6, 2024	ISSUED FOR SUBMISSION	BB
1	MAY 24, 2024	ISSUED FOR COORDINATION	BB

It is the responsibility of the Contractor and/or Owner to ensure that the drawings with the latest revisions are used for construction.

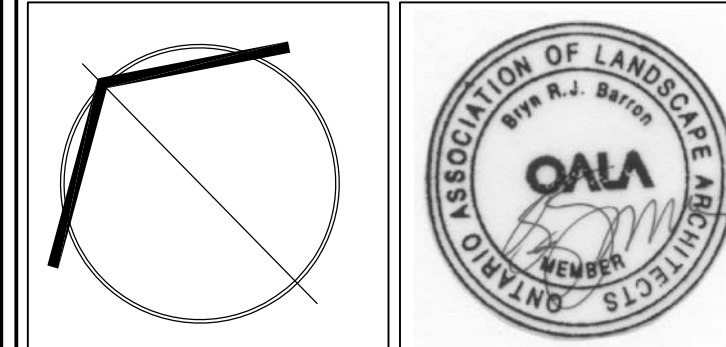

SBK 5770 HURONTARIO STREET, SUITE 320
 MISSISSAUGA, ONTARIO, L4R 3G5
 T: 416.695.4949 F: 905.712.3101
 WWW.STRYBOS.COM

STRYBOS BARRON KING
 LANDSCAPE ARCHITECTURE

PROJECT: **PROPOSED MIXED USE DEVELOPMENT**
 PLAZACORP
 109 GARDEN DRIVE
 OAKVILLE, ONTARIO

DRAWING TITLE: **CANOPY COVER PLAN**

SCALE:	PROJECT No.
DATE: MAY 23, 2024	24-6010
DRAWN BY: T.S.	DRAWING No.
CHECKED BY: B.B.	LC101