

- GENERAL NOTES**
1. BASE SURVEY PLAN PREPARED WITH THE FOLLOWING DRAWINGS:
 - 1.1 SURVEY DRAWING 17-30-168-02-A DATED MAY 7, 2021 COMPLETED BY J.D. BARNES LTD.
 2. ALL TRAFFIC CONTROL, SIGNAGE AND PAVEMENT MARKINGS SHALL CONFORM TO THE ONTARIO TRAFFIC MANUAL, BOOK 5 REGULATORY SIGNS, BOOK 6 WARNING SIGNS, BOOK 7 TEMPORARY CONDITIONS, BOOK 11 PAVEMENT, HAZARD AND DELINEATION MARKINGS AND BOOK 12 TRAFFIC SIGNALS.
 3. THE LOCATION AND EXTENT OF ALL EXISTING UTILITIES SHOWN ON THE PLAN ARE CONSIDERED APPROXIMATE ONLY. PRIOR TO CONSTRUCTION THE CONTRACTOR SHALL CONFIRM THE LOCATION OF UTILITIES AND BE RESPONSIBLE FOR ADEQUATE PROTECTION FROM DAMAGE DURING CONSTRUCTION.
 4. ALL WORK TO CONFORM TO THE APPLICABLE MUNICIPALITIES STANDARDS, ONTARIO PROVINCIAL STANDARDS AND SPECIFICATIONS AND ALL OTHER RELEVANT CODES, STANDARDS, GUIDELINES, ETC.
 5. ALL WORK TO BE CARRIED OUT IN COMPLIANCE WITH THE OCCUPATIONAL HEALTH AND SAFETY ACT AND THE MINISTRY OF TRANSPORTATION ROADSIDE SAFETY MANUAL.
 6. CONTRACTOR IS RESPONSIBLE FOR PROVIDING A PROTECTIVE BARRIER AROUND THE PERIMETER OF SITE TO PREVENT VEHICLES FROM ENTERING THE OPEN EXCAVATION. DESIGN OF BARRIER TO BE BY OTHER AND CAN BE REMOVED ONCE STRUCTURE REACHES GRADE LEVEL.
 7. TRAFFIC PARKING CONTROL SIGNAGE AND SUPPORTS SHALL BE LOCATED SO AS NOT TO ENCRUSH INTO ANY ADJACENT LANE AND PROVIDE A MINIMUM HEIGHT CLEARANCE OF 4.0m.
 8. EXISTING DRAINAGE PATTERNS TO BE MAINTAINED.
 9. NOISE LEVELS SHALL BE KEPT IN ACCORDANCE WITH THE APPLICABLE MUNICIPALITIES BY LAWS AND REGULATIONS.
 10. PEDESTRIAN WALKWAY TO BE KEPT CLEAR OF OBSTRUCTIONS AT ALL TIMES.
 11. CONSTRUCTION ZONE TO HAVE SUPPLEMENTARY REPLACEMENT STREET & PEDESTRIAN LIGHTING. (REQUIREMENTS TO BE DETERMINED BY THE CITY OF TORONTO.)
 12. CONTRACTOR IS RESPONSIBLE FOR OBTAINING ALL NECESSARY PERMITS REQUIRED FOR WORKING ON-SITE AND WITHIN THE PUBLIC RIGHT OF WAY.
 13. CONTRACTOR IS RESPONSIBLE FOR THE LAYOUT OF ALL WORKS.
 14. ALL DISCREPANCIES BETWEEN THE DRAWINGS AND FIELD LAYOUT SHALL BE REPORTED TO THE SITE SUPERVISOR AND OWNER BEFORE FURTHER ACTION IS TAKEN.
 15. ALL TRAFFIC SIGNALS & POLES, TRAFFIC CONTROLLERS, LIGHT STANDARDS, UTILITY POLES, SIGN POSTS, STREET FURNITURE, PIPE BARRIERS, TRAFFIC PARKING CONTROL SIGNAGE, REMOVAL, RELOCATION/REPLACEMENT SHALL BE BY THE APPLICABLE MUNICIPALITY OR APPROPRIATE UTILITY COMPANY/TRANSPORTATION AUTHORITY.
 16. CONTRACTOR IS RESPONSIBLE FOR THE INSTALLATION, MAINTENANCE AND REMOVAL OF ALL TEMPORARY SIGNAGE.
 17. NO EXISTING PERMITTED OF EXISTING PAVEMENT MARKINGS IF NEW PAVEMENT MARKINGS ARE BEING PLACED AS PART OF THIS PLAN. ONLY WATERSCODING AND BLASTING METHODS ARE PERMITTED FOR REMOVAL OF EXISTING PAVEMENT MARKINGS OR AS DIRECTED BY THE MUNICIPALITY.
 18. TC-54 FLEXIBLE DRUM (BARRELS) ARE ONLY TO BE REMOVED DURING CONSTRUCTION VEHICLE MANOEUVREING.
 19. ALL PROPOSED TRAFFIC CONTROL SIGNAGE TO BE MOUNTED ON EXISTING POLES WITH A SUITABLE BRACKET IF POSSIBLE.
 20. DURING AFTER HOURS, THE CONTRACTOR SHALL ENSURE ALL ACCESS GATES ARE CLOSED & LOCKED AND THAT ALL BUILDING MATERIAL/EQUIPMENT IS STORED WITHIN THE CONSTRUCTION AREA.
 21. FOLLOWING THE COMPLETION OF THE PROJECT, THE AREA WITHIN THE PUBLIC RIGHT OF WAY SHALL BE RESTORED TO EXISTING CONDITIONS OR BETTER.
 22. A PROTECTIVE BARRIER SHALL BE INSTALLED ALONG THE EDGE OF EXCAVATION ONCE EXCAVATION PROCEEDS BELOW GRADE LEVEL. THE BARRIER MAY BE REMOVED ONLY ONCE THE FUTURE STRUCTURE REACHES GRADE LEVEL. BARRIER DESIGN TO BE BY OTHERS.
 23. CROSS SECTION ITEMS, INCLUDING BUT NOT LIMITED TO, COVERED WALKWAY ARE FOR ILLUSTRATIVE PURPOSES ONLY. DETAILED DESIGN OF THESE ITEMS TO BE DESIGNED BY OTHERS.
 24. TRAFALGAR ROAD DESIGN CROSS SECTIONS IN FRONT OF DISTRICT SHOWING THE MUP AND SIDEWALK ATTACHED (3064 TRAFALGAR ROAD) PROPERTY STATUS JUST AFTER STA 1+400.0; ALTERNATE DISTRICT NEEDS TO HAVE THIS BUILT OUT WHEN REGION OPENS UP THE REST OF MUP / SIDEWALK ON TRAFALGAR. ALTERNATE PROVIDE DETAILS ON HOW THEY WILL BE MERGING PEDESTRIANS WITH CYCLISTS ONTO THE MUP WHILE THEY USE THE PROPOSED SIDEWALK AREA AS SLIP-ON AND SLIP-OFF.

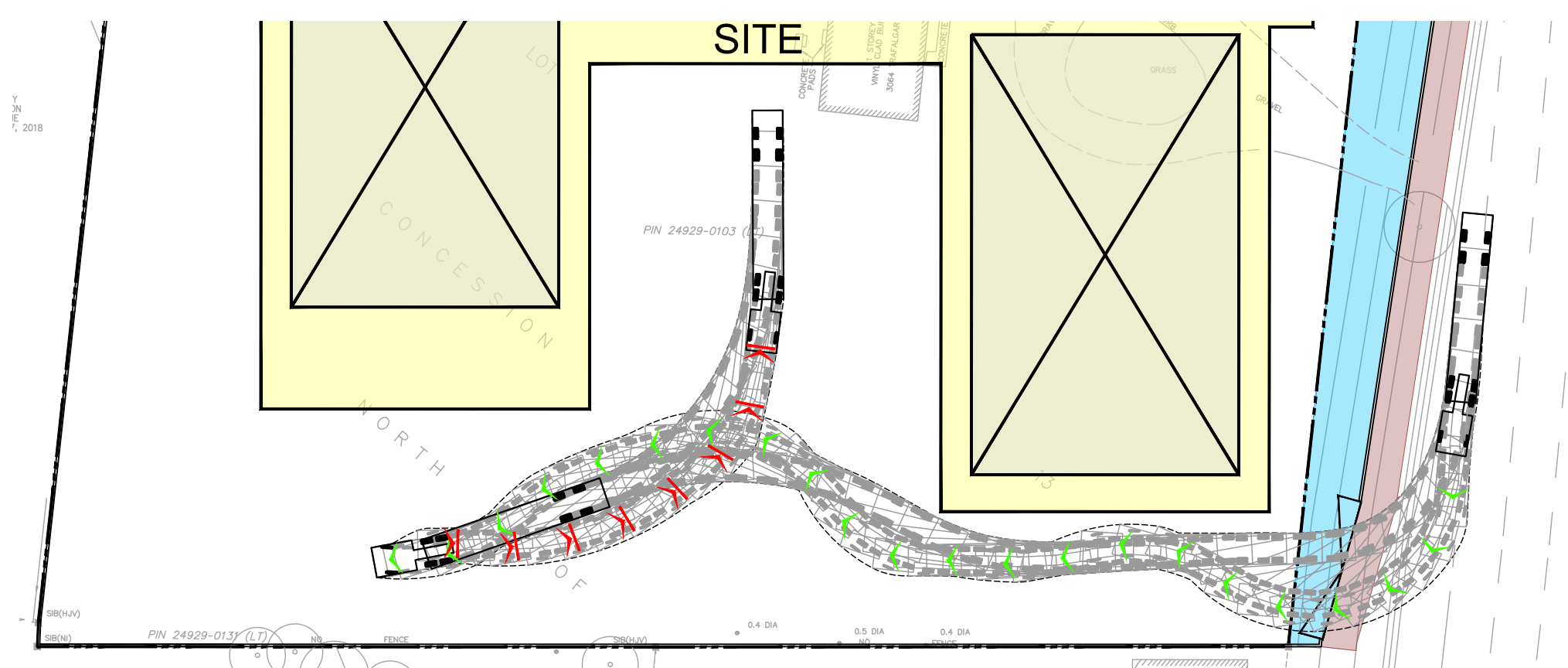
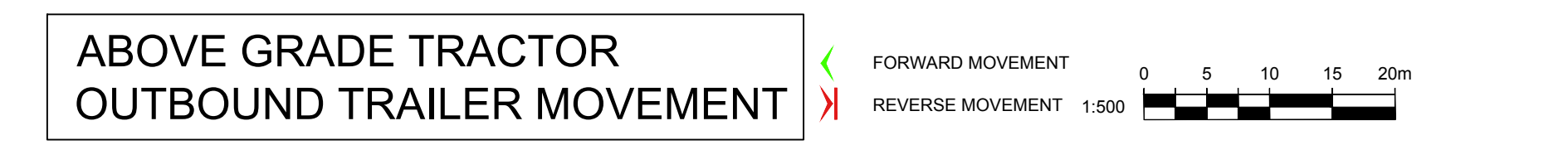
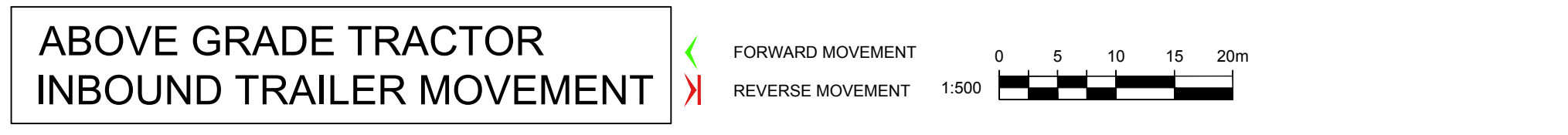

LEGEND

- CONSTRUCTION STAGING AREA
- COVERED PEDESTRIAN WALKWAY
- ITEM REMOVAL / RELOCATION
- Jersey Barrier (as per OPD 911.140)
- Jersey Barrier (as per OPD 911.140) WITH HOARDING WALL
- ENERGY ATTENUATOR (AS PER OPD 923.302)
- TRAFFIC CONTROL PERSON
- CONSTRUCTION EQUIPMENT/ MACHINERY
- CRANE SWING
- EXISTING SIGNAL
- CONSTRUCTION FAST FENCE (OR EQUIVALENT)
- PEDESTRIAN DETOUR ROUTE

↑ EXISTING LANE CONDITION
 ↓ PROPOSED LANE CONDITION
 ✗ REMOVAL

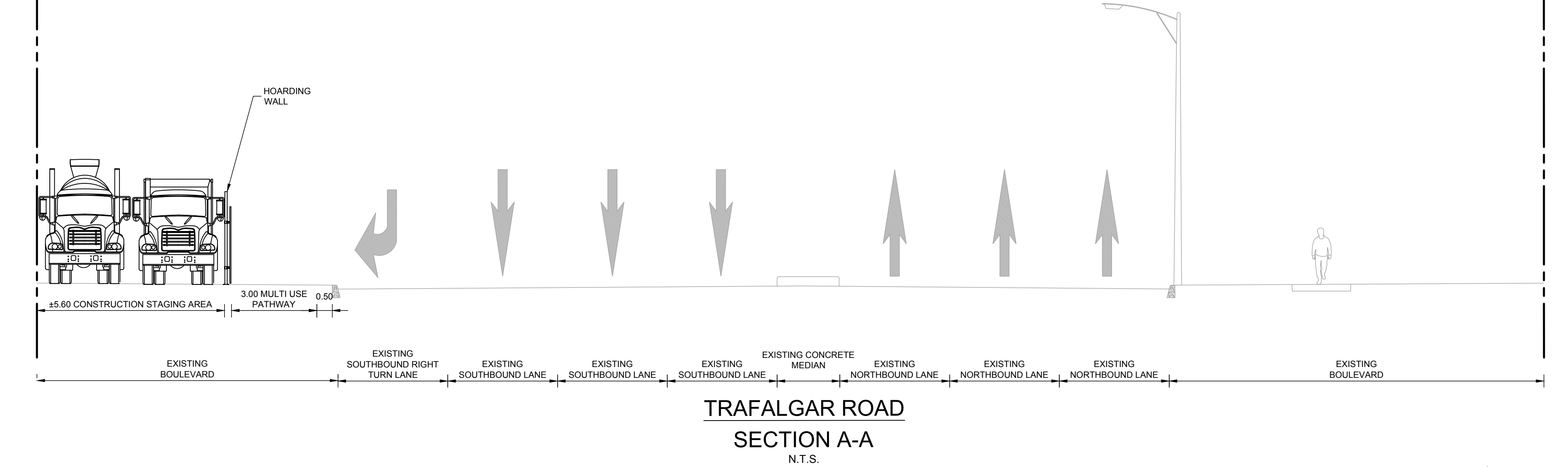
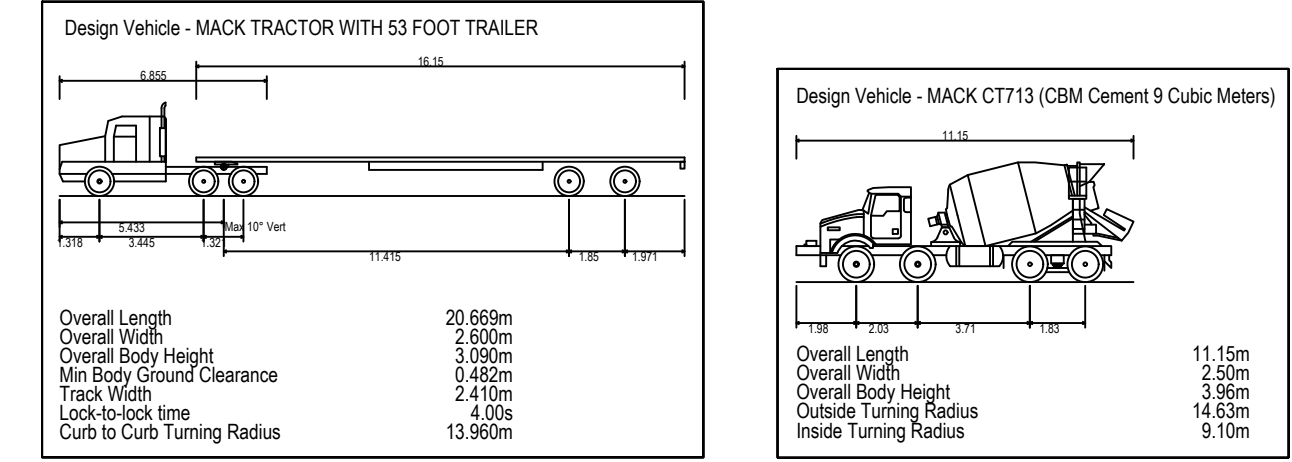

04-12-19-23	DAP	ISSUED TO CLIENT FOR CITY SUBMISSION
03-01-20-23	DAP	ISSUED TO CLIENT FOR CITY SUBMISSION
02-12-16-22	DAP	ISSUED TO CLIENT FOR CITY SUBMISSION
01-10-20-22	DAP	ISSUED TO CLIENT FOR PRELIMINARY REVIEW
10-07-22	DAP	ISSUED TO CLIENT FOR PRELIMINARY REVIEW
00-MM-00-YR	INT	REVISION NOTE

THIS TRAFFIC MANAGEMENT DURING CONSTRUCTION (TMDC) PLAN RECOMMENDS MITIGATION MEASURES WITH RESPECT TO VEHICULAR, BICYCLE AND PEDESTRIAN TRAFFIC (WHERE APPLICABLE) WITHIN THE PUBLIC RIGHT-OF-WAY(S) ADJACENT TO THE SITE. THIS PLAN IS INTENDED SOLELY TO SUPPORT THE PERMIT APPLICATION FOR RIGHT-OF-WAY OCCUPANCY. CONSTRUCTION LOGISTICS AND CONSTRUCTION MANAGEMENT ARE NOT ADDRESSED ON THIS PLAN.

BA Group

3064 Trafalgar Road
Toronto, ON M6R 1S9
Tel: 416 961 7100
www.baingroup.com

3064 TRAFALGAR ROAD

TRAFFIC MANAGEMENT DURING CONSTRUCTION PLAN

Date: OCTOBER 07, 2022
Project No.: 6849-21
Scale: 1:250