

ISSUED FOR SPA  
 2024-07-11  
 ISSUED FOR SPA  
 2024-09-30  
 ISSUED FOR SPA SUBMISSION #3  
 2024-12-19  
 ISSUED FOR SPA SUBMISSION #4

300 Colwell Street East, London, Ontario, N6A 1V7

RON KOUZES  
 LANDSCAPE ARCHITECTS

LANDSCAPE PLAN

SCALE = 1:400

KEY	COMMON NAME	BOTANICAL NAME	QTY	SIZE	COND
Am	MULTI-STEM SERVICEBERRY	<i>Amelanchier canadensis</i> multi-stem	3	150cm	POT
Ar	RED MAPLE	<i>Acer rubrum</i> 'Sunset'	1	60mcal	UB
As	SUGAR MAPLE	<i>Acer saccharum</i>	6	60mcal	UB
Bu	GREEN GEM BOXWOOD	<i>Buxus microphylla</i> 'Green Gem'	12	30cm	POT
Cc	MULTI-STEM REDBUD	<i>Cercis canadensis</i> multi-stem	2	750cm	UB
Ccl	SINGLE-STEM FOREST PANSY REDBUD	<i>Cercis canadensis</i> single-stem Forest Pansy'	6	45mcal	UB
Cd	HACKBERRY TREE	<i>Celtis occidentalis</i>	5	60mcal	UB
Dl	PARSONS M DAYLILY	<i>Hemerocallis</i> 'Parson M'	146	2yflgal	POT
Gb	MAIDEN HAIR TREE	<i>Ginkgo biloba</i>	6	60mcal	UB
Ge	BALLERINA GERANIUM	<i>Geranium chersum</i> 'Ballerina'	31	2yflgal	POT
Gt	SHADEMASTER LOCUST	<i>Gladiolus iracundus</i> 'Shademaster'	10	60mcal	UB
Hb	BOBO HYDRANGEA	<i>Hydrangea</i> 'LUBOVO'	36	2yflgal	POT
Jh	PRINCE OF WALES JANIPER	<i>Juniperus horizontalis</i> 'Prince of Wales'	129	60cm	POT
Kt	KARL FOERSTER REED GRASS	<i>Calamagrostis acutifolia</i> 'Karl Foerster'	131	2yflgal	POT
Lt	TULIP TREE	<i>Liriodendron tulipifera</i>	2	60mcal	UB
Pi	WHITE SPRUCE	<i>Picea glauca</i>	6	150cm	UB
Qr	RED OAK	<i>Quercus rubra</i>	4	60mcal	UB
Sb	SNOWGLOBE SPIREA	<i>Spiraea bushida</i> 'Snowglobe'	26	60cm	POT
Td	DWARF JAPANESE YEW	<i>Taxus cuspidata</i> 'Nana'	28	60cm	POT
Ue	FINE LINE LEGELA	<i>Weigela florida</i> 'Bravelli'	80	60cm	POT

LANDSCAPE PLAN

SCALE = 1:200

KEY	COMMON NAME	BOTANICAL NAME	QTY	SIZE	COND
Am	MULTI-STEM SERVICEBERRY	<i>Amelanchier canadensis</i> multi-stem	1	150cm	POT
Ccl	SINGLE-STEM FOREST PANSY REDBUD	<i>Cercis canadensis</i> Forest Pansy'	4	40mcal	UB
Dl	SPICE DAYLILY	<i>Hemerocallis</i> 'Spice'	26	2yflgal	POT
Ge	ROZANNE GERANIUM	<i>Geranium</i> 'Rozanne'	24	2yflgal	POT
Hb	ANNABELLE HYDRANGEA	<i>Hydrangea arborescens</i> 'Annabelle'	28	2yflgal	POT
Hd	BIG DADDY HOSTA	<i>Hosta</i> 'Big Daddy'	14	2yflgal	POT
Jh	BUFFALO JUNIPER	<i>Juniperus sibirica</i> 'Buffalo'	8	60cm	POT
Kt	KARL FOERSTER REED GRASS	<i>Calamagrostis acutifolia</i> 'Karl Foerster'	50	2yflgal	POT
Pi	WHITE SPRUCE	<i>Picea glauca</i>	3	150cm	UB
Pv	RUSSIAN SAGE	<i>Perovskia atropurpurea</i>	48	2yflgal	POT
Ru	BLACK EYED SUSAN	<i>Rudbeckia fulgida</i> 'Goldsturm'	56	2yflgal	POT
Si	CUTLEAF STEPHANANDRA	<i>Stephanandra incisa</i> 'Crispa'	26	30cm	POT
Tm	DENSE YEW	<i>Taxus media</i> 'Densiformis'	2	60cm	POT

Schlegel Village - Oakville

2150 WILLIAM HALTON PARKWAY W. OAKVILLE ONTARIO

Schlegel Village

Project No.: 22-2372

Drawn By: MCB

Plot Date: 2024-12-18

LANDSCAPE PLAN

L-1



388 Oxford Street East, London, Ontario, N6A 1Y7  
 519-837-1111  
 ISSUED FOR SPA  
 2024-07-11  
 REVISED FOR SPA  
 2024-09-30  
 ISSUED FOR SPA SUBMISSION #3  
 2024-12-19  
 ISSUED FOR SPA SUBMISSION #4

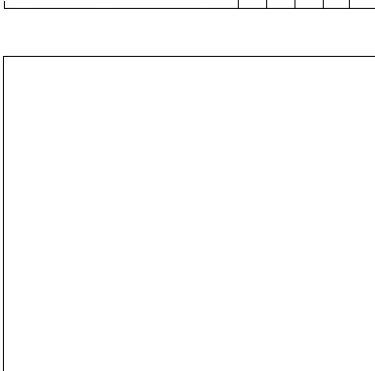

**Schlegel Village - Oakville**  
 2150 WILLIAM HALTON PARKWAY W. OAKVILLE ONTARIO  
 Schlegel Village  
 Project No.: 22-2372  
 Drawn By: MCB  
 Plot Date: 2024-12-18  
**STREETSCAPE LANDSCAPE PLAN**

L-2

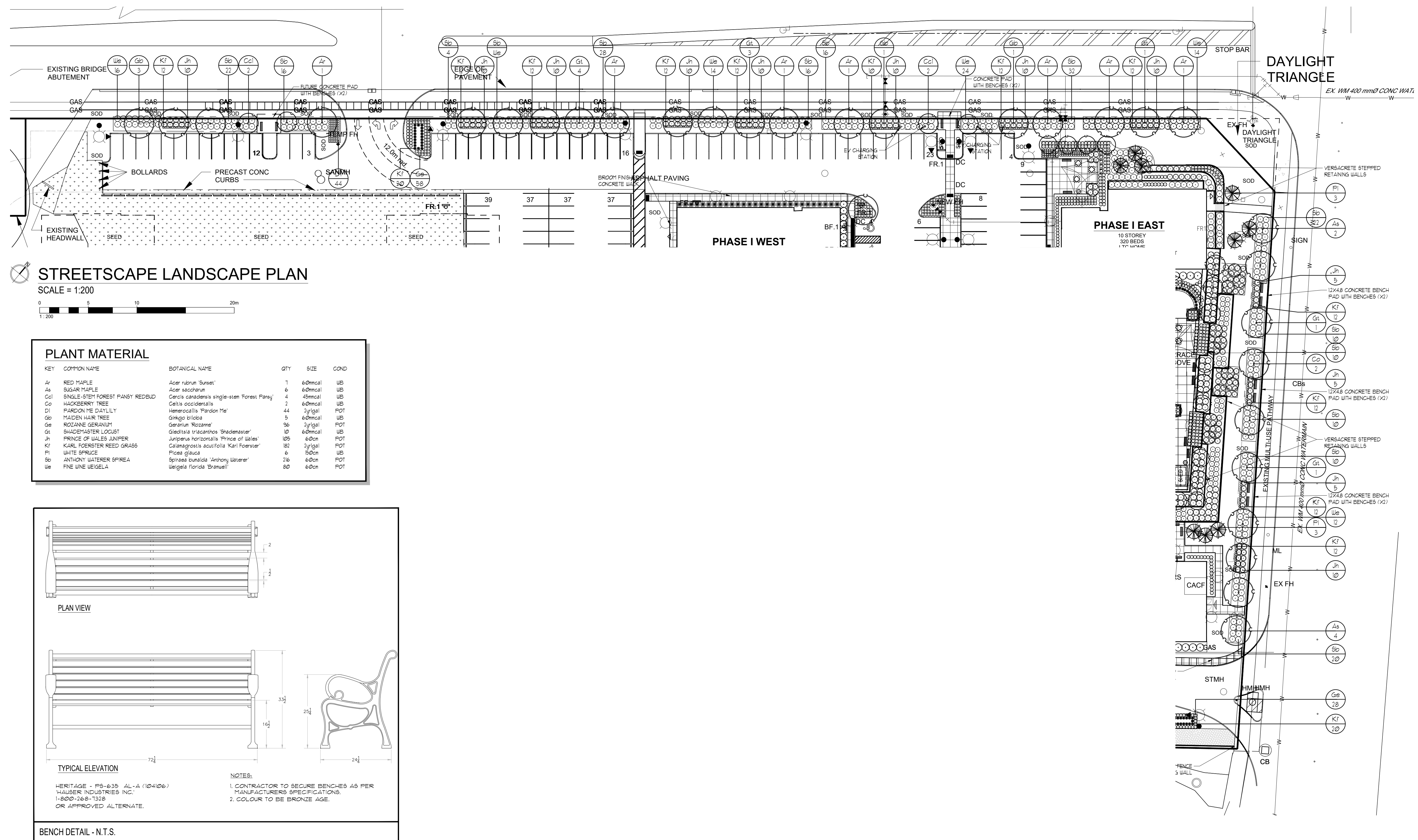

**PLANT MATERIAL**

KEY	COMMON NAME	BOTANICAL NAME	QTY	SIZE	COND
Ar	RED MAPLE	Acer rubrum 'Sunset'	1	60mcal	UB
As	SUGAR MAPLE	Acer saccharum	6	60mcal	UB
Ccl	SINGLE-STEM FOREST FANST REDBUD	Cercis canadensis single-stem Forest Fanst	4	45mcal	UB
Co	HACKBERRY TREE	Celtis occidentalis	2	60mcal	UB
D1	PARSON ME DAILYLY	Hemerocallis 'Parson Me'	44	2.7gal	POT
Gb	MAIDEN HAIR TREE	Ginkgo biloba	5	60mcal	UB
Ge	ROZANNE GERANIUM	Geranium 'Rozanne'	36	2.7gal	POT
G1	SHADEMASTER LOGIST	Gleditsia triacanthos 'Shademaster'	10	60mcal	UB
Jh	PRINCE OF WALES JUNIFER	Juniperus horizontalis 'Prince of Wales'	105	60cm	POT
Kf	KARL FOERSTER REED GRASS	Calamagrostis acutifolia Karl Foerster	182	2.7gal	POT
Pi	WHITE SPRUCE	Picea glauca	6	150cm	UB
Sc	ANTHONY WATERER SPIREA	Spiraea bushida 'Anthony Waterer'	26	60cm	POT
We	FINE LINE WEIGELA	Weigela florida 'Branwell'	80	60cm	POT

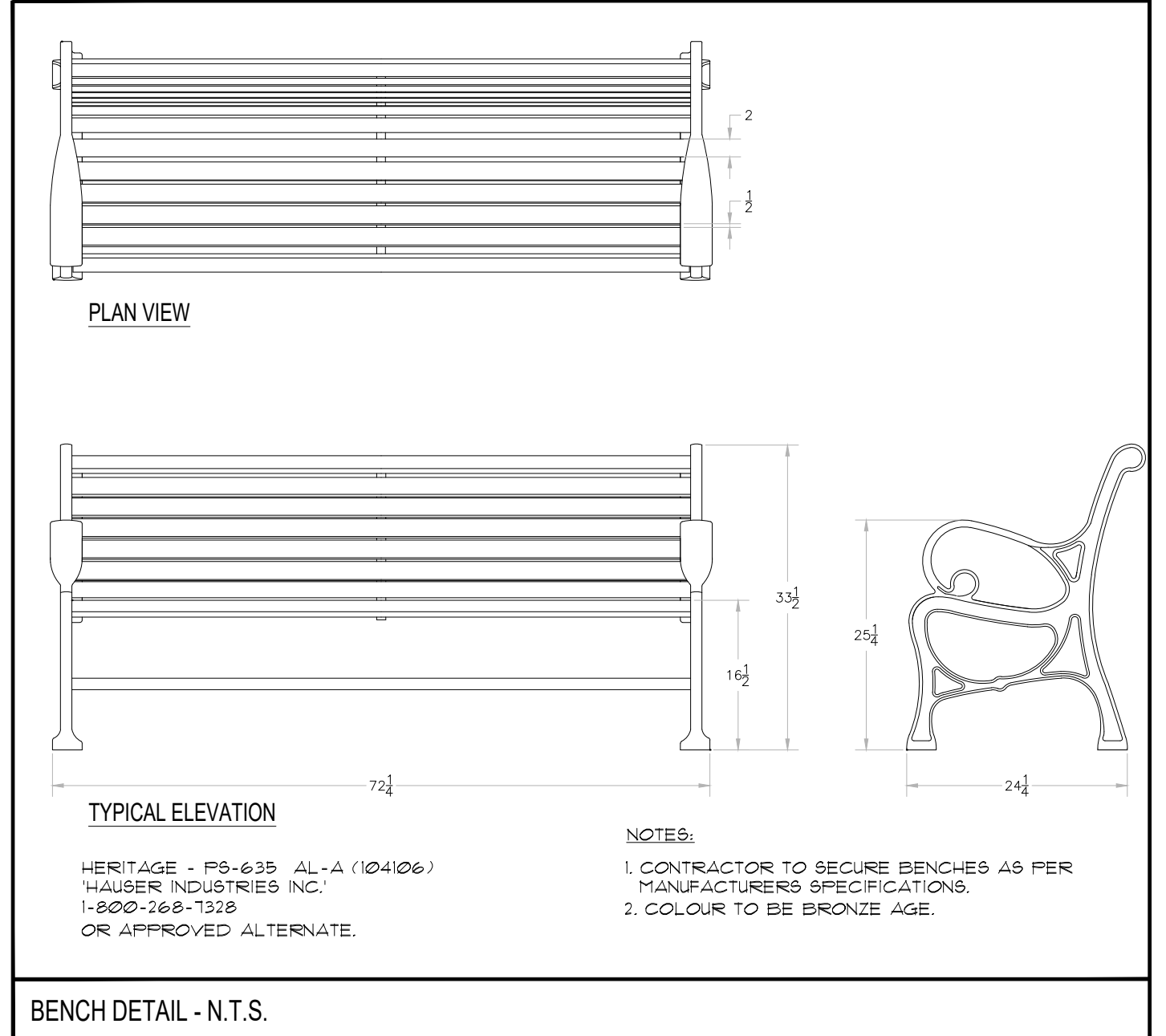

C:\Users\Aman\OneDrive\Desktop\Temp\Aman\Aman\_20171225\_2371\_L2.dwg, 2024 Dec 18, 01:10 pm

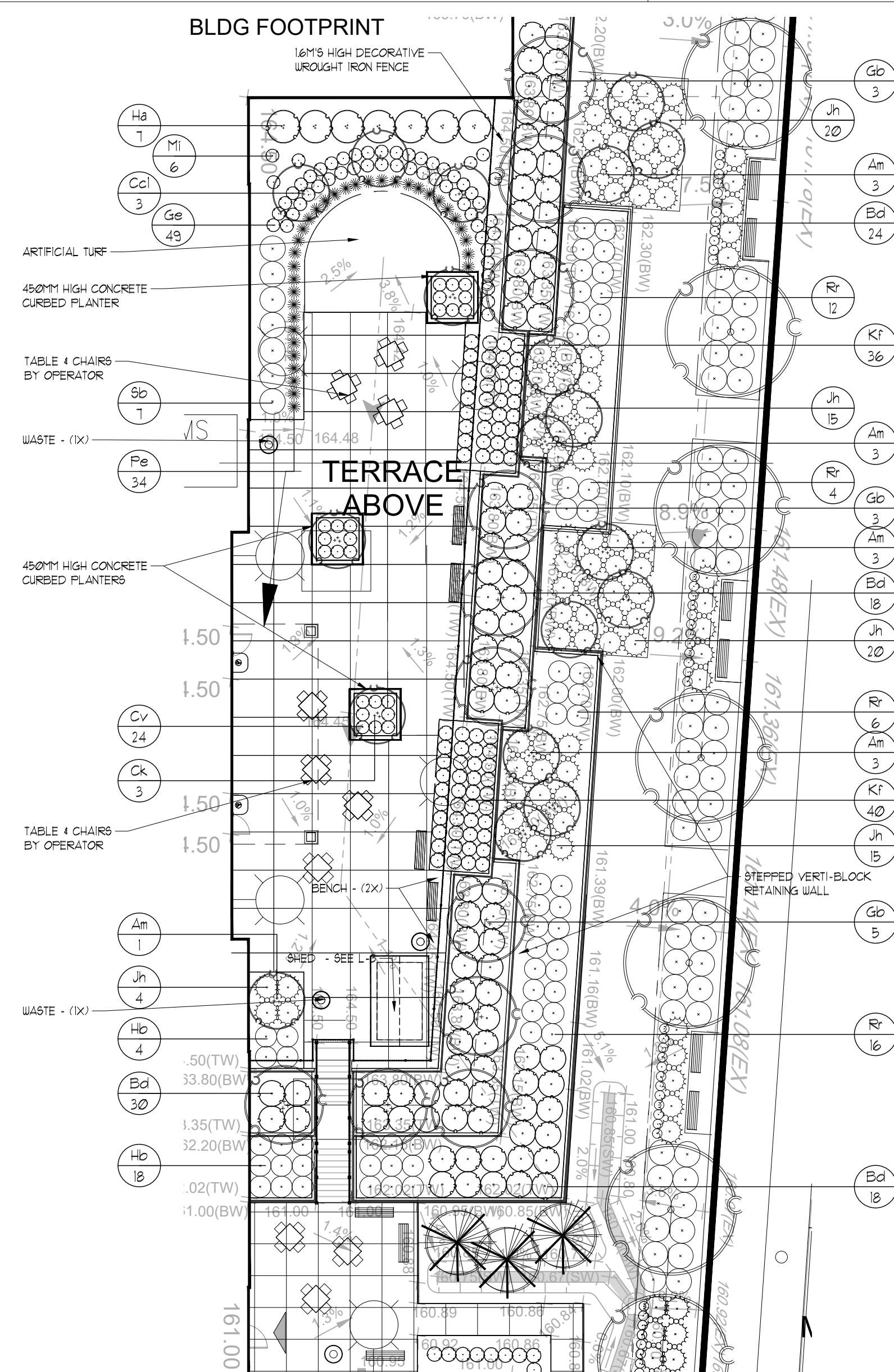

**COURTYARD 'A' LANDSCAPE PLAN**

SCALE = 1:200

KEY	COMMON NAME	BOTANICAL NAME	QTY	SIZE	COND
Am	MULTI-STEM SERVICEBERRY	<i>Amaranthus canadensis</i> multi-stem	13	250cm	UB
Bd	BUTTERFLY BUSH	<i>Buddleia</i>	30	2' gal	POT
Ccl	SINGLE-STEM FOREST PANSY REDBUD	<i>Cercis canadensis</i> Forest Pansy	3	40cm cal	UB
Ck	CHINESE FLOWERING DOOGWOOD	<i>Cornus kousa</i> var. <i>otensis</i>	3	50cm	POT
Cv	PURPLE CONE FLOWER	<i>Echinacea purpurea</i>	24	2' gal	POT
Ge	MAIDEN HAIR TREE	<i>Ginkgo biloba</i>	1	60cm cal	UB
Gp	BALLERINA GERANIUM	<i>Geranium 'Ballerina'</i>	48	2' gal	POT
Hb	ANNABELLE HYDRANGEA	<i>Hydrangea arborescens</i> 'Annabelle'	1	2' gal	POT
Hd	BOBO HYDRANGEA	<i>Hydrangea 'LEVO'</i>	22	2' gal	POT
Jh	BUFFALO JUNIPER	<i>Juniperus sibirica</i> 'Buffalo'	74	60cm	POT
Kf	KARL FOERSTER REED GRASS	<i>Calamagrostis acutiflora</i> 'Karl Foerster'	16	2' gal	POT
Mi	HARON SUNRISE MAIDEN GRASS	<i>Miscanthus sinensis</i> 'Haron Sunrise'	34	2' gal	POT
Rf	LITTLE BUNNY FOUNTAIN GRASS	<i>Pennisetum alopecuroides</i> 'Little Bunny'	16	2' gal	POT
Rr	THE FAIRY SHRUB ROSE	<i>Rosa rugosa</i> 'The Fairy'	38	60cm	POT
Sb	ANTHONY WATERER SPIREA	<i>Spiraea bushida</i> 'Anthony Waterer'	1	60cm	POT

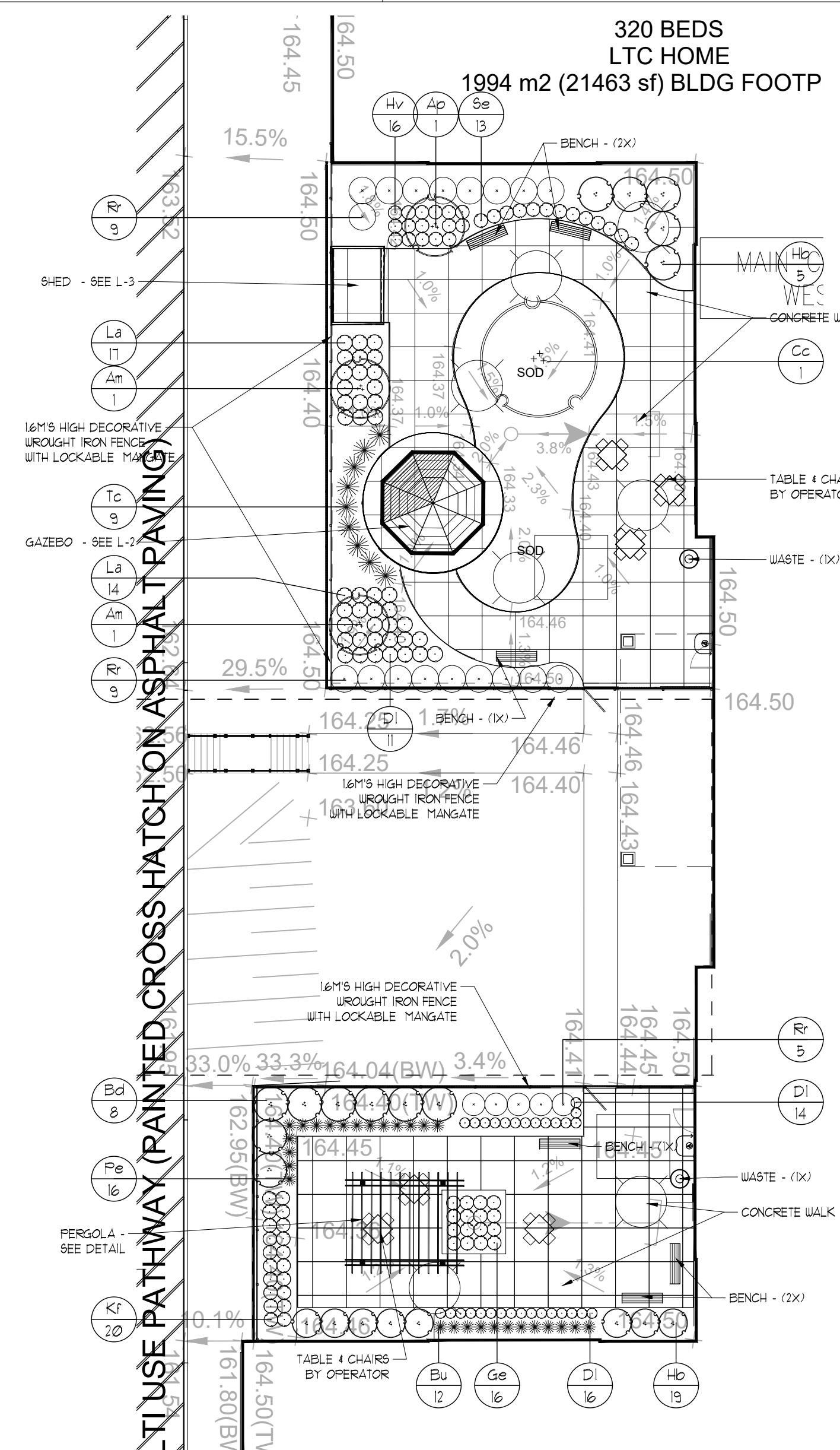

**COURTYARDS 'B' & 'C' LANDSCAPE PLAN**

SCALE = 1:200

KEY	COMMON NAME	BOTANICAL NAME	QTY	SIZE	COND
Am	MULTI-STEM SERVICEBERRY	<i>Amaranthus canadensis</i> multi-stem	2	200cm	UB
Bd	BLOODGOOD JAPANESE MAPLE	<i>Acer palmatum</i> 'Bloodgood'	1	50cm	UB
Bd	BUTTERFLY BUSH	<i>Buddleia</i>	8	2' gal	POT
Bu	GREEN MOUNTAIN BLOODGOOD	<i>Buddleia</i> 'Green Mountain'	12	30cm	POT
Cc	SINGLE-STEM FOREST PANSY REDBUD	<i>Cercis canadensis</i> Forest Pansy	1	40cm cal	UB
Di	SPICE DAYLILY	<i>Hemerocallis 'Spice'</i>	41	2' gal	POT
Ge	BALLERINA GERANIUM	<i>Geranium 'Ballerina'</i>	16	2' gal	POT
Hb	BOBO HYDRANGEA	<i>Hydrangea 'LEVO'</i>	24	2' gal	POT
Hv	VARIEGATED HOSTA	<i>Hosta undulata</i> 'Variegata'	16	2' gal	POT
Kf	KARL FOERSTER REED GRASS	<i>Calamagrostis acutiflora</i> 'Karl Foerster'	20	2' gal	POT
La	HIDCOTE LAVENDER	<i>Lavandula angustifolia</i> 'Hidcote'	31	2' gal	POT
Re	LITTLE BUNNY FOUNTAIN GRASS	<i>Pennisetum alopecuroides</i> 'Little Bunny'	16	2' gal	POT
Rr	THE FAIRY SHRUB ROSE	<i>Rosa rugosa</i> 'The Fairy'	21	60cm	POT
Se	AUTUMN JOY SEDUM	<i>Sedum spectabile</i> 'Autumn Joy'	13	2' gal	POT
Tc	DWARF JAPANESE YEW	<i>Taxus cuspidata</i> 'Nana'	9	3gal.	POT

**GENERAL PLANTING SPECIFICATIONS**

- BASE INFORMATION SUPPLIED BY CORNERSTONE ARCHITECTURE.
- CONTRACTOR TO MAKE THEMSELVES FAMILIAR WITH ALL RELATED SPECIFICATIONS.
- CONTRACTORS ARE RESPONSIBLE FOR REVIEW OF ALL SPECIFICATIONS AND RELATED DRAWINGS WITH SELECTED SUB-CONTRACTORS AND FOR THE REVIEW OF ALL ARCHITECTURAL WORKING DRAWINGS AND SPECIFICATIONS.
- REPORT ALL DISCREPANCIES TO THE LANDSCAPE ARCHITECT DURING TENDERING PROCESS. ERRORS AND/OR OMISSIONS WILL BE THE RESPONSIBILITY OF THE CONTRACTOR.
- CONTRACTOR SHALL MAINTAIN ALL LANDSCAPED AREAS UNTIL OWNER ACCEPTANCE OF PROJECT. CONTRACTOR TO NOTIFY LANDSCAPE ARCHITECT IN WRITING ON COMPLETION OF PROJECT FOR A SITE WORK COMPLETION CERTIFICATE AS WELL AS THE COMPLETION OF THE ACCEPTANCE OF PROJECT.
- ALL WORKMANSHIP TO BE WARRANTED FOR TWO YEARS UNLESS OTHERWISE STATED. WARRANTY PERIOD WILL BEGIN ON FINAL ACCEPTANCE OF PROJECT.
- ALL WORKMANSHIP TO THE STANDARDS OF THE ONTARIO LANDSCAPE ASSOCIATION AND THE LANDSCAPE ONTARIO SPECIFICATION STANDARDS.
- ALL NURSERY STOCK TO BE "NURSERY GROWN AND MUST COMPLY WITH GUIDE SPECIFICATION FOR NURSERY STOCK OF THE CANADIAN NURSERY TRADES ASSOCIATION.
- ALL LANDSCAPING IS TO BE INSTALLED PRIOR TO THE END OF THE FIRST GROWING SEASON FOLLOWING THE OCCUPANCY OF THE SITE DEVELOPMENT UNLESS OTHERWISE STATED.
- CONTRACTOR IS RESPONSIBLE FOR ALL UNDERGROUND UTILITIES AND MUST NOTIFY THE LANDSCAPE ARCHITECT WITH COPIES OF LOCATE CERTIFICATES PRIOR TO COMMENCEMENT OF WORK.

**GRADING**

- CONTRACTOR TO ENSURE POSITIVE DRAINAGE IN ALL AREAS.
- ALL GRADING TO BE IN ACCORDANCE WITH SITE ENGINEERS DRAWINGS.
- SOIL SHALL BE SCARIFIED FREE OF ALL STONES, ROOTS, BRANCHES LARGER THAN 1" (25MM) AND COMPACTED TO 98% SPD.
- ALL SUBSOIL TO BE SCARIFIED TO A DEPTH OF 6" (150MM) PRIOR TO THE INSTALLATION OF TOPSOIL TO ENSURE NO HARDPAN CONDITIONS.
- CONTRACTOR TO NOTIFY LANDSCAPE ARCHITECT PRIOR TO INSTALLATION OF TOPSOIL TO APPROVE SUBBASE.
- DIRECT ALL RAINLEADERS AND SUMP LEADERS AWAY FROM PLANTING BEDS AND TO THE DESIGNATED DRAINAGE SWALES.
- NOTIFY LANDSCAPE ARCHITECT IN WRITING OF ANY SUBSTANTIAL LET CONDITIONS.

**TOPSOIL**

- AT THE CONTRACTORS EXPENSE A SOIL TEST IS TO BE COMPLETED BY A REPUTABLE LABORATORY. THE SOIL TEST IS TO BE COMPLETED AND NECESSARY RECOMMENDATIONS FROM THE LABORATORY ARE TO BE PROVIDED TO THE LANDSCAPE ARCHITECT AND RECOMMENDATIONS ARE TO BE PROVIDED TO THE LANDSCAPE ARCHITECT FOR APPROVAL ONE WEEK PRIOR TO WORK COMMENCING.
- TOPSOIL FOR PLANTING BEDS IS TO BE A TRIPLE MIX (1/3 TOPSOIL, 1/3 PEATMOSS, 1/3 COMPOST) - FERTILE, FRIABLE, NATURAL CLAY TO A MINIMUM DEPTH OF 18" (450MM) AND A MINIMUM DEPTH OF 4" (100MM) FOR TURF AREAS - UNLESS OTHERWISE STATED - TOPSOIL SHALL CONTAIN NOT LESS THAN 4% ORGANIC MATTER FOR CLAY LOAMS AND NOT LESS THAN 2% ORGANIC MATTER FOR SANDY LOAM TO A MAXIMUM OF 10% AND CAPABLE OF SUSTAINING VIGOROUS PLANT GROWTH. FREE OF SUBSOIL, CONTAMINATION ON ROOTS AND STONES OVER 50MM DIAMETER, REASONABLY FREE OF WEEDS, AS DETERMINED BY THE LANDSCAPE ARCHITECT, AND HAVING A PH RANGING FROM 6.0 TO 10.

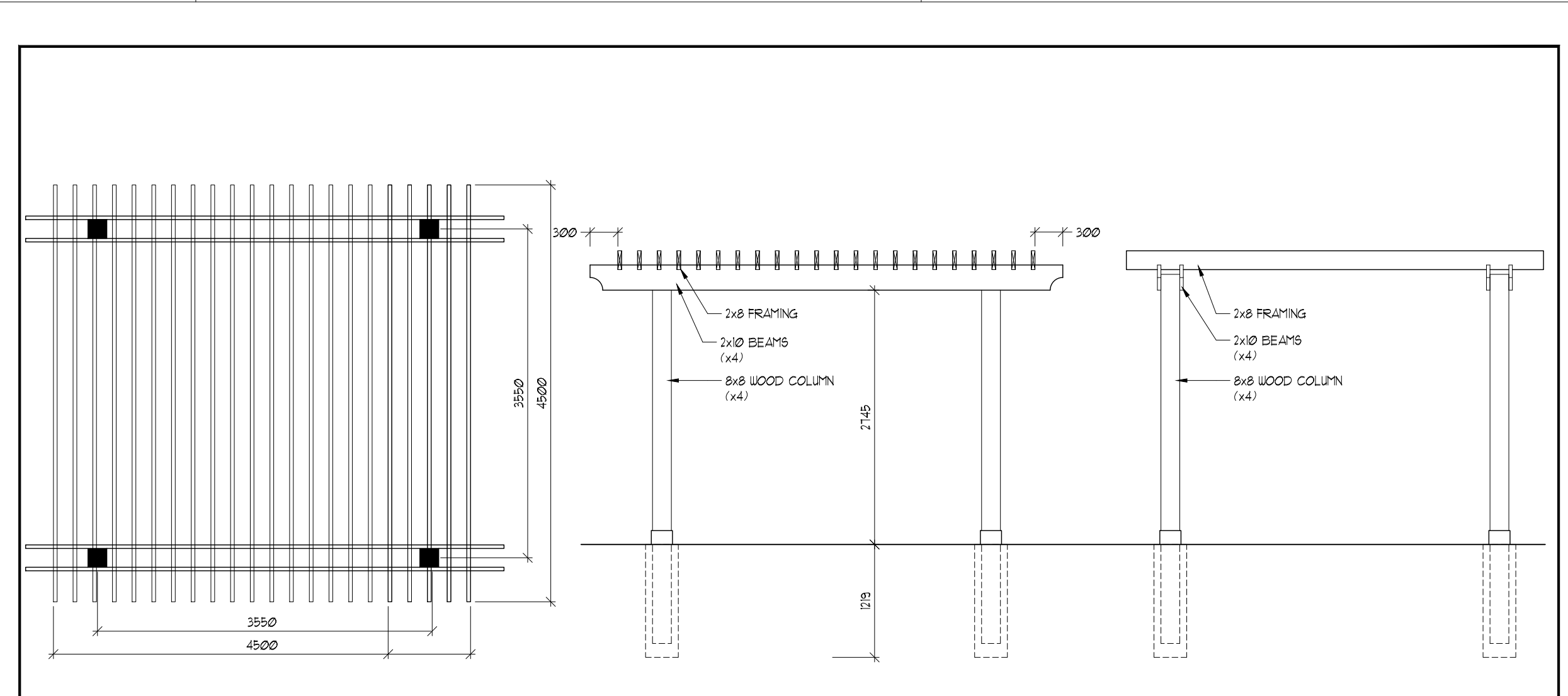

**PERGOLA DETAIL N.T.S.**

NOTES:

- PERGOLA TO BE CONSTRUCTED WITH CONSTRUCTION GRADE CEDAR. ALL FASTENERS TO BE GALVANIZED.
- DO NOT MOUNT TO CONCRETE SIDEWALK. PROVIDE 12M DEEP FOOTINGS.
- STRUCTURAL ENGINEER TO PROVIDE STAMP.

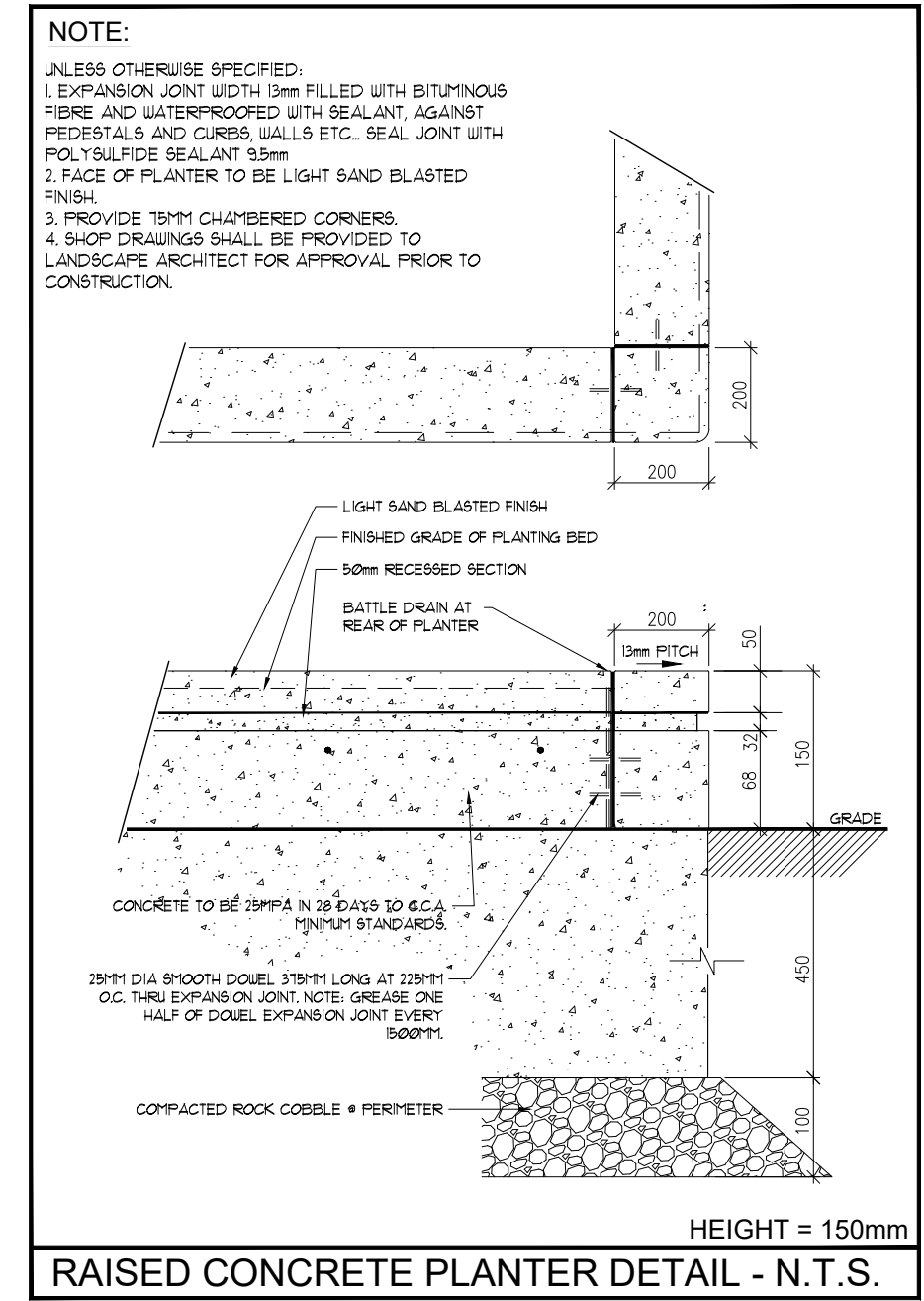

**RAISED CONCRETE PLANTER DETAIL - N.T.S.**

NOTE:

- UNLESS OTHERWISE SPECIFIED: EXPANSION JOINT WIDTH 10mm FILLED WITH BITUMINOUS FIBRE AND WATERPROOFED WITH SEALANT AGAINST PRECASTS AND CURBS SHALL ETC. SEAL JOINT WITH POLYURETHANE SEALANT 15mm.
- FACE OF PLANTER TO BE LIGHT SAND BLASTED FINISH.
- PROVIDE 15MM CHAMFERED CORNERS.
- SHOP DRAINAGE SHALL BE PROVIDED TO LANDSCAPE ARCHITECT FOR APPROVAL PRIOR TO CONSTRUCTION.

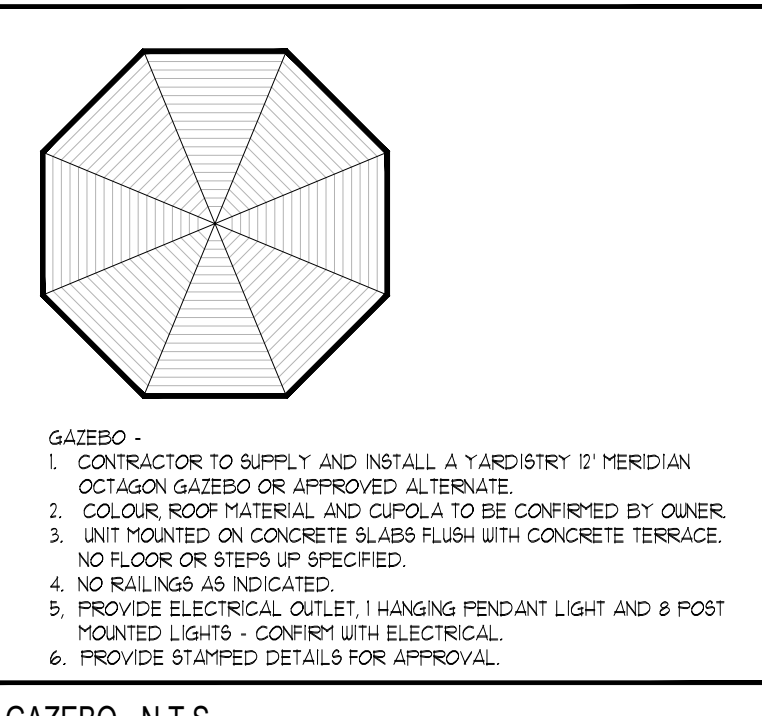

**GAZEBO - N.T.S.**

NOTE:

- CONTRACTOR TO SUPPLY AND INSTALL A YARDSTRY 12' DIAMETER OCTAGON GAZEBO OR APPROVED ALTERNATE.
- COLOR ROOF MATERIAL AND CUPOLA TO BE CONFIRMED BY OWNER.
- UNIT MOUNTED ON CONCRETE SLABS FLUSH WITH CONCRETE TERRACE. NO FLOOR OR STEPS UP SPECIFIED.
- NO RAILINGS AS INDICATED.
- PROVIDE ELECTRICAL OUTLET, 1 HANGING PENDANT LIGHT AND 8 POST MOUNTED LIGHTS - CONFIRM WITH ELECTRICAL.
- PROVIDE STAMPED DETAILS FOR APPROVAL.

**SHEDS - N.T.S.**

NOTE:

- CONTRACTOR TO SUPPLY AND INSTALL 12' x 8' x 8' LIFETIME OUTDOOR STORAGE SHED #000106131 BY HOME DEPOT OR APPROVED ALTERNATE.
- COLOR TO BE CONFIRMED BY OWNER.
- UNIT MOUNTED ON CONCRETE SLABS FLUSH WITH CONCRETE TERRACE. NO FLOOR OR STEPS UP SPECIFIED.
- PROVIDE GFI ELECTRICAL OUTLETS AND INTERIOR LIGHTS - CONFIRM WITH ELECTRICAL.

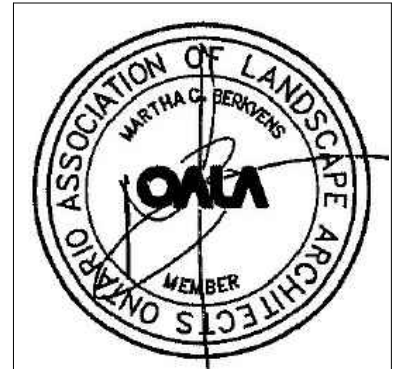

388 Oakes Street East, London, Ontario, N6A 1Y7

ISSUED FOR SPA SUBMISSION #3  
2024-01-11  
36%  
ISSUED FOR SPA SUBMISSION #3  
2024-09-30  
ISSUED FOR SPA SUBMISSION #4  
2024-12-19

RON KOUDEY ARCHITECTS

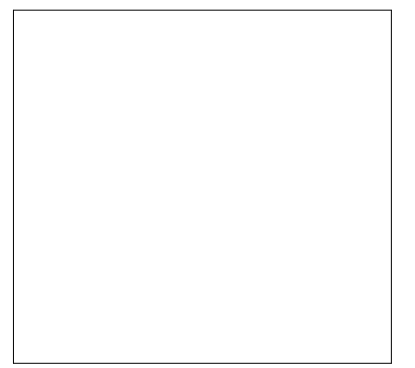

**Schlegel Village - Oakville**

2150 WILLIAM HALTON PARKWAY W. OAKVILLE ONTARIO

Project No.: 22-257z  
Drawn By: MCB  
Plot Date: 2024-12-18

**LANDSCAPE PLAN & DETAILS**

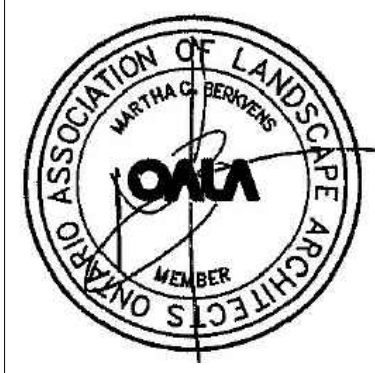

ISSUED FOR SPA SUBMISSION #3  
 2024-01-11  
 2024-09-30  
 2024-12-19

ISSUED FOR SPA SUBMISSION #4  
 2024-01-11  
 2024-09-30  
 2024-12-19

2150 WILLIAM HALTON PARKWAY W. OAKVILLE, ONTARIO, CANADA, N6H 1Y7  
 905.880.8888  
 416.880.8888  
 www.maglin.ca  
 info@maglin.ca



**Schlegel Village**  
 Schlegel Village  
 2150 WILLIAM HALTON PARKWAY W. OAKVILLE, ONTARIO

Project No.: 22-2372  
 Drawn By: MCB  
 Plot Date: 2024-12-18

**Schlegel Village - Oakville**  
 LANDSCAPE DETAILS

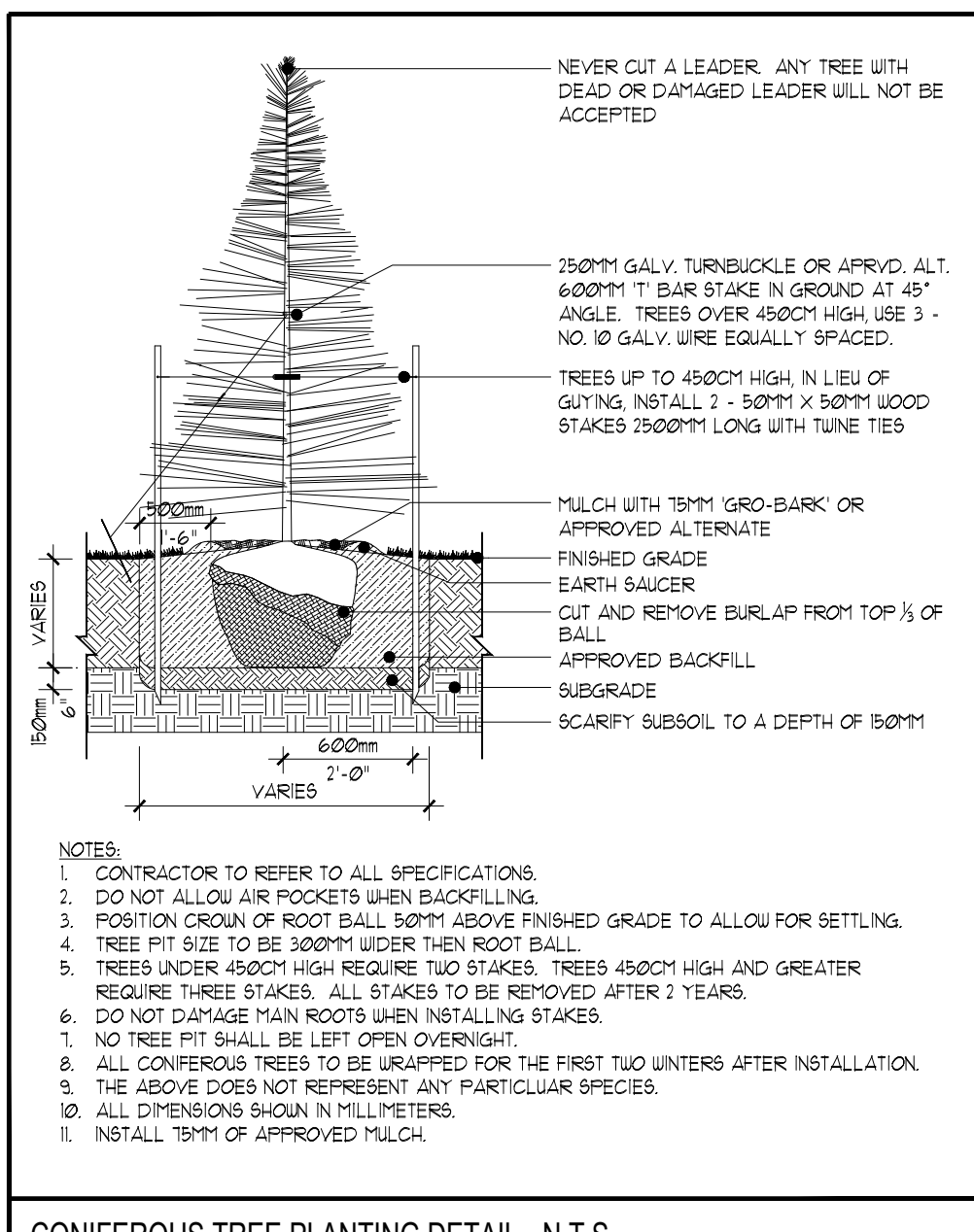

CONIFEROUS TREE PLANTING DETAIL - N.T.S.

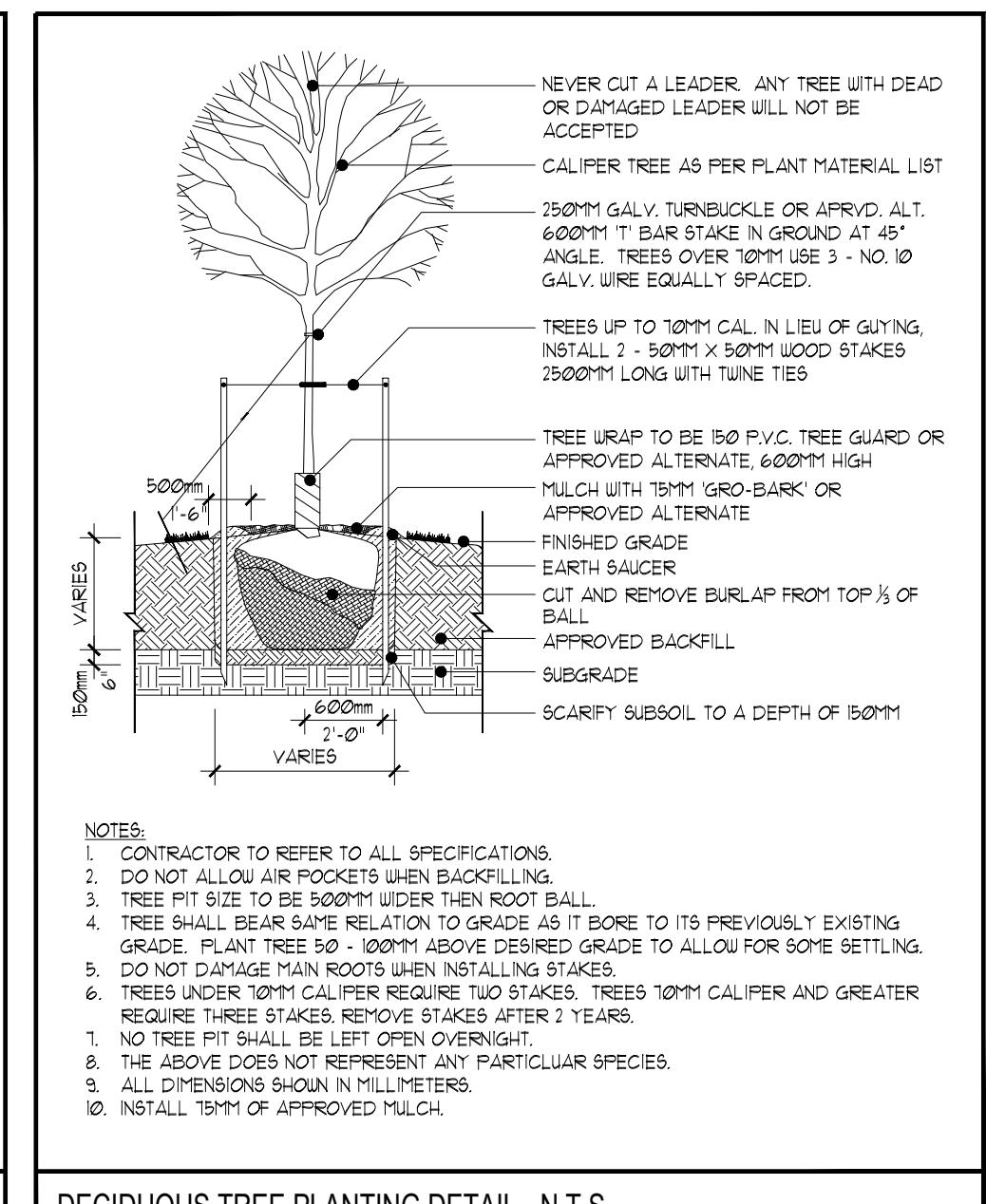

DECIDUOUS TREE PLANTING DETAIL - N.T.S.

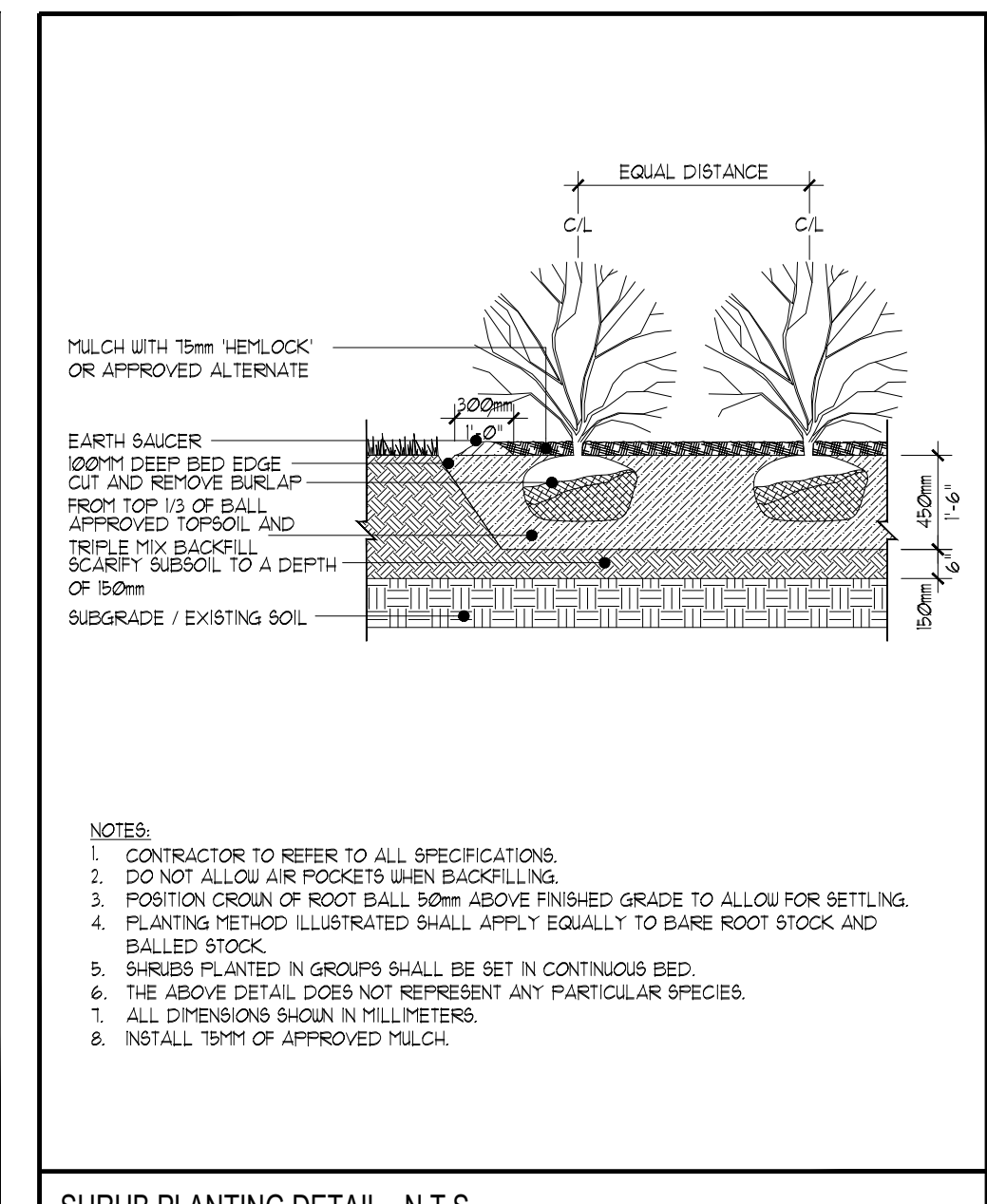

SHRUB PLANTING DETAIL - N.T.S.

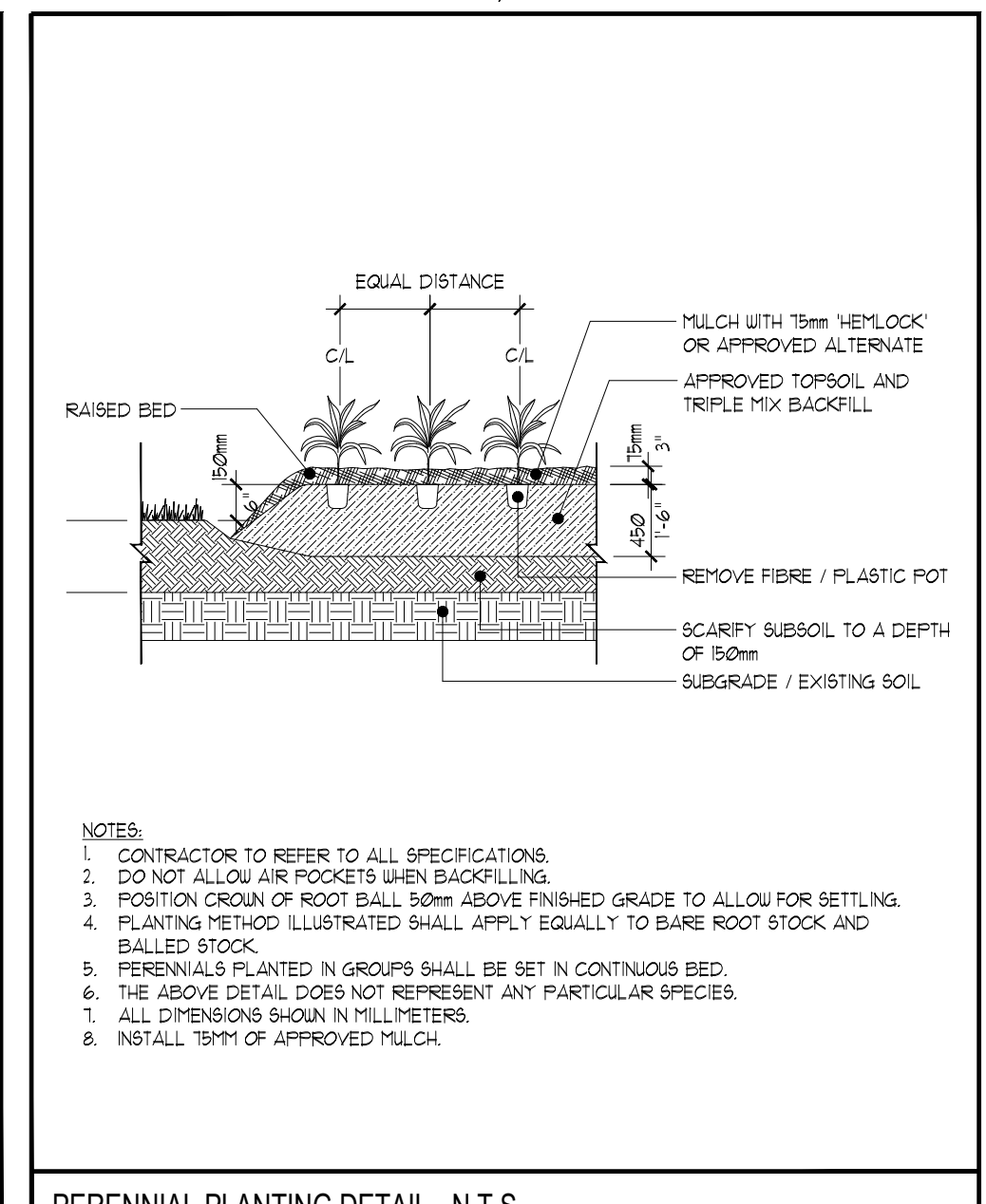

PERENNIAL PLANTING DETAIL - N.T.S.

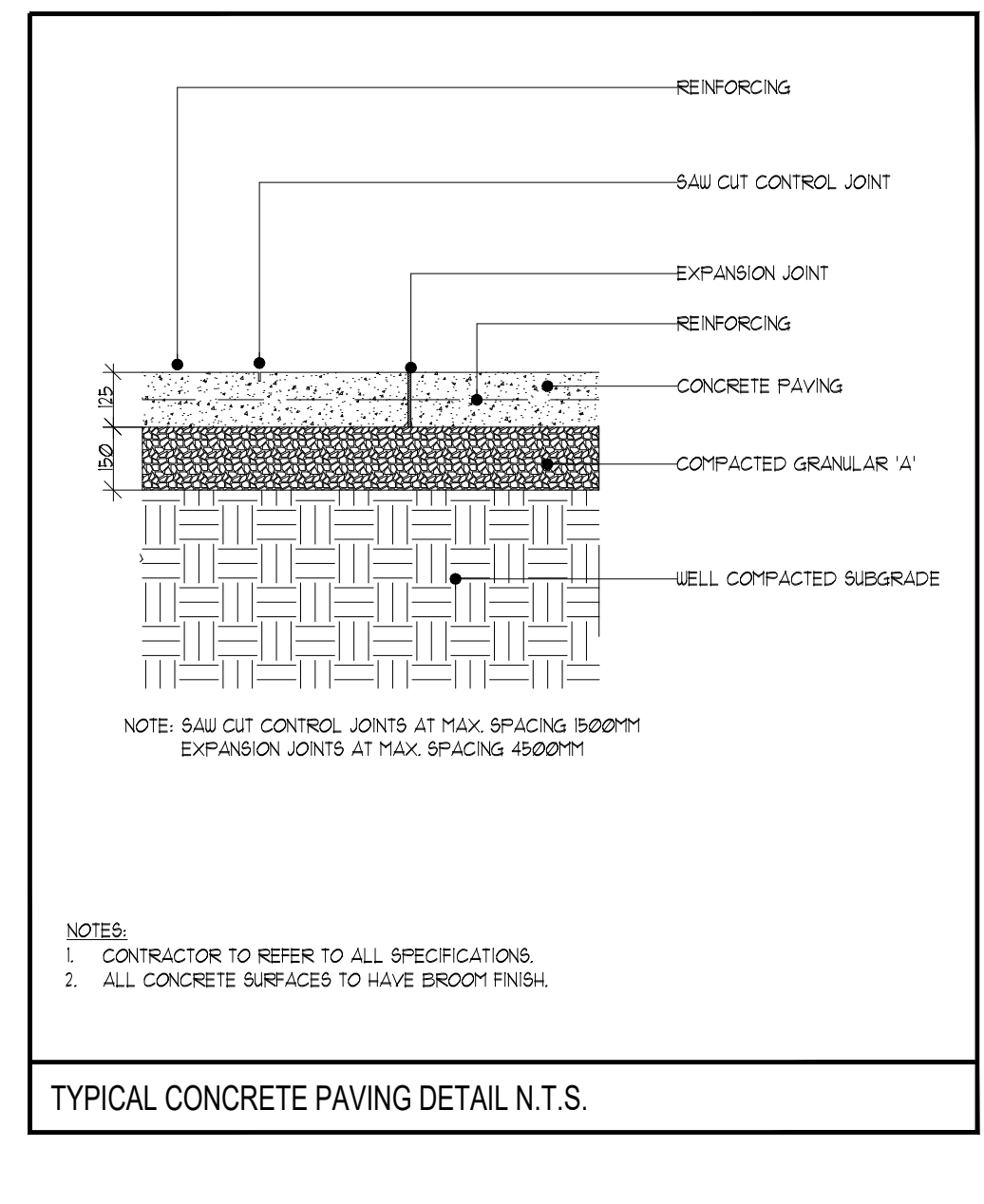

TYPICAL CONCRETE PAVING DETAIL N.T.S.

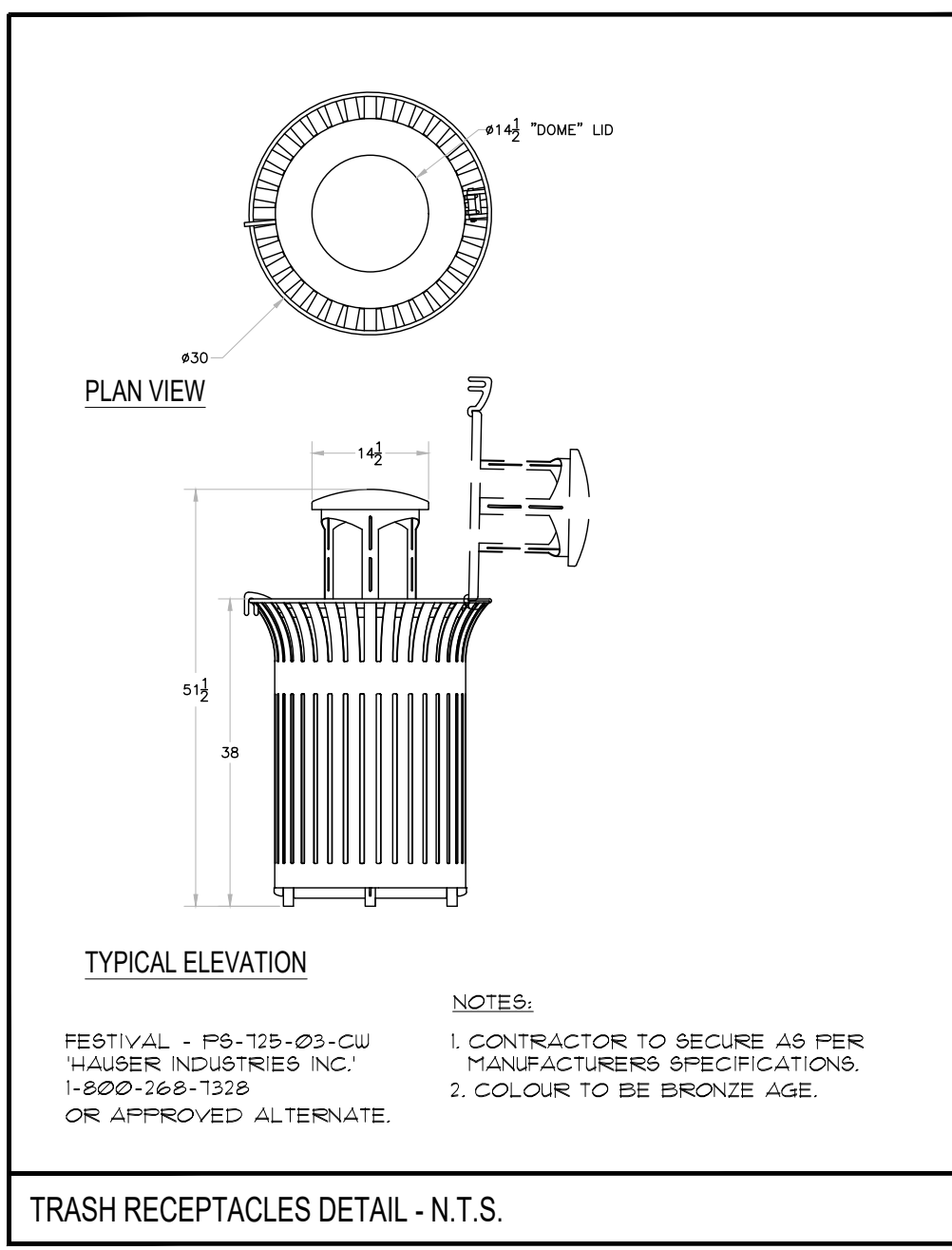

TRASH RECEPTACLES DETAIL - N.T.S.

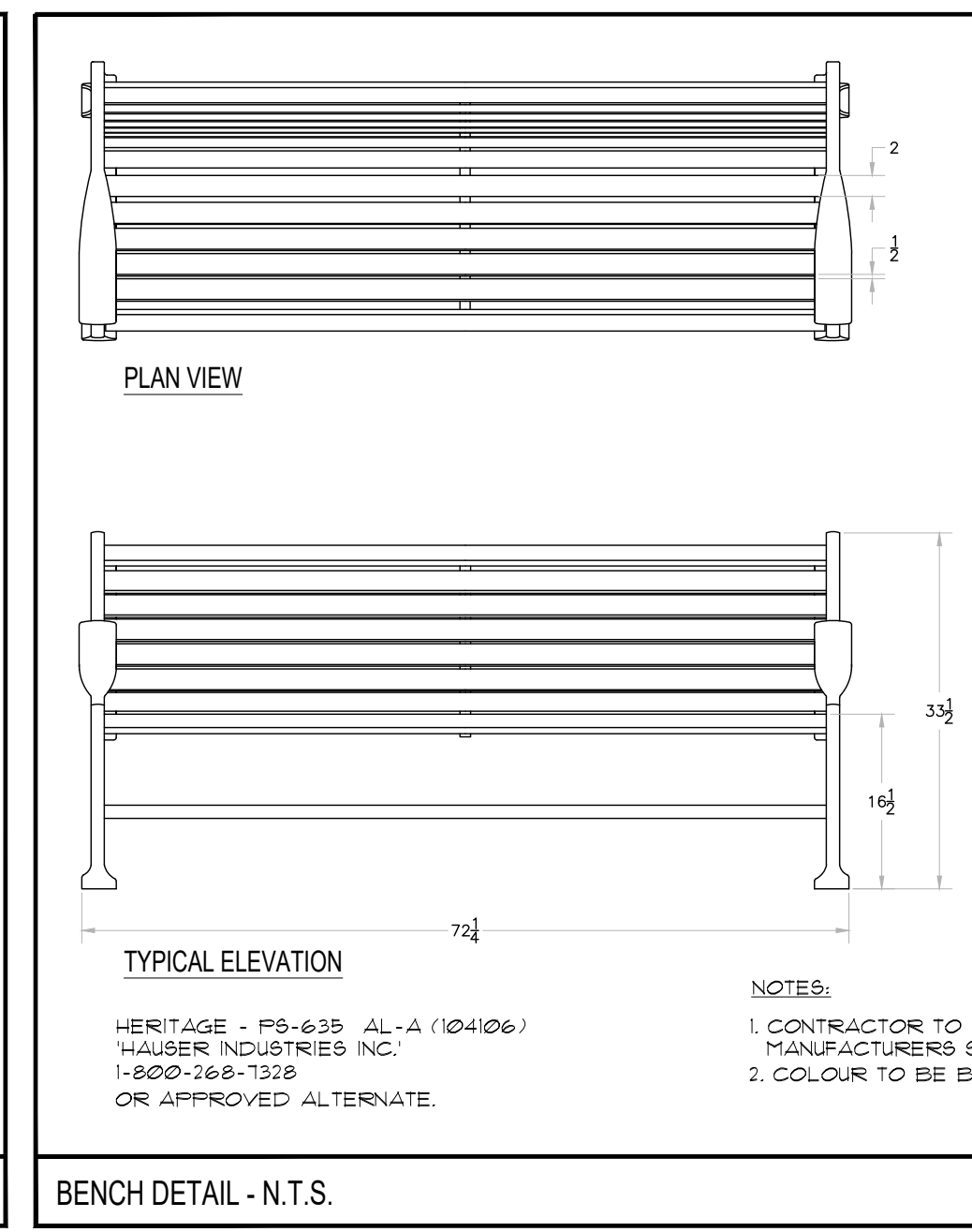

BENCH DETAIL - N.T.S.

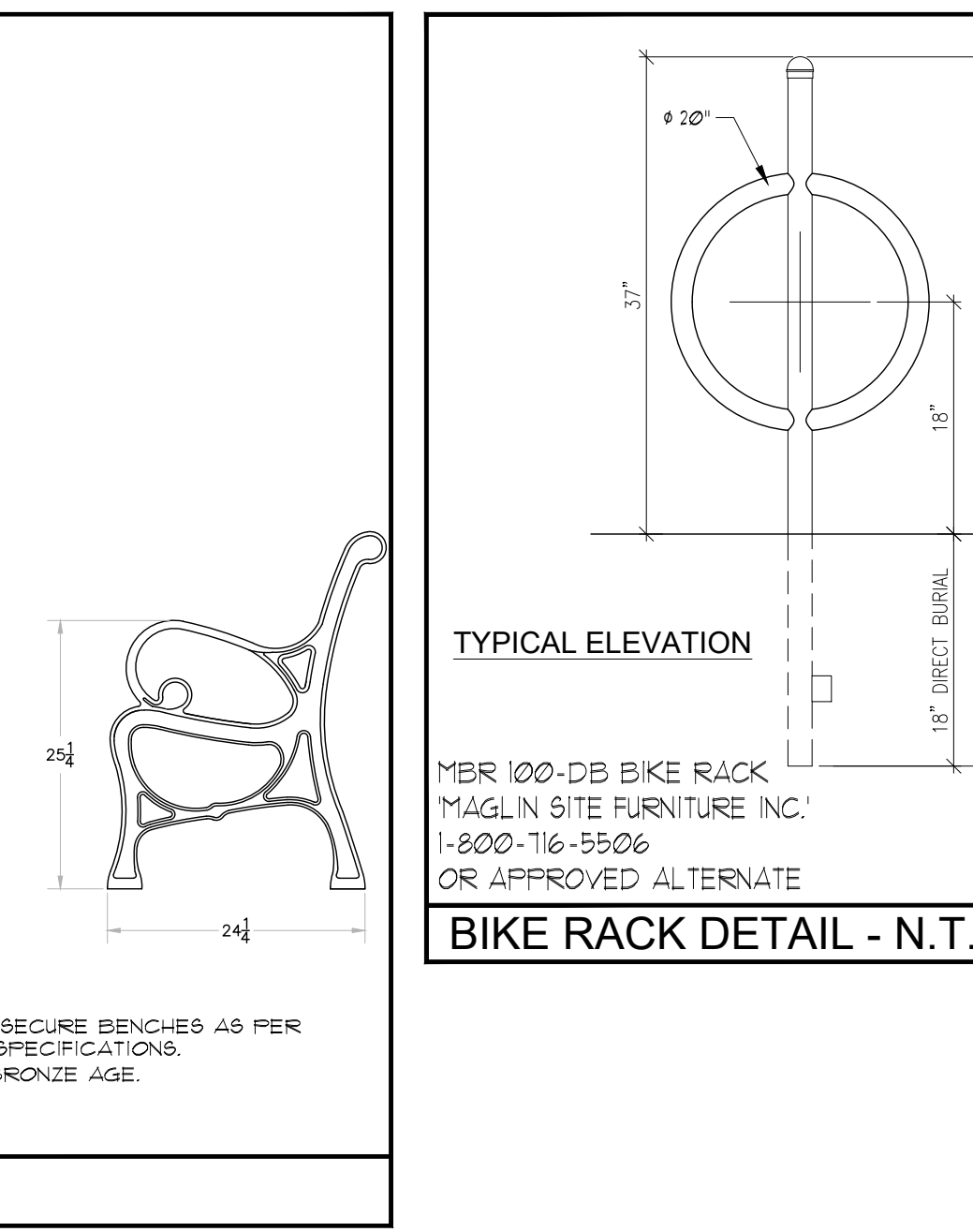

BIKE RACK DETAIL - N.T.S.

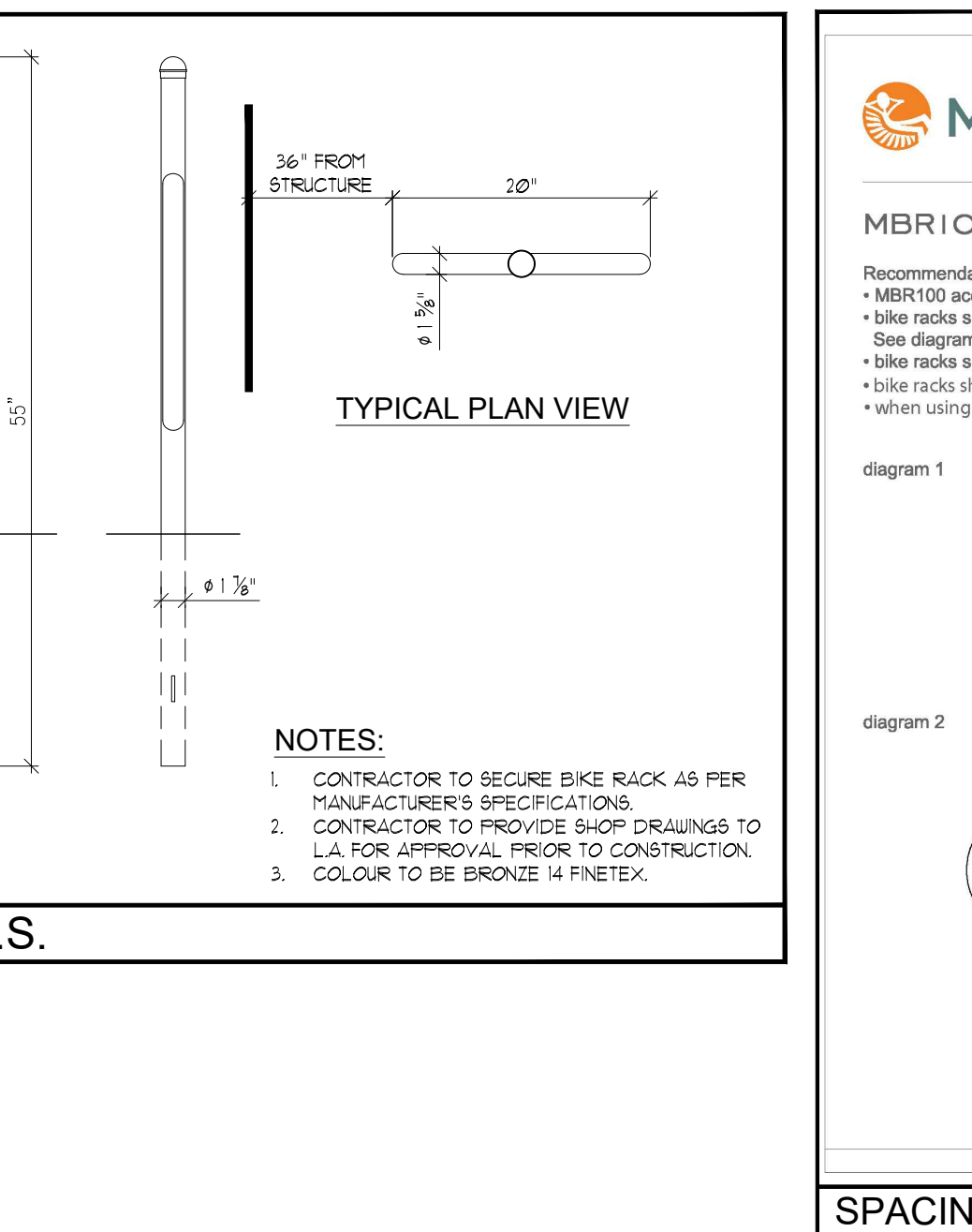

BIKE RACK DETAIL - N.T.S.

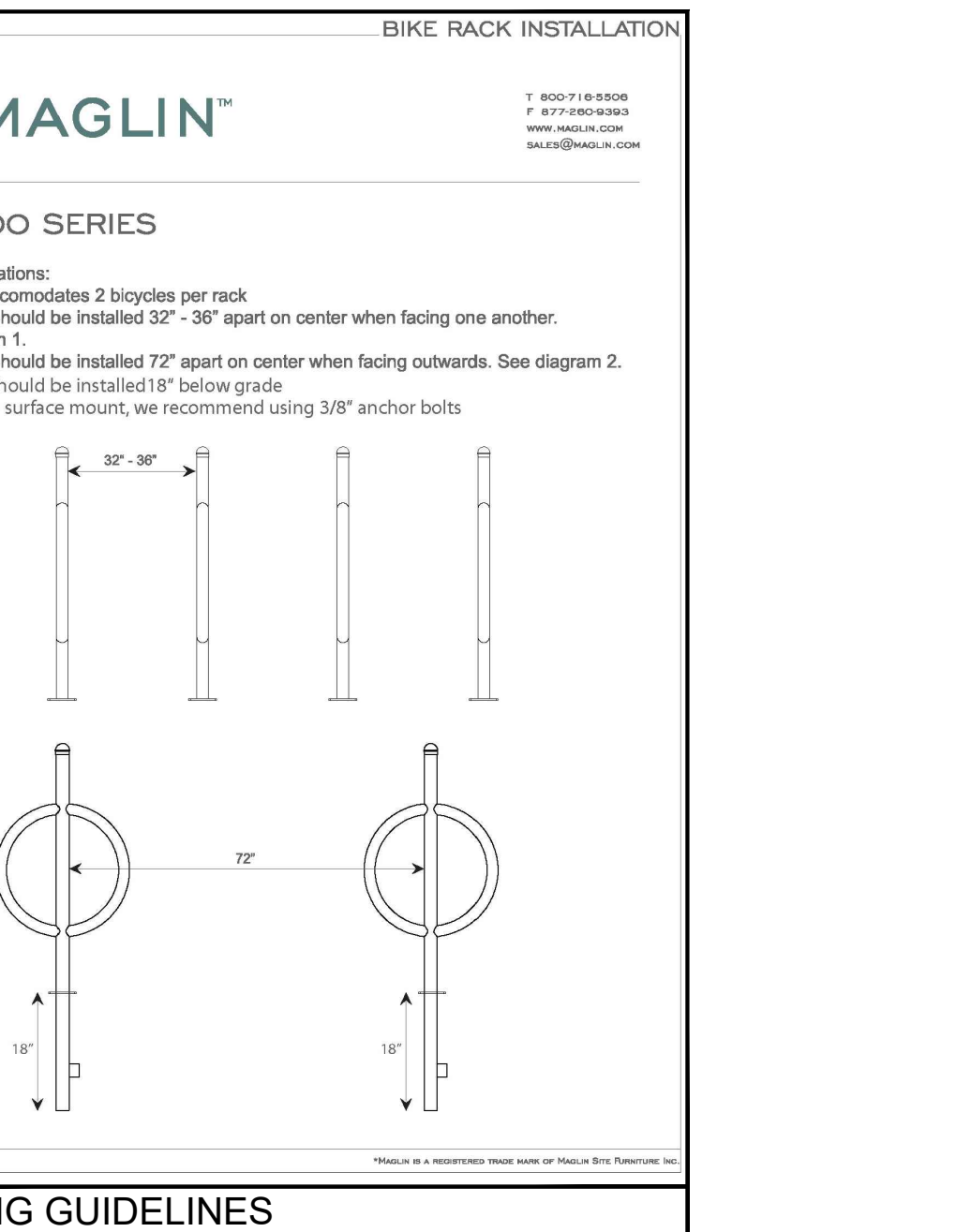

SPACING GUIDELINES

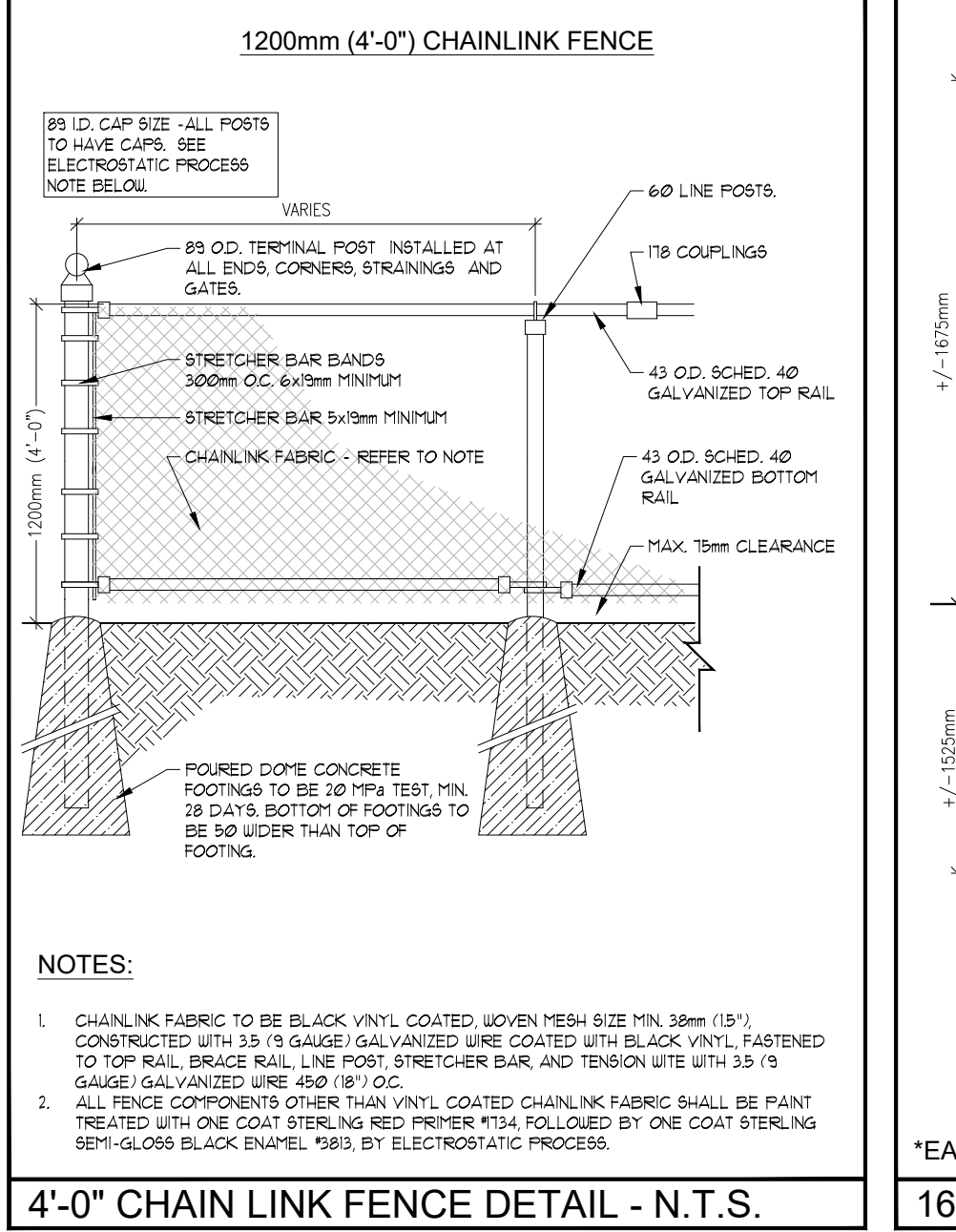

4'-0" CHAIN LINK FENCE DETAIL - N.T.S.

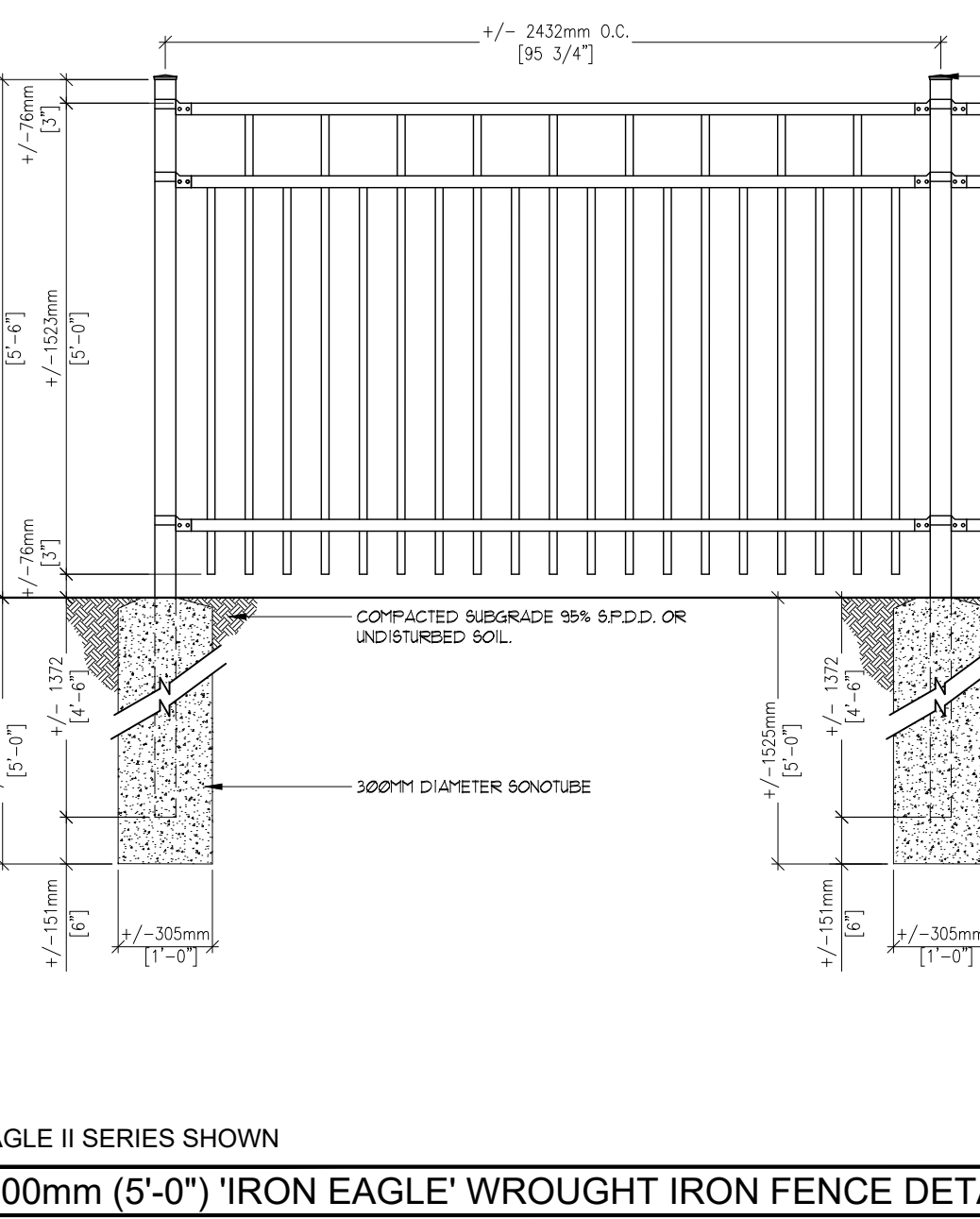

1600mm (5'-0") 'IRON EAGLE' WROUGHT IRON FENCE DETAIL - N.T.S.

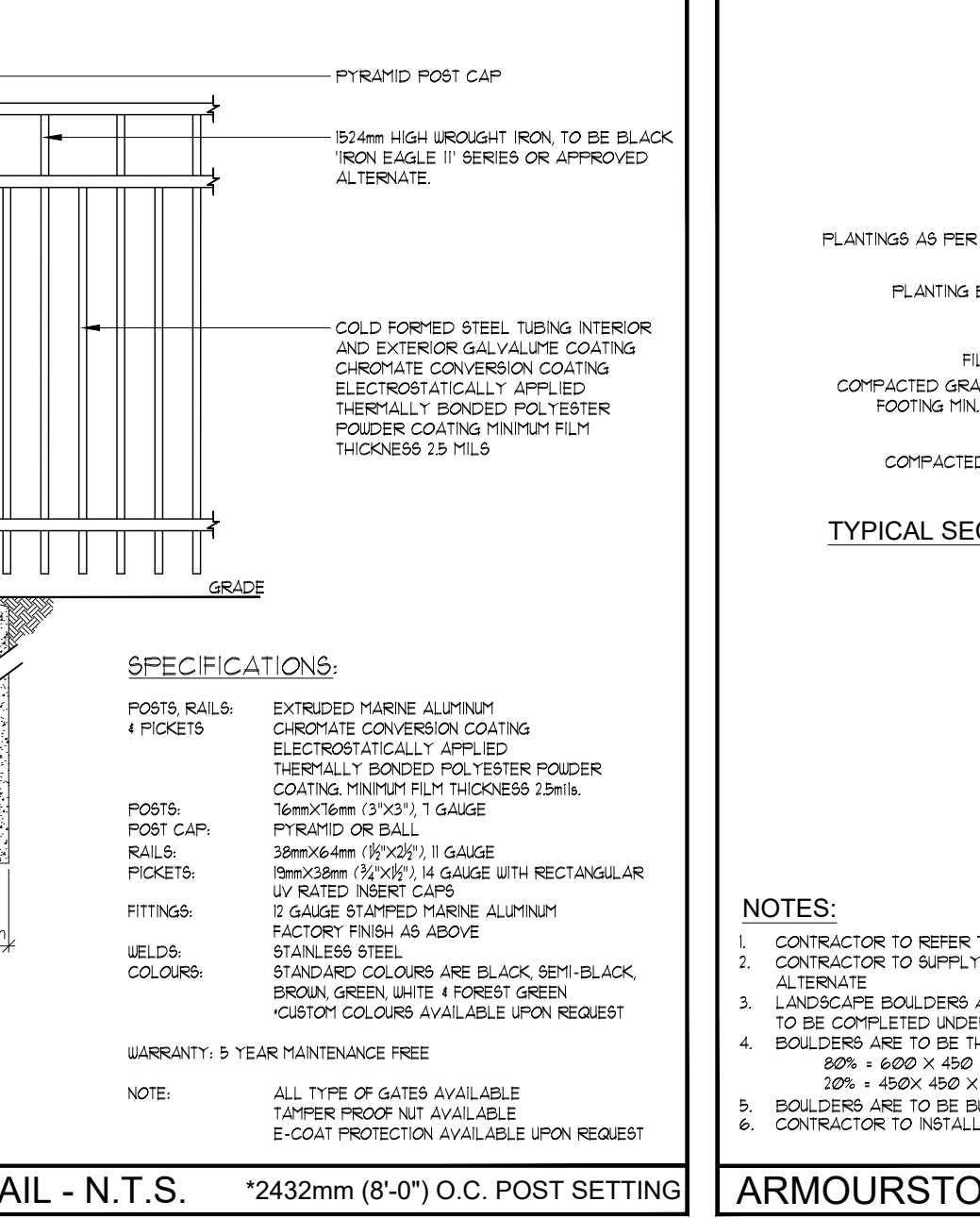

ARMOURSTONE DETAIL - N.T.S.

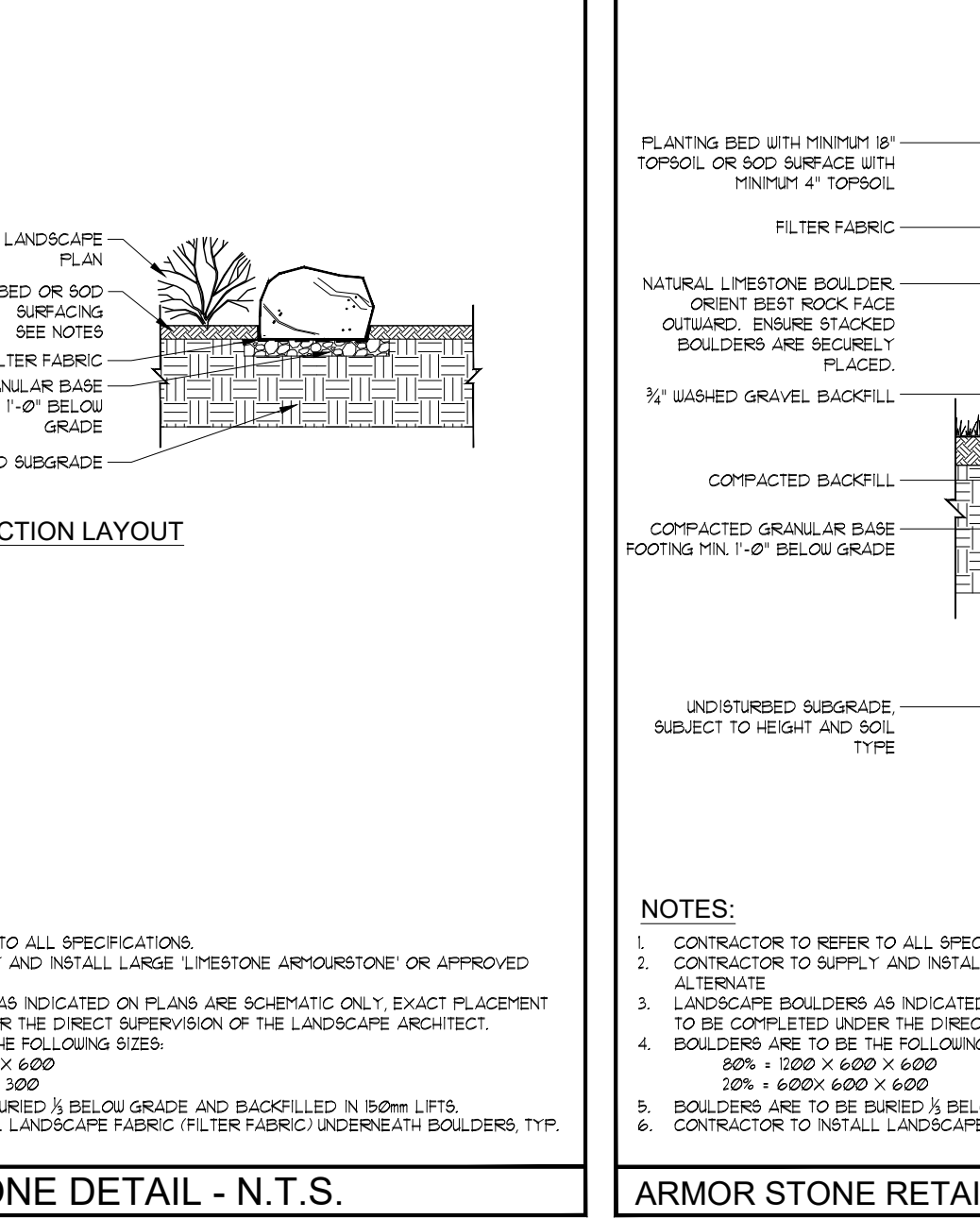

ARMOR STONE RETAINING WALL DETAIL - N.T.S.



2024.01.11 ISSUED FOR SPA  
 2024.07.11 REVISED FOR SPA  
 2024.09.30 ISSUED FOR SPA SUBMISSION #3  
 2024.12.19 ISSUED FOR SPA SUBMISSION #4

988 Colwell Street East, London, Ontario, N6A 1V7  
**RON KOUROS LANDSCAPE ARCHITECTS**

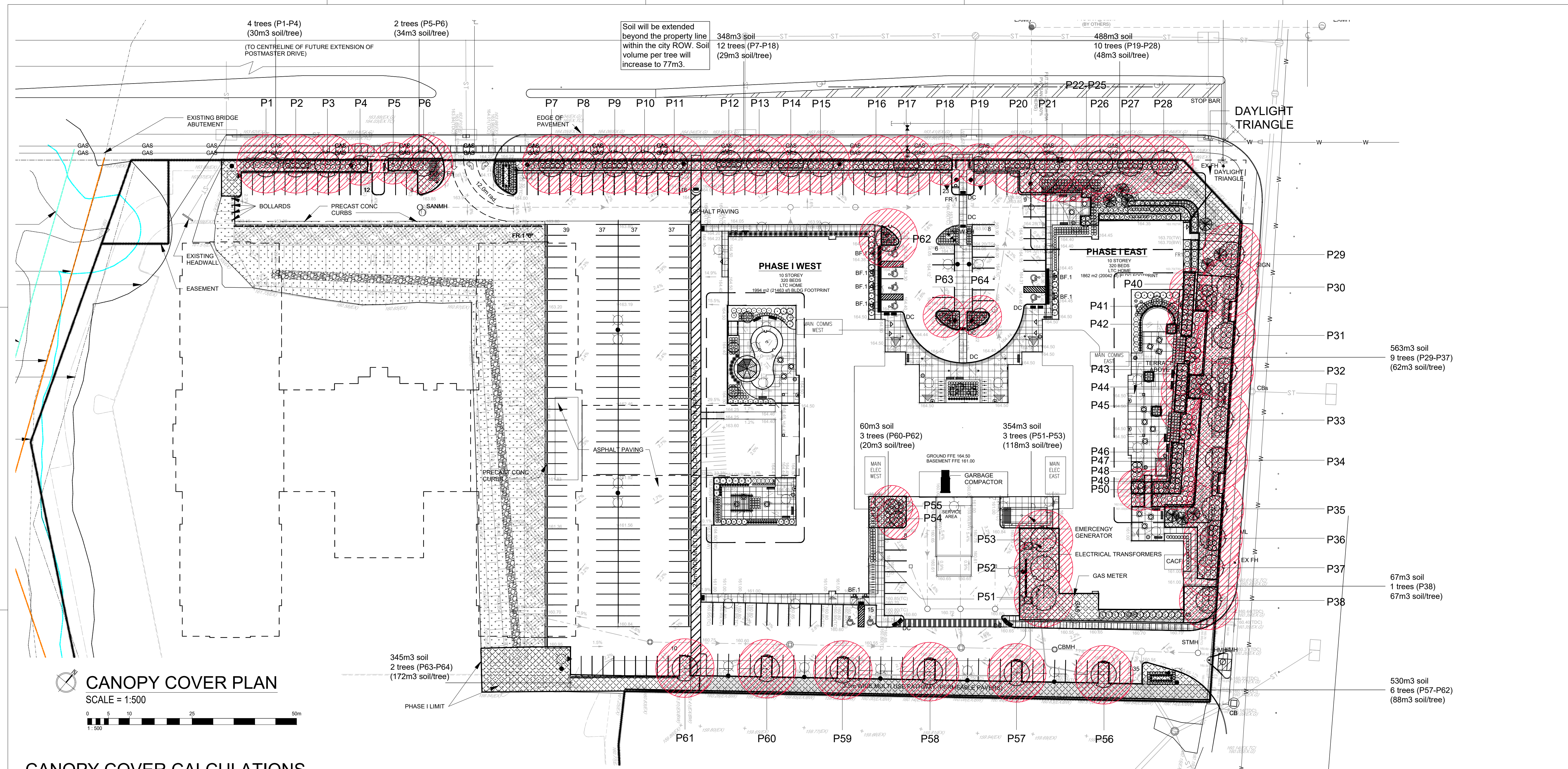

**CANOPY COVER PLAN**  
 SCALE = 1:500

**CANOPY COVER CALCULATIONS**

TREE #	SPECIES	STATURE (S.M.)	SOIL VOLUME/TREE (CUBIC METERS)	CANOPY AREA (SQUARE METERS)	TREE #	SPECIES	STATURE (S.M.)	SOIL VOLUME/TREE (CUBIC METERS)	CANOPY AREA (SQUARE METERS)	TREE #	SPECIES	STATURE (S.M.)	SOIL VOLUME/TREE (CUBIC METERS)	CANOPY AREA (SQUARE METERS)
<b>PROPOSED CANOPY ON SITE</b>					<b>PROPOSED CANOPY ON SITE</b>					<b>PROPOSED CANOPY ON SITE</b>				
P1	Gleditsia triacanthos 'Shademaster'	L	30	154	P17	Gleditsia triacanthos 'Shademaster' - consideration of breakout zone provided within city right of way	L	26	96	P47	Omitted due to insufficient soil			
P2	Gleditsia triacanthos 'Shademaster'	L	30	95	P18	Cercis canadensis 'Forest Pansy' (Single-stem) - consideration of breakout zone provided within city right of way	M	26	65	P48	Omitted due to insufficient soil			
P3	Gleditsia triacanthos 'Shademaster'	L	30	100	P19	Cercis canadensis 'Forest Pansy' (Single-stem)	M	48	71	P49	Omitted due to insufficient soil			
P4	Cercis canadensis 'Forest Pansy' (Single-stem)	M	30	52	P20	Gleditsia triacanthos 'Shademaster'	L	48	95	P50	Omitted due to insufficient soil			
P5	Cercis canadensis 'Forest Pansy' (Single-stem)	M	34	70	P21	Gleditsia triacanthos 'Shademaster'	L	48	94	P51	Celtis occidentalis	L	118	153
P6	Acer rubrum 'Red Sunset'	L	34	123	P22	Cercis canadensis 'Forest Pansy' (Single-stem)	M	48	76	P52	Celtis occidentalis	L	118	94
P7	Gleditsia triacanthos 'Shademaster' - consideration of breakout zone provided within city right of way	L	29	154	P23	Cercis canadensis 'Forest Pansy' (Single-stem)	M	48	10	P53	Celtis occidentalis	L	119	92
P8	Gleditsia triacanthos 'Shademaster' - consideration of breakout zone provided within city right of way	L	29	100	P24	Cercis canadensis 'Forest Pansy' (Single-stem)	M	48	9	P54	Cercis canadensis (Multi-stem)	M	20	40
P9	Gleditsia triacanthos 'Shademaster' - consideration of breakout zone provided within city right of way	L	29	100	P25	Cercis canadensis 'Forest Pansy' (Single-stem)	M	48	10	P55	Cercis canadensis (Multi-stem)	M	20	47
P10	Gleditsia triacanthos 'Shademaster' - consideration of breakout zone provided within city right of way	L	29	100	P26	Acer rubrum 'Red Sunset'	L	48	148	P56	Cercis canadensis (Multi-stem)	M	20	38
P11	Gleditsia triacanthos 'Shademaster' - consideration of breakout zone provided within city right of way	L	29	95	P27	Gleditsia triacanthos 'Shademaster'	L	48	96	P57	Platanus acerifolia - consideration of breakout zone into SWM area	L	88	153
P12	Gleditsia triacanthos 'Shademaster' - consideration of breakout zone provided within city right of way	L	29	148	P28	Gleditsia triacanthos 'Shademaster'	L	48	105	P58	Quercus rubra - consideration of breakout zone into SWM area	L	88	153
P13	Gleditsia triacanthos 'Shademaster' - consideration of breakout zone provided within city right of way	L	29	100	P29	Gleditsia triacanthos 'Shademaster'	L	62	154	P59	Quercus rubra - consideration of breakout zone into SWM area	L	88	153
P14	Acer rubrum 'Red Sunset' - consideration of breakout zone provided within city right of way	L	29	148	P30	Gleditsia triacanthos 'Shademaster'	L	62	109	P60	Platanus acerifolia - consideration of breakout zone into SWM area	L	88	153
P15	Gleditsia triacanthos 'Shademaster' - consideration of breakout zone provided within city right of way	L	29	100	P31	Gleditsia triacanthos 'Shademaster'	L	62	154	P61	Platanus acerifolia - consideration of breakout zone into SWM area	L	88	153
P16	Acer rubrum 'Red Sunset' - consideration of breakout zone provided within city right of way	L	29	151	P32	Celtis occidentalis	L	62	111	P62	Quercus rubra - consideration of breakout zone into SWM area	L	88	153
					P33	Celtis occidentalis	L	62	141	P63	Quercus rubra - consideration of breakout zone into SWM area	L	88	153
					P34	Gleditsia triacanthos 'Shademaster'	L	62	124	P64	Platanus acerifolia - consideration of breakout zone into SWM area	L	112	153
					P35	Gleditsia triacanthos 'Shademaster'	L	62	141	P65	Omitted due to insufficient soil			
					P36	Gleditsia triacanthos 'Shademaster'	L	62	141	P66	Omitted due to insufficient soil			
					P37	Gleditsia triacanthos 'Shademaster'	L	62	94	P67	Omitted due to insufficient soil			
					P38	Gleditsia triacanthos 'Shademaster'	L	62	94					
					P39	Gleditsia triacanthos 'Shademaster'	L	62	94					
					P40	Omitted due to insufficient soil								
					P41	Omitted due to insufficient soil								
					P42	Omitted due to insufficient soil								
					P43	Omitted due to insufficient soil								
					P44	Omitted due to insufficient soil								
					P45	Omitted due to insufficient soil								
					P46	Omitted due to insufficient soil								
					P47	Omitted due to insufficient soil								
					P48	Omitted due to insufficient soil								
					P49	Omitted due to insufficient soil								
					P50	Omitted due to insufficient soil								
					P51	Omitted due to insufficient soil								
					P52	Omitted due to insufficient soil								
					P53	Omitted due to insufficient soil								
					P54	Omitted due to insufficient soil								
					P55	Omitted due to insufficient soil								
					P56	Omitted due to insufficient soil								
					P57	Omitted due to insufficient soil								
					P58	Omitted due to insufficient soil								
					P59	Omitted due to insufficient soil								
					P60	Omitted due to insufficient soil								
					P61	Omitted due to insufficient soil								
					P62	Omitted due to insufficient soil								
					P63	Omitted due to insufficient soil								
					P64	Omitted due to insufficient soil								
					P65	Omitted due to insufficient soil								
					P66	Omitted due to insufficient soil								
					P67	Omitted due to insufficient soil								

**LEGEND**

PROPOSED CANOPY

AVAILABLE SOIL VOLUME (AREA x D.S.)

**Schlegel Village - Oakville**  
 2150 WILLIAM HALTON PARKWAY W. OAKVILLE, ONTARIO

**CANOPY COVERAGE PLAN**

Project No.: 22-2372  
 Drawn By: MCB  
 Plot Date: 2024-12-18