

<b>Tree Canopy Coverage Chart Site</b>						
File Number: 113151E						
File Name: 3171 Lakeshore Road West, Oakville, Ontario						
Canopy Cover Target: 25% Based on Residential Land Use						
Tree #	Species	Number of Trees	Soil Volume Total	Soil Volume per Tree (m <sup>3</sup> )	Canopy Area (m <sup>2</sup> )	Canopy Area per tree (m <sup>2</sup> )
<b>Proposed Large Stature Trees</b>						
T1	Freemans Maple	1	30	30	153	153
T2	Kentucky Coffee Tree, Freeman Maple, Bur Oak	8	210	26	1005	133
T3	Freemans Maple	1	30	30	153	153
<b>Subtotal of Proposed Canopy (m<sup>2</sup>)</b>						<b>1371</b>
<b>Total # of Trees</b>					<b>10</b>	<b>Total Canopy Area (m<sup>2</sup>)</b>
						<b>1371</b>
<b>Canopy Summary</b>						
Total Site m <sup>2</sup>						2,674.0
Site Canopy Cover						51.3%
Canopy Cover Target by Land Use						25%
<b>Parking Area Summary</b>						
Total parking Spaces Proposed						
Total # of Trees in or within 5m of Parking Area						0
Percentage of Parking Spots within 30m of a Proposed Tree						N/A

PLANT SCHEDULE					
CODE	QTY	BOTANICAL NAME	COMMON NAME	SIZE	COST
<b>DECIDUOUS TREES</b>					
AF	1	ACER FREEMANII 'REDHILL BLAZE'	AUTUMN BLAZE / JEFFERSON MAPLE	100MM CAL.	\$85
CH	1	QUERCUS GRANATIFLORA	KENTUCKY COFFEE TREE	100MM CAL.	\$95
OSD	1	SORBUS LACINIOSA	WHITE DAWG	100MM CAL.	\$85
TD	1	SUBTOTAL:			
<b>BROADLEAF EVERGREEN</b>					
E	10	ELAEAGNUS CHAMISSI	NORCICH / NINEBERRY HOLLY	1 GAL	\$10

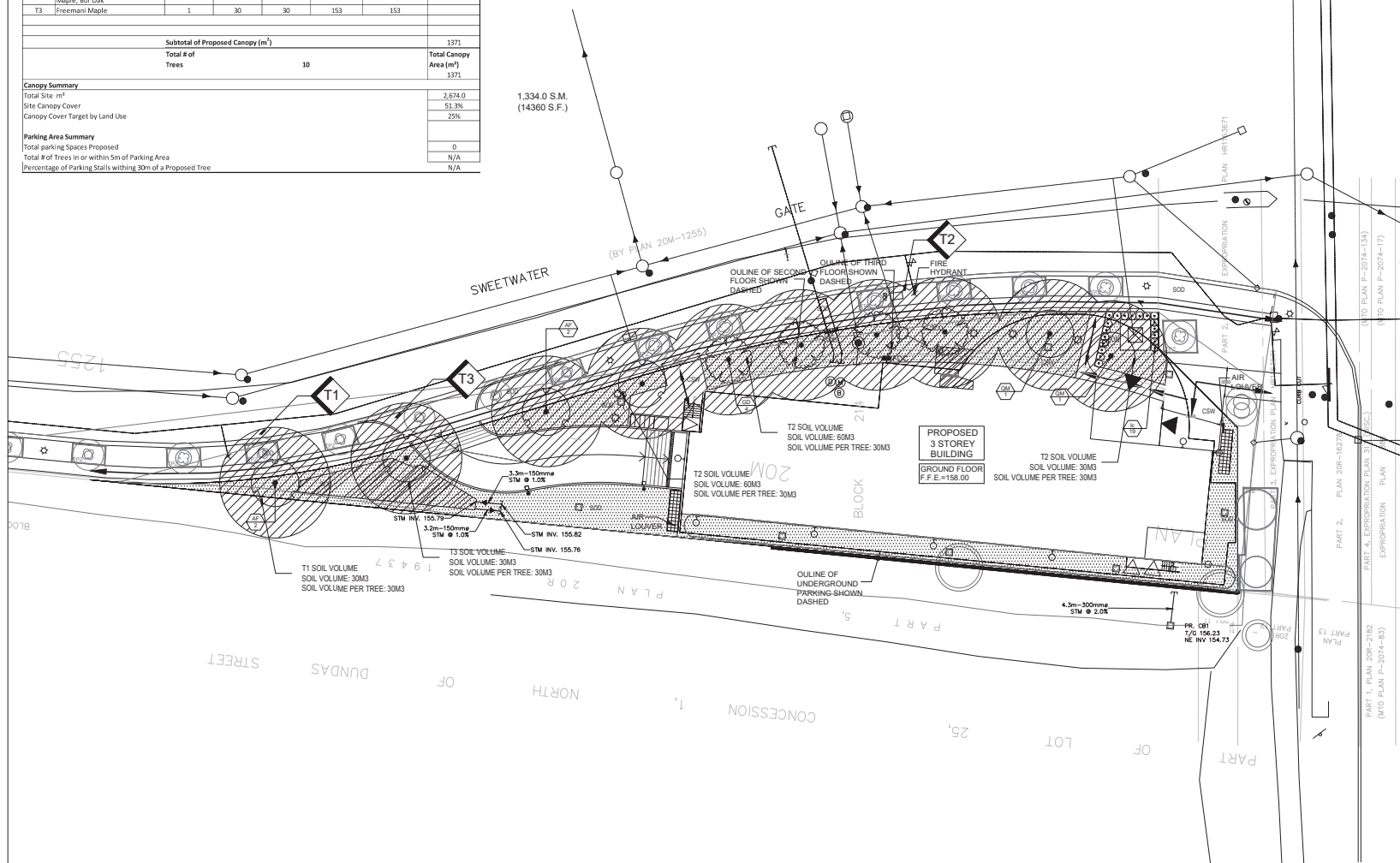

### LEGEND



} PROPOSED DECIDUOUS TREE

 PROPOSED SHRUB BED

CONCRETE SIDEWALK

 SODDED AREA

### GENERAL NOTES

1. Do not scale the drawings. All dimensions are in millimeters unless noted otherwise.
2. This drawing is to be read in conjunction with the overall master plan and engineering drawings prepared by the project engineer and site plans prepared by the project architect.
3. The contractor shall check and verify all existing and proposed grading and conditions on the project and immediately report any discrepancies to the consultant before proceeding with any work.
4. The contractor is to be responsible for all existing and proposed services and utilities. The contractor is responsible for having all underground services and utility lines stated by each agency having jurisdiction prior to commencing work.
5. This drawing is to be used for development approval only. For layout of all work refer to construction drawings.
6. Plant quantities indicated on the plan supersede the quantities from the plant list (report any discrepancies to the landscape architect).
7. Do not leave any holes open overnight.
8. Keep all outside construction zone areas used and useable by others at all times. Contractor shall thoroughly clean zone areas surrounding the construction zone at the end of each work day.
9. Contractor to make good any and all damages outside of the development area that may occur as a result of construction work and pay any extra cost.
10. This drawing is Copyright © MHCBC 2024.

3.	MARCH 31, 2025	ISSUED FOR ZBA	CC
2.	NOVEMBER 04, 2024	ISSUED FOR ZBA	CC
1.	AUGUST 12, 2024	ISSUED FOR ZBA	CC
REVISION NO.	DATE	ISSUED / REVISION	BY



PLANNING  
URBAN DESIGN  
& LANDSCAPE  
ARCHITECTURE

STAM



ISSUED FOR ZBA ONLY  
NOT FOR CONSTRUCTION

All drawings and specifications are instruments of service and will remain the property of MHC Planning and must be returned at the completion of the work. This drawing shall not be used for construction purposes unless the drawings are marked "Issued for Construction" and the professional seal is signed and dated by the landscape architect.

PROJECT

3010 SWEETWATER GATE  
OAKVILLE, ON

FILE NAME

CANOPY COVER PLAN

	DWG NO.
--	---------

L1