

LEGEND

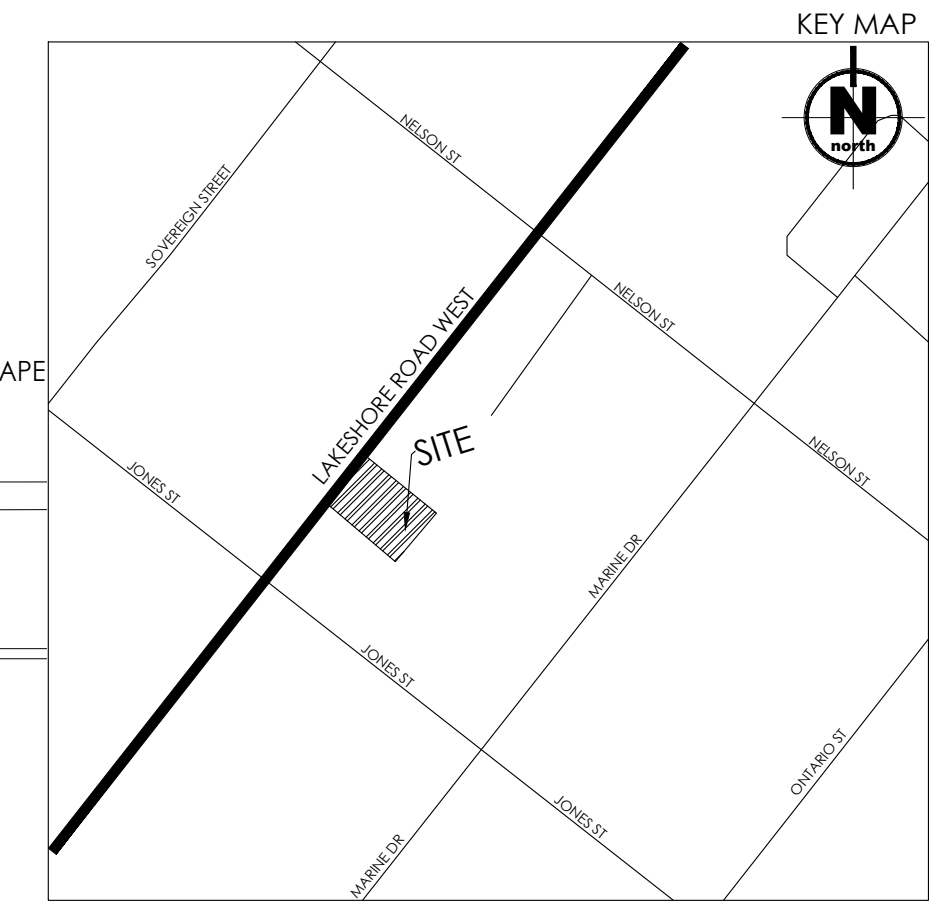
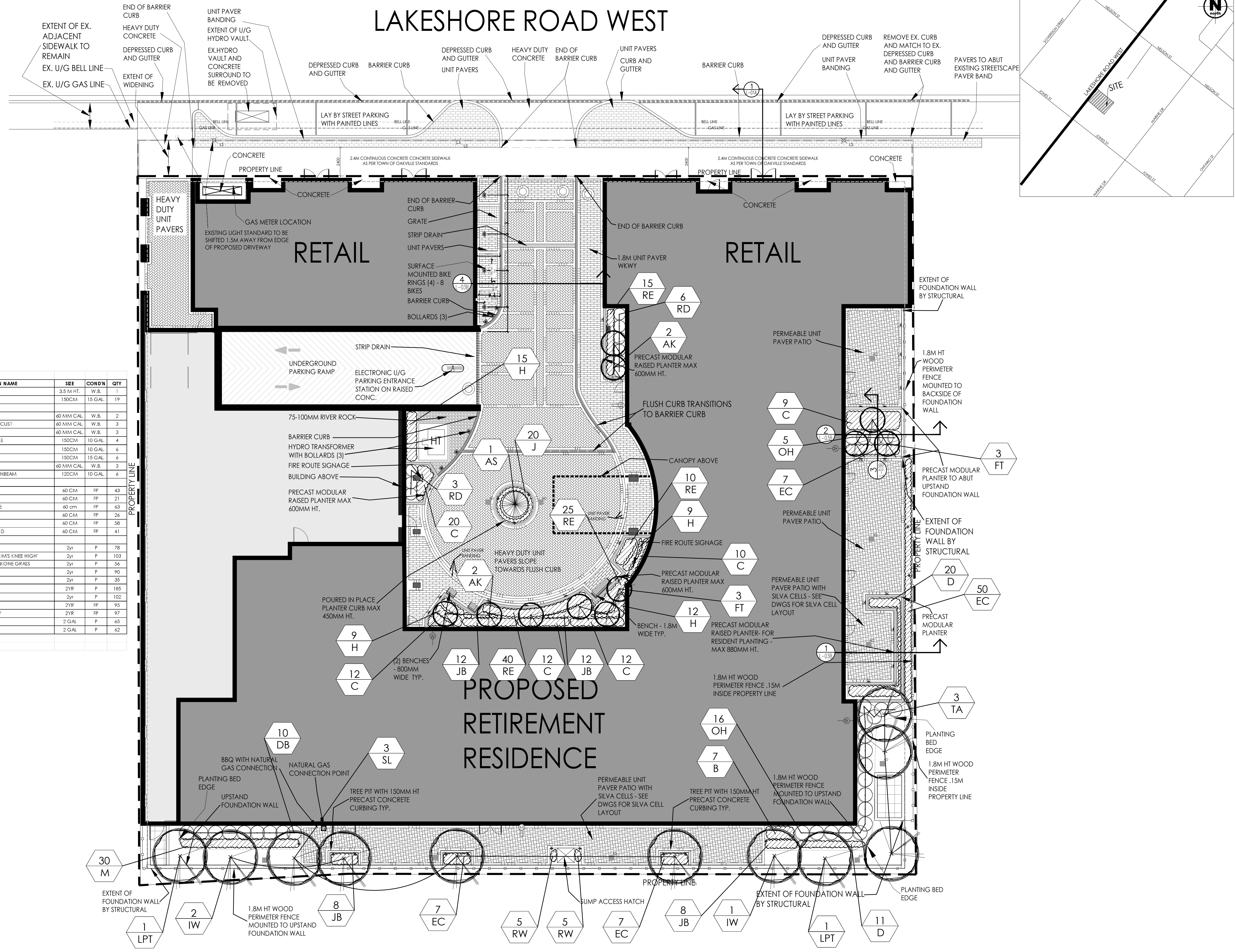
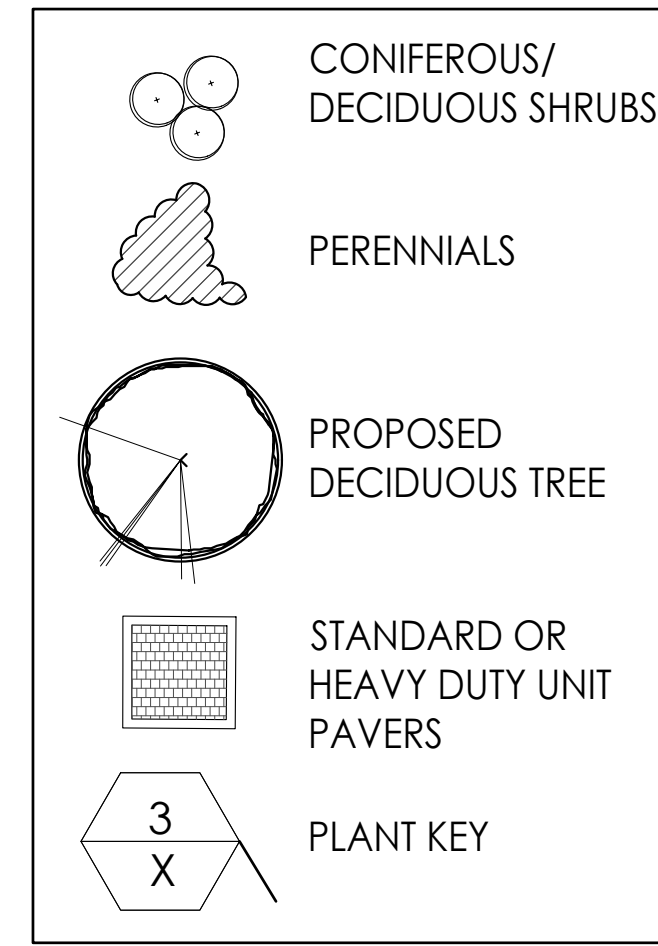

KEY	BOTANICAL NAME	COMMON NAME	SIZE	COND'N	QTY
AS	PICEA ABIES 'ACROCONA'	ACROCONASPRUCE	3.5 M HT.	W.B.	1
TO	THUJA OCCIDENTALIS 'EMERALD'	EMERALD CEDAR	150CM	W.B.	19
LPT	LIRIODENDRON TULIPIFERA	LONDON PLANE TREE	60 MM CAL.	W.B.	2
SL	GLEDITSIA TRIACANTHOS 'STREET KEEPER'	STREET KEEPER HONEYLOCUST	60 MM CAL.	W.B.	3
IW	ABSCULLUS X CARNEA 'BROTII'	RED HORSE CHESTNUT	60 MM CAL.	W.B.	3
AK	ACER PALMATHUM 'KATSURAI'	KATSURAI JAPANESE MAPLE	150CM	10 GAL.	4
FT	CHIONANTHUS VIRGINICUS	FRINGETREE	150CM	10 GAL.	6
MS	MAGNOLIA X SUSAN	SUSAN MAGNOLIA	150CM	15 GAL.	6
TA	TILIA CORDATA	LITTLE LEAF LINDEN	60 MM CAL.	W.B.	3
DCH	CARPINUS BETULUS 'COLUMNARIS NANA'	DWARF COLUMNAR HORNBEAM	120CM	10 GAL.	6
RD	CORNUS STOLONIFERA	RED OSIER DOGWOOD	60 CM	FP	43
OH	HYDRANGEA QUERCIFOLIA	OAKLEAF HYDRANGEA	60 CM	FP	21
MO	PHILADELPHUS CORONARIUS 'AUREUS'	GOLDEN MOCK ORANGE	60 cm	FP	63
DB	EUONYMUS ALATUS COMPACTUS	DWARF BURNING BUSH	60 CM	FP	26
CY	TAXUS CANADENSIS	CANADIAN YEW	60 CM	FP	58
YD	CORNUS SERICEA FLAVIRMEA	YELLOWTWIG DOGWOOD	60 CM	FP	41
B	HOSTA 'PATRIOT'	HOSTA 'PATRIOT'	2yr	P	78
C	ECHINACEA PURPUREA 'KIMS KNEE HIGH'	PURPLE CONE FLOWER 'KIMS KNEE HIGH'	2yr	P	103
D	HAKONECHLOA MACRA 'AUREOLA'	GOLDEN VARIEGATED HAKONE GRASS	2yr	P	56
H	GERANIUM 'SILVSTEMON' 'ROZANNE'	ROZANNE GERANIUM	2yr	P	90
J	SPIROBOLUS CRYSTANDRUS	SAND DROPSSEED	2yr	P	38
RE	RUDIBECKIA HIRTA	BLACK EYED SUSAN	2yr	P	185
JA	CAREX ELATA 'BOWLES GOLDEN'	BOWLES GOLDEN SEDGE	2yr	P	102
JB	IMPERATA CYLINDRICA 'RUBRA'	JAPANESE BLOODGRASS	2YR	FP	95
EC	HEMEROCALLIS 'ELEGANT CANDY'	ELEGANT CANDY DAYLILY	2YR	FP	97
BB	SCHIZACHYRIUM SCOPARIUM 'BLAZE'	BLAZE LITTLE BLUESTEM	2 GAL	P	65
RW	HAKONECHLOA MACRA 'BENI-KAZE'	RED WIND FOREST GRASS	2 GAL	P	62

WILK ASSOCIATES
LANDSCAPE ARCHITECTURE LTD
 P.O. BOX 142
 1496 SAFARI ROAD
 MILGROVE ON (R1V0)
 T. 905-659-9498
 www.wilkassociates.ca

ALL DRAWINGS ARE THE PROPERTY OF WILK ASSOCIATES. THE CLIENT AGREES TO RETURN UPON REQUEST. THE CONTRACTOR SHALL CHECK ALL DIMENSIONS, SPECIFICATIONS AND NOTES AND REPORT ANY DISCREPANCIES TO THE LANDSCAPE ARCHITECT BEFORE PROCEEDING WITH THE WORK.
DO NOT SCALE DRAWINGS



No.	Date	Revisions
11	OCT 16, 2020	REVISED AS PER COMMENTS
12	NOV 30, 2020	ISSUED FOR BUILDING PERMIT
13	MAY 13, 2022	ISSUED FOR F.A.S.T.
14	MAR 24, 2023	ISSUED FOR CLIENT REVIEW
15	JULY 7, 2023	ISSUED FOR OP/AV/BA SUBMISSION
16	OCT 27, 2023	ISSUED PROGRESS SET
17	OCT 31, 2023	ISSUED FOR SPA
18	DEC 7, 2023	ISSUED FOR SPA
19	FEB 20, 2024	ISSUED FOR SPA
20	MAR 7, 2024	ISSUED FOR TENDER #1
21	APR 11, 2024	ISSUED FOR TENDER #1

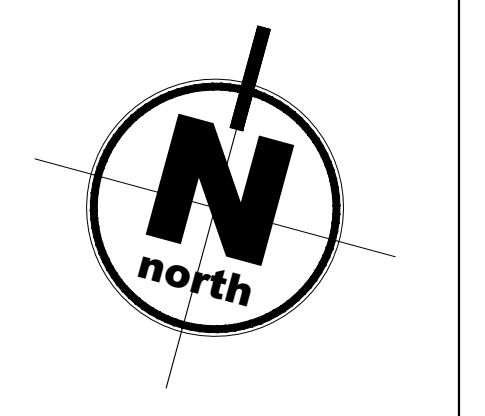

SUCCESSION DEVELOPMENT CORPORATION
 PROPOSED
6 STOREY RETIREMENT RESIDENCE
 2380 LAKESHORE ROAD WEST, OAKVILLE ONTARIO

LANDSCAPE PLANTING PLAN
 SCALE: 1:150
 DATE: MAY 7, 2018
 DRAWN: AW
 PROJECT NUMBER: 180443

NOTE:
 BASE INFORMATION PROVIDED MICHAEL SPAZIANI ARCHITECT INC.
 CIVIL INFORMATION PROVIDED BY THE ODAN/DETECH GROUP INC.
 SURVEY INFORMATION PROVIDED BY CUNNINGHAM MCCONNELL LIMITED ONTARIO LAND SURVEYORS
 SITE ELECTRICAL INFORMATION PROVIDED BY DEI CONSULTING ENGINEERS INC.
 PLANNING CONSULTANT GLEN SCHNARR & ASSOCIATES INC.
 WILK ASSOCIATES LANDSCAPE ARCHITECTURE INC. IS IN NO WAY RESPONSIBLE FOR INFORMATION PROVIDED BY THE AFOREMENTIONED CONSULTANTS

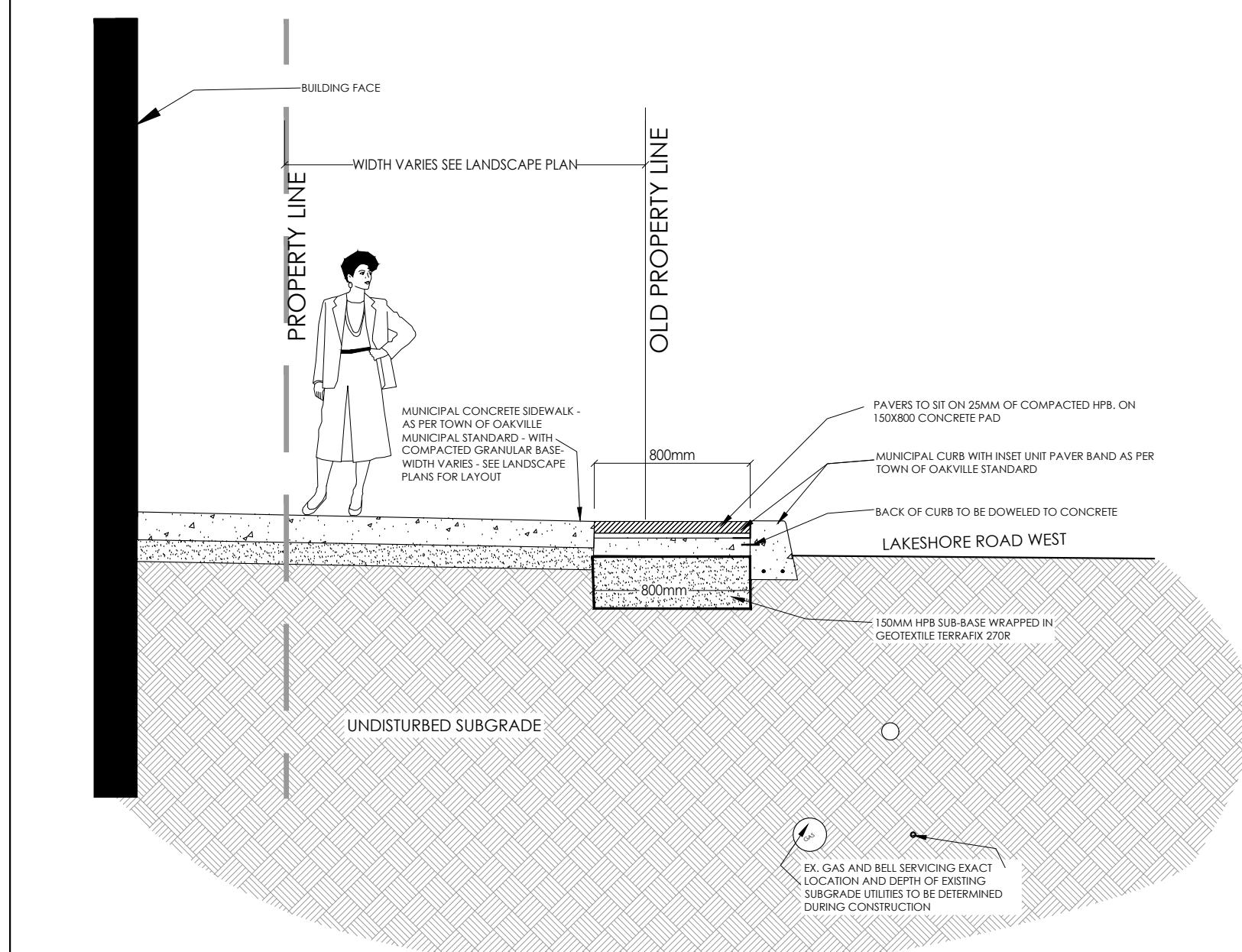

1 L-01A SECTION TYPICAL BOULEVARD CONDITION N.T.S.

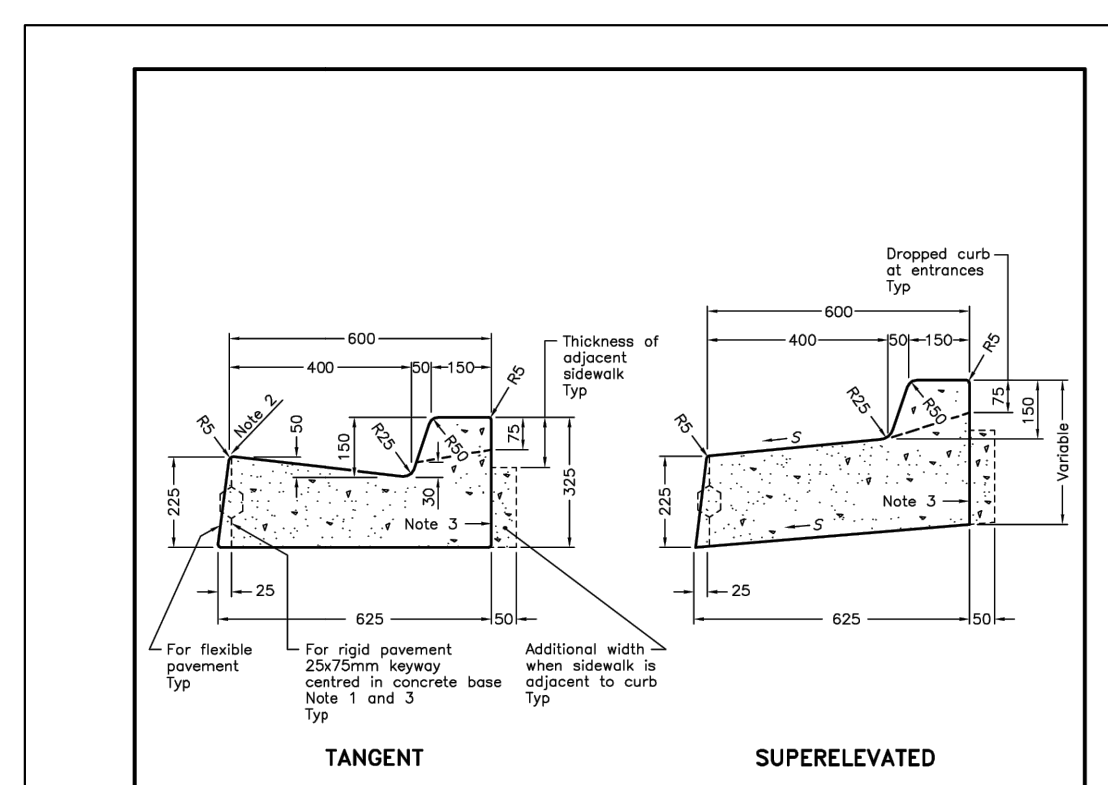

2 L-01A SECTION CONCRETE BARRIER CURB AND GUTTER N.T.S.

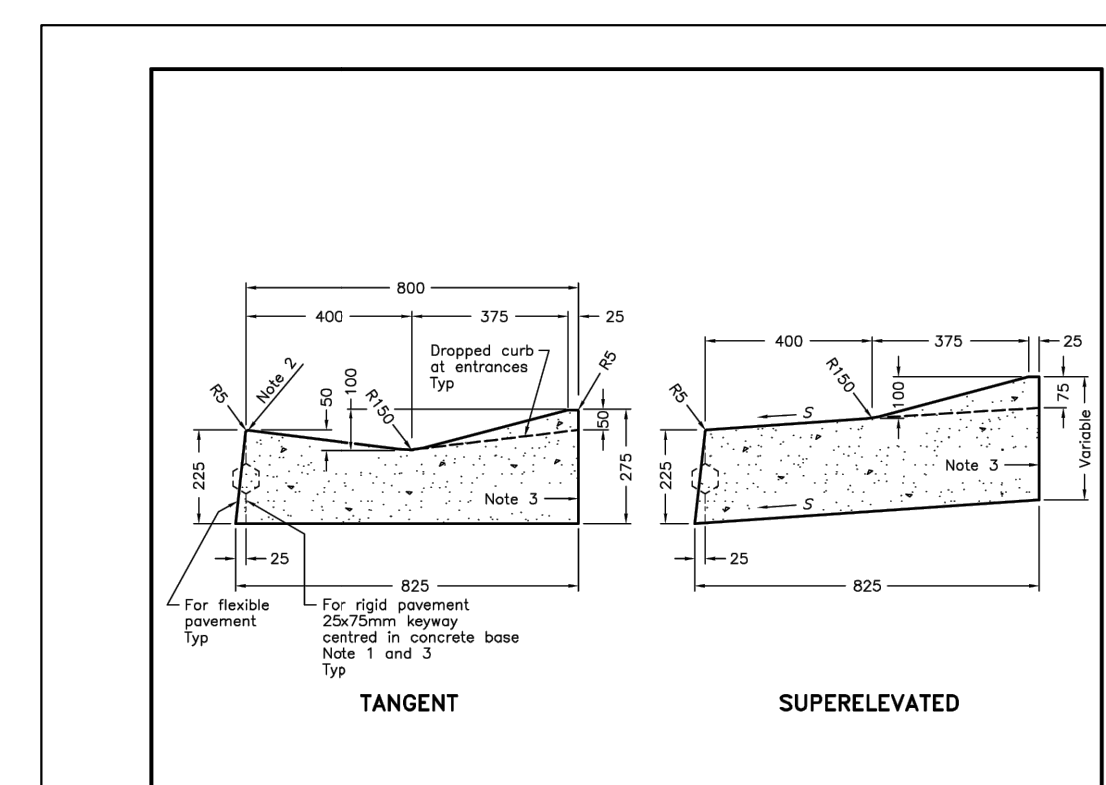

3 L-01A SECTION FLUSH CURB AND GUTTER N.T.S.

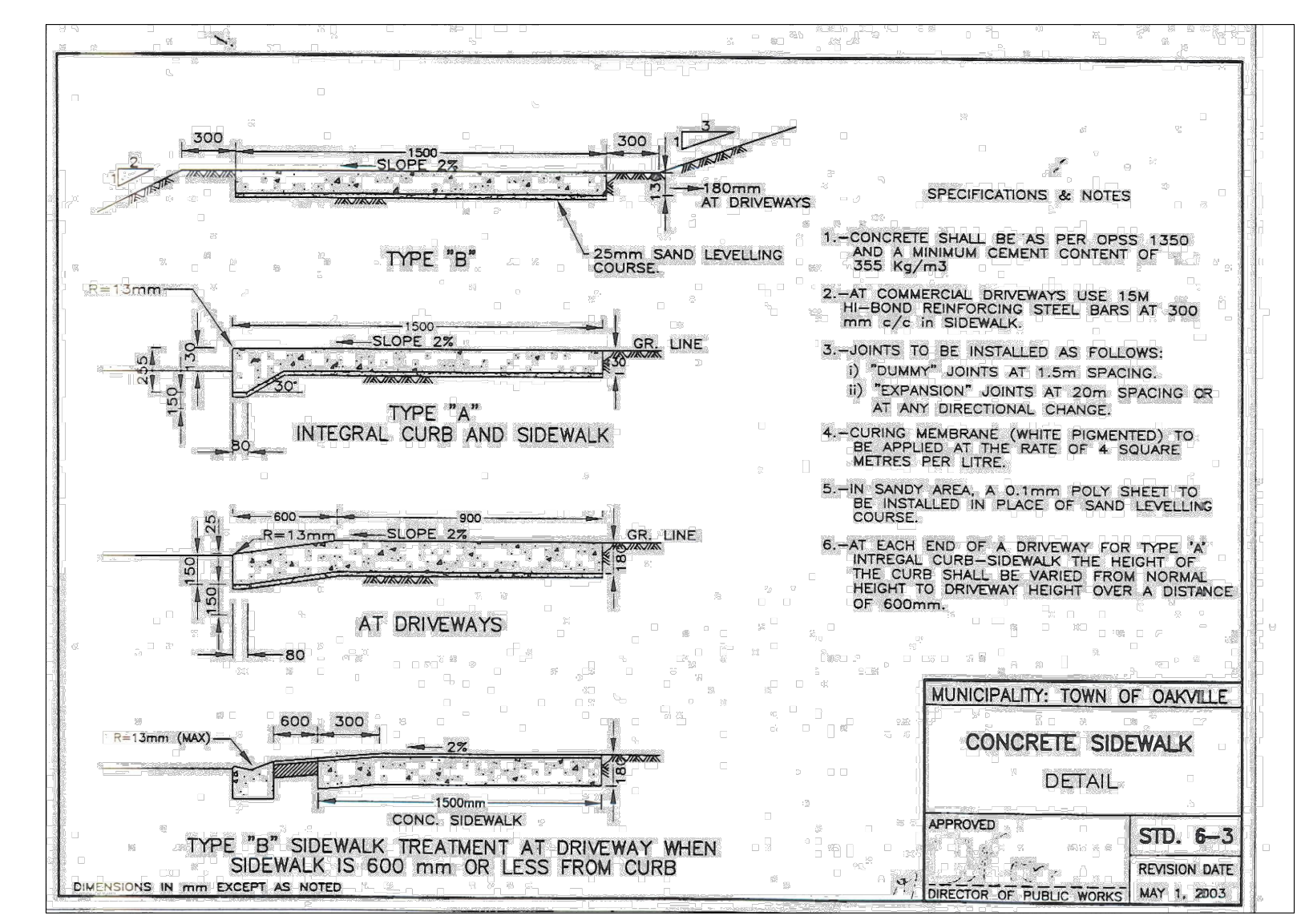

4 L-01A SECTION TYPICAL CONCRETE SIDEWALK N.T.S.

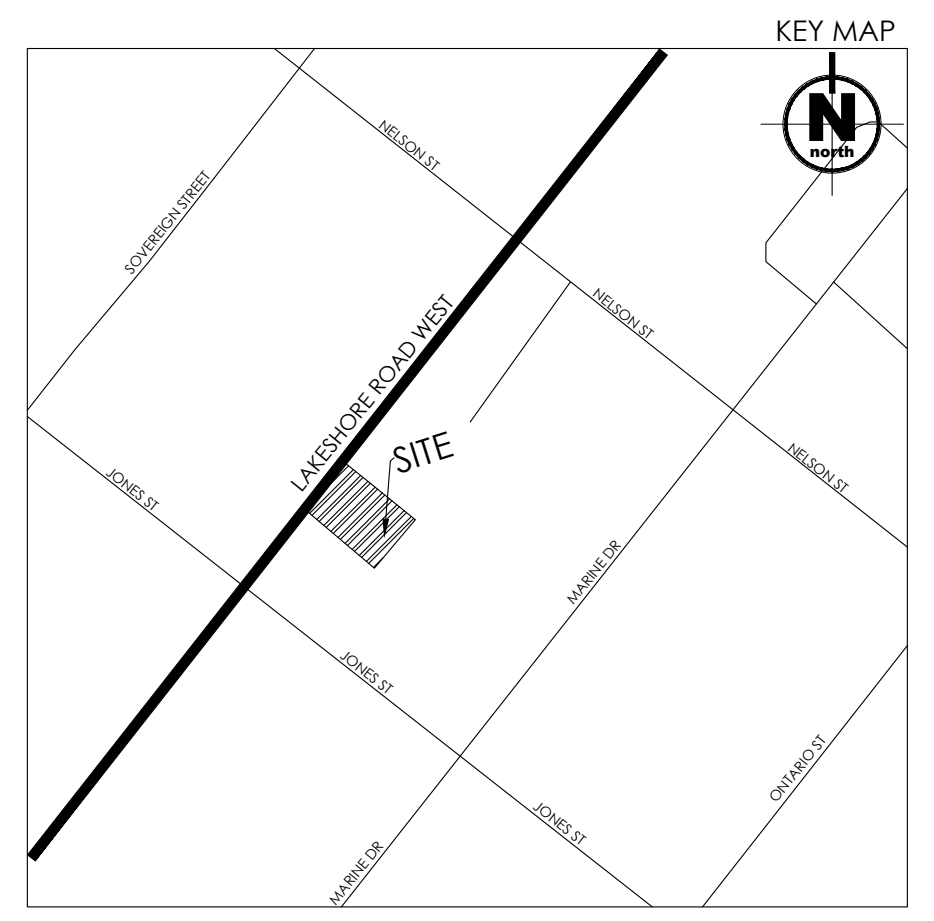

WILK ASSOCIATES
LANDSCAPE ARCHITECTURE LTD
P.O. BOX 142
1496 SAFARI ROAD
MILBROVE ON L3R1V0
T: 905-659-9489
www.wilkassociates.ca

ALL DRAWINGS ARE THE PROPERTY OF WILK ASSOCIATES. THE CLIENT MUST RETURN TO THE ARCHITECT UPON REQUEST. THE CONTRACTOR SHALL CHECK ALL DIMENSIONS, SPECIFICATIONS AND NOTES AND REPORT ANY DISCREPANCIES TO THE LANDSCAPE ARCHITECT BEFORE PROCEEDING WITH THE WORK.
DO NOT SCALE DRAWINGS

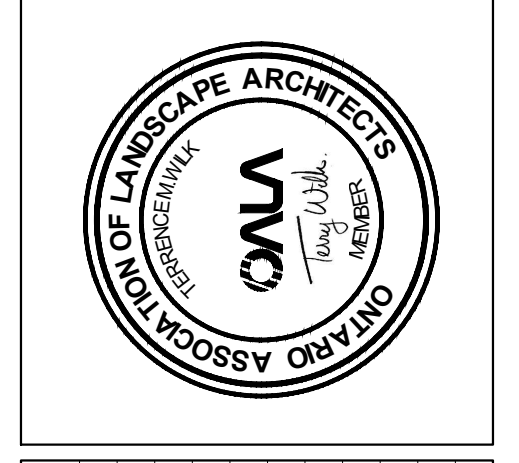

No.	Date	Revisions
11	OCT 16, 2020	REVISED AS PER COMMENTS
12	NOV 30, 2020	ISSUED FOR BUILDING PERMIT
13	MAY 13, 2021	ISSUED FOR F&T
14	MAR 24, 2023	ISSUED FOR CLIENT REVIEW
15	JULY 7, 2023	ISSUED FOR OPA/BA SUBMISSION
16	OCT 27, 2023	ISSUED PROGRESS SET
17	OCT 31, 2023	ISSUED FOR SPA
18	DEC 7, 2023	ISSUED FOR PERM
19	FEB 20, 2024	ISSUED FOR SPA
20	MAR 7, 2024	ISSUED FOR TENDER #1
21	APR 11, 2024	ISSUED FOR TENDER #1

LAKESHORE ROAD WEST

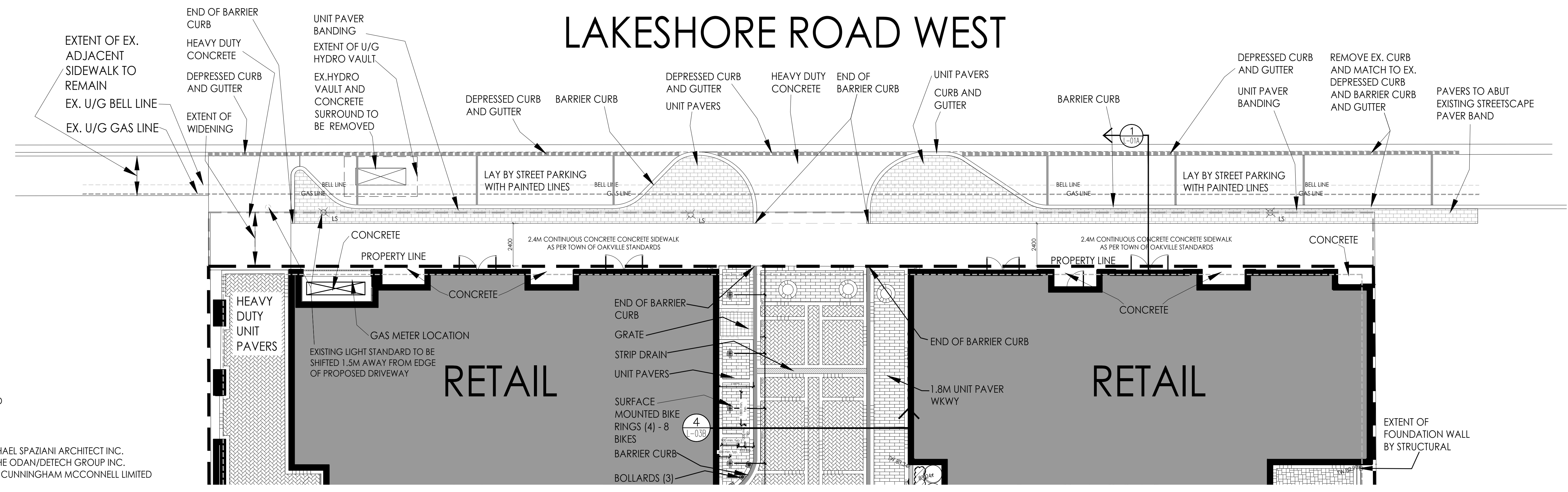

STREETSCAPE NOTE:
STREETSCAPE WORKS ARE TO THE SATISFACTION OF TOWN STAFF IN TRANSPORTATION ENGINEERING AND PLANNING SERVICES.

NOTE:
BASE INFORMATION PROVIDED MICHAEL SPAZIANI ARCHITECT INC.
CIVIL INFORMATION PROVIDED BY THE ODAN/DETECH GROUP INC.
SURVEY INFORMATION PROVIDED BY CUNNINGHAM MCCONNELL LIMITED ONTARIO LAND SURVEYORS
SITE ELECTRICAL INFORMATION PROVIDED BY DEI CONSULTING ENGINEERS INC.
PLANNING CONSULTANT GLEN SCHNARR & ASSOCIATES INC.

WILK ASSOCIATES LANDSCAPE ARCHITECTURE INC. IS IN NO WAY RESPONSIBLE FOR INFORMATION PROVIDED BY THE AFOREMENTIONED CONSULTANTS

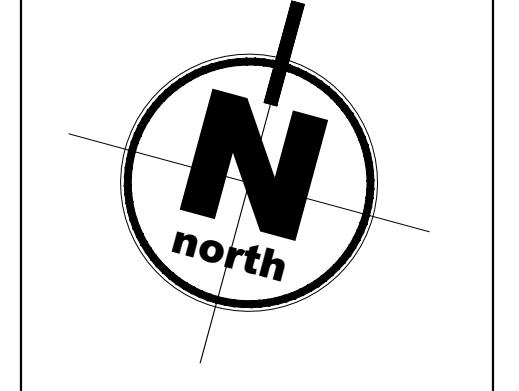

SUCCESSION DEVELOPMENT CORPORATION
PROPOSED
6 STOREY RETIREMENT RESIDENCE
2380 LAKESHORE ROAD WEST, OAKVILLE ONTARIO

STREETSCAPE PLAN
SCALE: 1:125
DATE: MAY 7, 2018
DRAWN: AW
PROJECT NUMBER: 180443
L-01A

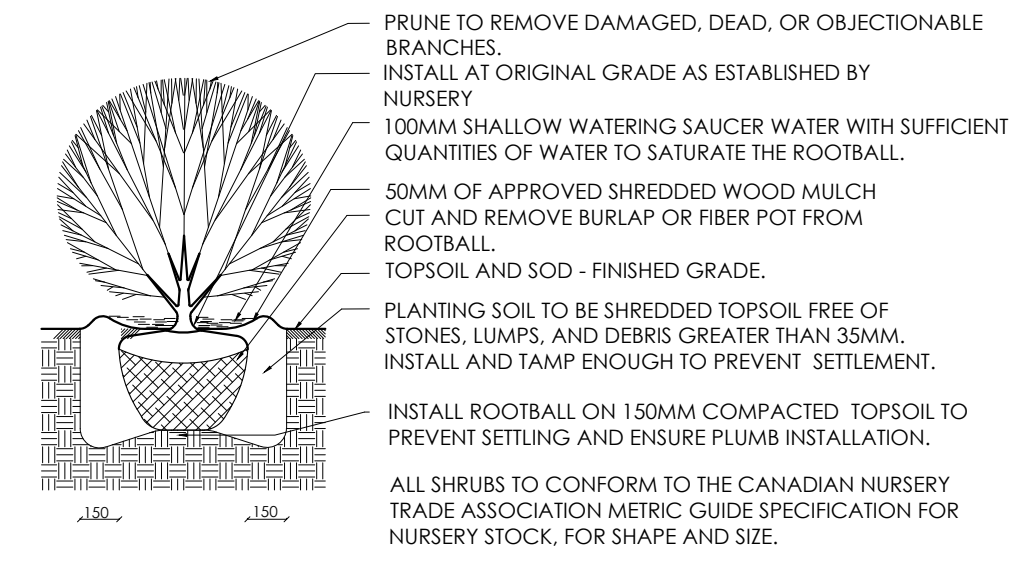

1 TYPICAL SHRUB PLANTING DETAIL N.T.S.

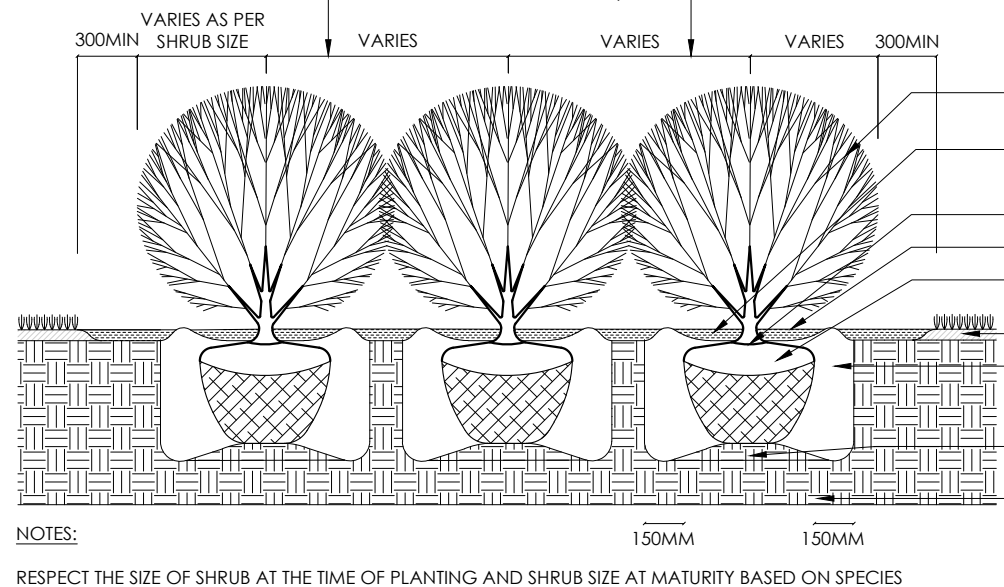

2 TYPICAL SHRUB AND LAYOUT GUIDELINES N.T.S.

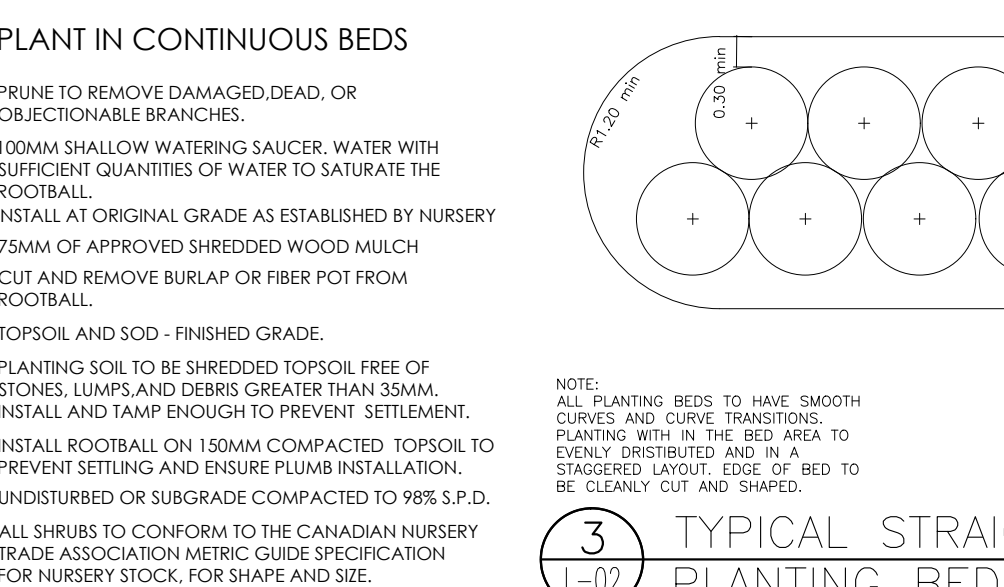

3 TYPICAL STRAIGHT SHRUB AND PLANTING BED LAYOUT N.T.S.

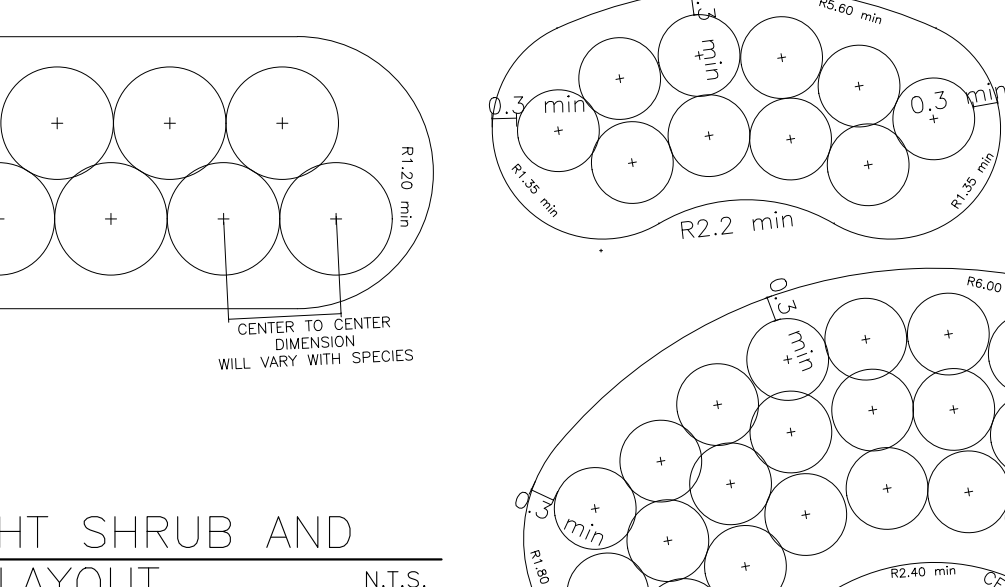

4 TYPICAL CURVED SHRUB AND PLANTING BED LAYOUT N.T.S.

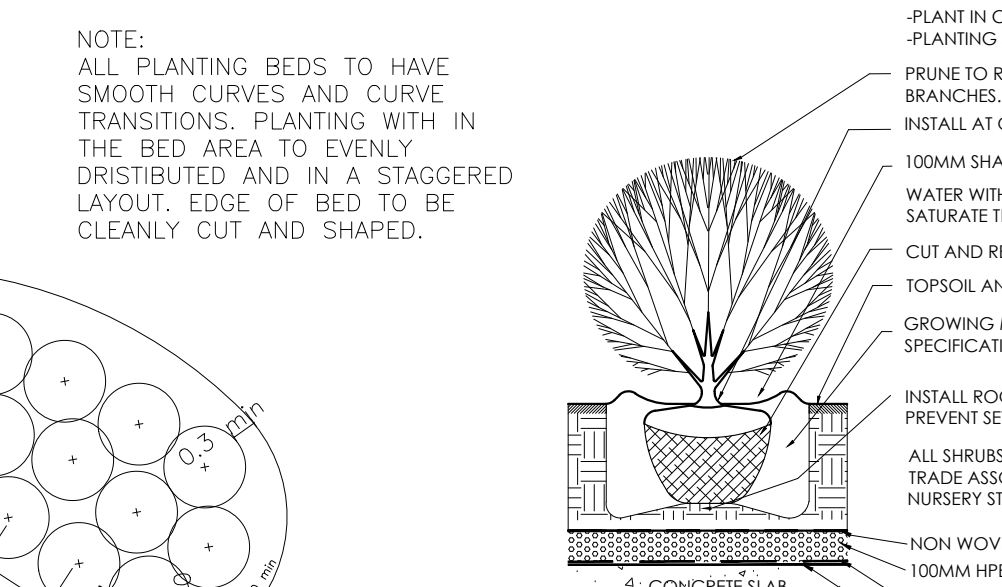

5 TYPICAL SHRUB ON CONCRETE ROOF SLAB N.T.S.

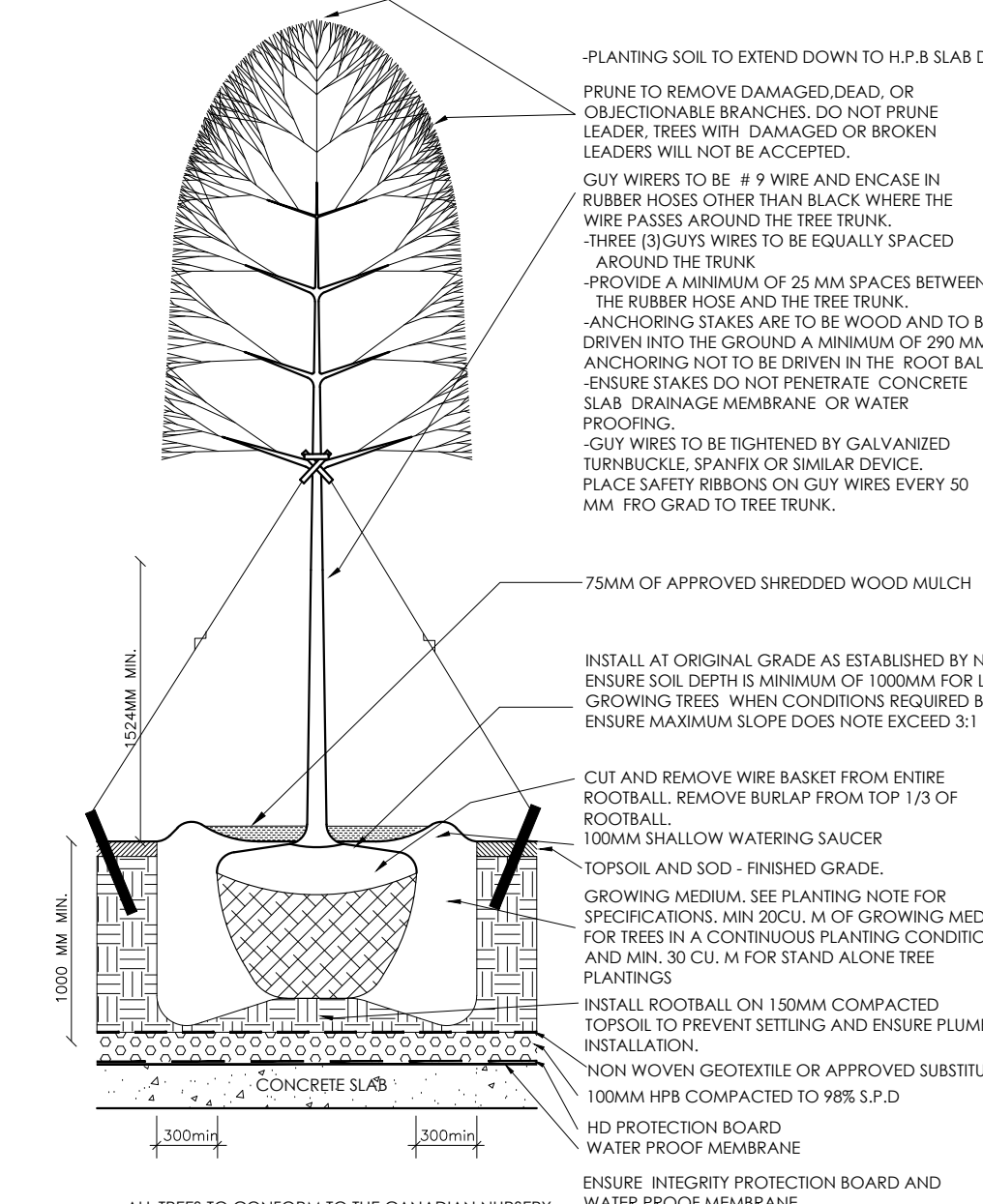

6 TYPICAL DECIDUOUS TREE ON CONCRETE ROOF SLAB N.T.S.

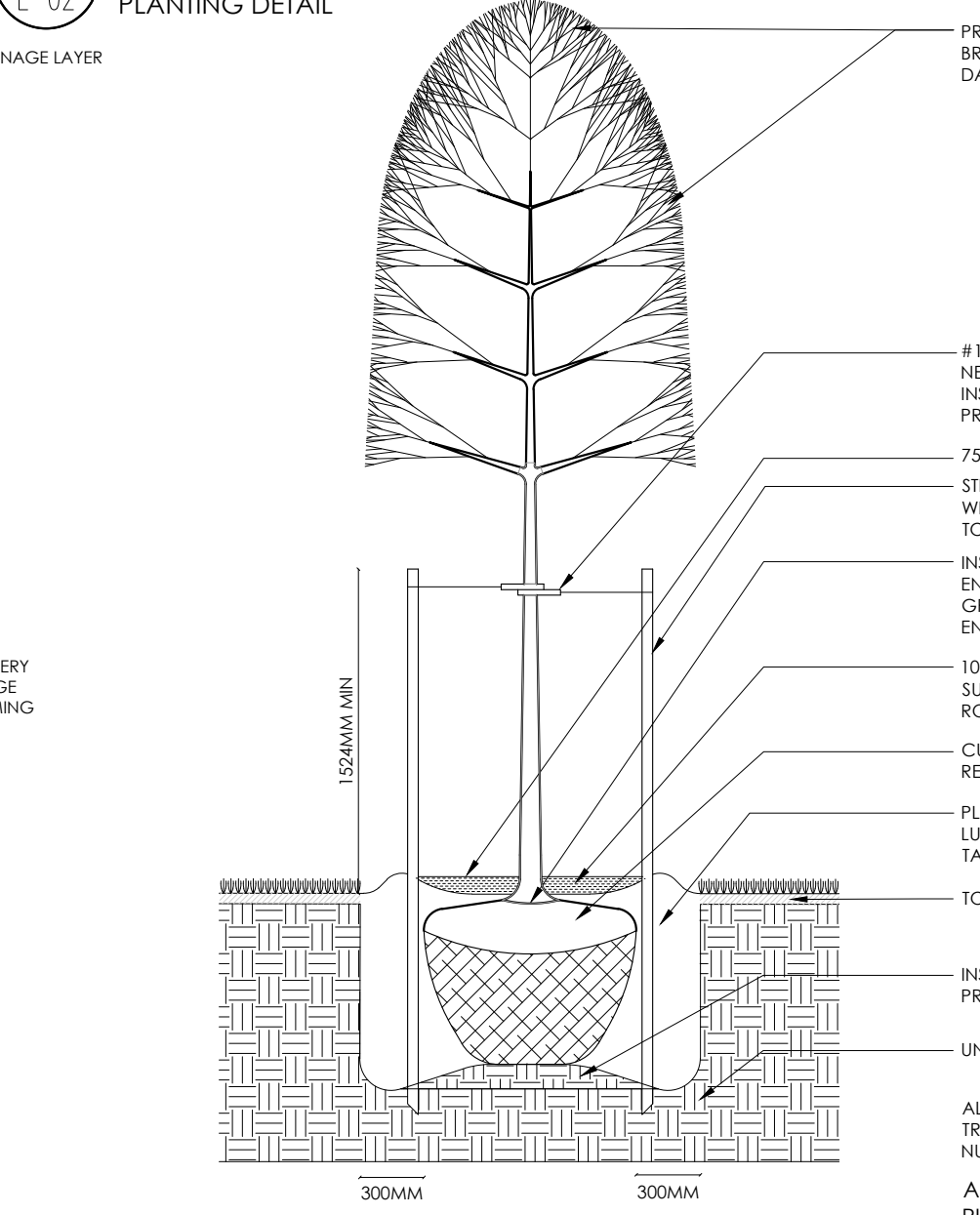

7 TYPICAL DECIDUOUS TREE N.T.S.

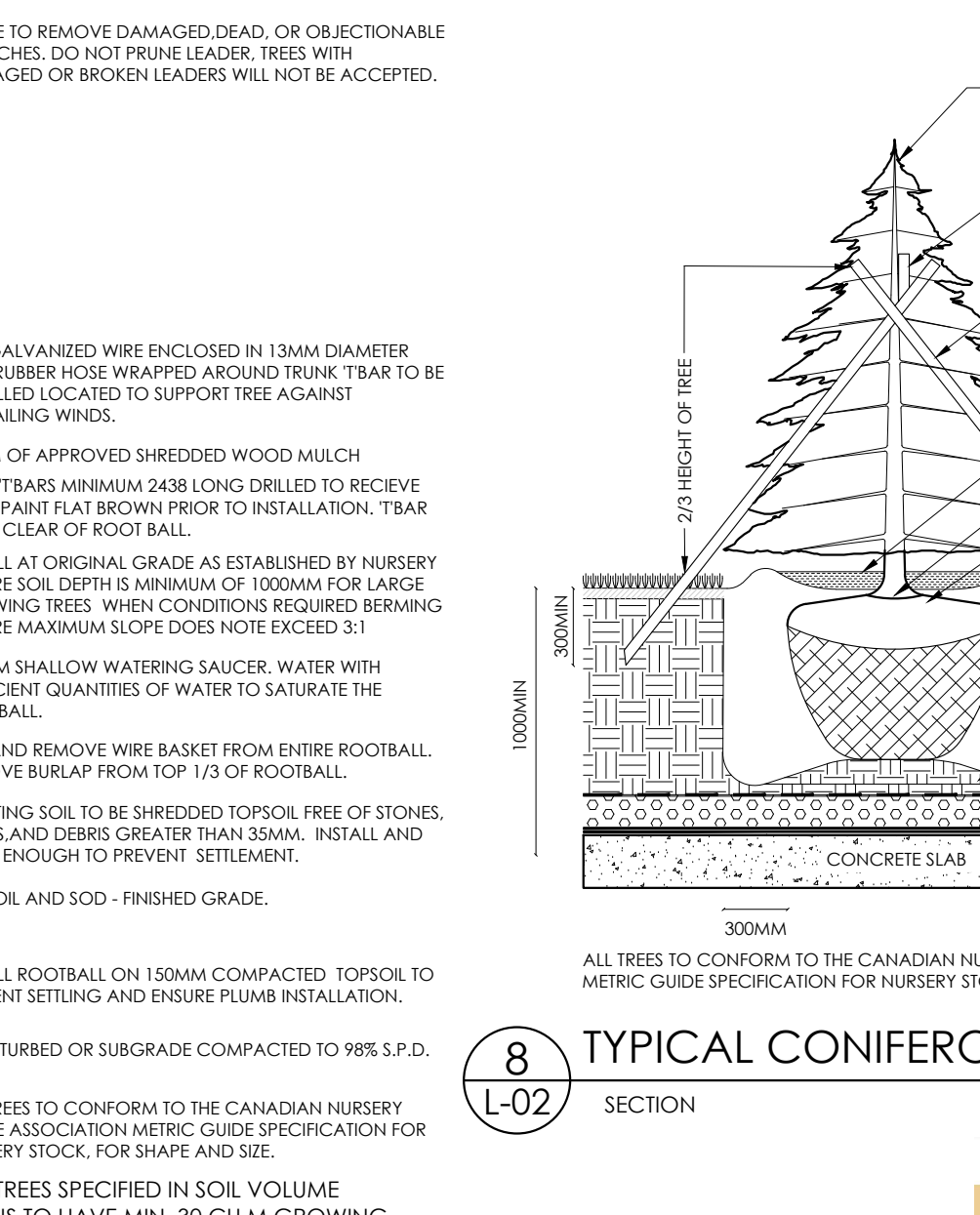

8 TYPICAL CONIFEROUS TREE ON CONCRETE ROOF SLAB N.T.S.

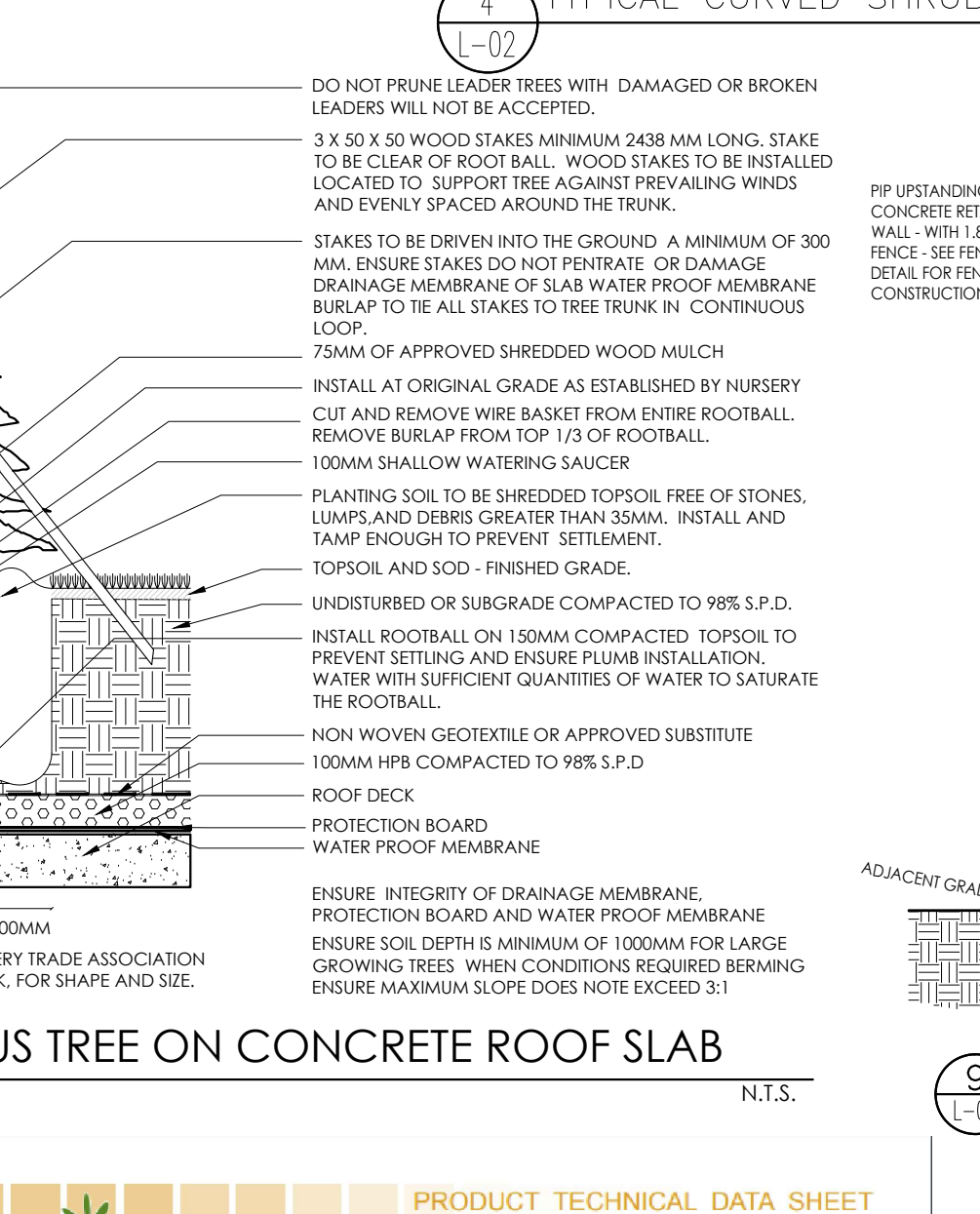

9 REAR YARD CROSS SECTION N.T.S.

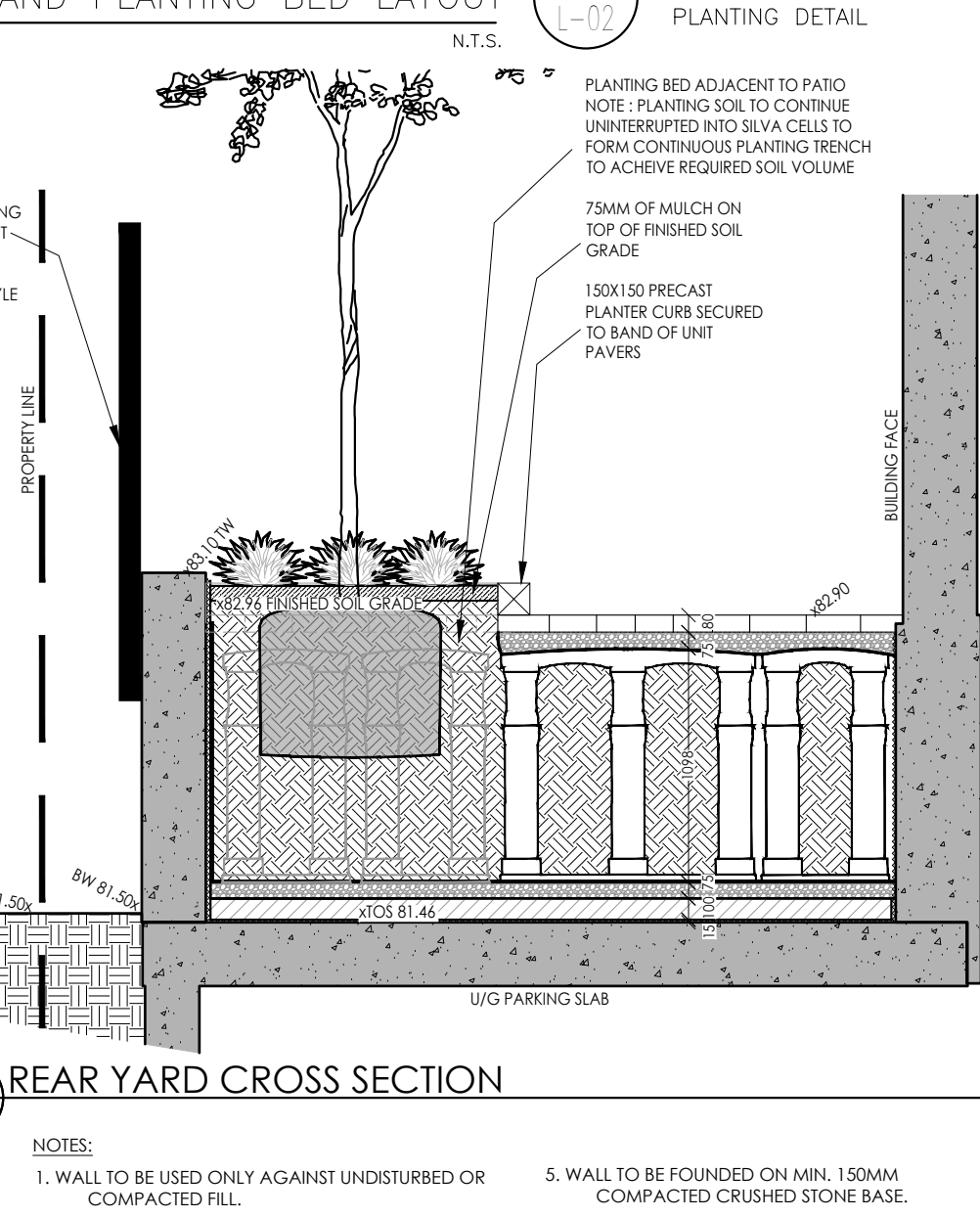

10 REAR YARD CROSS SECTION N.T.S.

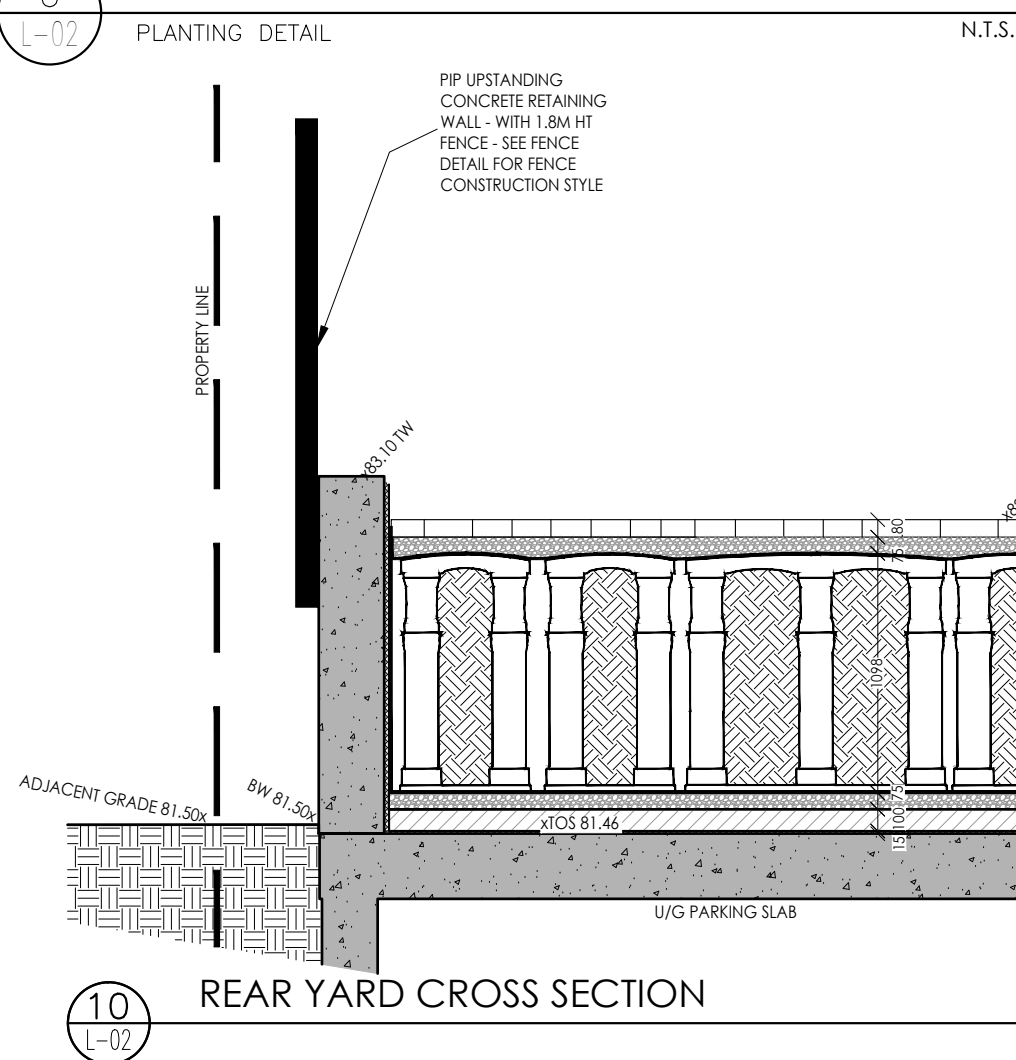

11 REAR YARD CROSS SECTION N.T.S.

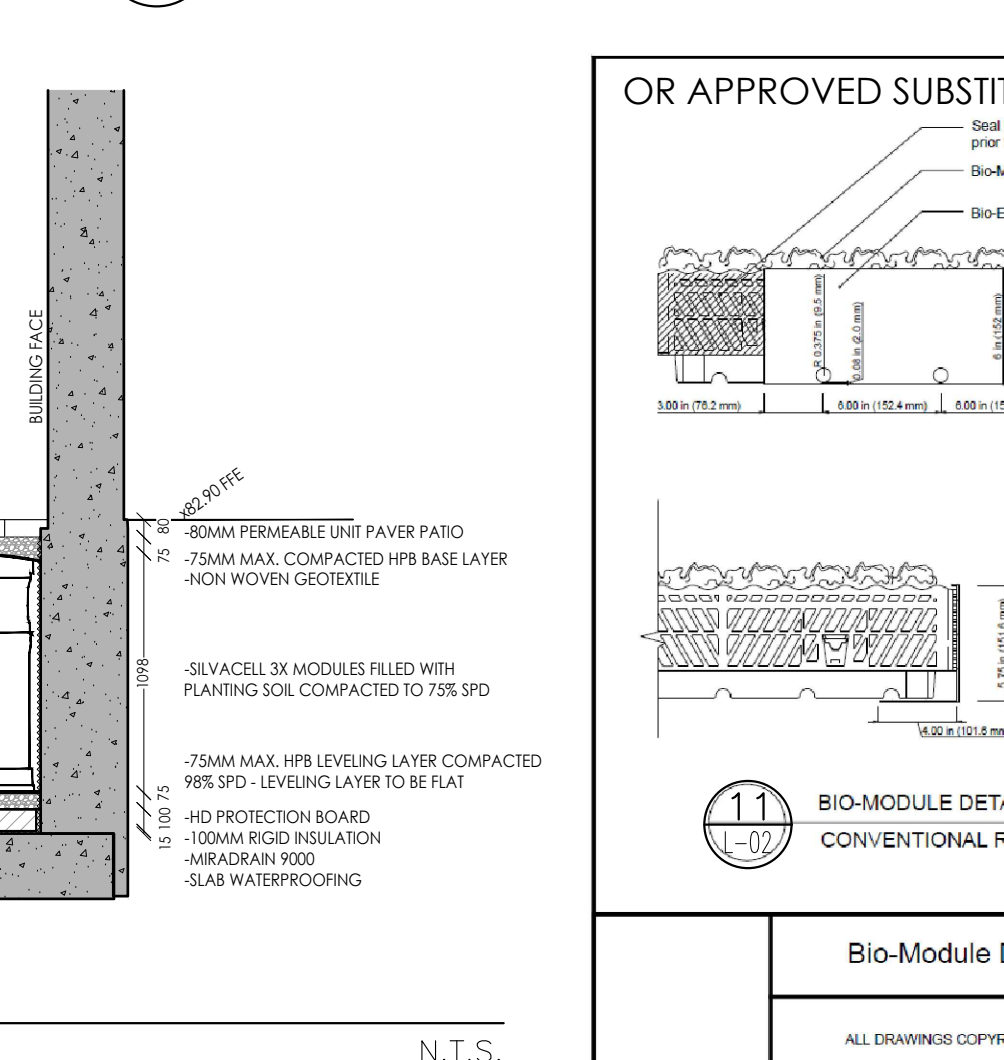

12 BIO-MODULE DETAILS CONVENTIONAL ROOFS N.T.S.

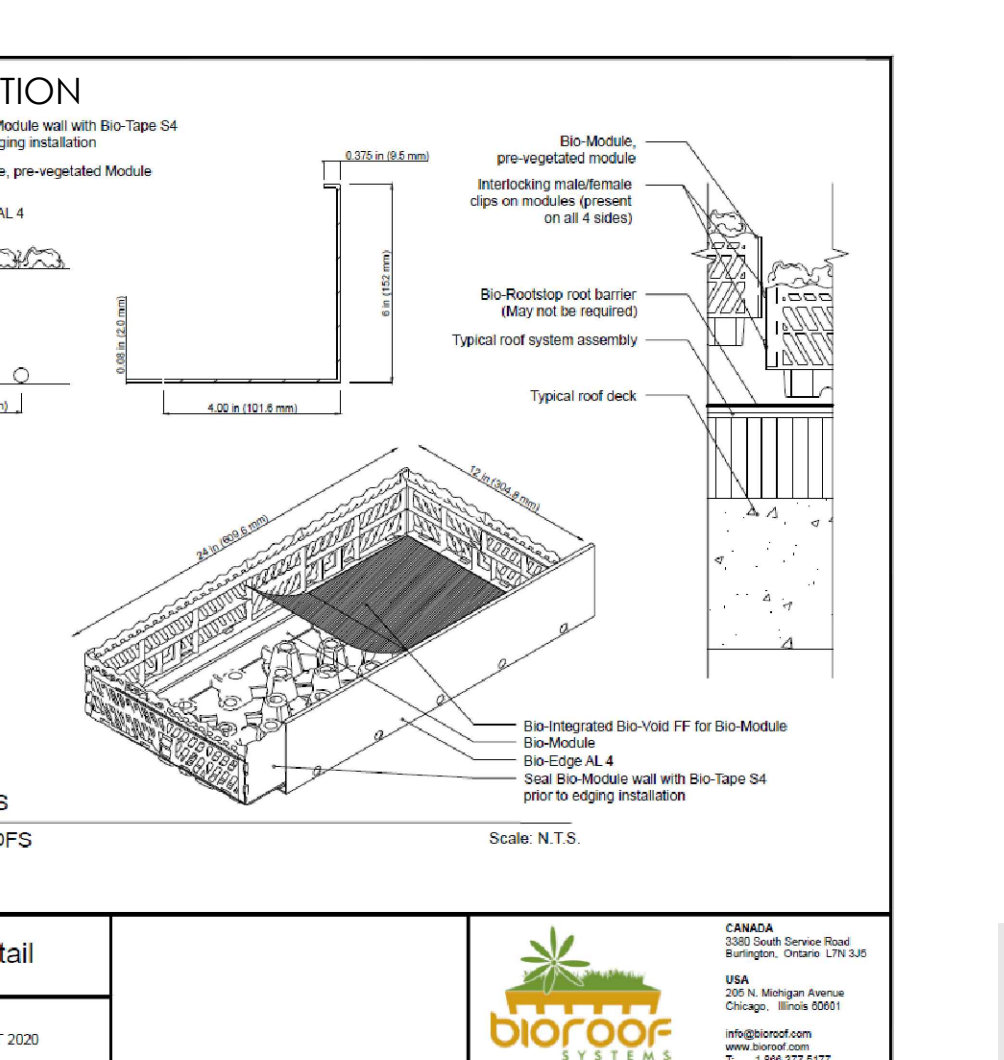

13 BIO-MODULE DETAILS N.T.S.

PRODUCT TECHNICAL DATA SHEET

BIO-MODULE 4

OR APPROVED SUBSTITUTION

PRODUCT DESCRIPTION

Three dimensional and integrating looking clips, filter fabric, growth media and vegetation to form an integrated modular green roof system.

Options

Standard and custom plant mixes available. Option to order modules with integrated rotary irrigation.

PRODUCT PROPERTIES

Materials

- 100% recycled high density polypropylene empty module.
- 100% recycled non-woven filter fabric.
- 100% recycled growth media blend.

Water Capacity

Vegetated Module: ~60 L/m² (1.7 gal/ft²)

Empty Module: 11.9 L/m² (0.29 gal/ft²)

Dimensions

304.8 mm x 609.6 mm x 149 mm (12 in x 24 in x 5.75 in)

Area

0.165 m² (2 ft²)

Thickness

nom 2.54 mm (100 mil) with 0.52 mm (20 mil) reinforcement

Weight

Maximum: ~176 kg/m² (36 lb/ft²)

Minimum: ~108 kg/m² (22 lb/ft²)

Shipping: ~137 kg/m² (28 lb/ft²)

Empty Module: ~6 kg/m² (1.28 lb/ft²)

Compressive Strength

302 kN/m² (7064 lb/ft²)

LOCAL REP

KEN MCGOWAN

TEL: 866 377 5177

CELL: 905 975 1721

EMAIL: KEN@BIOROOF.COM

14 PRECAST INTERLOCKING RETAINING WALL PLANTER ON CONCRETE SLAB DECK N.T.S.

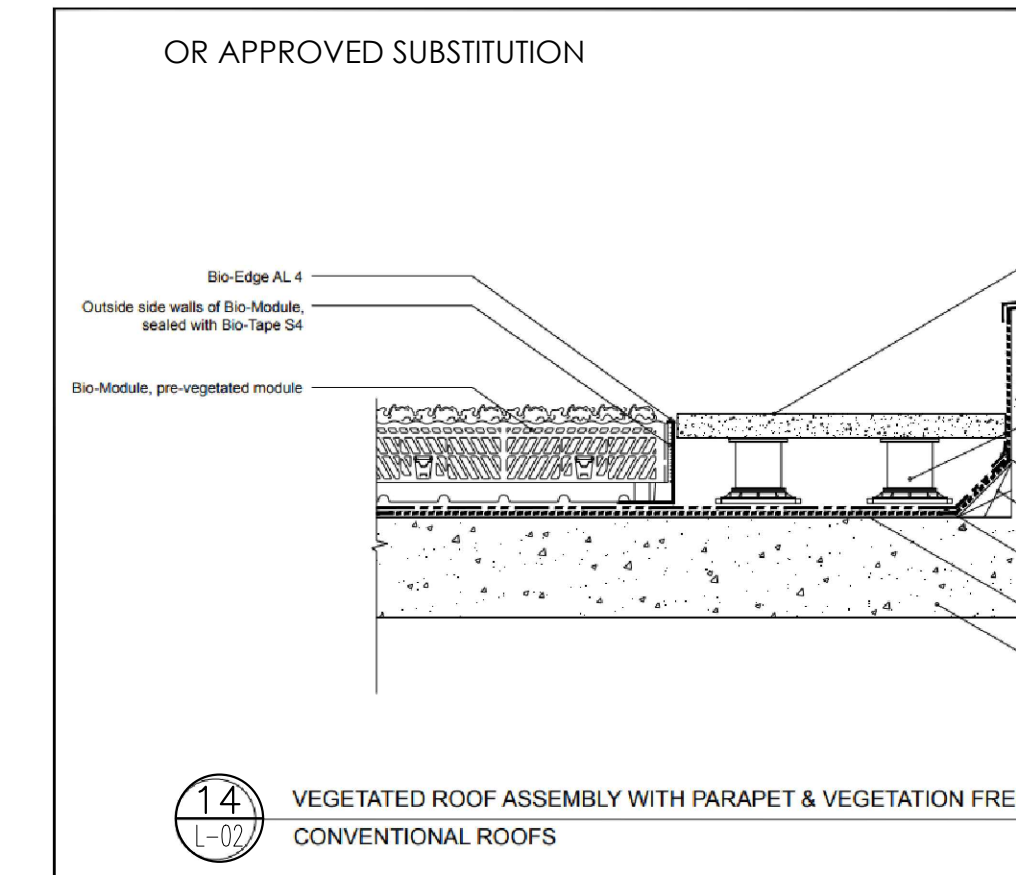

14 VEGETATED ROOF ASSEMBLY WITH PARAPET & VEGETATION FREE ZONE CONVENTIONAL ROOFS Scale: 1:10

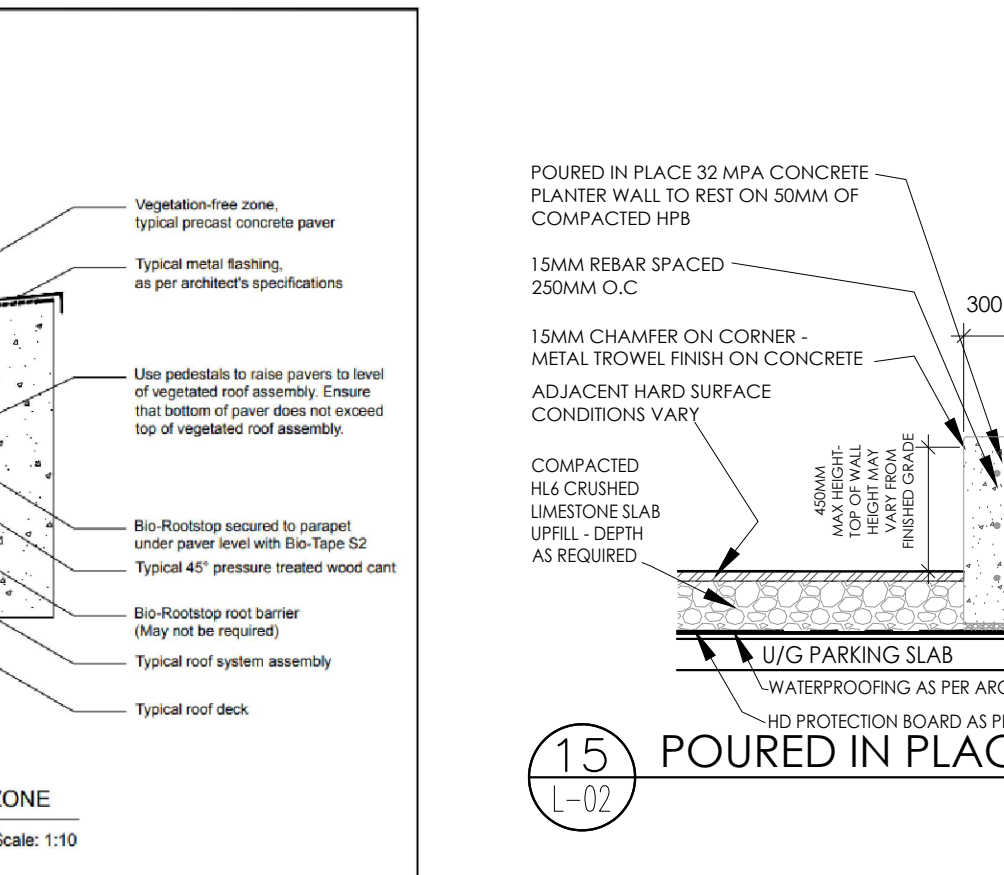

15 POURED IN PLACE CONCRETE PLANTERS N.T.S.

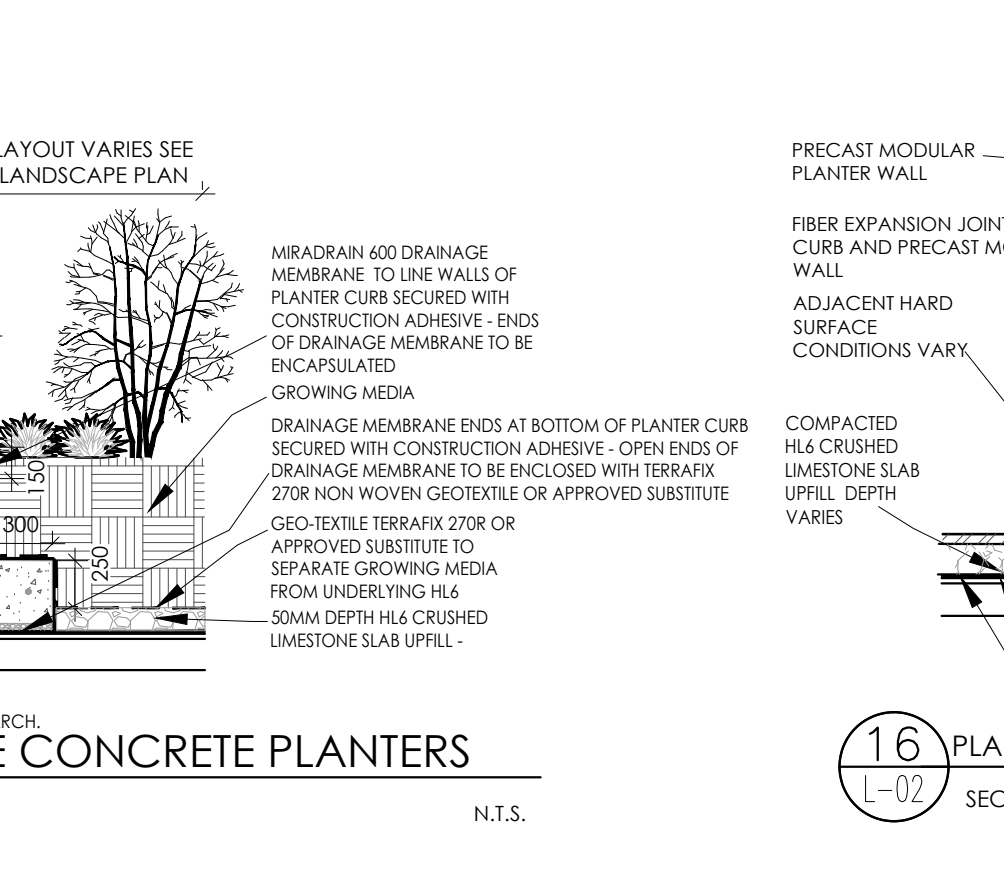

16 PLANTER WALL AND FINISHED HARD SURFACE INTERACTION N.T.S.

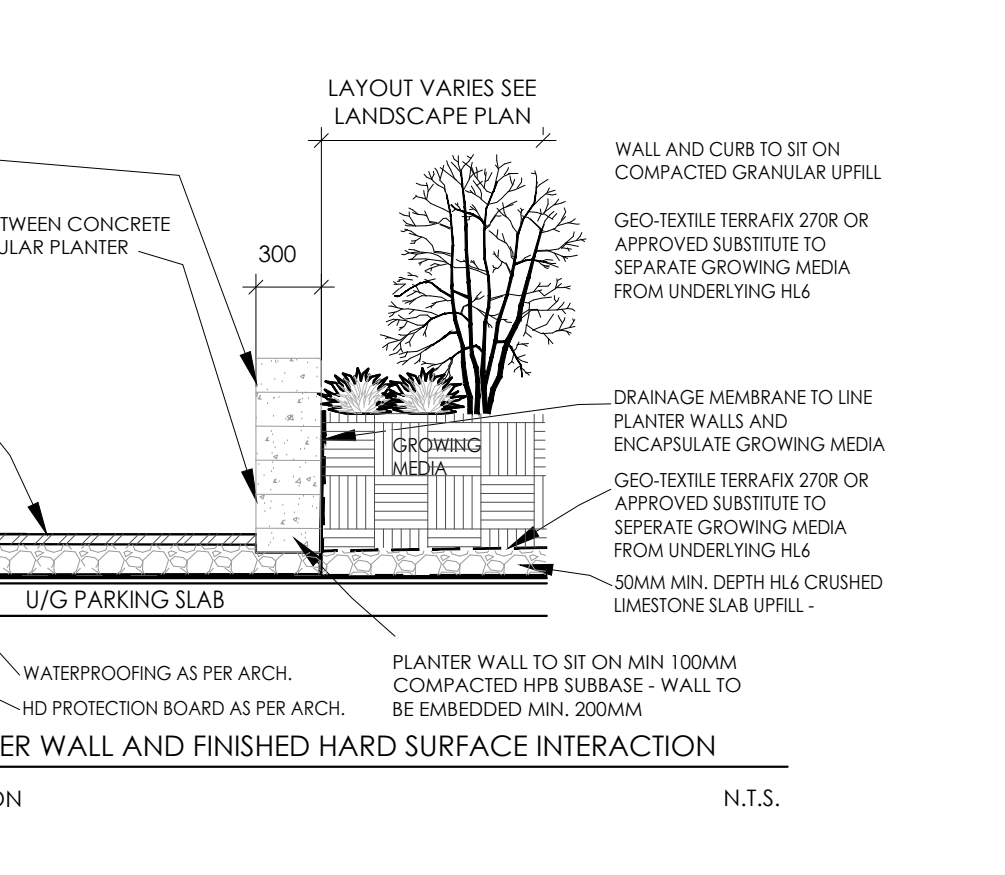

17 PLANTER WALL AND FINISHED HARD SURFACE INTERACTION N.T.S.

Bio-Module Detail

ALL DRAWINGS COPYRIGHT 2020

bioROOF SYSTEMS

USA: 2025 Michigan Avenue Chicago, Illinois 60607

Canada: 2380 South Service Road Burlington, Ontario L7R 3J5

www.bioroof.com

Bio-Module Detail

ALL DRAWINGS COPYRIGHT 2020

bioROOF SYSTEMS

USA: 2025 Michigan Avenue Chicago, Illinois 60607

Canada: 2380 South Service Road Burlington, Ontario L7R 3J5

www.bioroof.com

Bio-Module Detail

ALL DRAWINGS COPYRIGHT 2020

bioROOF SYSTEMS

USA: 2025 Michigan Avenue Chicago, Illinois 60607

Canada: 2380 South Service Road Burlington, Ontario L7R 3J5

www.bioroof.com

Bio-Module Detail

ALL DRAWINGS COPYRIGHT 2020

bioROOF SYSTEMS

USA: 2025 Michigan Avenue Chicago, Illinois 60607

Canada: 2380 South Service Road Burlington, Ontario L7R 3J5

www.bioroof.com

WILK ASSOCIATES

LANDSCAPE ARCHITECTURE LTD

P.O. BOX 142
1495 SAFARI ROAD
MILGROVE ON (Q1V0)
T: 905-609-9489
www.wilkassociates.ca

ALL DRAWINGS ARE THE PROPERTY OF WILK ASSOCIATES AND MUST BE RETURNED UPON REQUEST. THE CONTRACTOR SHALL CHECK ALL DIMENSIONS, SPECIFICATIONS AND NOTES AND REPORT ANY DISCREPANCIES TO THE LANDSCAPE ARCHITECT BEFORE PROCEEDING WITH THE WORK.

DO NOT SCALE

DRAWINGS

ASSOCIATION OF LANDSCAPE ARCHITECTS

ALA

MEMBER

No.	Date	Revisions
11	OCT 16, 2020	REVISED AS PER COMMENTS
12	NOV 20, 2020	REVISED AS PER COMMENTS
13	MAY 13, 2022	ISSUED FOR PERMITS
14	MAR 24, 2023	ISSUED FOR CLIENT REVIEW
15	JULY 7, 2023	ISSUED FOR CIVILIAN SUBMISSION
16	OCT 07, 2023	ISSUED FOR PERMITS
17	OCT 31, 2023	ISSUED FOR PERMITS
18	DEC 7, 2023	ISSUED FOR PERMITS
19	FEB 20, 2024	ISSUED FOR PERMITS
20	MAR 2, 2024	ISSUED FOR TENDER #1
21	APR 11, 2024	ISSUED FOR TENDER #1

SUCCESSION DEVELOPMENT CORPORATION

PROPOSED

6 STOREY RETIREMENT RESIDENCE

2380 LAKESHORE ROAD WEST, OAKVILLE ONTARIO

LANDSCAPE PLANTING DETAILS

SCORE: N.T.S.

DATE: MAY 7, 2018

DRAWN: AW

PROJECT NUMBER: 180443

L-02

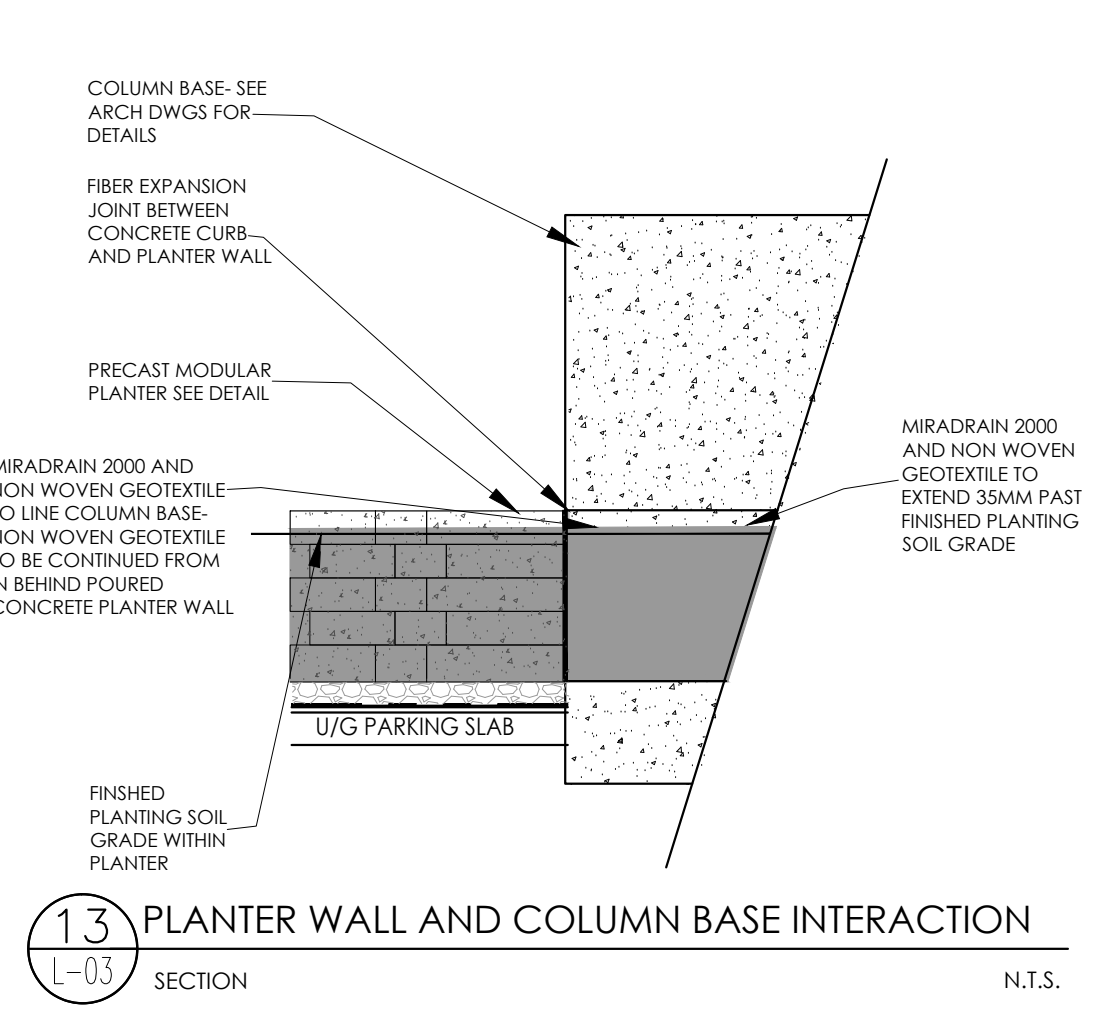
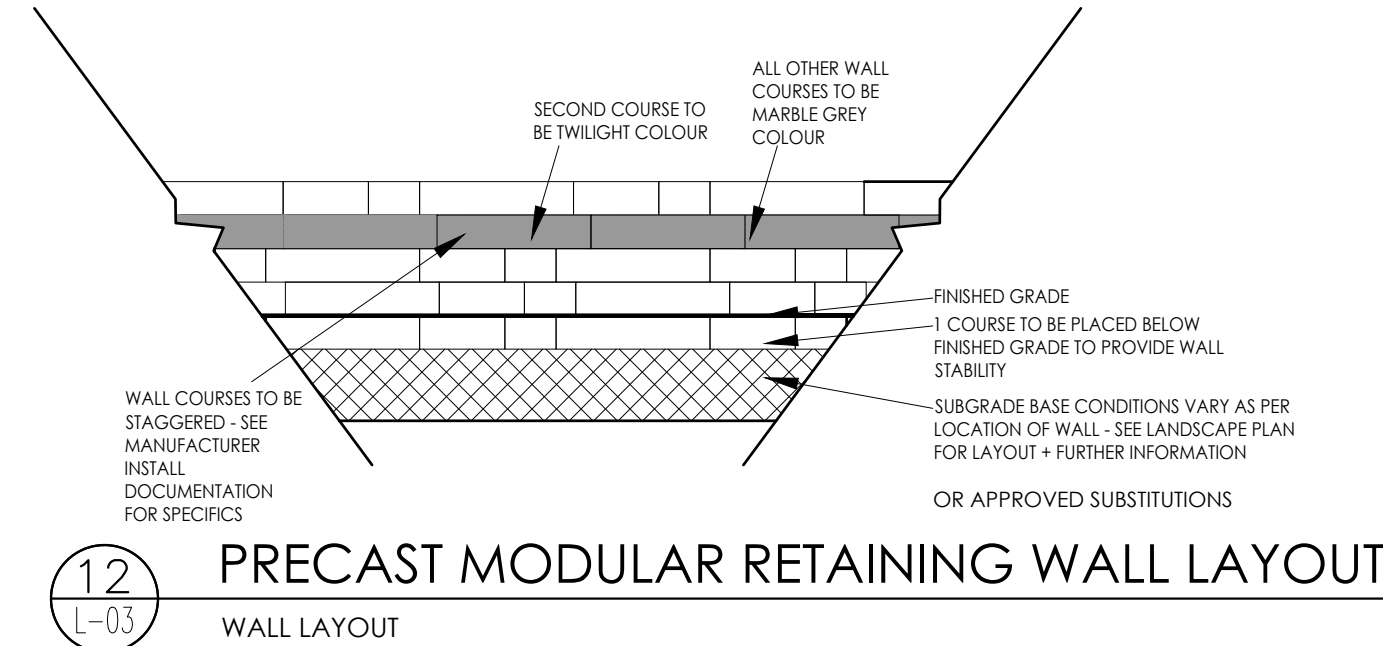
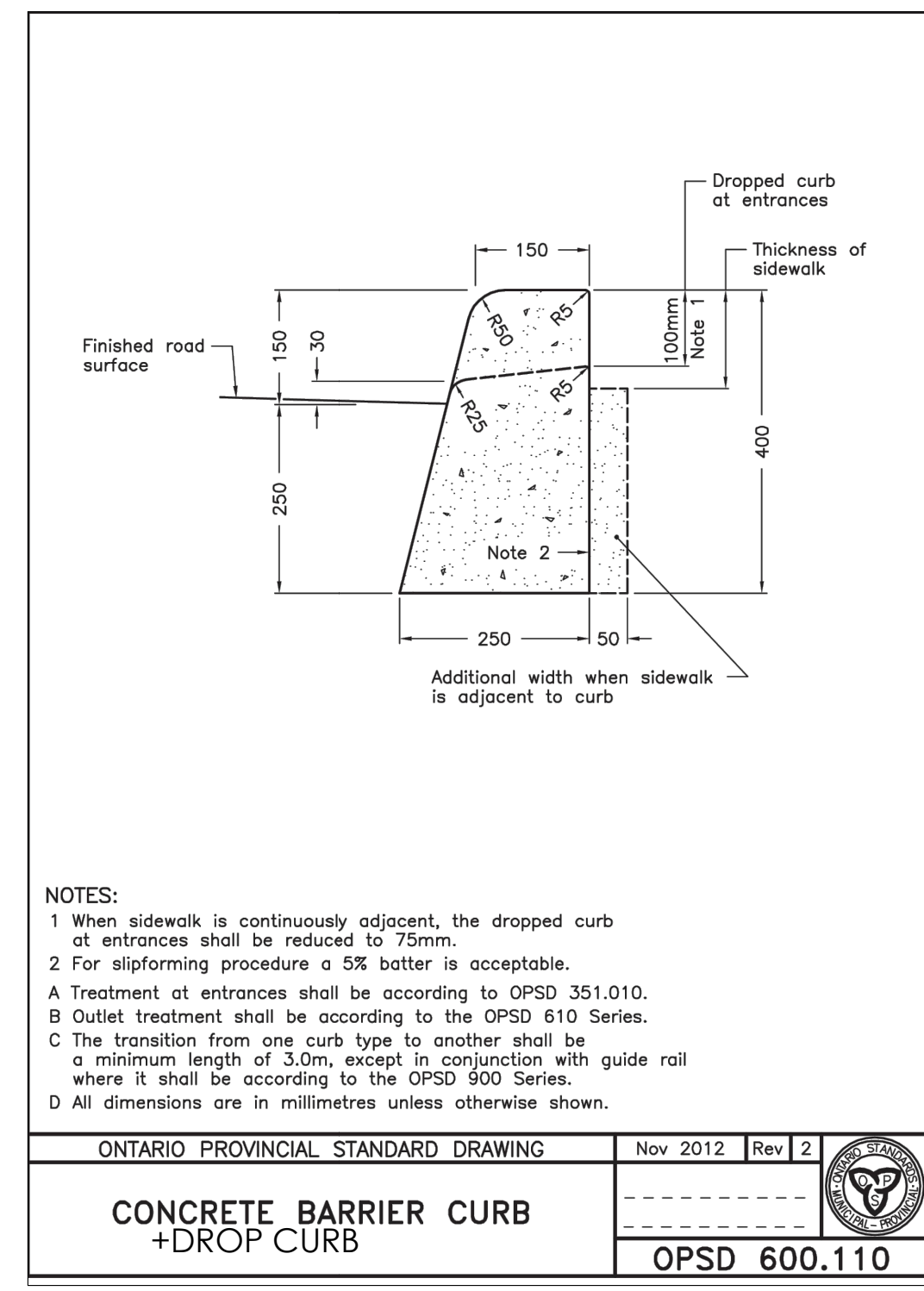
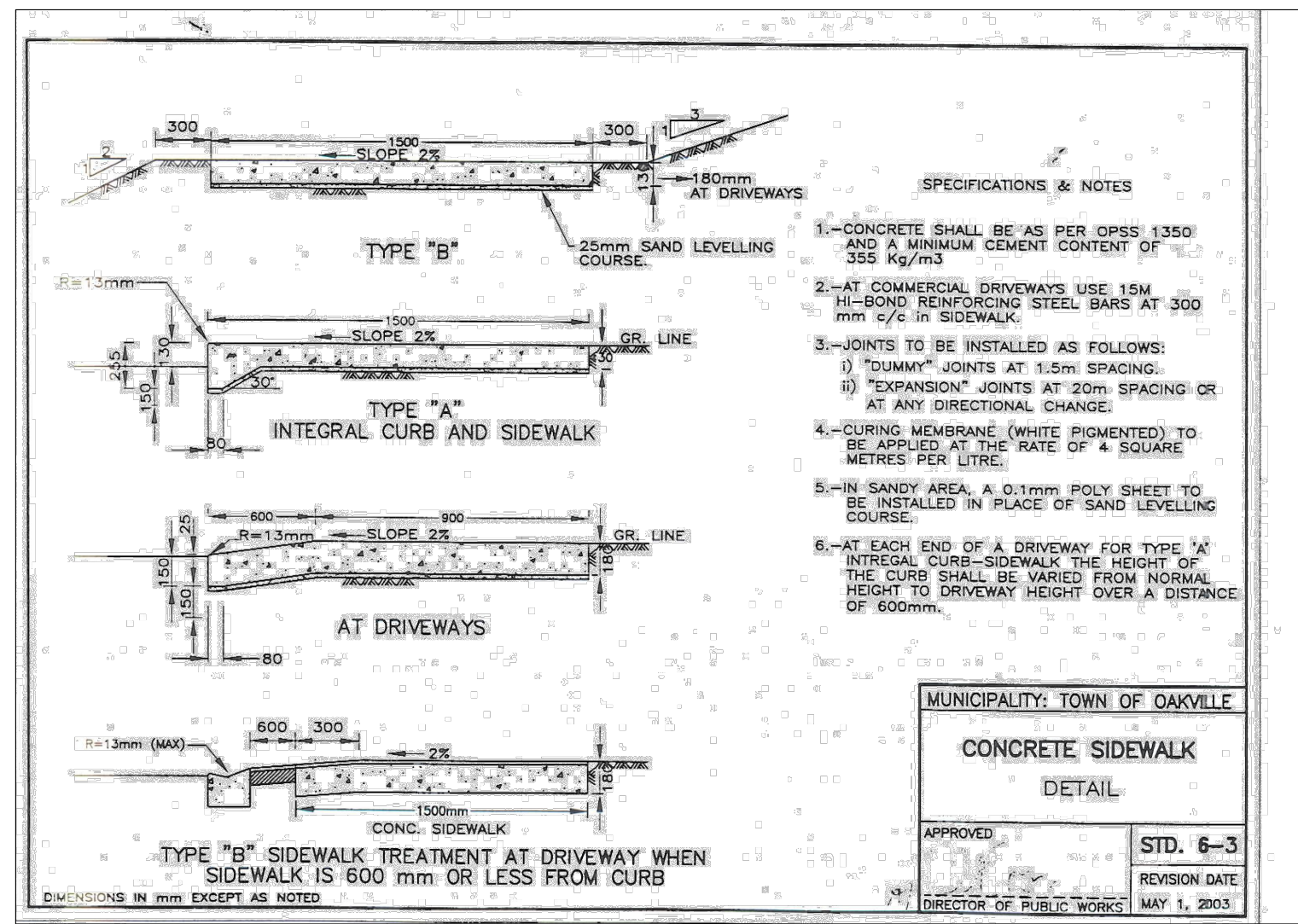
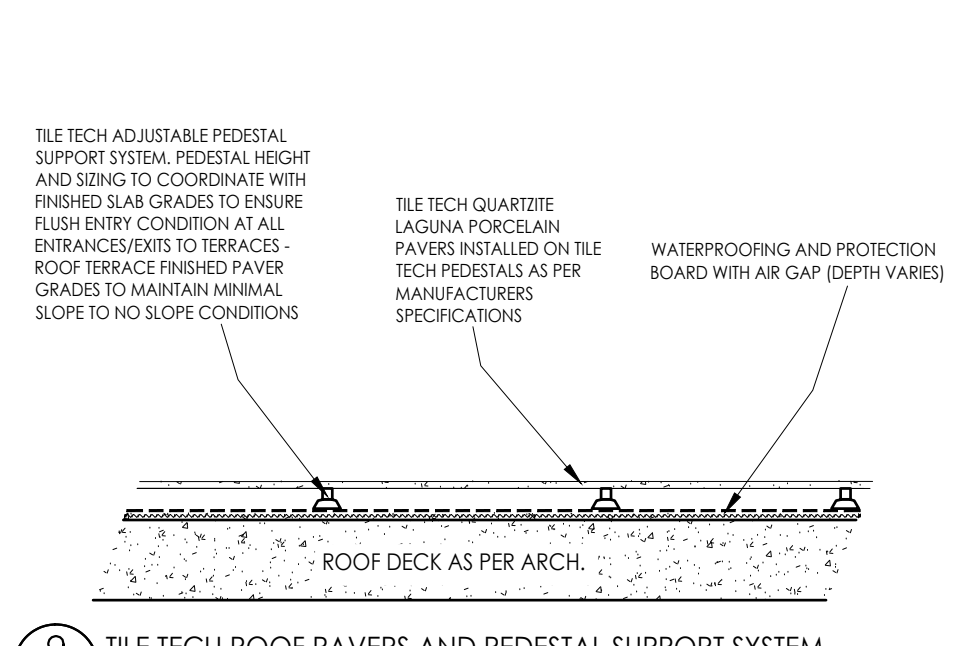
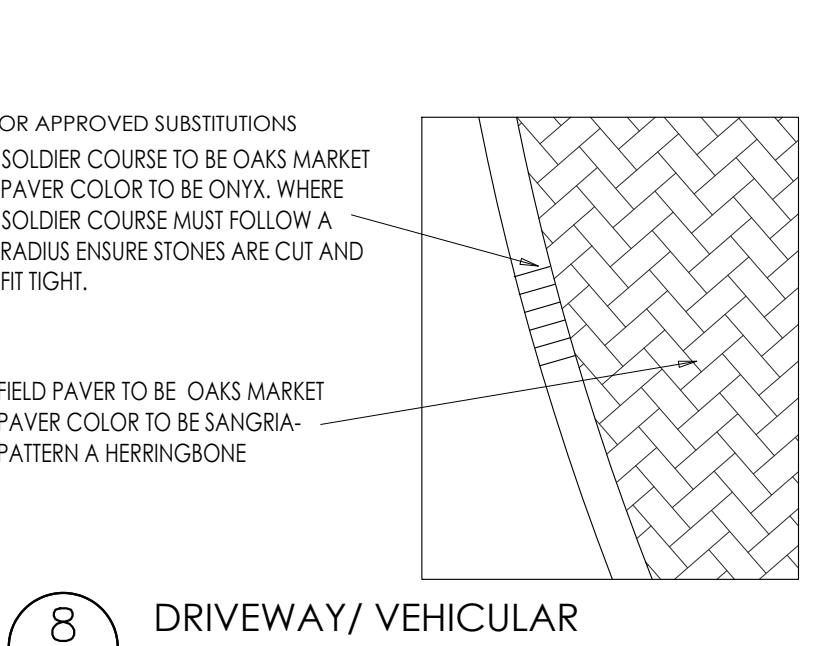
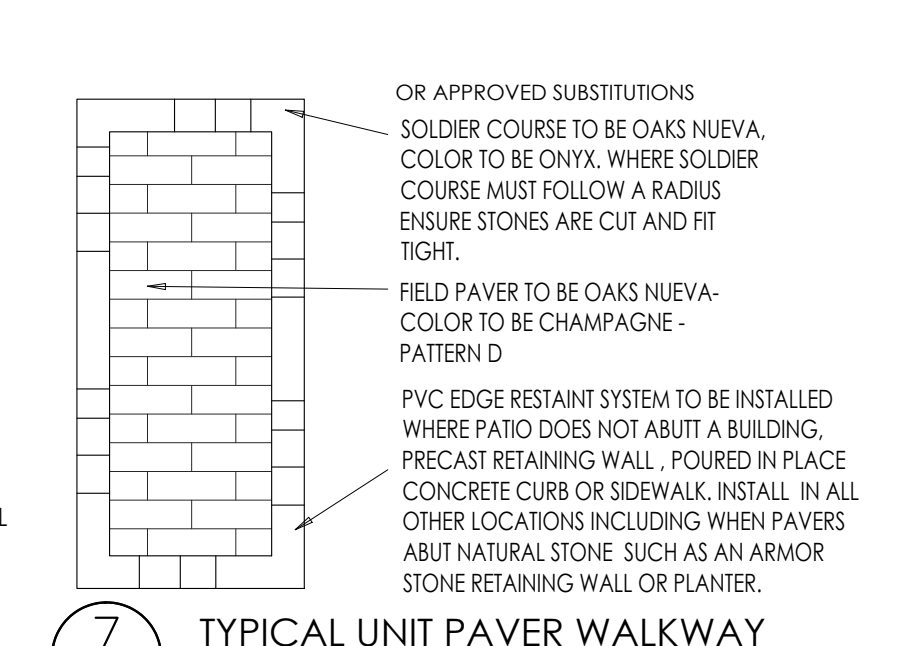
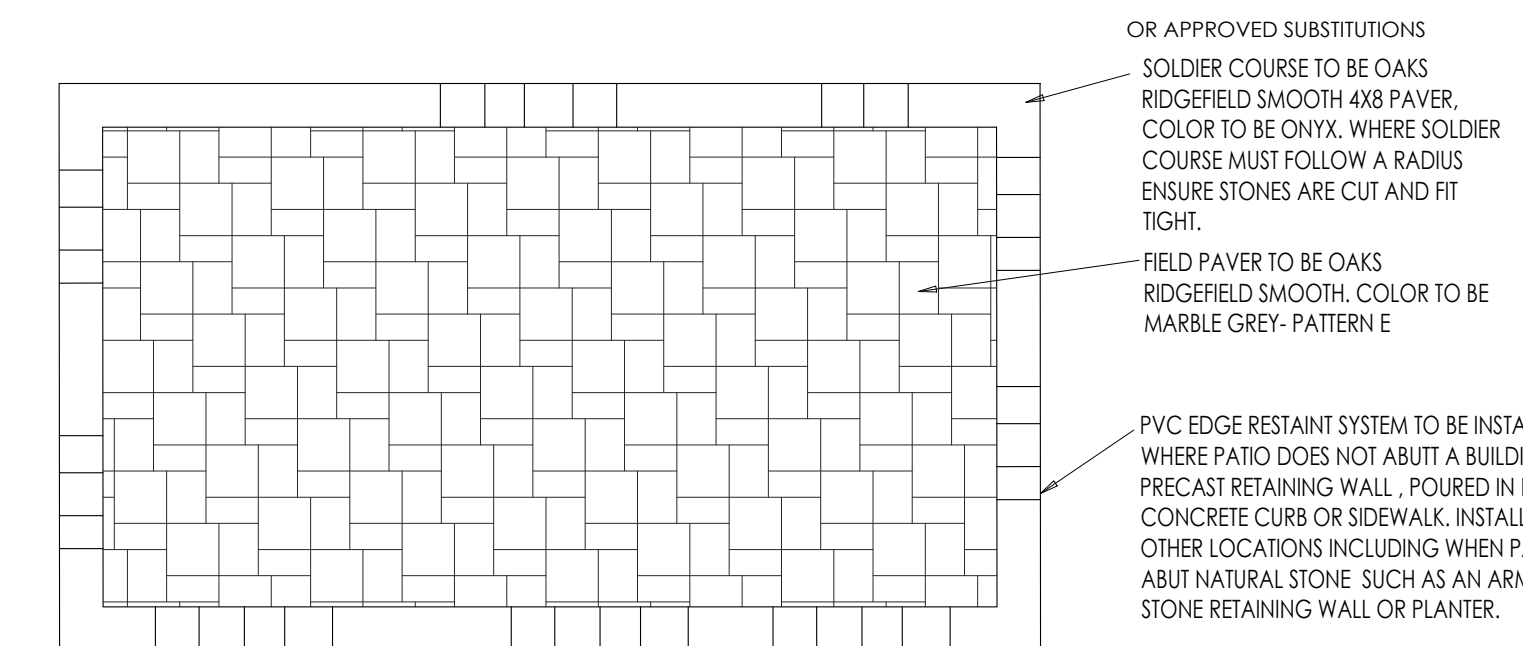
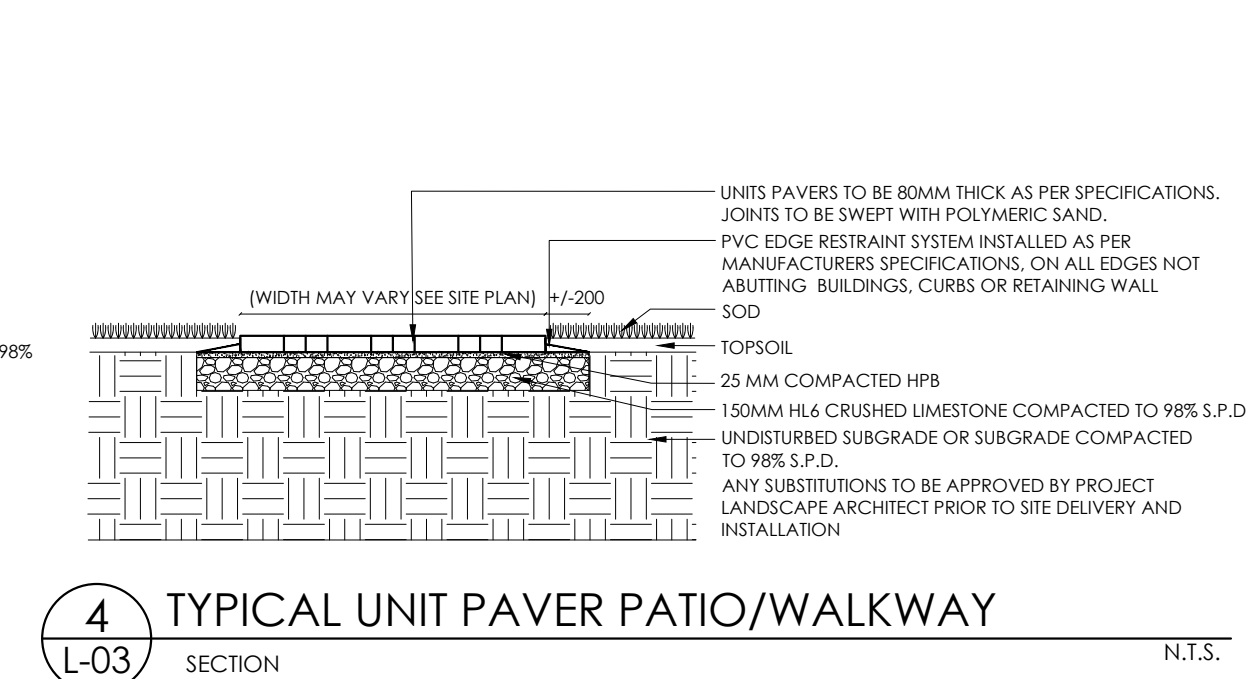
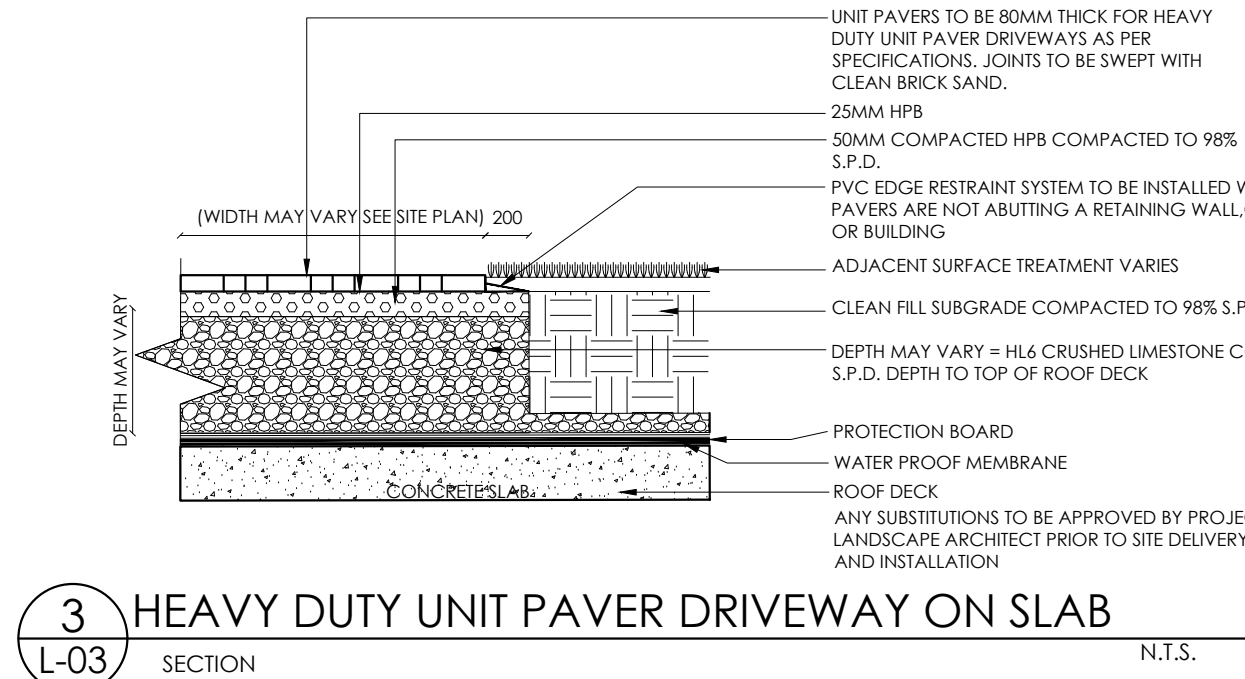
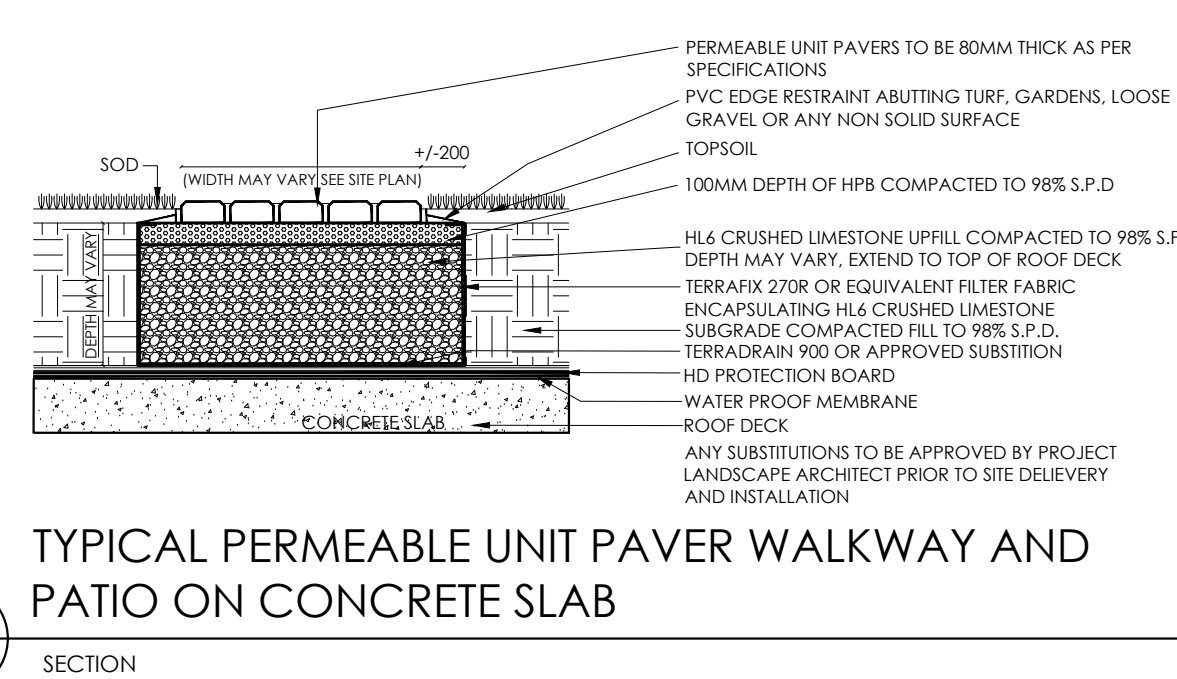
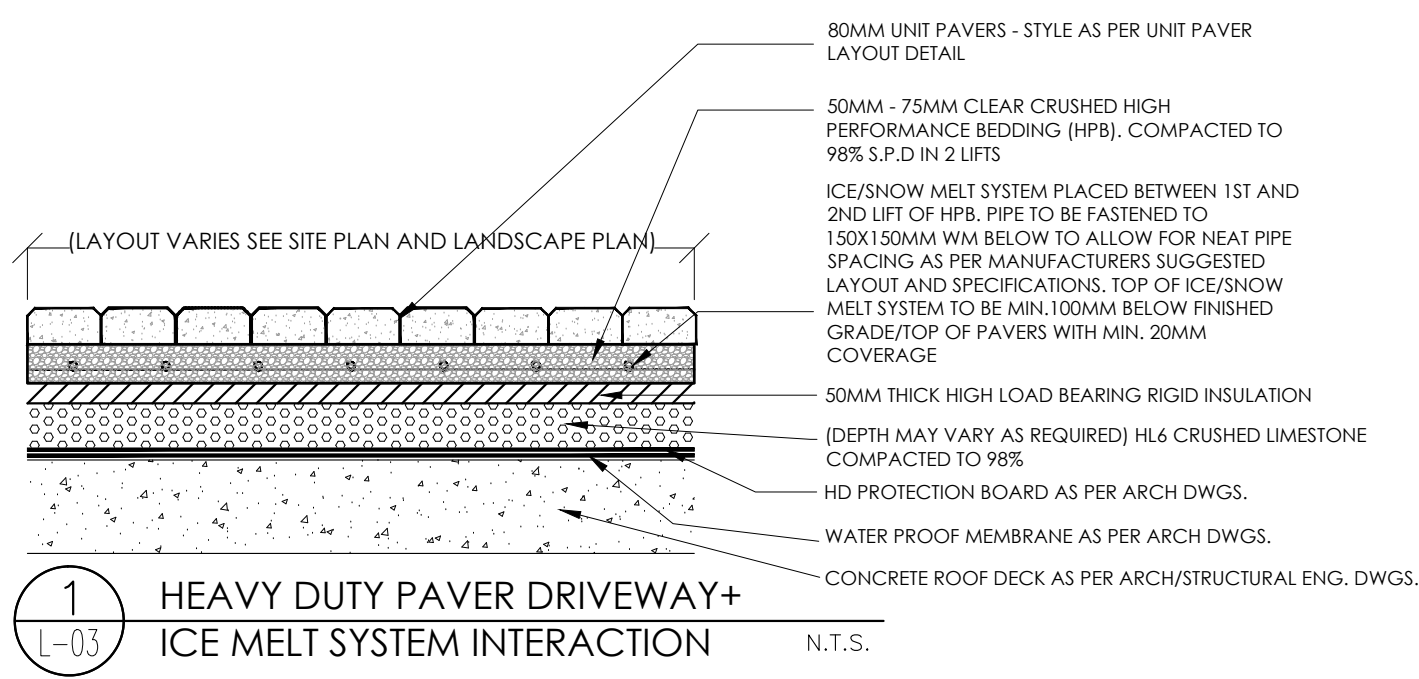

ALL DRAWINGS ARE THE PROPERTY OF WILK ASSOCIATES. ANY REUSE OR REPRODUCTION WITHOUT THE WRITTEN PERMISSION OF WILK ASSOCIATES IS STRICTLY PROHIBITED. THE CONTRACTOR SHALL CHECK ALL DIMENSIONS, SPECIFICATIONS AND NOTES AND REPORT ANY DISCREPANCIES TO THE LANDSCAPE ARCHITECT BEFORE PROCEEDING WITH THE WORK.
DO NOT SCALE DRAWINGS

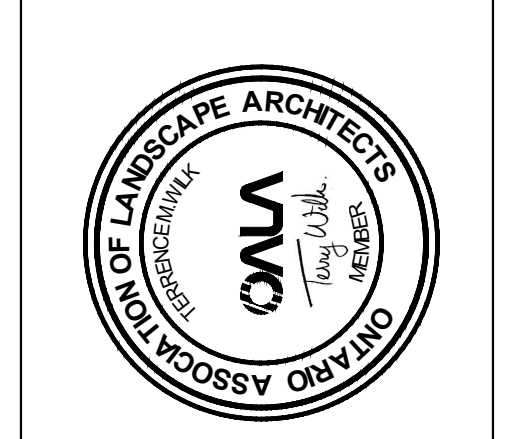

No.	Date	Revisions
11	OCT 16, 2020	REVISED AS PER COMMENTS
12	NOV 30, 2020	ISSUED FOR BUILDING PERMIT
13	MAY 13, 2022	ISSUED FOR F & S
14	MAR 24, 2023	ISSUED FOR CLIENT REVIEW
15	JULY 7, 2023	ISSUED FOR OPA/IBA SUBMISSION
16	OCT 07, 2023	ISSUED FOR PROGRESS SET
17	OCT 31, 2023	ISSUED FOR SPA
18	DEC 7, 2023	ISSUED FOR PERM
19	FEB 20, 2024	ISSUED FOR SPA
20	MAR 7, 2024	ISSUED FOR TENDER #1
21	APR 11, 2024	ISSUED FOR TENDER #1

SUCCESSION DEVELOPMENT CORPORATION
PROPOSED
6 STOREY RETIREMENT RESIDENCE
2380 LAKESHORE ROAD WEST, OAKVILLE ONTARIO

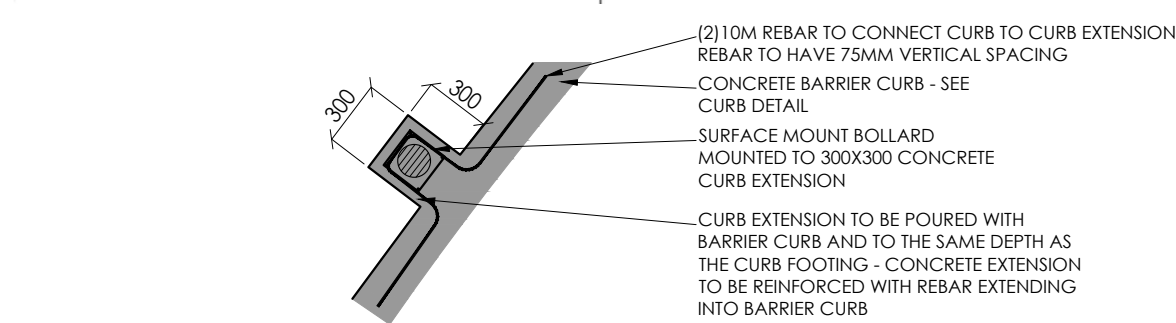
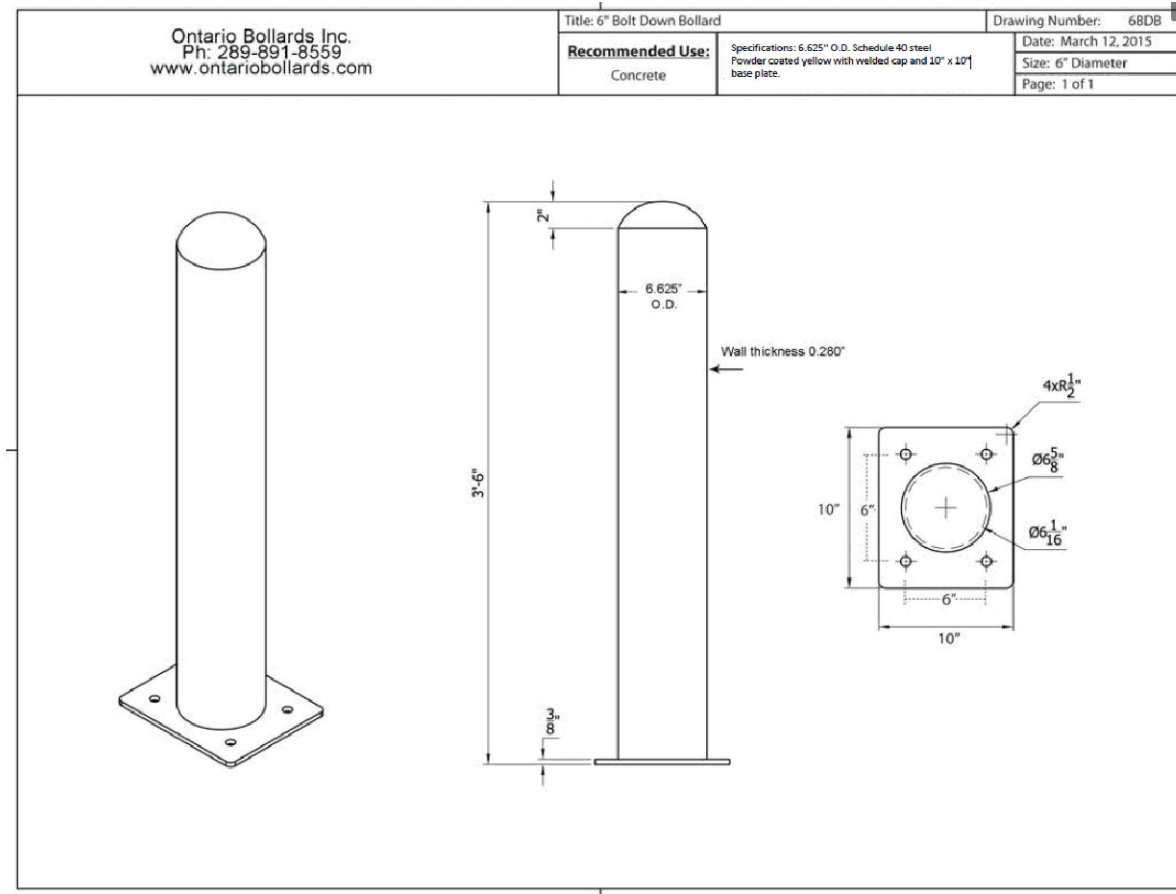

1 HYDRO TRANSFORMER BOLLARD SECTION N.T.S.

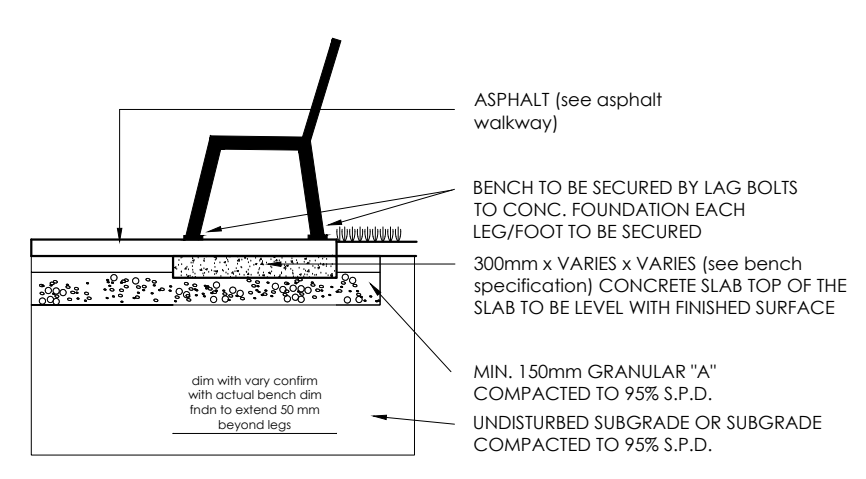

2 BENCH CONCEPT PICTURE N.T.S.

MBR-0100-0001
Legacy # MBR100-DB

Sustainability Facts

Unit Size	One (1) MBR-0100-0001 This Unit
Carbon Footprint (CO2e)	41.4 kg CO2e
Material Recycled (by weight)	100%
Water Use (GPI)	1880.16 lbs
Material Recycled (by volume)	100%
Material Recycled (by weight)	100%
Material Recycled (by volume)	100%
Material Recycled (by weight)	100%
Material Recycled (by volume)	100%

DESCRIPTION: 100 Series - 100 Bike Rack, H.S. Steel Tube, Aluminum Spun Top, Direct Burial, 2 Bike Configuration

FINISH: All steel components are protected with E-Coat rust proofing. The Maglin Powdercoat System provides a durable finish on all metal surfaces.

INSTALLATION: The bike rack is delivered pre-assembled.

TO SPECIFY: Select MBR-0100-0001
Chosen: Powdercoat Color

HEIGHT: 33" (84cm) **DIAMETER:** 20" (50.8cm) **WEIGHT:** 16.25 lbs (7.4g)

MAGLIN
Since 1988
1-800-955-8888
887 1st Ave
www.maglin.com

3 SURFACE MOUNT BIKE RING N.T.S.

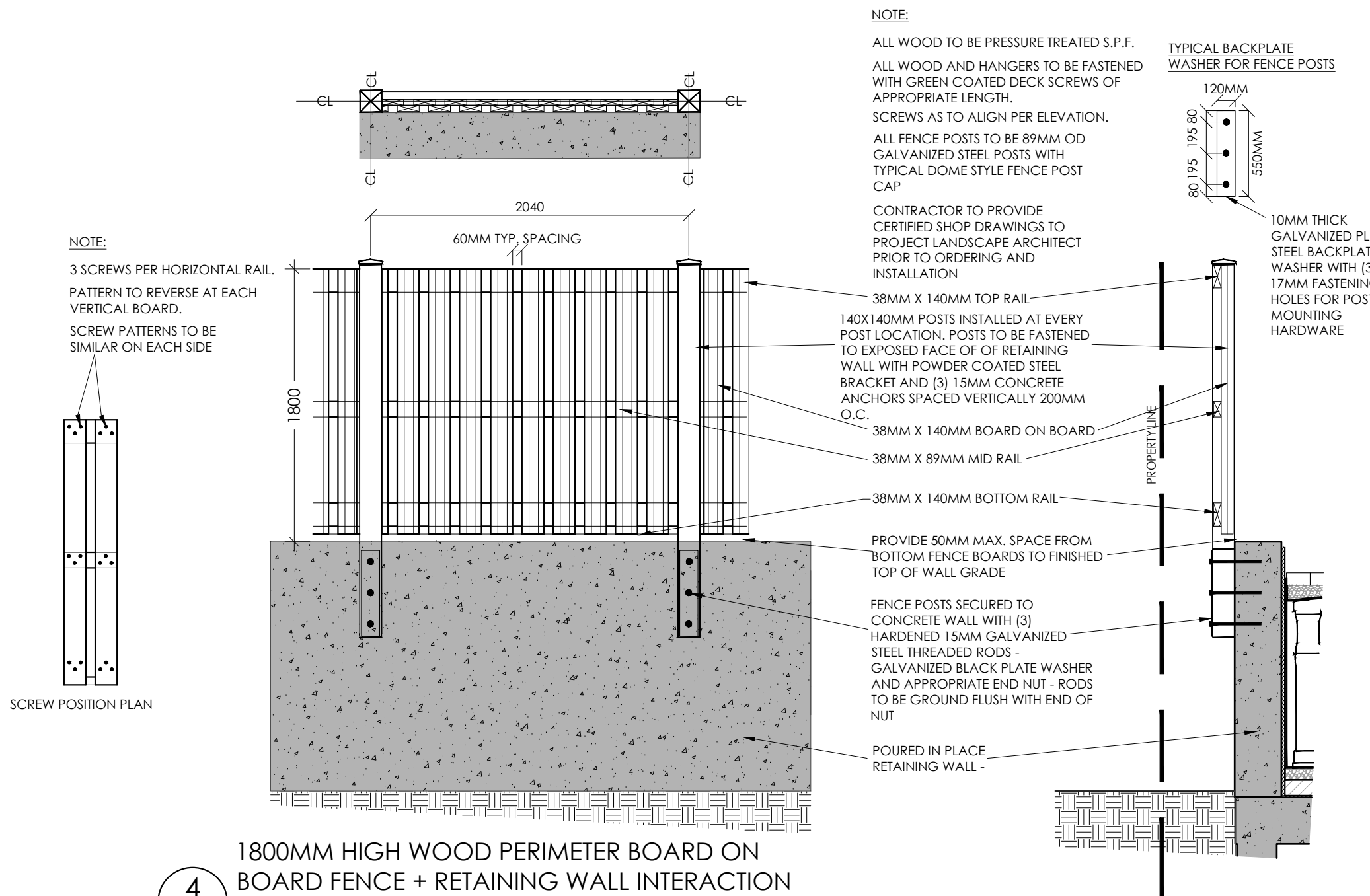

4 1800MM HIGH WOOD PERIMETER BOARD ON BOARD FENCE + RETAINING WALL INTERACTION N.T.S.

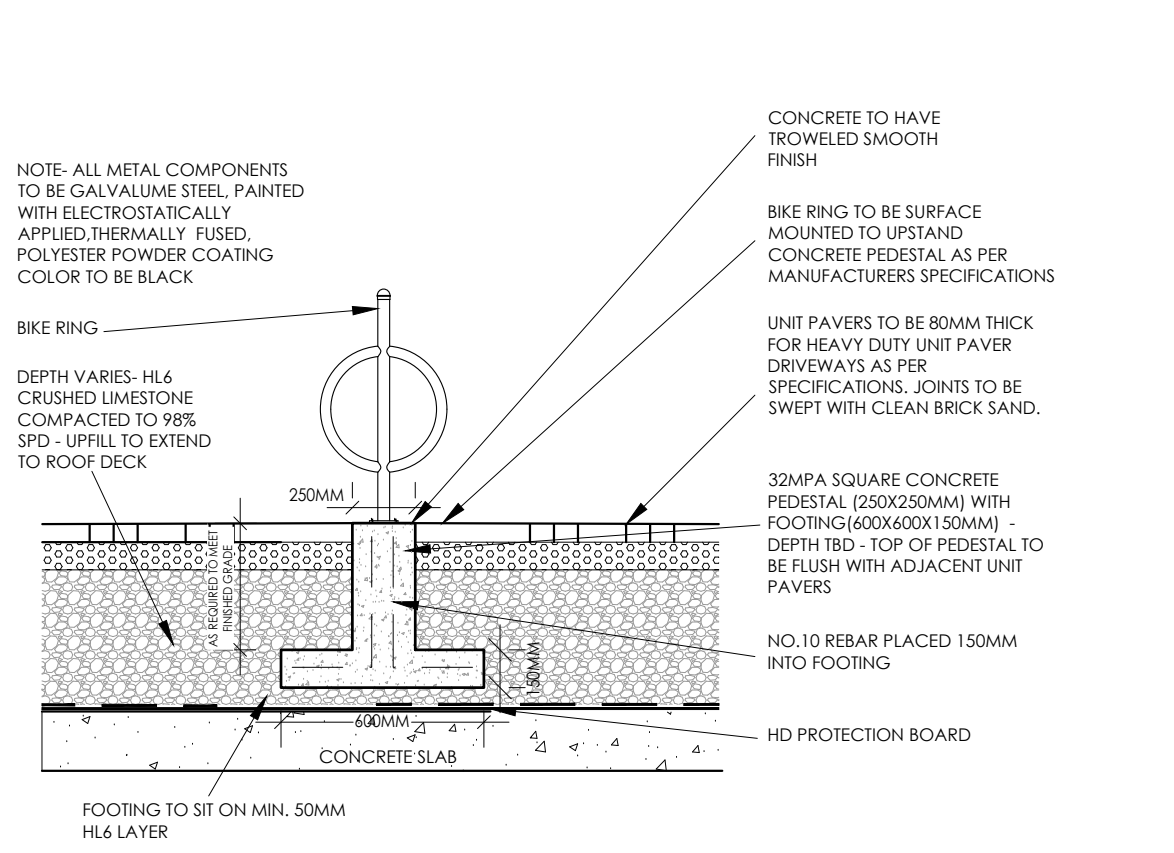

7 BIKE RING CONCRETE FOOTING AND UNIT PAVING INTERACTION N.T.S.

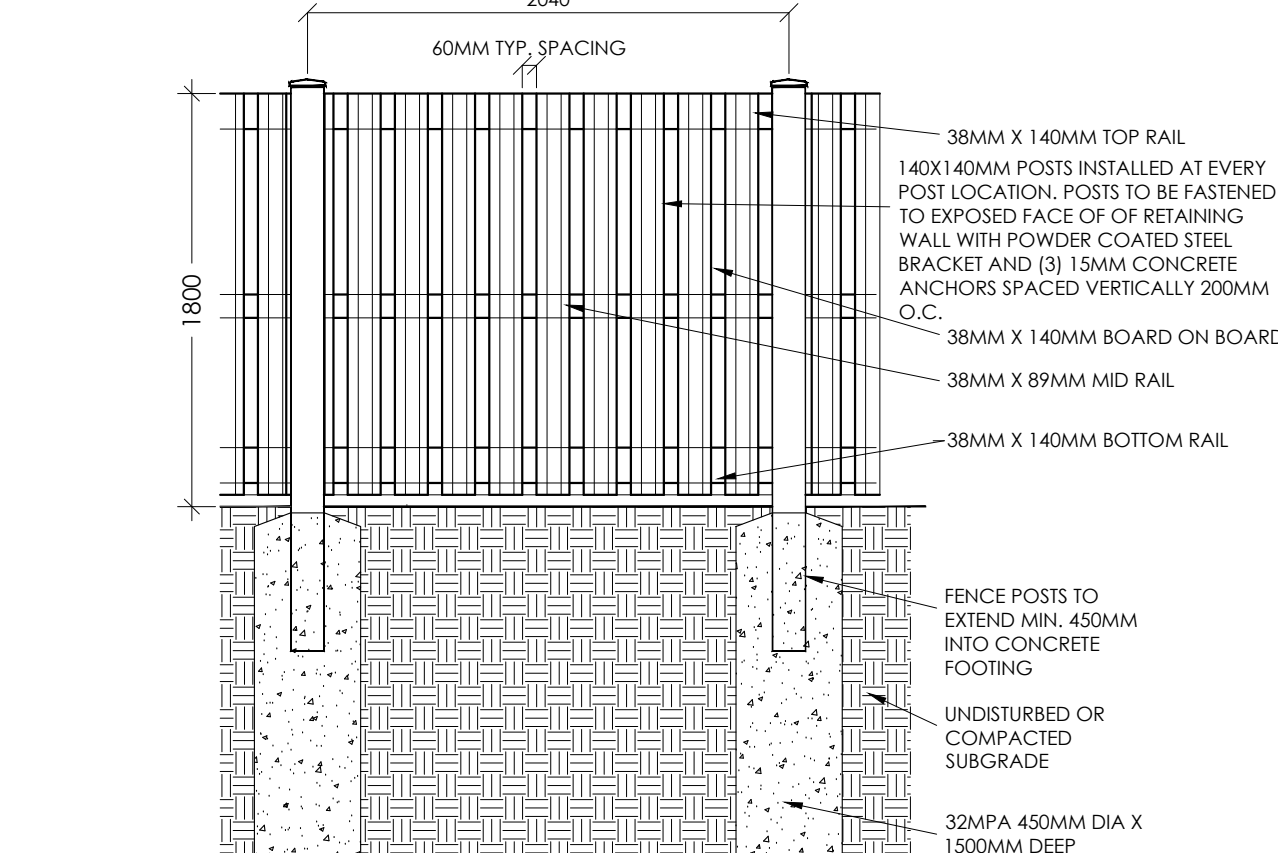

8 1800MM HIGH WOOD PERIMETER BOARD ON BOARD FENCE WITH TYPICAL FENCE POST FOOTING N.T.S.

HADCO by @ignify

Landscape Path light
RL9 LED Aluminum

PL-1 OR APPROVED SUBSTITUTIONS

Specifications

HOUSING: Die-cast aluminum. Stem is extruded aluminum. Roof has dual stainless steel hinge with stainless steel spring lock for tool-less entry and reamping. 1/2" NPS male threads to allow for accessory mounting stake or junction box, sold separately. Fasteners are 300 series stainless steel.

FINISH: Thermoseal polyester powdercoat is electrostatically applied after a five-stage conversion cleaning process and bonded by heat fusion thermosealing. Laboratory tested for superior weatherability and fade resistance in accordance with ASTM B117 specifications. Textured finish.

OPTICAL ASSEMBLY: Thermoseal polyester powdercoat is electrostatically applied after a five-stage conversion cleaning process and bonded by heat fusion thermosealing. Laboratory tested for superior weatherability and fade resistance in accordance with ASTM B117 specifications. Textured finish.

OPTICAL ASSEMBLY: Spun aluminum reflector with white thermoseal powdercoat. Frosted tempered glass sprinker shield includes top and bottom silicone gaskets for light seal.

LAMPING: Philips 12V LED 1.2W Capsule lamp. Up to 80% energy savings when compared to a 10W Capsule halogen lamp. Long lifetime of 15,000 hours (BSGL70). Operating temperature range is between -20C and 35C (ambient). Suitable for use in enclosed luminaires where the case temperature (Tc) remains below 100 MAX. Total Lumens = 100lm. Lamp is included with fixture. Lower wattage lamps are acceptable.

ELECTRICAL ASSEMBLY: Bright socket type (S4) with 250° C high temperature teflon coated wire leads. 12 volt fixture is pre-wired with 3.8 gage of 18-2 AWG, 105° C, SPT-1W wire. Low voltage quick connector, catalog RLV33 included for easy hook-up to the low voltage supply cable, not included. 12 Volt system requires remote transformer, not included.

WARRANTY: Three-year limited warranty.

CERTIFICATIONS: ETL listed to U.S. safety standards for wet locations. cETL listed to Canadian safety standards for wet locations. Manufactured to ISO 9001:2008 Standards.

Height: 16.5" (416 mm) **Width:** 8" (203 mm) **Max. Weight:** 1.5 lbs (0.68 kg)

Ordering Guide
Example: RL9 A S7 LED2W

Product Code	RL9	LED Aluminum Path Light
Finish	A	Black
	H	Bronze
Mounting	S7	Mounting Stake
LED	LED2W	LED Lamp

@ignify

5 LANDSCAPE LIGHTING 'PL-1' N.T.S.

HADCO by @ignify

Landscape Deck Light
DAL1 Aluminum

DL-1 OR APPROVED SUBSTITUTIONS

Specifications

HOUSING: Body and mounting plate are cast aluminum construction. Fasteners are 300 series stainless steel.

FINISH: Thermoseal polyester powdercoat is electrostatically applied after a five-stage conversion cleaning process and bonded by heat fusion thermosealing. Laboratory tested for superior weatherability and fade resistance in accordance with ASTM B117 specifications.

OPTICAL ASSEMBLY: Frosted, annealed glass lens. Reflector is Stamped Homogeneous Aluminum.

LAMPING: 10W maximum T3 bi-pin lamp. Lower wattage lamps are acceptable. 10W T3 lamp is included with fixture.

ELECTRICAL ASSEMBLY: Bi-pin socket type (S4) with 250° C high temperature teflon coated wire leads. 12 volt fixture is pre-wired with 6-8 gage of 18-2 AWG, 105° C, SPT-1W wire. Low voltage quick connector, catalog RLV33 included for easy hook-up to the low voltage supply cable, not included. 12 Volt system requires remote transformer, not included.

INSTALLATION & MOUNTING: Two (2) Stainless #8 wood screws (supplied) via key slots.

WARRANTY: Three-year limited warranty.

CERTIFICATIONS: ETL listed to U.S. safety standards for wet locations. cETL listed to Canadian safety standards for wet locations. Manufactured to ISO 9001:2008 Standards.

Height: 3 1/2" (89mm) **Width:** 3 1/2" (89mm) **Depth:** 1 7/8" (48mm) **Max. Weight:** 0.30 lb

Ordering Guide
Example: DAL1 A

Product Code	DAL1	Aluminum Deck Light
Finish	A	Black
	B	White
	V	Verde
	H	Bronze

@ignify

6 LANDSCAPE LIGHTING 'DL-1' N.T.S.

ALL DRAWINGS ARE THE PROPERTY OF WILK ASSOCIATES. THE CLIENT AND ARCHITECT SHALL BE RESPONSIBLE FOR THE ACCURACY OF ALL INFORMATION PROVIDED. THE CONTRACTOR SHALL CHECK ALL DIMENSIONS, SPECIFICATIONS AND NOTES AND REPORT ANY DISCREPANCIES TO THE LANDSCAPE ARCHITECT BEFORE PROCEEDING WITH THE WORK.

DO NOT SCALE DRAWINGS

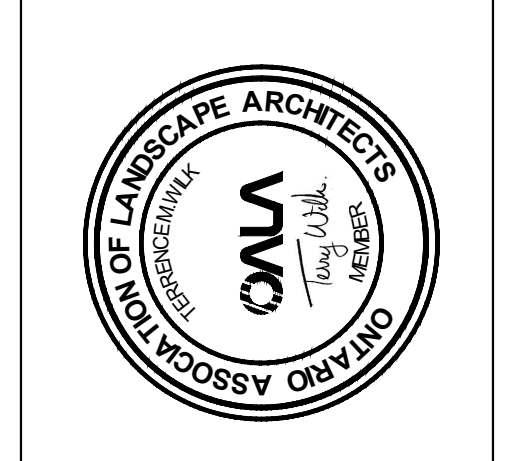

No.	Date	Revisions
11	OCT 16, 2020	REVISED AS PER COMMENTS
12	NOV 30, 2020	ISSUED FOR PERMITTING PERMIT
13	MAY 13, 2022	ISSUED FOR PERMITTING PERMIT
14	MAR 24, 2023	ISSUED FOR CLIENT REVIEW
15	JULY 7, 2023	ISSUED FOR OPA/IBA SUBMISSION
16	OCT 21, 2023	ISSUED FOR PERMIT
17	OCT 21, 2023	ISSUED FOR PERMIT
18	DEC 7, 2023	ISSUED FOR PERMIT
19	FEB 20, 2024	ISSUED FOR PERMIT
20	MAR 27, 2024	ISSUED FOR TENDER #1
21	APR 11, 2024	ISSUED FOR TENDER #1

SUCCESSION DEVELOPMENT CORPORATION
PROPOSED
6 STOREY RETIREMENT RESIDENCE
2380 LAKESHORE ROAD WEST, OAKVILLE, ONTARIO

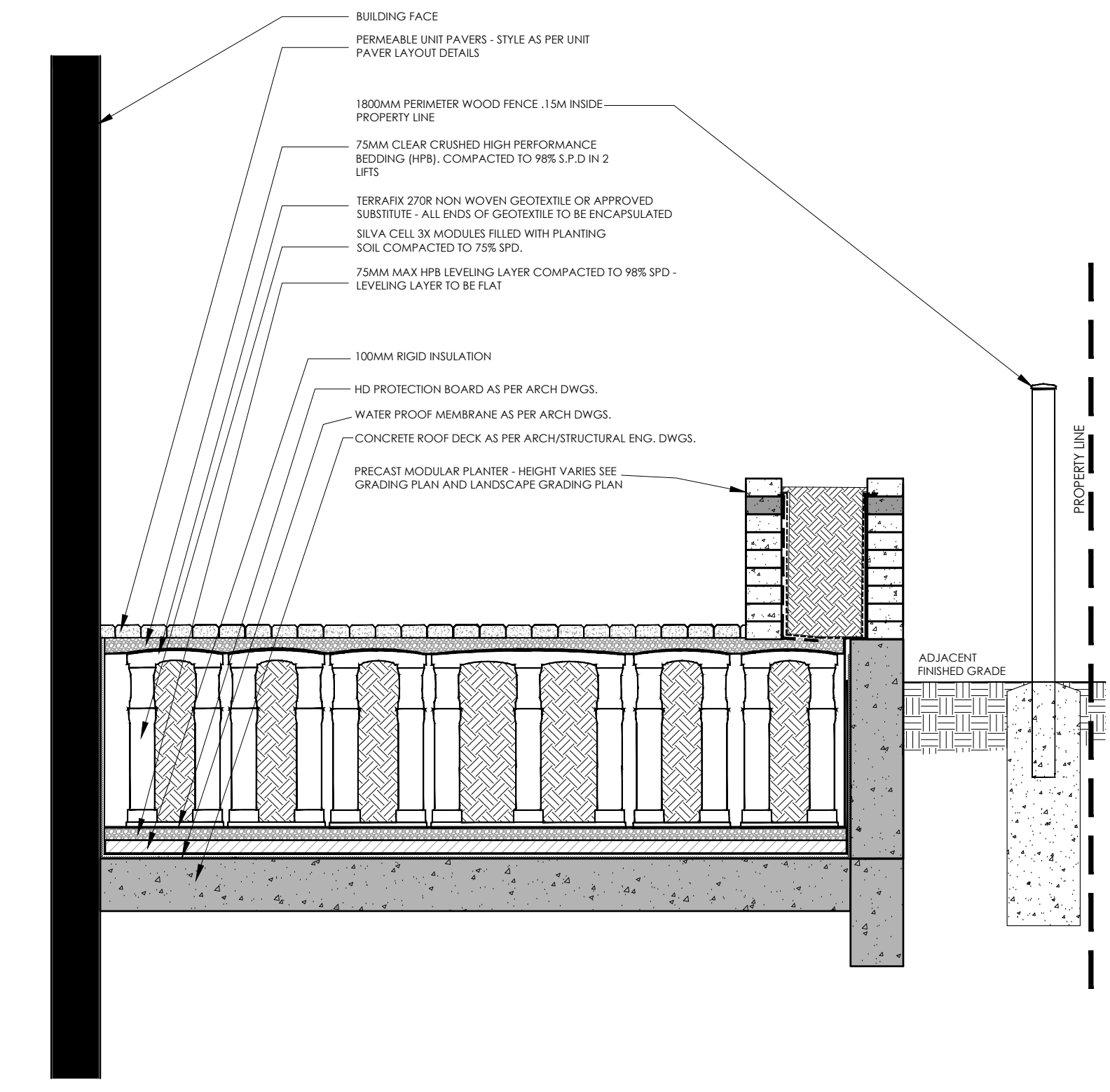

1 SIDE YARD CROSS SECTION
N.T.S.

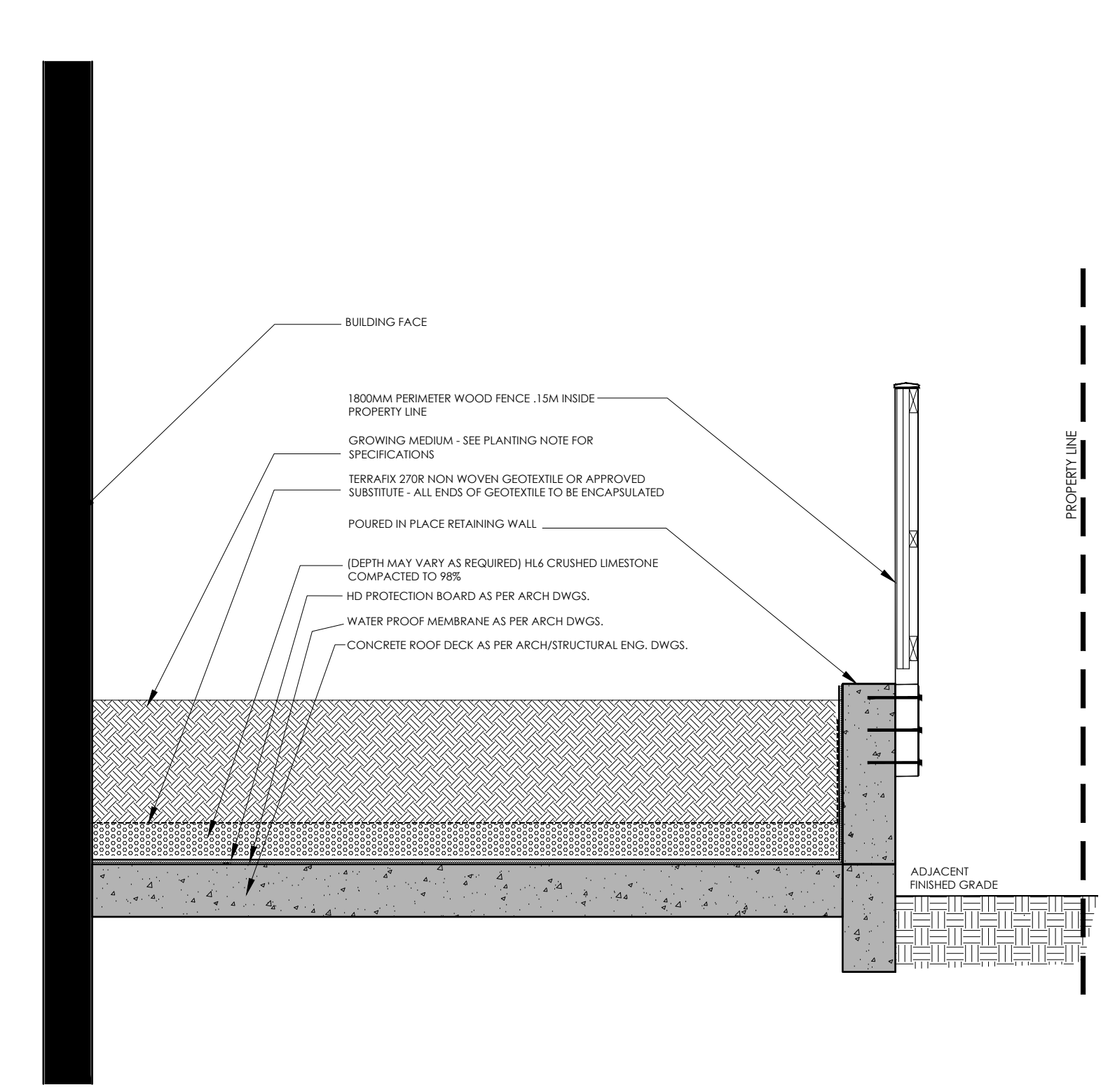

2 SIDE YARD CROSS SECTION
N.T.S.

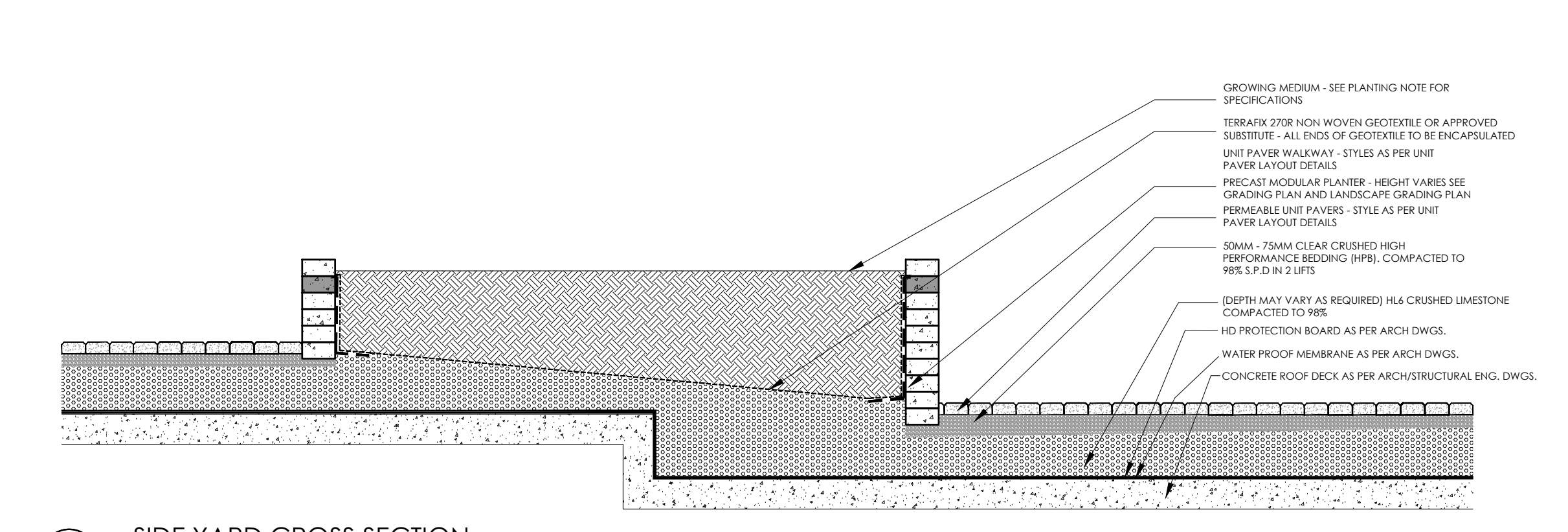

3 SIDE YARD CROSS SECTION
N.T.S.

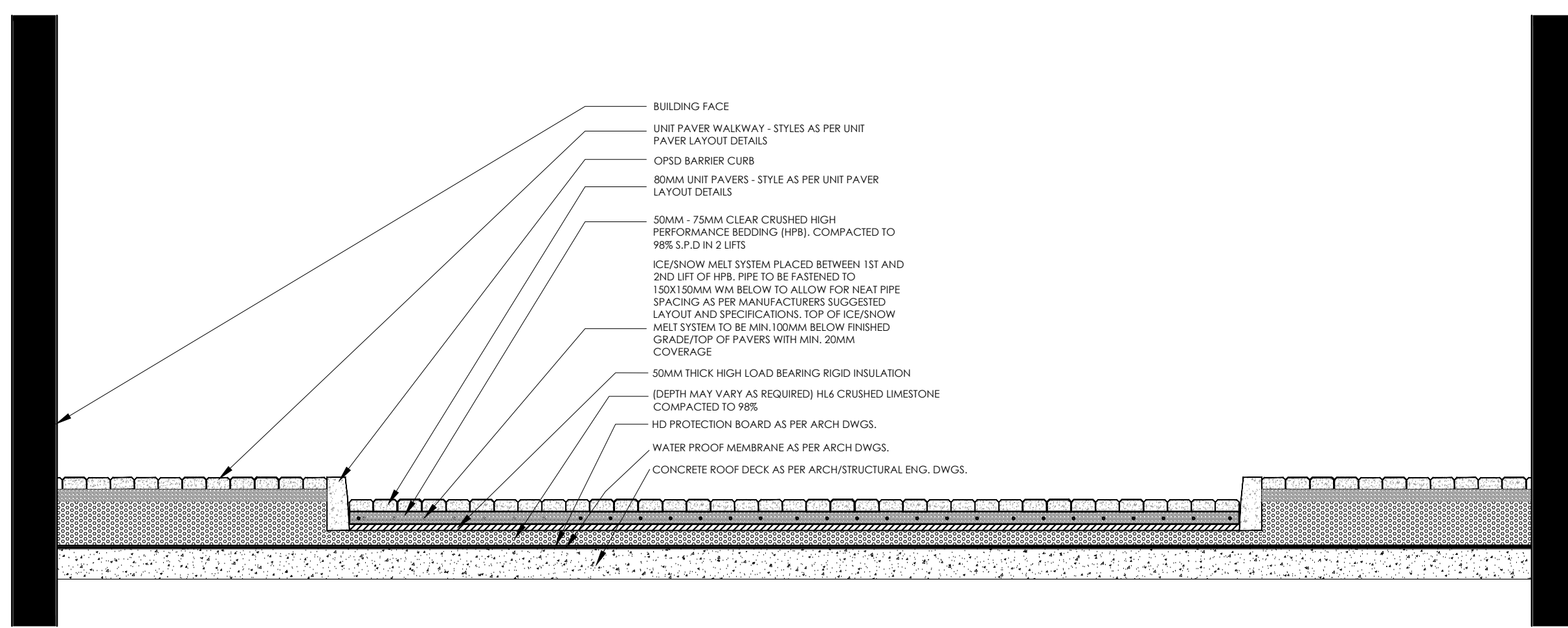

4 DRIVEWAY CROSS SECTION
N.T.S.

WILK ASSOCIATES
LANDSCAPE ARCHITECTURE LTD
P.O. BOX 142
1496 SAFARI ROAD
MILLSBORO ON (L9V 1V0)
T: 905-659-9489
www.wilkassociates.ca

ALL DRAWINGS ARE THE PROPERTY OF WILK ASSOCIATES. ANY REUSE OR REPRODUCTION WITHOUT THE WRITTEN PERMISSION OF WILK ASSOCIATES IS STRICTLY PROHIBITED. THE CONTRACTOR SHALL CHECK ALL DIMENSIONS, SPECIFICATIONS AND NOTES AND REPORT ANY DISCREPANCIES TO THE LANDSCAPE ARCHITECT BEFORE PROCEEDING WITH THE WORK.
DO NOT SCALE DRAWINGS

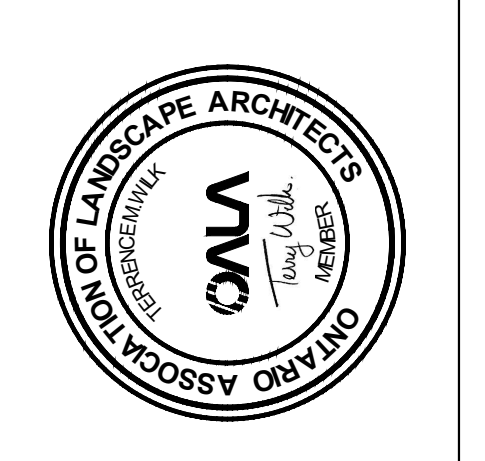

No.	Date	Revisions
11	OCT 16, 2020	REVISED AS PER COMMENTS-
12	NOV 30, 2020	ISSUED FOR BUILDING PERMIT
13	MAY 13, 2022	ISSUED FOR E.F.S.T
14	MAR 24, 2023	ISSUED FOR CLIENT REVIEW
15	JULY 7, 2023	ISSUED FOR OP/IMA SUBMISSION
16	OCT 27, 2023	ISSUED PROGRESS SET
17	OCT 27, 2023	ISSUED FOR SPA
18	DEC 7, 2023	ISSUED FOR PERMIT
19	FEB 20, 2024	ISSUED FOR SPA
20	MAR 27, 2024	ISSUED FOR TENDER #1
21	APR 11, 2024	ISSUED FOR TENDER #1

SUCCESSION DEVELOPMENT CORPORATION
PROPOSED
6 STOREY RETIREMENT RESIDENCE
2380 LAKESHORE ROAD WEST, OAKVILLE ONTARIO

LANDSCAPE CROSS SECTIONS
score: N13
date: MAY 7, 2018
drawn: AW
180443
project number
L-03B

