

MH	OPSD	T/G	INVERTS
MH1A	(OPSD 701.010)	147.25	SW143.89 AB SW143.751
MH1B	(OPSD 701.010)	146.88	NE143.99 AB NE143.000 SE143.84 AB SE145.992
MH1C	(OPSD 701.010)	147.17	NE143.06 AB NE143.031
MH1D	(OPSD 701.010)	147.05	NE142.68 AB N142.642 SE142.69 AB SE142.621 SW142.68 AB SW142.813
MH1E	(OPSD 701.010)	147.01	SE143.37 AB SE143.364
MH1F	(OPSD 701.010)	146.84	NW143.14 AB NW143.081 SE143.06 AB SE143.008
MH1G	(OPSD 701.010)	146.77	NE142.96 AB N142.900 SW142.91 AB SW143.051
MH1H	(OPSD 701.010)	146.53	NW142.47 AB NW142.514 SE142.44 AB SE142.559 SW142.44 AB SW142.813
MH1I	(OPSD 701.010)	146.21	NW142.34 AB NW142.239 SE142.31 AB SE142.298
MH1J	(OPSD 701.010)	146.21	141.66 AB 142.290

MH	OPSD	T/G	INVERTS
CB MH 1	(OPSD 701.010)	146.79	NE144.25 AB NE144.159 SE144.33 AB SE144.239
CB MH2	(OPSD 701.010)	147.06	SE145.50 AB SE145.419 NE145.58 AB NE145.552
EX STM MH	(OPSD 701.010)	146.26	NW142.94 AB NW142.887 SE142.77 AB SE142.758
MH1	(OPSD 701.010)	147.19	SW144.51 AB SW144.433
MH2	(OPSD 701.010)	147.04	NE144.17 AB NE144.162 SW144.10 AB SW144.095 NW145.20 AB NW145.182
MH3	(OPSD 701.010)	146.80	NE143.56 AB NE143.542 SE143.47 AB SE143.467
MH4	(OPSD 701.010)	147.00	NE143.40 AB N143.407 SE143.32 AB SE143.314 SW143.47 AB SW143.470
MH5	(OPSD 701.010)	147.03	SE144.02 AB SE144.004
MH6	(OPSD 701.010)	146.88	NW143.82 AB NW143.785 SE143.77 AB SE143.785
MH7	(OPSD 701.010)	146.81	NE143.69 AB N143.667 SW143.61 AB SW143.687
MH8	(OPSD 701.010)	146.60	NW143.21 AB NW143.227 SE143.16 AB SE143.134 NE143.24 AB NE143.230

CROSSING	WM	STM	SAN
X1	INV 145.15 OBV 145.35	INV 144.36 OBV 144.66	INV 143.65 OBV 143.85
X2	INV 144.53 OBV 144.73	INV 145.23 OBV 145.53	INV 143.47 OBV 143.67
X3	INV 144.40 OBV 144.60	INV 145.10 OBV 145.40	INV 142.94 OBV 143.14
X4	N/A	INV 143.41 OBV 143.86	INV 142.58 OBV 142.78
X5	INV 144.08 OBV 145.28	INV 143.51 OBV 143.81	INV 142.75 OBV 142.95
X6	N/A	INV 143.24 OBV 143.62	INV 142.47 OBV 142.67
X7	INV 144.49 OBV 144.69	INV 143.10 OBV 143.55	INV 142.43 OBV 142.63

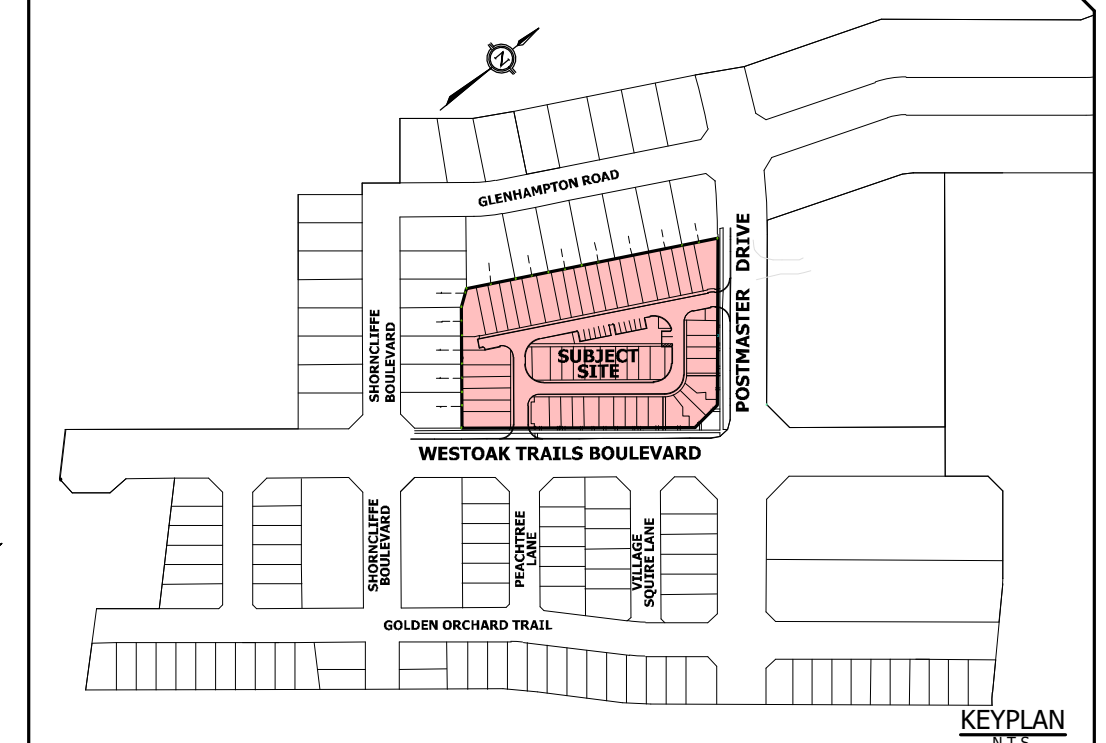

SHORNLIFFE BOULEVARD

POSTMASTER DRIVE

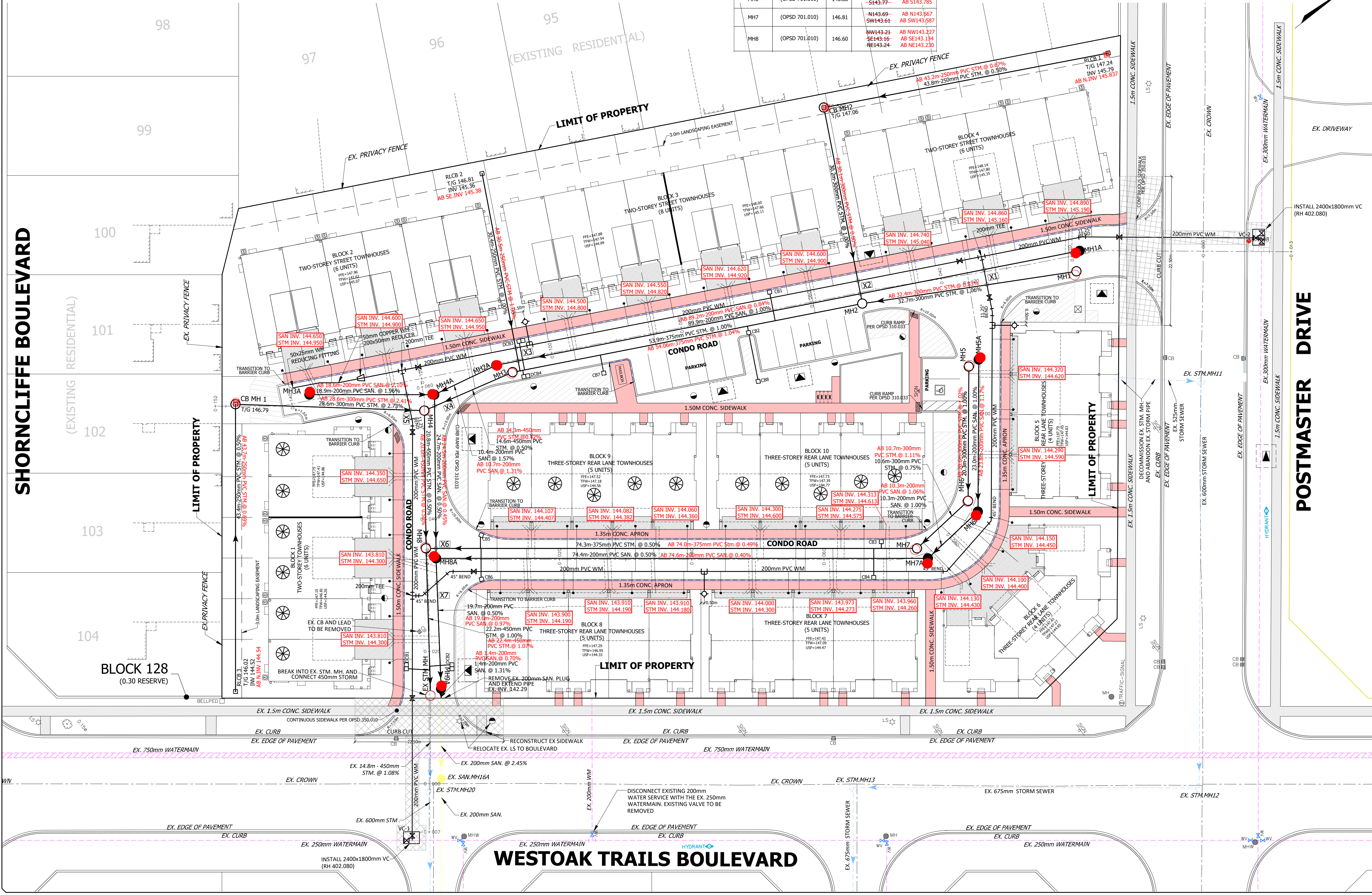

LEGEND

- EXISTING SINGLE CB (ROAD AND REAR YARD)
- EXISTING DOUBLE CB
- SINGLE CB (ROAD C/S WITH CB SHIELD AS PER DETAIL ON DWG. 501)
- DOUBLE CB WITH CB SHIELD AS PER DETAIL ON DWG. 501
- CB MANHOLE
- STORM MANHOLE
- SANITARY MANHOLE
- HYDRANT
- 200mm WATER VALVE AND BOX
- 25mm WATER SERVICE CONNECTION AND CURB STOP
- SANITARY SERVICE CONNECTION
- STORM SERVICE CONNECTION
- SANITARY SERVICE CONNECTION TO BE INSTALLED BENEATH MAINLINE STORM SEWER
- RAIN WATER LEADER
- TACTILE WALKING SURFACE (OPSD 310.039)
- ARMOUR STONE RETAINING WALL
- DRIVEWAY
- CONCRETE SEMI-MOUNTABLE CURB WITH STANDARD GUTTER (OPSD 600.060)
- CONCRETE BARRIER CURB WITH STANDARD GUTTER (STD 6-1)
- SNOW STORAGE AREA (REFER TO SITE PLAN BY GSAI FOR DETAILS)
- AIR CONDITIONER (REFER TO SITE PLAN BY GSAI FOR DETAILS)
- TRANSFORMER (REFER TO UTILITY PLANS BY COLUM FOR DETAILS)
- UTILITY PEDESTAL (REFER TO UTILITY PLANS BY COLUM FOR DETAILS)
- STREET LIGHT (REFER TO UTILITY PLANS BY COLUM FOR DETAILS)
- WALL PACK STREET LIGHT (REFER TO UTILITY PLANS BY COLUM FOR DETAILS)
- LIMITS OF WORK AREAS WITHIN EXISTING RIGHT-OF-WAYS

- AS BUILT STORM MANHOLE
- AS BUILT SANITARY MANHOLE
- AS BUILT CB MANHOLE
- AS BUILT CB

**WORKS WITHIN EXISTING RIGHT-OF-WAYS**

- THE LOCATION OF EXISTING UTILITIES AND SERVICES IS APPROXIMATE ONLY AND THE EXACT LOCATION SHOULD BE DETERMINED BY CONSULTING THE MUNICIPAL AUTHORITIES AND UTILITY COMPANIES CONCERNED. THE CONTRACTOR SHALL BE RESPONSIBLE FOR ADEQUATE PROTECTION FROM DAMAGE DURING CONSTRUCTION.
- ALL AREAS DISTURBED DURING CONSTRUCTION SHALL BE RESTORED TO THE ORIGINAL CONDITION OR BETTER, TO THE SATISFACTION OF THE TOWN OF OAKVILLE AND REGION OF HALLOW, BOULEVARDS TO BE RESTORED WITH 200mm TOPSOIL AND SOD.
- RESIDENTIAL ENTRANCES TO BE CONSTRUCTED PER OPSD 350.010.
- CURB TO BE RESTORED PER OPSD 600.040
- SIDEWALK TO BE RESTORED PER TOWN STD 6-3
- MATCH EXISTING PAVEMENT STRUCTURE ON POSTMASTER DRIVE AND WESTOAK TRAILS BOULEVARD TO BE CONFIRMED IN FIELD

**GENERAL NOTES:**

- ROOF DRAINAGE TO DISCHARGE TO SPLASH PADS AT GRADE AS PER OAKVILLE STANDARD 10-1.
- ALL UNITS REQUIRE SUMP PUMPS. REFER TO DWG 501 FOR TYPICAL SUMP PUMP RESIDENTIAL STORM SEWER CONNECTION DETAIL.
- ALL UNITS TO COMPLY WITH SECTION 7.4.6.4 (3b) OF THE ONTARIO BUILDING CODE REGARDING BACKWATER VALVE REQUIREMENTS.

**BENCHMARK**  
ELEVATIONS ARE GEODETIC AND REFERRED TO THE TOWN OF OAKVILLE BENCHMARK HAVING AN ORTHOMETRIC ELEVATION OF 133.458 METRES. ELEVATIONS ARE REFERENCED TO THE CANADIAN GEODETIC VERTICAL DATUM OF 1928. PRE-1978 ADJUSTMENT (CGVD-1928/PRE-1978). ELEVATION OF BENCHMARK ESTABLISHED AT THE CORNER OF THE WESTERLY EDGE OF CONCRETE GARAGE DOOR SILL AT #1351 GREENRIDGE CIRCLE.

**BRANTHAVEN WEST OAK INC.**  
**WESTOAK TRAILS BLOCK 107, PLAN 20M-696**  
TOWN FILE # Z.1427.13

OAKVILLE REGIONAL MUNICIPALITY OF HALTON  
**TOWN OF OAKVILLE**

Urbantech Consulting  
A Division of Leighton-Zec Ltd.  
3760 14th Avenue, Suite 301,  
Markham, ON L3R 3T7  
TEL 905.946.9461 • urbantech.com



**SITE SERVICING PLAN**

DESIGNED:	A.M.	CHECKED:	A.M.	PROJECT No.:	20-640
DRAWN:	R.A.	DATE:	April 12, 2024	SHEET No.:	
SCALE:			1:300	DRAWING No.:	<b>AC101</b>