

**NOTE**  
ALL VALVES TO BE CAST IRON EPOXY COATED

**NOTE**  
FOR SERVICING, GRADING, ROAD AND EROSION CONTROL NOTES, REFER TO DRAWING No. 1

**NOTE**  
FOR AREA DRAINS (AD), SEE MECHANICAL DRAWINGS FOR DETAILS.

**NOTE RE: WATERMAIN / WATER SERVICE**  
INSULATION REQUIRED FOR WATERMAIN / WATER SERVICE WHERE THE SEPARATION BETWEEN WATERMAIN / WATER SERVICE AND OTHER SERVICES AND STRUCTURES IS LESS THAN 2.5m AND THE COVER IS LESS THAN 1.7m. REFER TO DETAIL ON DWG. 7 UNLESS OTHERWISE SPECIFIED.

ANY DISTURBED AREA DURING CONSTRUCTION TO BE RESTORED TO THE ORIGINAL CONDITION OR BETTER TO THE SATISFACTION OF THE AUTHORITIES HAVING JURISDICTION

CONTRACTOR TO VERIFY THE PRECISE LOCATIONS AND INVERT ELEVATIONS OF EX UNDERGROUND SERVICES AND EX UTILITIES PRIOR TO STARTING CONSTRUCTION

PERMISSION REQUIRED FOR WORK ON ADJACENT LANDS

**NOTE:**  
ALL EXISTING BUILDINGS, POST & WIRE FENCE, TREES, UTILITY POLES, CULVERTS AND RETAINING WALLS, ETC. WITHIN LOTS AND BLOCKS TO BE REMOVED, UNLESS OTHERWISE NOTED

**NOTE: SUMP PUMP**  
FOR FLOOD PROTECTION, SUMP PUMP TO BE PROVIDED FOR ALL UNDERGROUND PARKING FACILITIES. REFER TO MECHANICAL DRAWINGS FOR DETAIL, WHERE APPLICABLE.

**NOTE RE: WATERMAIN PRV'S**  
INDIVIDUAL PRESSURE REDUCING VALVES WILL BE REQUIRED FOR HOMES IN AREAS WHERE THE SERVICE PRESSURES IN WATERMAIN WILL BE ABOVE 80psi (550kPa). CONTRACTOR TO VERIFY PRESSURE IN THE FIELD PRIOR TO STARTING CONSTRUCTION. REFER TO HYDRAULIC CAPACITY AND MODELING ANALYSIS, PRESERVE PHASE 3 - BLOCK 300 DEVELOPMENT, BY GEADWICE ENGINEERING INC. FROM JUNE 6, 2022.

STM MANHOLE INFO		
DCBMH 4 (OPSD-701.011&OPSD-400.110)	1500	
TOP ELEV.	171.05	
375Ø	E INV.	169.280
DCBMH 3 (OPSD-701.011&OPSD-400.110)	1500	
TOP ELEV.	171.48	
375Ø	W INV.	169.104
450Ø	E INV.	169.024
STM CONTROL MH 2 (OPSD-701.010)	1200	
TOP ELEV.	171.35	
450Ø	N INV.	168.918
450Ø	W INV.	169.715
525Ø	E INV.	168.843

SAN MANHOLE INFO		
MH 6A (OPSD-701.010)	1200	
TOP ELEV.	171.59	
200Ø	W INV.	168.410
MH 5A (OPSD-701.010)	1200	
TOP ELEV.	171.52	
200Ø	E INV.	168.110
200Ø	W INV.	168.080
MH 7A (OPSD-701.010)	1200	
TOP ELEV.	171.25	
250Ø	E INV.	168.295
250Ø	N INV.	168.235
SAN CONTROL MH 4A (OPSD-701.010)	1200	
TOP ELEV.	171.12	
200Ø	E INV.	167.750
250Ø	S INV.	167.760
250Ø	W INV.	167.700
MH 5340A (OPSD-701.010)	1200	
TOP ELEV.	170.97	
250Ø	E INV.	167.605
200Ø	S INV.	167.525
200Ø	N INV.	167.525

PIPE CROSSING TABLE					
<b>CROSS 1</b>					
TOP ELEV.	171.56		(OUTSIDE OF PIPE)		
150Ø	WM	INV. 169.740	INV. 169.740		Clearance = 1.381m
200Ø	SAN	OBV. 168.359	OBV. 168.359		
<b>CROSS 2</b>					
TOP ELEV.	171.52		(OUTSIDE OF PIPE)		
150Ø	WM	INV. 169.706	INV. 169.706		Clearance = 0.150m
375Ø	STM	OBV. 169.556	OBV. 169.556		
<b>CROSS 3</b>					
TOP ELEV.	171.45		(OUTSIDE OF PIPE)		
450Ø	STM	INV. 168.938	INV. 168.855		Clearance = 0.500m
150Ø	WM	OBV. 168.355	OBV. 168.355		
<b>CROSS 4</b>					
TOP ELEV.	171.43		(OUTSIDE OF PIPE)		
450Ø	STM	INV. 168.932	INV. 168.850		Clearance = 0.500m
200Ø	WM	OBV. 168.350	OBV. 168.350		
<b>CROSS 5</b>					
TOP ELEV.	170.98		(OUTSIDE OF PIPE)		
150Ø	WM	INV. 168.826	INV. 168.826		Clearance = 0.942m
250Ø	SAN	OBV. 167.884	OBV. 167.884		

- LEGEND**
- STORM MANHOLE
  - SANITARY MANHOLE
  - SANITARY MANHOLE BY OTHERS
  - SINGLE SANITARY HOUSE CONNECTION
  - SINGLE STORM HOUSE CONNECTION
  - WATER CONNECTION
  - MOUNTABLE CURB (OPSD 600.060)
  - BARRIER CURB WITH DEPRESSED SECTION (OPSD 600.110)
  - CONCRETE SIDEWALK RAMP (OPSD 310.033)
  - CURB STOP SERVICE
  - HYDRANT
  - TEE
  - VALVE & BOX
  - VALVE & CHAMBER
  - SINGLE CATCHBASIN
  - DOUBLE CATCHBASIN
  - PHASE LINE
  - BOREHOLE LOCATIONS
  - DOWNSPOUT

**NOTE RE: SWM POND 13 PDB INFO**  
100 YR. WATER LEVEL = 168.663  
MAX. REGIONAL POND LEVEL = 170.112  
EMERGENCY OVERFLOW = 170.35  
THE ABOVE MENTIONED WATER LEVELS ARE AS PER PDB REPORT FOR SWM POND 13 - PHASE 3 OF THE PRESERVE SUBDIVISION, PROJECT NO. 14-744 BY DSEL.

**NOTE RE: MH 438 SWM INFO**  
100 YR. WATER LEVEL = 169.358  
(100 YR. WATER LEVEL AS PER SWM REPORT FOR PRESERVE SUBDIVISION PHASE 3, PROJECT NO. 14-744). THE ABOVE MENTIONED WATER LEVEL IS UNDER THE STM CONNECTION POINT INVERT ELEVATION OF 170.125. THIS INFORMATION HAS BEEN PROVIDED TO THE MECHANICAL DESIGNER FOR THEIR PURPOSES. 5 YR. EVENT FREQUENCY HAS BEEN USED FOR STM SYSTEM DESIGN.

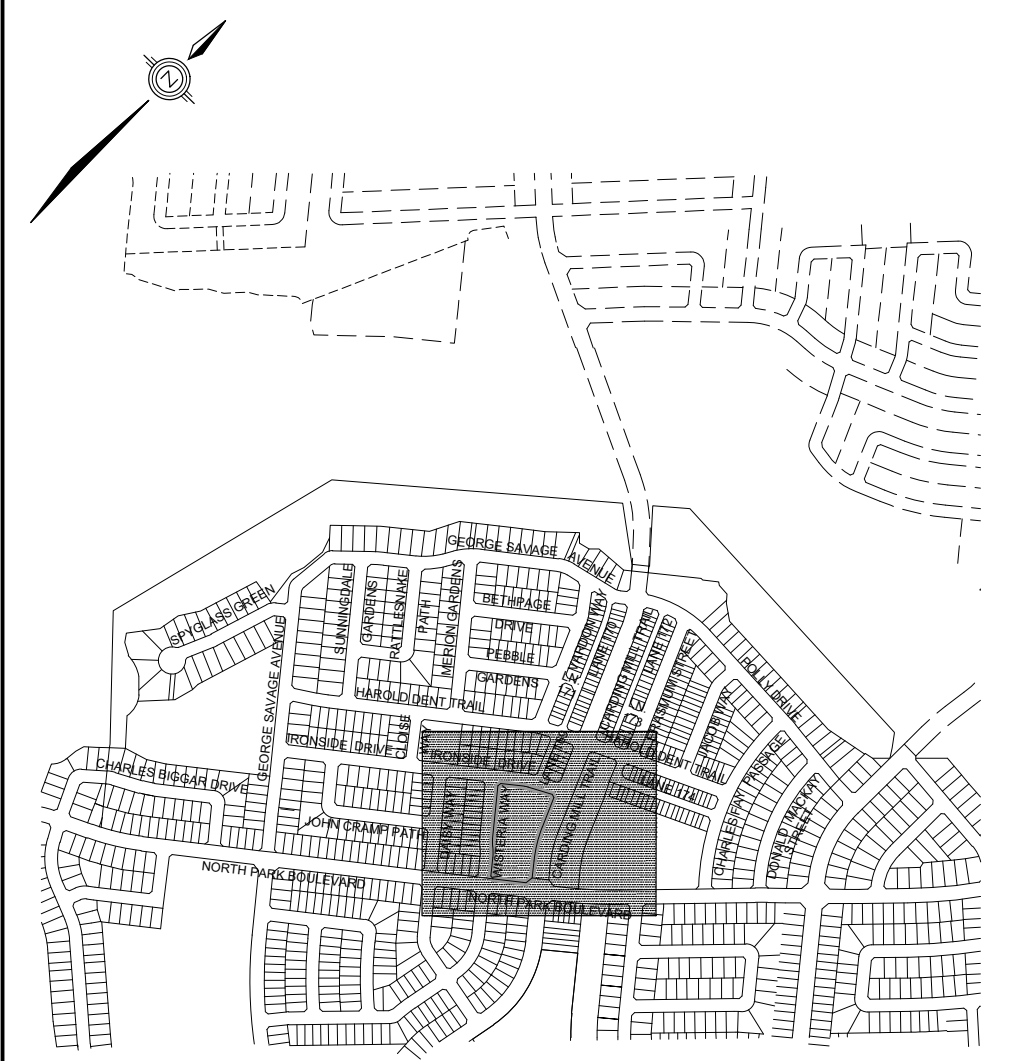

**KEY PLAN**  
SCALE 1:10000

**TOPOGRAPHIC INFORMATION**  
TOPOGRAPHIC INFORMATION PROVIDED BY PENTEK & EDWARD SURVEYING LTD.: JOB No. 16-146, TOPOGRAPHIC SURVEY DATED ON JULY 5, 2016 AND DATED JULY 20, 2016.  
MAJESTIC MACKLIN MONAGHAN ONTARIO LTD., JOB No 20-05052-00-000, TOPOGRAPHIC SURVEY DATED JUNE 11, 2005 TO JULY 21, 2005.

**SITE PLAN INFORMATION**  
SITE PLAN PROVIDED BY CH ARCHITECTS INC., JOB No. 21010, RECEIVED ON MAY 8, 2023.

**NOT FOR CONSTRUCTION**

**BENCHMARK NOTE**  
ELEVATIONS ARE GEODETIC AND ARE REFERRED TO MINISTRY OF TRANSPORTATION ONTARIO 100 YR. WATER LEVEL AS PER SWM REPORT FOR PRESERVE SUBDIVISION PHASE 3, PROJECT NO. 14-744. THE ABOVE MENTIONED WATER LEVEL IS UNDER THE STM CONNECTION POINT INVERT ELEVATION OF 170.125. THIS INFORMATION HAS BEEN PROVIDED TO THE MECHANICAL DESIGNER FOR THEIR PURPOSES. 5 YR. EVENT FREQUENCY HAS BEEN USED FOR STM SYSTEM DESIGN.

No.	DATE	BY
3.	23-05-26	K.S.
2.	22-11-11	K.M.
1.	22-06-13	K.M.

DESIGNED BY:	P.P./T.H.	CHECKED BY:	K.M.	DATE	JUNE 2022
DRAWN BY:	T.H.	CHECKED BY:	P.P.	REFERENCES	

APPROVALS		FIELD NOTES
MUNICIPAL APPROVAL	APPROVED IN PRINCIPLE SUBJECT TO DETAIL CONSTRUCTION CONFORMING TO TOWN OF OAKVILLE STANDARDS AND SPECIFICATIONS	BELL <input type="checkbox"/> HYDRO <input type="checkbox"/>
MANAGER OF DEVELOPMENT ENGINEERING	DATE	GAS <input type="checkbox"/> CABLE <input type="checkbox"/>
REGIONAL APPROVAL	DESIGN OF SANITARY, WATER SERVICES AND REGIONAL ROAD WORKS APPROVED SUBJECT TO DETAIL CONSTRUCTION CONFORMING TO HALTON REGION STANDARDS & SPECIFICATIONS & LOCAL APPROVAL FROM AREA MUNICIPALITY	TRAFFIC <input type="checkbox"/> WATER <input type="checkbox"/>

LEGISLATIVE AND PLANNING SERVICES

DATE

SCALE: HORIZ. 1:400

REFERENCES

STAMP: LICENSED PROFESSIONAL ENGINEER, K. M. SCUDAMORE, 00220845, 2023-05-27, PROVINCE OF ONTARIO

**DSEL** 600 Alden Road, Suite 700, Markham, Ontario, L3R 0E7, Tel. (905) 475-3080, Fax. (905) 475-3081, www.DSEL.ca

MUNICIPALITY: **OAKVILLE** DEVELOPMENT ENGINEERING

REGION: **Halton** The Regional Municipality of Halton

DEVELOPER: **PENDENT DEVELOPMENTS LTD.**

DEVELOPMENT MANAGER: **PH/ PEN**

PROJECT: **PRESERVE NORTH SITE PLAN (BLOCK 300)**  
3250 CARDING MILL TRAIL, 256-292 IRONSIDE DRIVE

**GENERAL PLAN**

MUNICIPAL FILE NO.	REGIONAL FILE NO.
XX.XXXXXXX	XXXXXXX
PROJECT NO.	SHEET 2 OF 9

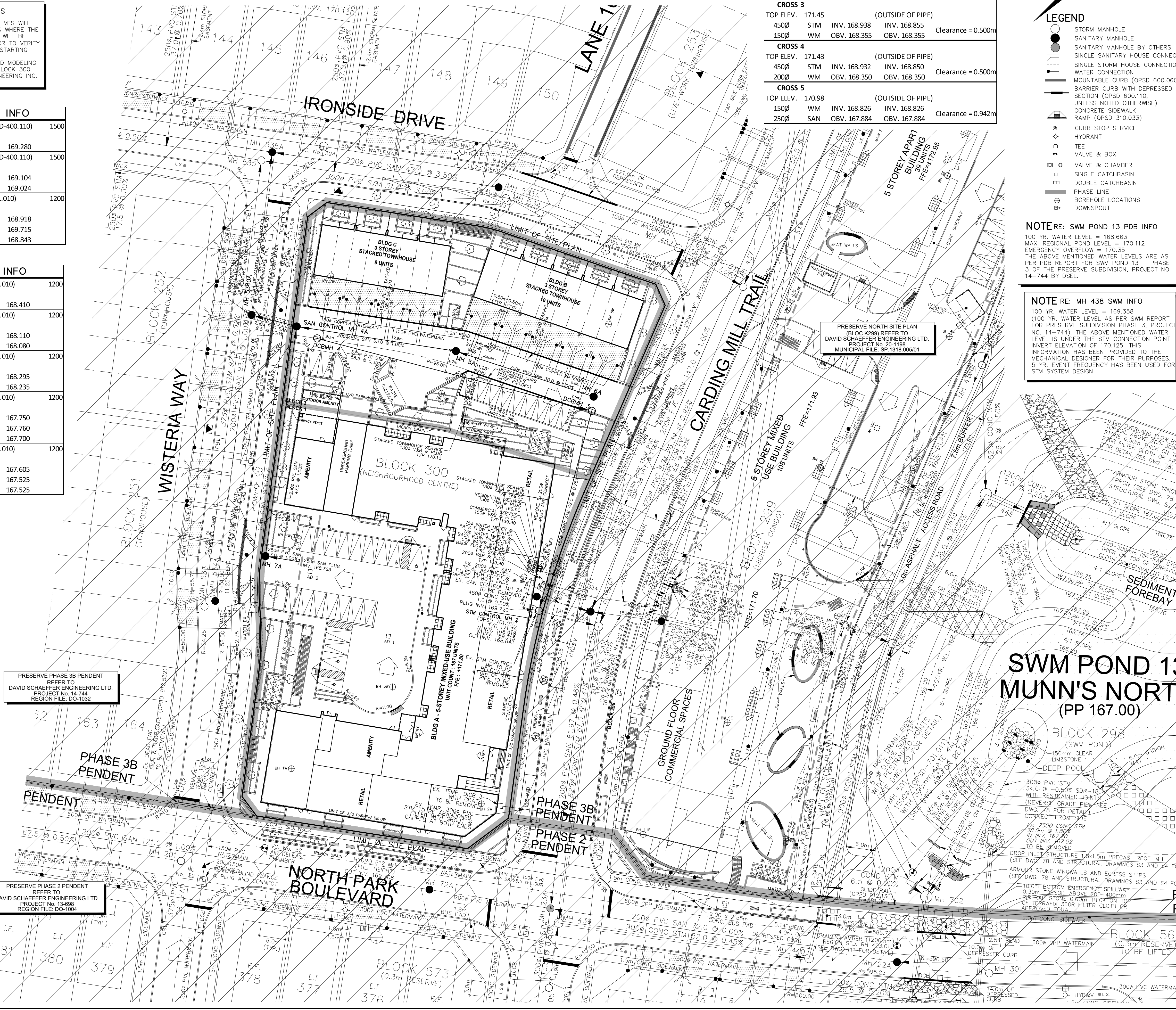

PRESERVE PHASE 3B PENDENT REFER TO DAVID SCHAEFFER ENGINEERING LTD. PROJECT No. 14-744 REGION FILE: DO-1032

PRESERVE PHASE 2 PENDENT REFER TO DAVID SCHAEFFER ENGINEERING LTD. PROJECT No. 14-888 REGION FILE: DO-1004

**SWM POND 13**  
**MUNN'S NORTH**  
(PP 167.00)

