

KEY	TREE #	Botanical Name	Common Name	Size/Remarks	Qty	Stature (m)	Volume (m³)	Canopy Area (m²)	Canopy Density (%)
Proposed Trees									
	LT1-19	TDB	TDB	TDB	19	L	TBD	TBD	TBD
	ST1-3	TDB	TDB	TDB	3	S	TBD	TBD	TBD
	ST4-6	TDB	TDB	TDB	3	S	TBD	TBD	TBD
	LT20-21	TDB	TDB	TDB	2	L	TBD	TBD	TBD
	LT22-24	TDB	TDB	TDB	3	L	TBD	TBD	TBD
	LT25-36 & MT1	TDB	TDB	TDB	13	L/M	TBD	TBD	TBD
	LT37-40/72	TDB	TDB	TDB	4	L/M	TBD	TBD	TBD
	LT44-46	TDB	TDB	TDB	4	L/M	TBD	TBD	TBD
	LT48-51	TDB	TDB	TDB	4	L	TBD	TBD	TBD
	LT50-51	TDB	TDB	TDB	2	L	TBD	TBD	TBD
	LT57-10	TDB	TDB	TDB	4	S	TBD	TBD	TBD
	LT52-60	TDB	TDB	TDB	9	L	TBD	TBD	TBD
	LT61-70	TDB	TDB	TDB	10	L	TBD	TBD	TBD
	LT71-77	TDB	TDB	TDB	7	L	TBD	TBD	TBD
Subtotal					0.0	multiplied by bonus factor of 1.5		0	0
Existing Canopy on Site									
Existing Canopy Overhanging Site									

Canopy Summary	Site Area (m²)	Site Canopy Cover	Land Use Canopy Cover Target
CANOPY SUMMARY	19,551	40.8%	15-34%
TOTAL CANOPY m2	7,982		
Total # of Trees within 5m of Parking Area			
Total Parking Spaces Proposed			
Total # of Trees within 5m of Parking Area			

Canopy Cover Analysis

Based on the driplines reported in the inventory, a canopy cover analysis was completed to determine the amount of canopy identified for preservation and the proposed amount of canopy based on new plantings. Where proposed trees are situated together and their canopies form continuous cover, the canopy area was determined for the group of trees such that overlapping canopy areas were omitted. The canopy areas of trees situated outside of the site boundary whose canopies overhang the site boundary were calculated; a bonus factor was not applied to the canopy areas of these trees. Trees located outside of the site boundary whose canopies do not overhang the site boundary were not included in the canopy cover analysis.

The preservation of 0m² of existing canopy is proposed. Proposed landscape plantings account for a proposed coverage of 7,982m² of canopy area. The total canopy area is therefore 7,982m² within a total subject area of 19,551m², resulting in a canopy coverage of 41%. There are various uses proposed for the site, with target canopy coverages between 15-34%, so targets are exceeded.

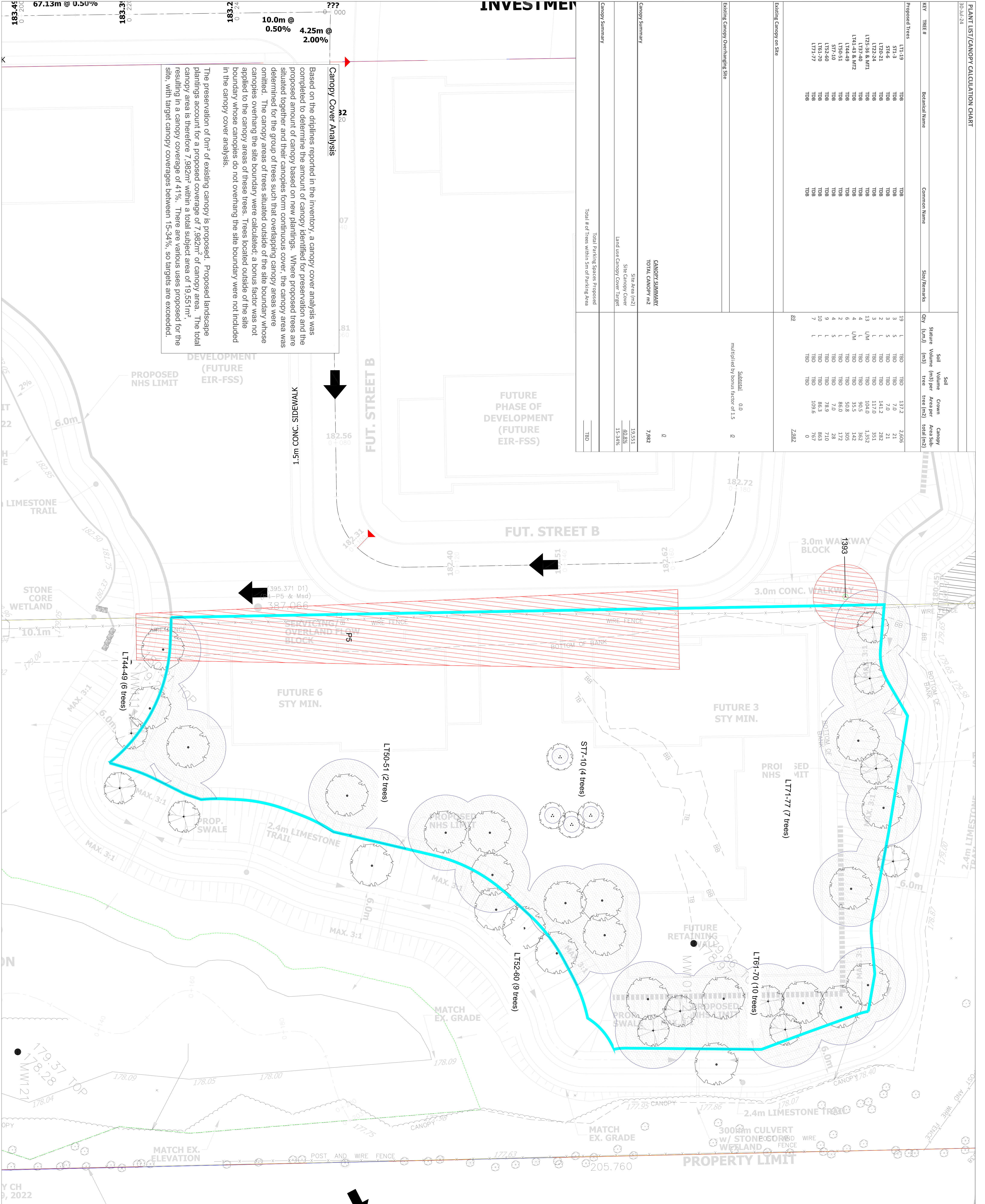

LEGEND

- Site Boundary*
- Canopy Identified for Preservation
- Canopy Identified for Removal
- Proposed Canopy
- Proposed multi-stemmed tree (small)
- Proposed deciduous trees (large)
- Proposed coniferous trees (medium)
- Existing Tree Number
- Proposed Tree Number

* For the purposes of the Canopy Cover Analysis, the "site" is defined as a combination of the property line and the proposed NHS. Where proposed trees within the NHS will have canopies that extend into the site boundary, those trees and the portions of canopies that extend onto the subject site have been included in the calculation. Where proposed trees are within the site boundary, the portions of their crowns that extend beyond the site boundary have also been included. Trees proposed as part of the development parcel to the west have been excluded from the calculation.

No.	Issue/Revisions	Date	By
1	Report Submission	12 July 23	CB
2	CCP Update	30 July 24	CB

KUNTZ FORESTRY CONSULTING INC.

146 Lakeshore Road West
PO Box 1287 Lakeshore W. PO
Oakville, ON L6K 0B3
e: info@kuntzforestry.ca
w: www.kuntzforestry.ca

Seferian Design Group
761 Brant Street, Suite 202
Burlington, Ontario L7R 2H7

Property
3275-3301 Trafalgar Road
Oakville, Ontario

Canopy Cover Analysis

Project	P3824	Figure	
Date	12 July 2023	CCP-2	
Scale	1:300		