

Calculation Summary

Label	CalcType	Units	Avg	Max	Min	Avg/Min	Max/Min
LIGHTSPILL	illuminance	Fc	0.00	0.2	0.0	N.A.	N.A.
SITE	illuminance	Fc	1.39	4.2	0.3	4.63	14.00

**NOTES :**

- ALL EXTERIOR LIGHTING FIXTURES ARE DARK SKY FRIENDLY
- ALL EXTERIOR WALL MOUNTED AND POLE MOUNTED LUMINAIRE ARE LED
- ALL EXTERIOR LUMINAIRE TO BE CONTROLLED BY PHOTOCELL AND TIMECLOCK 'OFF'.
- OVERALL SITE LIGHTING WILL BE REDUCED TO AVERAGE OF 1 FC OR LESS AFTER 1:00PM ON THE CLOSE OF BUSINESS WHICHEVER IS LATER.
- ALL LIGHTING DEVICES SHALL BE FULL CUT OFF AND NIGHT SKY FRIENDLY AND SHALL BE MITIGATED AT THE SOURCE SO THAT NO LIGHT (0FC) WILL BE DIRECTLY PROJECTED ONTO ADJACENT PROPERTIES.

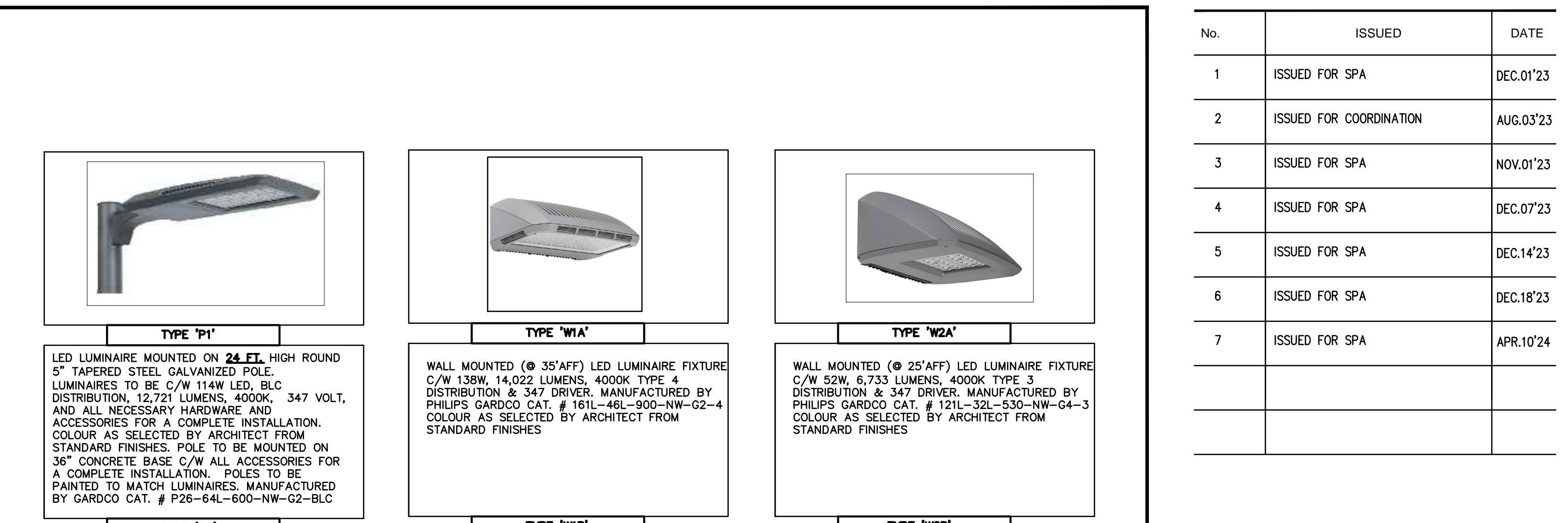

**TYPE 'P1'**

LED LUMINAIRE MOUNTED ON 24 FT. HIGH ROUND 5" TAPERED STEEL GALVANIZED POLE. LUMINAIRE TO BE C/W 114W LED, BLC DISTRIBUTION, 12,721 LUMENS, 4000K, 347 VOLT, AND ALL NECESSARY HARDWARE AND ACCESSORIES FOR A COMPLETE INSTALLATION. COLOUR AS SELECTED BY ARCHITECT FROM STANDARD FINISHES. POLE TO BE MOUNTED ON 36" CONCRETE BASE C/W ALL ACCESSORIES FOR A COMPLETE INSTALLATION. POLES TO BE PAINTED TO MATCH LUMINAIRE, MANUFACTURED BY GARDCO CAT. # P26-84L-600-NW-G2-BLC

**TYPE 'P2'**

LED LUMINAIRE MOUNTED ON 24 FT. HIGH ROUND 5" TAPERED STEEL GALVANIZED POLE. LUMINAIRE TO BE C/W 101W LED, TYPE 4 DISTRIBUTION, 14,351 LUMENS, 4000K, 347 VOLT, AND ALL NECESSARY HARDWARE AND ACCESSORIES FOR A COMPLETE INSTALLATION. COLOUR AS SELECTED BY ARCHITECT FROM STANDARD FINISHES. POLE TO BE MOUNTED ON 36" CONCRETE BASE C/W ALL ACCESSORIES FOR A COMPLETE INSTALLATION. POLES TO BE PAINTED TO MATCH LUMINAIRE, MANUFACTURED BY GARDCO CAT. # P26-48L-700-NW-G2-4

**TYPE 'P3'**

LED LUMINAIRE (4 @ 90) MOUNTED ON 38 FT. HIGH ROUND 5" TAPERED STEEL GALVANIZED POLE. LUMINAIRE TO BE C/W 101W LED, TYPE 5W DISTRIBUTION, 14,819 LUMENS, 4000K, 347 VOLT, AND ALL NECESSARY HARDWARE AND ACCESSORIES FOR A COMPLETE INSTALLATION. COLOUR AS SELECTED BY ARCHITECT FROM STANDARD FINISHES. POLE TO BE MOUNTED ON 36" CONCRETE BASE C/W ALL ACCESSORIES FOR A COMPLETE INSTALLATION. POLES TO BE PAINTED TO MATCH LUMINAIRE, MANUFACTURED BY GARDCO CAT. # P26-48L-700-NW-G2-5W

**TYPE 'P4'**

LED LUMINAIRE (BACK TO BACK) MOUNTED ON 24 FT. HIGH ROUND 5" TAPERED STEEL GALVANIZED POLE. LUMINAIRE TO BE C/W 101W LED, TYPE 5W DISTRIBUTION, 14,819 LUMENS, 4000K, 347 VOLT, AND ALL NECESSARY HARDWARE AND ACCESSORIES FOR A COMPLETE INSTALLATION. COLOUR AS SELECTED BY ARCHITECT FROM STANDARD FINISHES. POLE TO BE MOUNTED ON 36" CONCRETE BASE C/W ALL ACCESSORIES FOR A COMPLETE INSTALLATION. POLES TO BE PAINTED TO MATCH LUMINAIRE, MANUFACTURED BY GARDCO CAT. # P26-48L-700-NW-G2-5W

**TYPE 'W1A'**

WALL MOUNTED (Ø 35'AFF) LED LUMINAIRE FIXTURE C/W 138W, 14,022 LUMENS, 4000K TYPE 4 DISTRIBUTION & 347 DRIVER, MANUFACTURED BY PHILIPS GARDCO CAT. # 161L-46L-900-NW-G2-4 COLOUR AS SELECTED BY ARCHITECT FROM STANDARD FINISHES

**TYPE 'W1B'**

WALL MOUNTED (Ø 30'AFF) LED LUMINAIRE FIXTURE C/W 138W, 14,022 LUMENS, 4000K TYPE 4 DISTRIBUTION & 347 DRIVER, MANUFACTURED BY PHILIPS GARDCO CAT. # 161L-46L-900-NW-G2-4 COLOUR AS SELECTED BY ARCHITECT FROM STANDARD FINISHES

**TYPE 'W2A'**

WALL MOUNTED (Ø 25'AFF) LED LUMINAIRE FIXTURE C/W 52W, 6,733 LUMENS, 4000K TYPE 3 DISTRIBUTION & 347 DRIVER, MANUFACTURED BY PHILIPS GARDCO CAT. # 121L-32L-530-NW-G4-3 COLOUR AS SELECTED BY ARCHITECT FROM STANDARD FINISHES

**TYPE 'W2B'**

WALL MOUNTED (Ø 22'AFF) LED LUMINAIRE FIXTURE C/W 52W, 6,733 LUMENS, 4000K TYPE 3 DISTRIBUTION & 347 DRIVER, MANUFACTURED BY PHILIPS GARDCO CAT. # 121L-32L-530-NW-G4-3 COLOUR AS SELECTED BY ARCHITECT FROM STANDARD FINISHES

**TYPE 'W2C'**

WALL MOUNTED (Ø 20'AFF) LED LUMINAIRE FIXTURE C/W 52W, 6,733 LUMENS, 4000K TYPE 3 DISTRIBUTION & 347 DRIVER, MANUFACTURED BY PHILIPS GARDCO CAT. # 121L-32L-530-NW-G4-3 COLOUR AS SELECTED BY ARCHITECT FROM STANDARD FINISHES

**TYPE 'W3'**

WALL MOUNTED (Ø 30'AFF) LED LUMINAIRE FIXTURE C/W 52W, 6,733 LUMENS, 4000K TYPE 3 DISTRIBUTION & 347 DRIVER, MANUFACTURED BY PHILIPS GARDCO CAT. # 121L-32L-1000-NW-G4-4 COLOUR AS SELECTED BY ARCHITECT FROM STANDARD FINISHES

**TYPE 'W3'**

WALL MOUNTED (Ø 30'AFF) LED LUMINAIRE FIXTURE C/W 52W, 6,733 LUMENS, 4000K TYPE 3 DISTRIBUTION & 347 DRIVER, MANUFACTURED BY PHILIPS GARDCO CAT. # 121L-32L-1000-NW-G4-4 COLOUR AS SELECTED BY ARCHITECT FROM STANDARD FINISHES

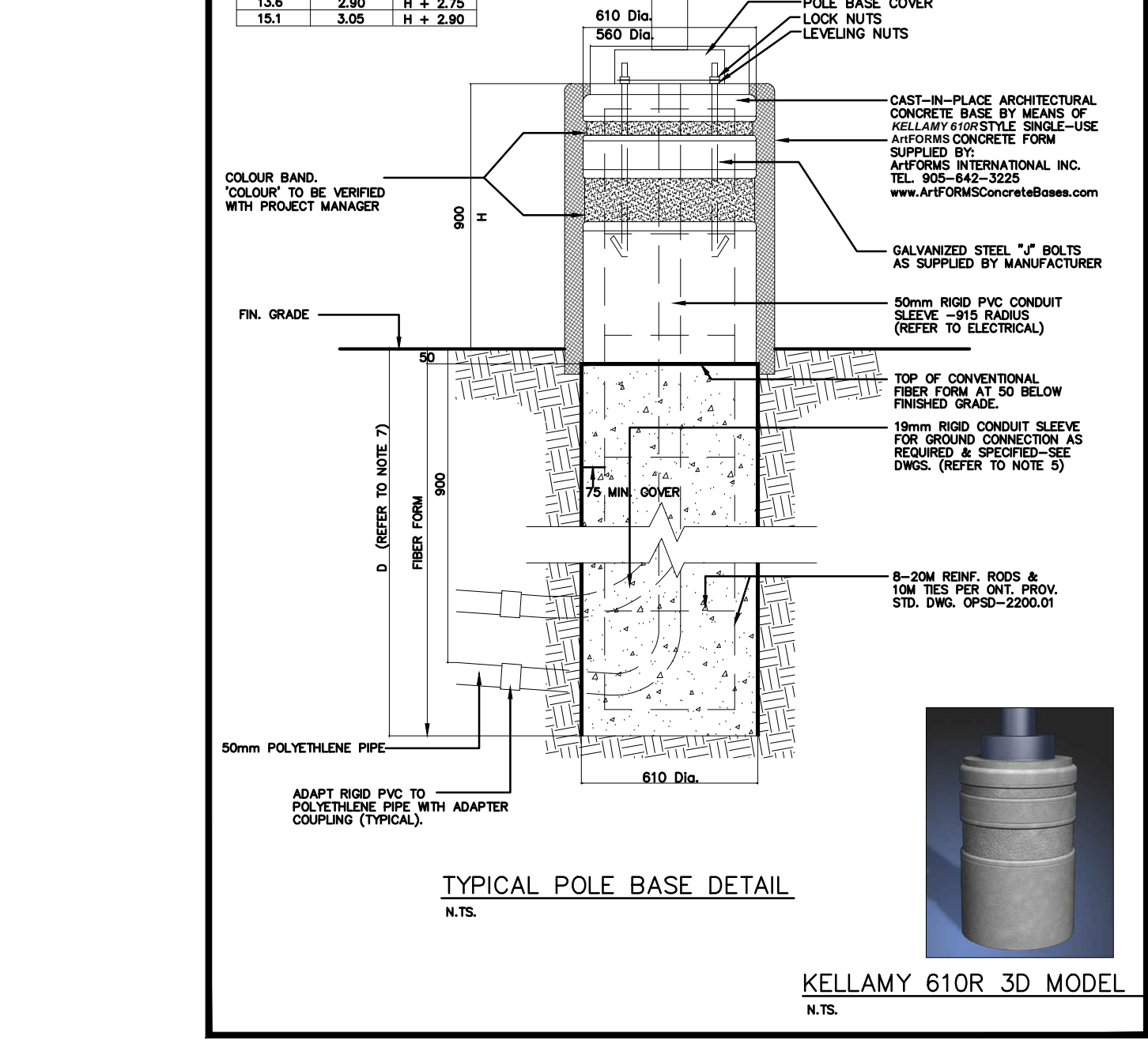
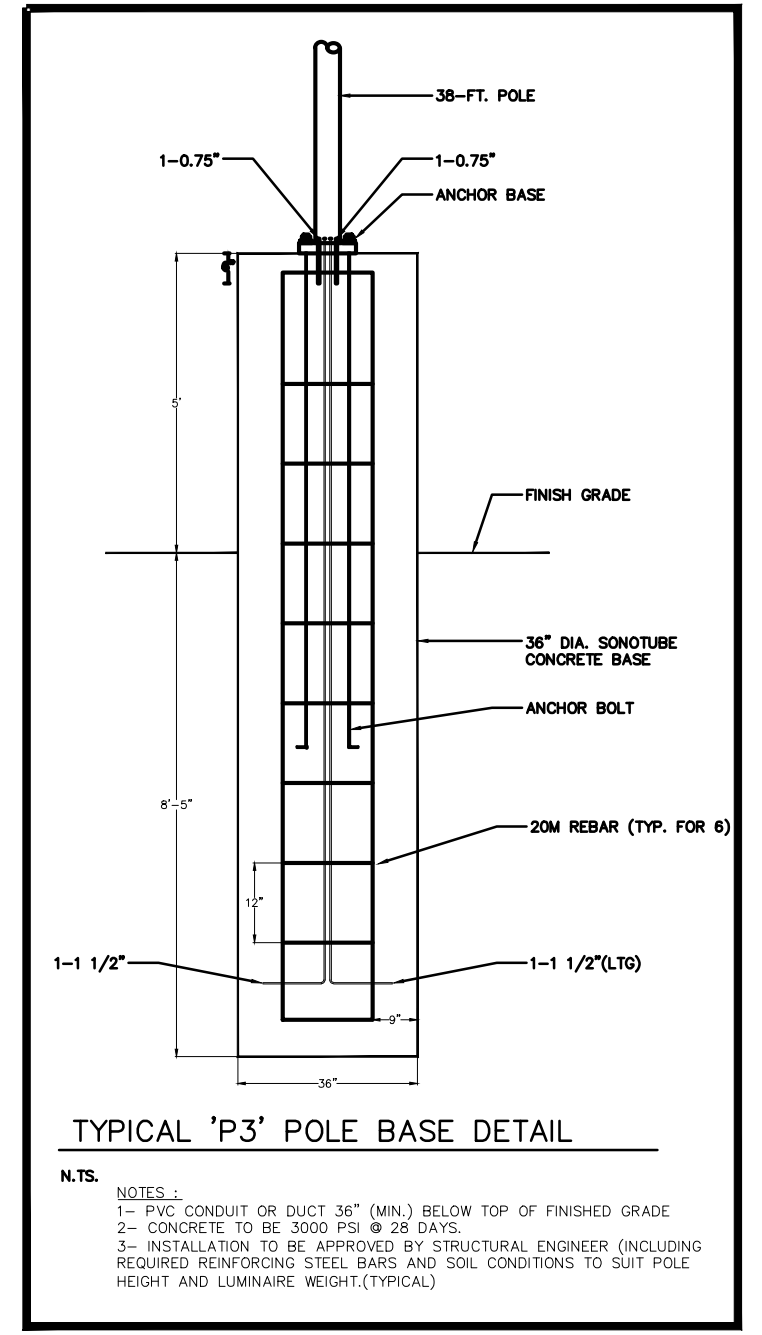

POLE LENGTH (m)	BASE DIAL DEPTH (m)	REF. ROD LENGTH (m)
3.0	1.50	H + 1.30
5.6	2.15	H + 2.00
7.0	2.15	H + 2.00
7.6	2.15	H + 2.00
8.7	2.45	H + 2.30
8.0	2.45	H + 2.30
10.5	2.60	H + 2.45
12.0	2.75	H + 2.60
13.6	2.90	H + 2.75
15.1	3.05	H + 2.90

No.	ISSUED	DATE
1	ISSUED FOR SPA	DEC.01'23
2	ISSUED FOR COORDINATION	AUG.03'23
3	ISSUED FOR SPA	NOV.01'23
4	ISSUED FOR SPA	DEC.07'23
5	ISSUED FOR SPA	DEC.14'23
6	ISSUED FOR SPA	DEC.18'23
7	ISSUED FOR SPA	APR.10'24
No.	REVISION	DATE

**BALDASSARRA Architects Inc.**

30 Great Gulf Drive, Unit 20 | Concord ON | L4K 0K7  
T. 905.660.0722 | www.baldassarra.ca

**MJA ENGINEERING LTD.**  
ELECTRICAL ENGINEERS

556 EDWARD AVENUE, UNIT 82  
RICHMOND HILL, ONTARIO  
L4C 9Y5, CANADA  
PHONE: (905) 780-8590 FAX: (905) 780-8591  
EMAIL: engineering@mjaeng.com  
WEB SITE: www.mjaeng.com

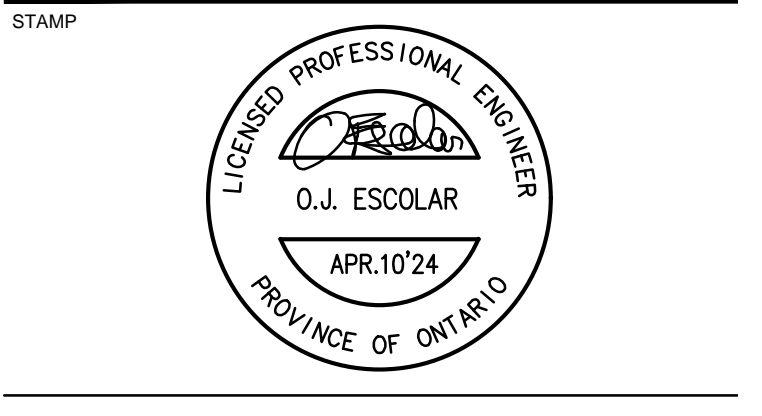

772 Winston Churchill  
Oakville, ON

**ELECTRICAL SITE LIGHTING**

DATE: NOV. 2022 DRAWN BY: HG CHECKED: OE SCALE: 1:1000  
PROJECT No. DRAWING No.

2022-241 **ESL**

KELLY 610R 3D MODEL