

BF.1

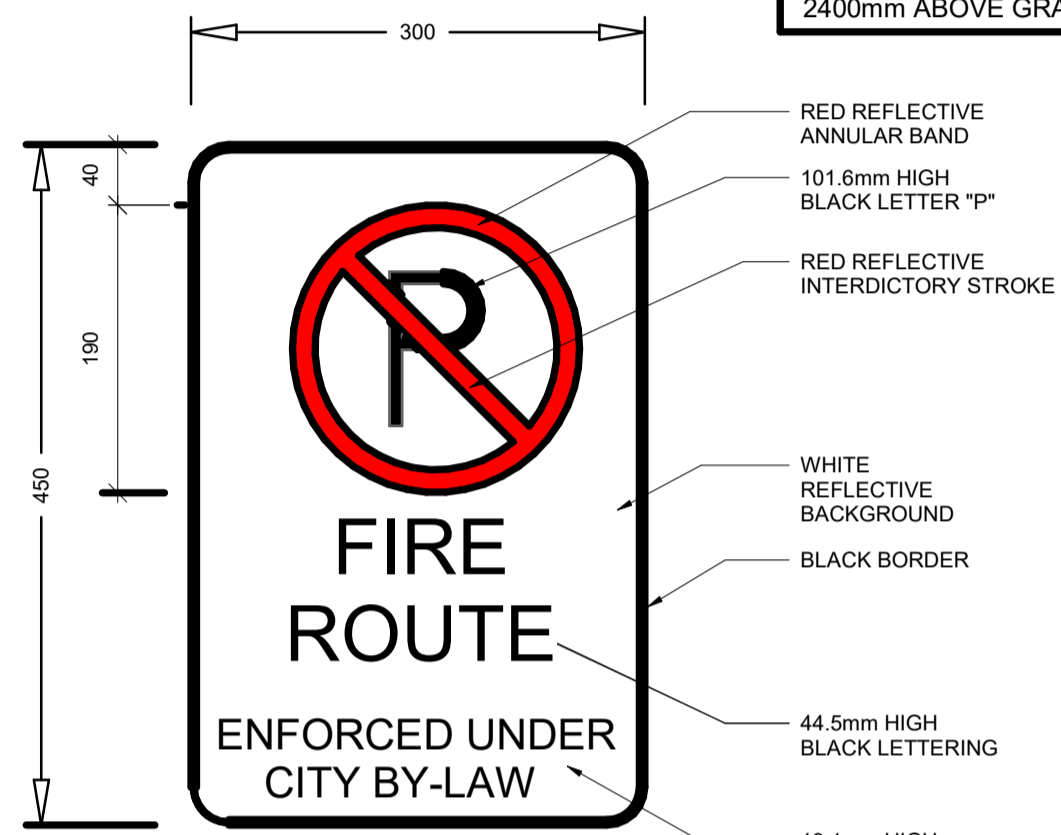

FR.1

SIGNS TO BE MOUNTED ON 64m STEEL SIGN POST 2400mm ABOVE GRADE

1013 SITE SIGNAGE DETAILS
A1.01

0 50 100 250mm
1:5 WHEN PLOTTED ON A1 SHEET SIZE

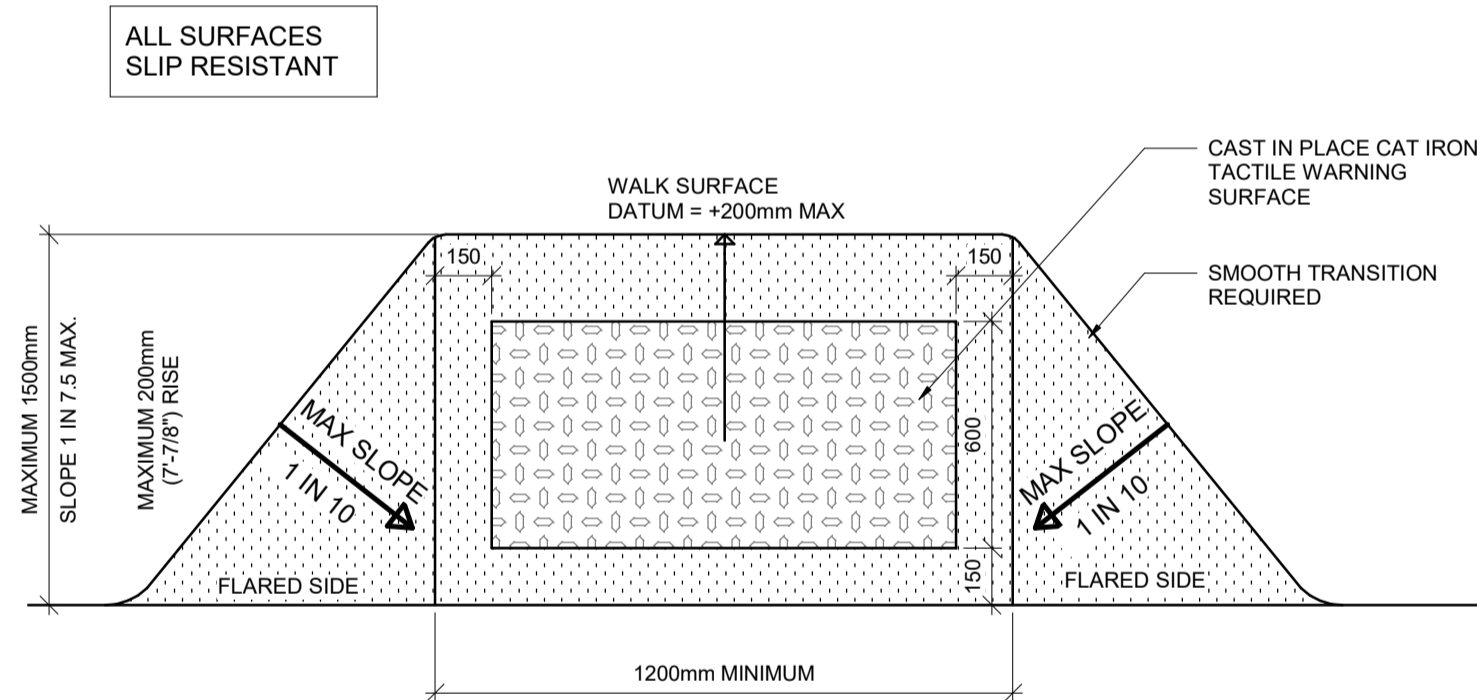

1014 BARRIER FREE CURB RAMP DETAIL (DC)
A1.01

0 200 500 1000mm
1:20 WHEN PLOTTED ON A1 SHEET SIZE

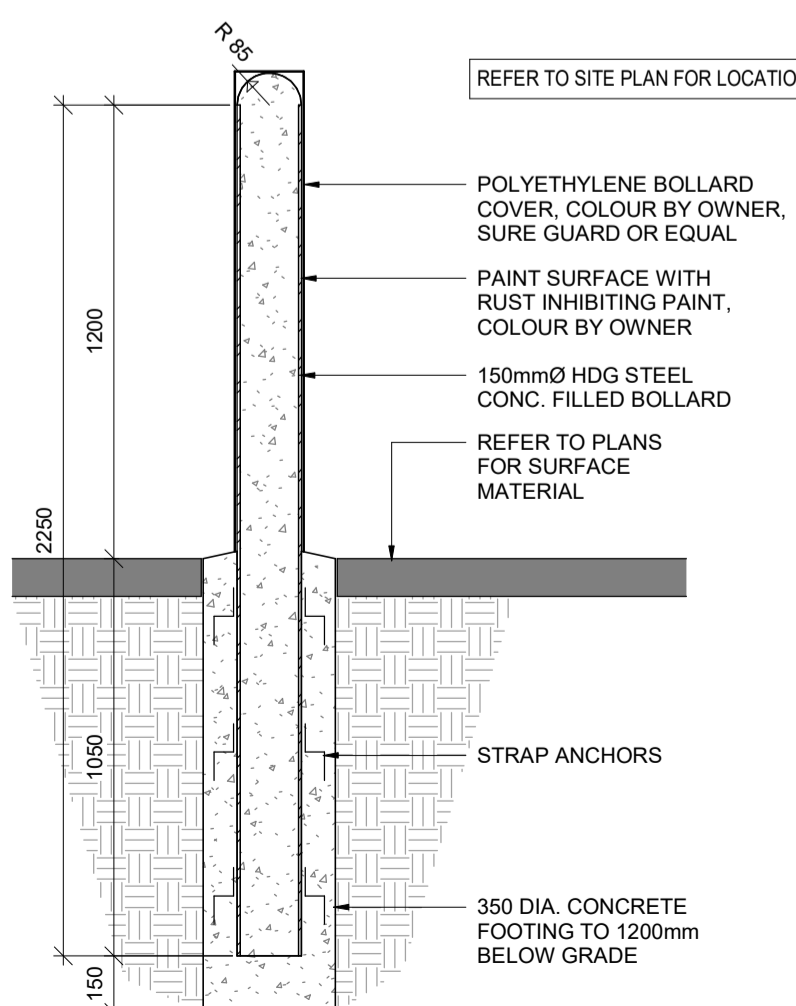

1012 BOLLARD DETAIL
A1.01

0 200 500 1000mm
1:20 WHEN PLOTTED ON A1 SHEET SIZE

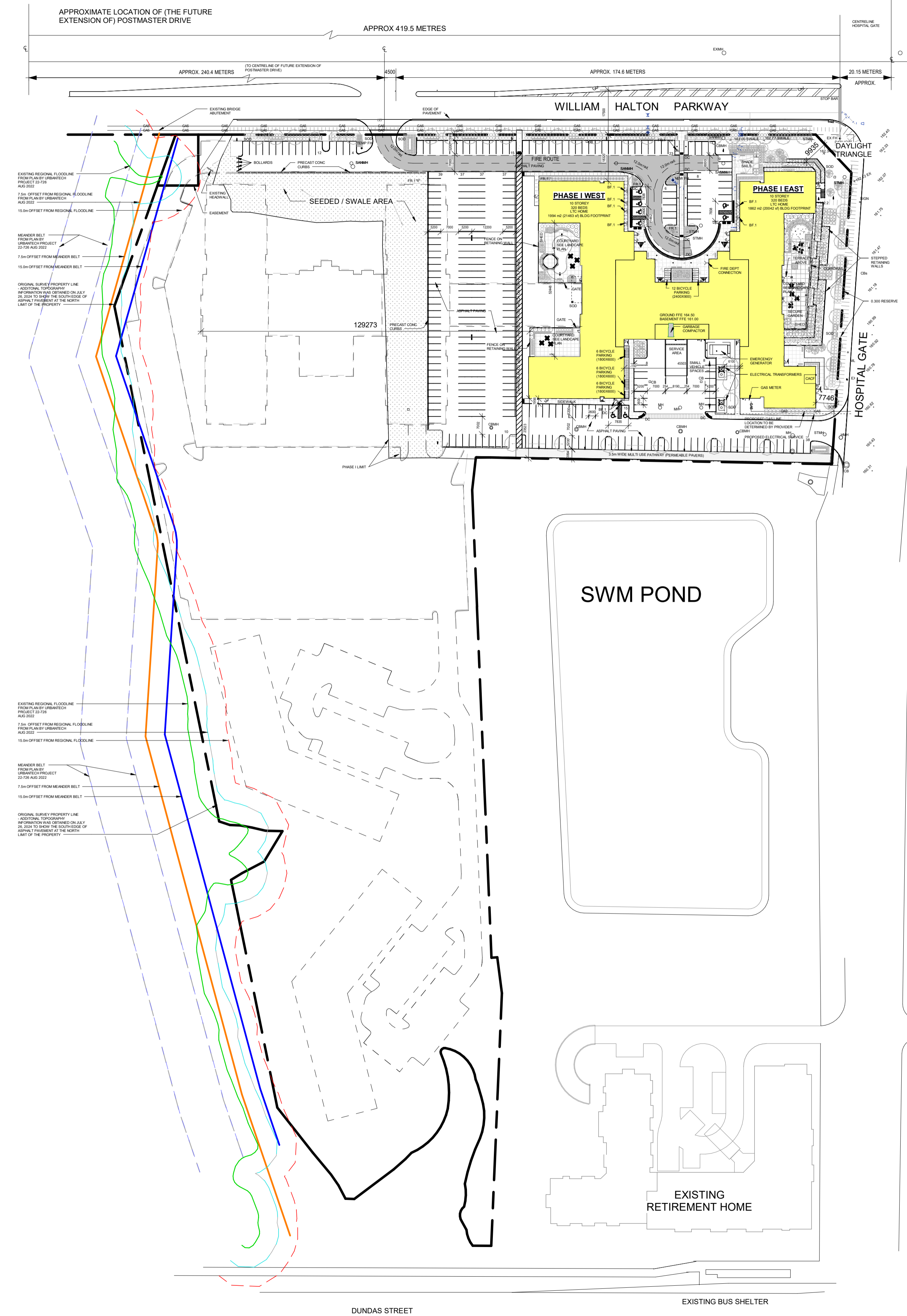

1011 OVERALL SITE PLAN
A1.01

0 10 25 50 100 m
1:1000

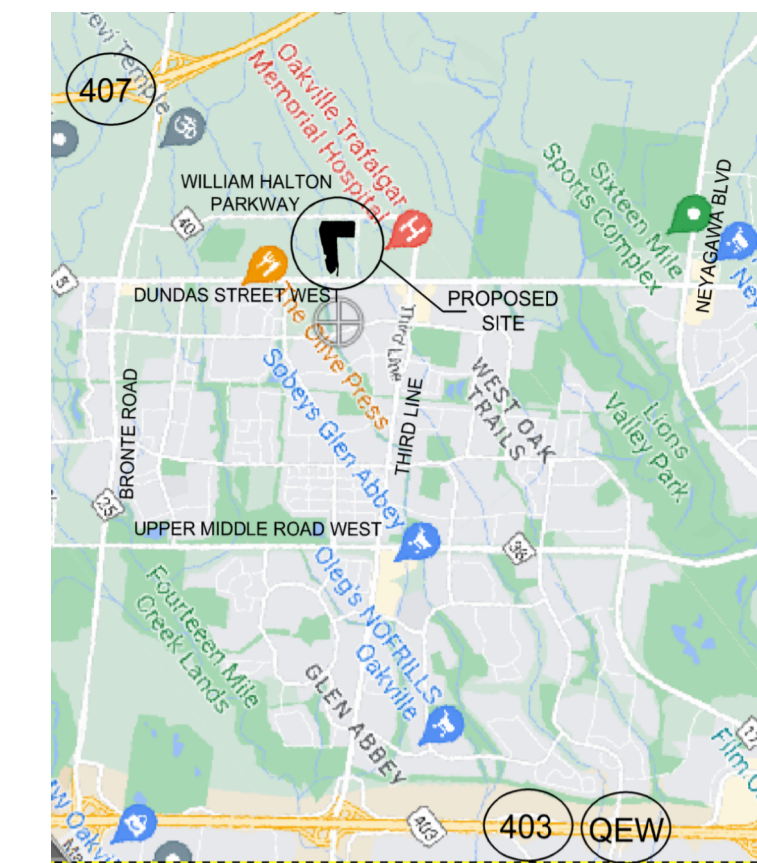

KEY PLAN

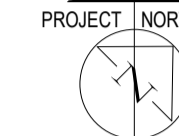

SITE PLAN PHASE I

TOTAL SITE AREA	63 454 m ²	6.346 ha	15.681 ac
PHASE I LIMIT AREA	24 086 m ²	2.491 ha	6.154 ac
BUILDING AREA	5 212 m ²		
COVERAGE	8.21 %		
GROSS FLOOR AREA	44 503 m ²		
	REQUIRED	PROPOSED	
PARKING REQUIRED (640 TC BEDS @ 0.25/BED)	160 SPACES	306 SPACES	+ 8 SMALL VEHICLE SPACES
BARRIER FREE PARKING (TABLE 5.2)	8	8	
BICYCLE PARKING (TABLE 5.7.B)	23	24	
LANDSCAPED AREA	10.0%	76.4 %	
BUILDING HEIGHT	63.0 m	41.25 m	

PROPOSED ANCILLARY USES TO THE LONG TERM CARE FACILITY:

- LIVING CLASSROOM + LABS

SURVEY INFO TAKEN FROM PLAN PREPARED BY SPEIGHT, VAN NOSTRAND & GIBSON LIMITED ONTARIO LAND SURVEYORS
FILE NAME A2010297.DWG
JOB NO. 201-0297
ADDITIONAL TOPOGRAPHY INFORMATION WAS OBTAINED ON JULY 26, 2024 TO SHOW THE SOUTH EDGE OF ASPHALT PAVEMENT AT THE NORTH LIMIT OF THE PROPERTY

PROPERTY LINE ALONG MCCARNEY CREEK TAKEN FROM PLAN BY URBANTECH 'EXISTING CONDITIONS REGIONAL FLOOD PLAN'
PROJECT NO. 22-726
DATE: AUG 2022

419.5 DIMENSION (APPROX) FROM EAST BOUND STOP BAR AT HOSPITAL GATE TO CENTRELINE OF FUTURE POSTMASTER DRIVE TAKEN FROM WSP EMAIL DATED 11 DEC 2023

ARCHEOLOGICALLY INFO TAKEN FROM OAKVILLE LAND ASSEMBLY PARCEL 1 WITH ARCHEOLOGICAL SITE (AIGW-991)
DATED 11/19/2020
NAME D1043036 ARCH

ZONING NOTE
IT IS INTENDED THAT THE PROPOSED ZONING APPLY TO THE SITE AS A WHOLE NOTWITHSTANDING ANY FUTURE LOT DIVISION

SITE SYMBOL LEGEND

- BUILDING LAYOUT POINT
- PRINCIPAL / FIRE FIGHTERS, BARRIER FREE ENTRY
- BUILDING ENTRY POINTS
- BUILDING EXIT POINTS
- 6.0 m WIDE FIRE ROUTE
- FIRE DEPARTMENT CONNECTION
- CACF CENTRAL ALARM CONTROL FACILITY
- FAAP FIRE ALARM ANNUNCIATOR PANEL
- FIRE HYDRANT (SEE SITE ENGINEERING)
- PERMEABLE PAVERS
- NEW CONC SIDEWALK / PATIO (SIDEWALKS 1.5m WIDE UNLESS INDICATED) WITH SEALED BROOM FINISH
- NEW CONC SIDEWALK / PATIO (SIDEWALKS 1.5m WIDE UNLESS INDICATED) WITH SEALED EXPOSED AGGREGATE FINISH
- BENCH SEE LANDSCAPE
- DC BARRIER FREE CURB RAMP
- B BOLLARDS
- FR.1 FIRE ROUTE SIGN
- BF.1 DISABLED PARKING PERMIT SIGN
- BARRIER FREE PARKING SPACE PAINTED SOLID, SUPERIMPOSE PAINTED BARRIER FREE SYMBOL
- EXISTING REGIONAL FLOODLINE FROM PLAN BY URBANTECH PROJECT 22-726 - AUG 2022
- 7.5m OFFSET FROM REGIONAL FLOODLINE FROM PLAN BY URBANTECH AUG 2022
- 15.0m OFFSET FROM REGIONAL FLOODLINE
- MEANDER BELT FROM PLAN BY URBANTECH PROJECT 22-726 AUG 2022
- 7.5m OFFSET FROM MEANDER BELT
- 15.0m OFFSET FROM MEANDER BELT
- ORIGINAL SURVEY PROPERTY LINE - ADDITIONAL TOPOGRAPHY INFORMATION WAS OBTAINED ON JULY 26, 2024 TO SHOW THE SOUTH EDGE OF ASPHALT PAVEMENT AT THE NORTH LIMIT OF THE PROPERTY



102-320 Thames St. London ON Canada N6A 0E1
P. 519.432.6644 F. 519.432.6737
cornerstonearchitecture.ca

CORNERSTONE ARCHITECTURE

Issued for Site Plan Application
2024-07-11 Resubmitted for Site Plan Application
2024-09-30 Issued for Site Plan Approval Submission #3

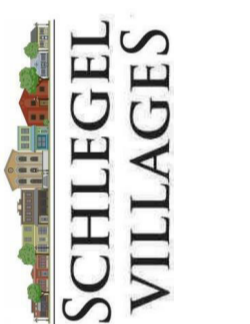

Schlegel Villages Oakville LTC

SCHLEDEL VILLAGES
Plot Date: 2024-10-02
Drawn By: CR
Project No.: 835
OVERALL SITE PLAN

A1.01

APPROX 419.5 METRES

APPROX. 174.6 METERS

CENTRELINE HOSPITAL GATE

(TO CENTRELINE OF FUTURE EXTENSION OF POSTMASTER DRIVE)

WILLIAM HALTON PARKWAY

EXMH

20.15 METERS APPROX

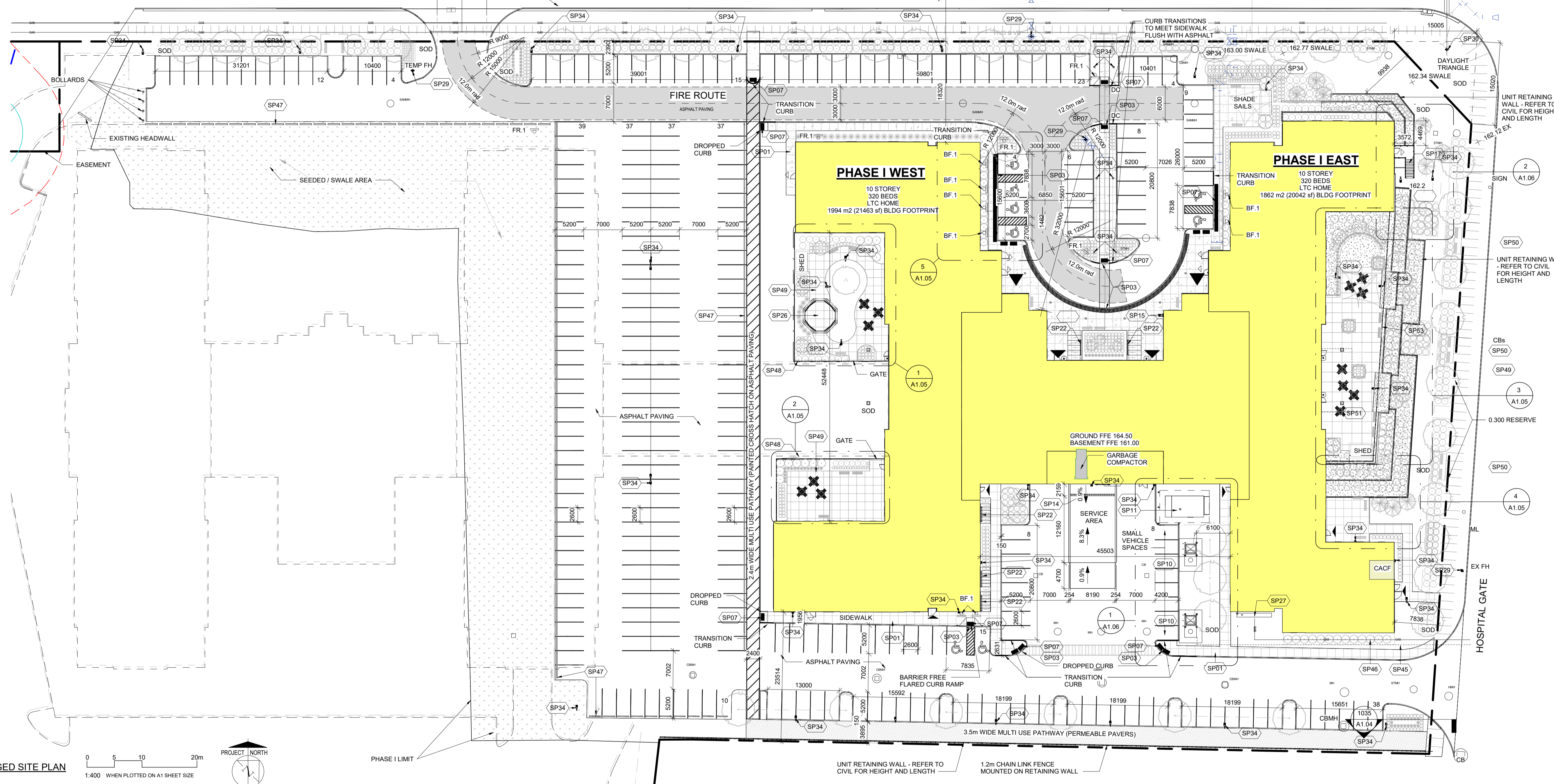

1021 ENLARGED SITE PLAN
A1.02

0 5 10 20m
1:400 WHEN PLOTTED ON A1 SHEET SIZE

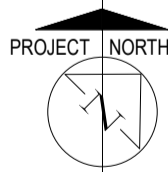

PHASE I LIMIT

SITE SYMBOL LEGEND

- BUILDING LAYOUT POINT
- PRINCIPAL / FIRE FIGHTERS, BARRIER FREE ENTRY
- BUILDING ENTRY POINTS
- BUILDING EXIT POINTS
- 6.0 m WIDE FIRE ROUTE
- FIRE DEPARTMENT CONNECTION
- CENTRAL ALARM CONTROL FACILITY
- FIRE HYDRANT (SEE SITE ENGINEERING)
- BENCH SEE LANDSCAPE
- PERMEABLE PAVERS
- NEW CONC SIDEWALK / PATIO (SIDEWALKS 1.5m WIDE UNLESS INDICATED WITH SEALED BROOM FINISH)
- NEW CONC SIDEWALK / PATIO (SIDEWALKS 1.5m WIDE UNLESS INDICATED WITH SEALED EXPOSED AGGREGATE FINISH)
- BARRIER FREE CURB RAMP
- BARRIER FREE PARKING SPACE PAINTED SOLID, SUPERIMPOSE PAINTED BARRIER FREE SYMBOL
- BOLLARDS
- DISABLED PARKING PERMIT SIGN
- FIRE ROUTE SIGN
- STORM (SEE CIVIL DRAWINGS)
- SANITARY (SEE CIVIL DRAWINGS)
- WATER (SEE CIVIL DRAWINGS)

SITE STATISTICS

PHASE I LOT AREA	6.154 ac (24 906 m ²)	
TOTAL LOT AREA	15.68 ac (6.346 ha)	
GROUND FLOOR BUILDING AREA		
WEST LTC BUILDING AREA	1,885 m ²	
EAST LTC BUILDING AREA	1,805 m ²	
SENIORS HUB	1,522 m ²	
TOTAL GROUND FLOOR BLDG AREA	5,212 m ²	
TOTAL NUMBER OF LTC BEDS	640	
PARKING REQUIRED (640 TC BEDS @ 0.25/BED)	160 SPACES	314 SPACES
BARRIER FREE PARKING (TABLE 5.2)	8	8
BICYCLE PARKING (TABLE 5.7.B)	23	24

SITE PLAN KEYNOTE LEGEND

Key Value	Keynote Text
SP01	CAST IN PLACE CONCRETE SIDEWALK. REFER TO SITE PLAN LEGEND FOR TYPES.
SP03	DROP CURB IN CAST IN PLACE CONCRETE SIDEWALK C/W TACTILE INDICATORS. REFER TO SPECIFICATIONS FOR TYPES & LOCATIONS.
SP07	TAI-2 & TAI-2R AT TRANSITIONS IN WALKING SURFACE. REFER TO SPECIFICATIONS.
SP11	SITE GENERATOR WITHIN PROPRIETARY ENCLOSURE. SEE ELECTRICAL COORD. PLACEMENT WITH DIVISION 16.
SP14	TRENCH DRAIN. COORDINATE WITH DIVISION 15 & CIVIL.
SP15	FIRE DEPARTMENT HOSE CONNECTION.
SP17	EXTERIOR STAIR. REFER TO FLOOR PLANS AND STRUCTURAL DWG. FOR FURTHER DETAILS.
SP22	BIKE PARKING STALLS. REFER TO SITE PLAN STATISTICS AND QUANTITIES IDENTIFIED ON PLANS.
SP26	LANDSCAPE ELEMENT. REFER TO LANDSCAPE DRAWINGS.
SP27	GAS METER LOCATION. COORDINATE ON SITE WITH DIVISION 15.
SP29	FIRE HYDRANT - NEW. SEE REFER TO CIVIL DRAWINGS.
SP30	FIRE HYDRANT - EXISTING. REFER TO CIVIL DRAWINGS.
SP34	LIGHT STANDARD. REFER TO ELECTRICAL SITE PLAN FOR TYPES & DETAILED INFORMATION.
SP45	PROPOSED ELECTRICAL SERVICE
SP46	PROPOSED GAS LINE LOCATION TO BE DETERMINE BY PROVIDER
SP47	PRECAST CONCRETE CURBS
SP48	FENCE ON RETAINING WALL
SP49	COURTYARD. SEE LANDSCAPE PLAN
SP50	BENCH CONCRETE PAD. SEE LANDSCAPE PLAN
SP51	SECURE GARDEN
SP53	GUARDRAIL



102-320 Thames St. London ON Canada N6A 0E7
P. 519.432.6644 F. 519.432.6737
cornerstonearchitecture.ca

© 2024 Cornerstone Architecture Incorporated. All Rights Reserved.
2024-07-11 Released for Site Plan Application
2024-09-19 Issued for Foundation Permit
2024-09-30 Issued for Site Plan Approval Submission #3

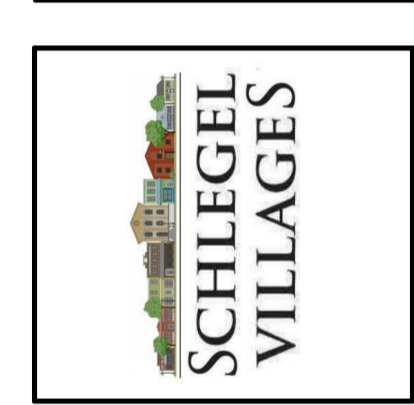

Schlegel Villages Oakville LTC
ENLARGED SITE PLAN
Project No.: 835
Drawn By: CR
Plot Date: 2024-10-02
YYYY-MM-DD

A1.02