

EXISTING VEGETATION IDENTIFICATION TABLE

TREE/UNIT NO.	SPECIES (COMMON NAME)	SPECIES (BOTANICAL NAME)	DBH (cm)	CONDITION	VEGETATION VALUE & PHYSICAL CONSTRAINTS	POTENTIAL IMPACTS FROM CONSTRUCTION	OWNERSHIP	RECOMMENDATION
1	White Mulberry	Morus alba	27	Fair-Good	SEE ARBORIST REPORT FOR TREE COMMENTS	Grading within root zone due to proposed entrance	Private - On Property	REMOVE
2	Green Ash	Fraxinus pennsylvanica	33	Fair-Good	-	Grading within root zone due to proposed entrance	Private - On Property	REMOVE
3	Norway Maple	Acer platanoides	18	Fair-Good	-	-	Public	SAVE
4	Norway Maple	Acer platanoides	16	Fair-Good	-	-	Public	SAVE
5	Cherry	Prunus sp.	21	Good	-	-	Public	SAVE
6	Norway Maple	Acer platanoides	25	Good	-	-	Public	SAVE
7	Green Ash	Fraxinus pennsylvanica	56	Fair-Good	-	-	Public	SAVE
8	Norway Maple	Acer platanoides	34	Good	-	-	Public	SAVE
9	Norway Maple	Acer platanoides	38	Good	-	-	Public	SAVE
10	Norway Maple	Acer platanoides	17	Good	-	-	Public	SAVE
11	Green Ash	Fraxinus pennsylvanica	32	Fair-Good	-	-	Public	SAVE
12	Oak Leaf Mountainash	Sorbus x thuringiaca	46	Good	-	-	Public	SAVE
13	White Spruce	Picea glauca	25	Dead	-	-	Public	SAVE
14	White Spruce	Picea glauca	22	Good	-	-	Public	SAVE
15	Thornless Honey Locust	Gleditsia triacanthos var. inermis	41	Fair-Good	-	-	Public	SAVE
16	White Spruce	Picea glauca	29	Fair-Good	-	-	Public	SAVE
17	Black Walnut	Juglans nigra	21	Fair-Good	-	-	Public	SAVE
18	Black Walnut	Juglans nigra	18	Good	-	-	Public	SAVE
19	Green Ash	Fraxinus pennsylvanica	25	Fair-Good	-	-	Public	SAVE
20	Norway Maple	Acer platanoides	26	Good	-	-	Public	SAVE
21	Hawthorn	Crataegus crus-galli	31	Fair-Good	-	-	Public	SAVE
22	Norway Maple	Acer platanoides	18	Fair-Good	-	-	Public	SAVE
23	Green Ash	Fraxinus pennsylvanica	40	Fair-Good	-	-	Public	SAVE
24	Black Walnut	Juglans nigra	18	Good	-	-	Public	SAVE
25	White Pine	Pinus strobus	27	Good	-	-	Public	SAVE
26	Basewood	Tilia americana	48	Fair-Good	-	-	Public	SAVE
27	Crabapple	Malus sp.	49	Fair-Good	-	-	Public	SAVE
28	Black Walnut	Juglans nigra	32	Fair-Good	-	-	Public	SAVE
29	Hawthorn	Crataegus crus-galli	14	Fair	-	-	Private - On Property	SAVE
30	Hawthorn	Crataegus crus-galli	21	Fair-Good	-	-	Private - On Property	SAVE
31	Black Walnut	Juglans nigra	23	Fair-Good	-	-	Private - On Property	SAVE
32	White Pine	Pinus strobus	38	Good	-	-	Private - On Property	SAVE
33	Basewood	Tilia americana	24	Good	-	-	Private - On Property	SAVE
34	Green Ash	Fraxinus pennsylvanica	16	Dead	-	Dead	Private - On Property	REMOVE
35	Hawthorn	Crataegus crus-galli	14	Good	-	-	Private - On Property	SAVE
36	Hawthorn	Crataegus crus-galli	19	Fair-Good	-	-	Private - On Property	SAVE
37	White Pine	Pinus strobus	32	Good	-	-	Private - On Property	SAVE
38	Green Ash	Fraxinus pennsylvanica	14	Dead	-	Dead	Private - On Property	REMOVE
39	Green Ash	Fraxinus pennsylvanica	22	Dead	-	Dead	Private - On Property	REMOVE
40	Green Ash	Fraxinus pennsylvanica	25	Dead	-	Dead	Private - On Property	REMOVE
41	Green Ash	Fraxinus pennsylvanica	13	Dead	-	Dead	Private - On Property	REMOVE
42	Green Ash	Fraxinus pennsylvanica	57	Dead	-	Dead	Private - On Property	REMOVE
43	White Pine	Pinus strobus	25	Dead	-	Dead	Private - On Property	REMOVE
44	Green Ash	Fraxinus pennsylvanica	32	Dead	-	Dead	Private - On Property	REMOVE
45	Green Ash	Fraxinus pennsylvanica	53	Dead	-	Dead	Private - On Property	REMOVE
46	Green Ash	Fraxinus pennsylvanica	25	Dead	-	Dead	Private - On Property	REMOVE
47	Cherry	Prunus sp.	17	Good	-	Grading within root zone due to proposed swale	Private - On Property	REMOVE
48	Siberian Elm	Ulmus pumila	50	Fair-Good	-	-	Private - On Property	SAVE
49	Siberian Elm	Ulmus pumila	40	Fair-Good	-	-	Private - On Property	SAVE
50	White Pine	Pinus strobus	23	Good	-	-	Private - On Property	SAVE
51	Scots Pine	Pinus sylvestris	10	Good	-	-	Private - On Property	SAVE
52	Shagbark Hickory	Carya ovata	38	Fair-Good	-	-	Private - On Property	SAVE
53	White Pine	Pinus strobus	34	Good	-	Grading within root zone due to proposed swale	Private - On Property	REMOVE
54	Norway Maple	Acer platanoides	23	Fair-Good	-	Grading within root zone due to proposed swale	Private - On Property	REMOVE
55	Green Ash	Fraxinus pennsylvanica	25	Dead	-	Dead	Private - On Property	REMOVE
56	Manitoba Maple	Acer negundo	41	Good	-	Grading within root zone due to proposed swale	Private - On Property	REMOVE
57	Norway Maple	Acer platanoides	20	Good	-	Grading within root zone due to proposed swale	Private - On Property	REMOVE
58	Norway Maple	Acer platanoides	12	Fair-Good	-	Grading within root zone due to proposed swale	Private - On Property	REMOVE
59	Norway Maple	Acer platanoides	24	Fair-Good	-	Grading within root zone due to proposed swale	Private - On Property	REMOVE
60	Hawthorn	Crataegus crus-galli	12	Fair-Good	-	Grading within root zone due to proposed parking lot	Private - On Property	REMOVE
61	Green Ash	Fraxinus pennsylvanica	13	Dead	-	Dead	Private - On Property	REMOVE
62	Wild Crabapple	Malus coronaria	11	Good	-	Grading within root zone due to proposed swale	Private - On Property	REMOVE
63	Norway Maple	Acer platanoides	15	Fair-Good	-	Grading within root zone due to proposed swale	Private - On Property	REMOVE
64	Green Ash	Fraxinus pennsylvanica	20	Dead	-	Dead	Private - On Property	REMOVE
65	Norway Maple	Acer platanoides	20	Good	-	Grading within root zone due to proposed swale	Private - On Property	REMOVE
66	Norway Maple	Acer platanoides	15	Fair-Good	-	Grading within root zone due to proposed parking lot	Private - On Property	REMOVE
67	Norway Maple	Acer platanoides	15	Good	-	Grading within root zone due to proposed swale	Private - On Property	REMOVE
68	Norway Maple	Acer platanoides	11	Fair-Good	-	Grading within root zone due to proposed swale	Private - On Property	REMOVE
69	Red Oak	Quercus rubra	56	Good	-	Grading outside of TPZ	Private - On Property	SAVE
70	Norway Maple	Acer platanoides	15	Good	-	-	Private - On Property	SAVE
71	Norway Maple	Acer platanoides	24	Fair-Good	-	-	Private - On Property	SAVE
72	Green Ash	Fraxinus pennsylvanica	21	Dead	-	Dead	Private - On Property	REMOVE
73	White Pine	Pinus strobus	32	Good	-	-	Private - On Property	SAVE
74	Red Oak	Quercus rubra	72	Fair-Good	-	-	Private - On Property	SAVE
75	Red Oak	Quercus rubra	24	Good	-	-	Private - On Property	SAVE
75A	Wild Crabapple	Malus coronaria	20	Fair-Good	-	Grading within root zone due to proposed parking lot	Private - On Property	REMOVE
75B	Wild Crabapple	Malus coronaria	16	Fair-Good	-	Grading within root zone due to proposed parking lot	Private - On Property	REMOVE
76	Green Ash	Fraxinus pennsylvanica	16	Dead	-	Dead	Private - On Property	REMOVE
77	Red Oak	Quercus rubra	17	Good	-	-	Private - On Property	SAVE
78	White Pine	Pinus strobus	26	Good	-	-	Private - On Property	SAVE
79	White Pine	Pinus strobus	30	Good	-	-	Private - On Property	SAVE
80	Red Oak	Quercus rubra	24	Fair-Good	-	-	Private - On Property	SAVE
81	Green Ash	Fraxinus pennsylvanica	22	Dead	-	Dead	Private - On Property	REMOVE
82	Pussy Willow	Salix discolor	15	Fair-Good	-	Grading within root zone due to proposed parking lot	Private - On Property	REMOVE
83	Eastern Redcedar	Juniperus virginiana	20	Fair-Good	-	Grading within root zone due to proposed parking lot	Private - On Property	REMOVE
84	Pussy Willow	Salix discolor	19	Fair-Good	-	Grading within root zone due to proposed parking lot	Private - On Property	REMOVE
85	White Pine	Pinus strobus	33	Good	-	-	Private - On Property	SAVE

MIGRATORY BIRDS AND NESTS:

- The Owner and Contractor must be aware of the Migratory Birds Convention Act, 1994 - specifically:
 - No tree removal or construction activity shall contravene the Act.
 - Construction activities with the potential to harm migratory birds or their nest should be restricted from March 15 to August 31.
 - If work must occur during the migratory bird breeding season, a nest survey should be taken by a qualified avian biologist.
 - A mitigation plan (showing active nests and appropriate buffers) may be required for review and approval by the Canadian Wildlife Services.

TREE REMOVAL:

- No trees shall be removed prior to municipal approvals of the Tree Management/Tree Preservation Plan.
- BOUNDARY TREES:
 - Note that boundary trees are protected under the Ontario Forestry Act. Boundary trees are defined in the Forestry Act (Section 10.2) and are considered shared or co-owned property. The Forestry Act indicates that it is a prosecutable offense for one co-owner to injure or cut down a boundary tree without the other co-owner's permission.
 - Written permission from the neighbouring property owner is required prior to removal or injury of any boundary tree (shared ownership) or any tree that is not fully on the subject property.
 - An ISA certified Arborist should be on site prior to any work being performed within the rootzone of a boundary or neighbouring tree to perform root pruning as required.

**CONDITION - consideration of trunk integrity, crown structure and crown vigor
 Good - few or no issues related to trunk integrity, crown structure or crown vigor
 Fair - minor issues related to trunk integrity, crown structure (form, some dead or damaged branches) or crown vigor (20-80% healthy foliage)
 Poor - issues with trunk integrity such as cavities or exposed dead wood, poor crown structure (poor form, no clear leader, significant dead or damaged branches) or poor crown vigor (<20% healthy foliage)
 -CONDITION OF TREES
 The decision to remove or retain a tree is subject to the forecasted development impacts, the structural condition of the tree (e.g. cracks, cavities, decay, weak branching, leaning, hazard potential), the biological condition of the tree (e.g. pest or disease concerns, overall health) and the suitability of the tree in its location (e.g. hardness, soil conditions, salt tolerance, visual obstruction, available soil volume)

TREE/UNIT NO.	SPECIES (COMMON NAME)	SPECIES (BOTANICAL NAME)	DBH (cm)	CONDITION	VEGETATION VALUE & PHYSICAL CONSTRAINTS	POTENTIAL IMPACTS FROM CONSTRUCTION	OWNERSHIP	RECOMMENDATION
86	Norway Maple	Acer platanoides	20	Good	SEE ARBORIST REPORT FOR TREE COMMENTS	-	Private - On Property	SAVE
87	Green Ash	Fraxinus pennsylvanica	34	Dead	-	Dead	Private - On Property	REMOVE
88	Wild Crabapple	Malus coronaria	15	Fair-Good	-	-	Private - On Property	SAVE
89	Green Ash	Fraxinus pennsylvanica	20	Dead	-	Grading within root zone due to proposed swale	Private - On Property	REMOVE
90	White Pine	Pinus strobus	20	Good	-	-	Private - On Property	SAVE
91	Green Ash	Fraxinus pennsylvanica	24	Dead	-	Dead	Private - On Property	REMOVE
92	Norway Maple	Acer platanoides	22	Good	-	-	Private - On Property	SAVE
93	Green Ash	Fraxinus pennsylvanica	53	Dead	-	Dead	Private - On Property	REMOVE
94	Wild Crabapple	Malus coronaria	25	Fair-Good	-	-	Private - On Property	SAVE
95	White Pine	Pinus strobus	35	Good	-	-	Private - On Property	SAVE
96	Eastern Redcedar	Juniperus virginiana	20	Fair-Good	-	Grading within root zone due to proposed parking lot	Private - On Property	REMOVE
97	Norway Maple	Acer platanoides	21	Fair-Good	-	Grading within root zone due to proposed parking lot	Private - On Property	REMOVE
98	Norway Maple	Acer platanoides	24	Fair-Good	-	Grading within root zone due to proposed sidewalk	Private - On Property	REMOVE
99	Green Ash	Fraxinus pennsylvanica	26	Dead	-	Dead	Private - On Property	REMOVE
100	White Pine	Pinus strobus	48	Poor	-	-	Private - On Property	SAVE
101	White Pine	Pinus strobus	29	Good	-	-	Private - On Property	SAVE
102	White Pine	Pinus strobus	32	Dead	-	Dead	Private - On Property	REMOVE
103	Norway Maple	Acer platanoides	27	Fair-Good	-	Grading within root zone due to proposed sidewalk	Private - On Property	REMOVE
104	Norway Maple	Acer platanoides	24	Good	-	Grading within root zone due to proposed sidewalk	Private - On Property	REMOVE
105	Norway Maple	Acer platanoides	29	Fair-Good	-	Grading within root zone due to proposed building	Private - On Property	REMOVE
106	Green Ash	Fraxinus pennsylvanica	31	Dead	-	Dead	Private - On Property	REMOVE
107	Norway Maple	Acer platanoides	20	Good	-	Grading within root zone due to proposed building	Private - On Property	REMOVE
108	Norway Maple	Acer platanoides	15	Good	-	-	Private - On Property	SAVE
109	Basewood	Tilia americana	43	Good	-	-	Private - On Property	SAVE
110	Red Oak	Quercus rubra	15	Good	-	-	Private - On Property	SAVE
111	Green Ash	Fraxinus pennsylvanica	28	Dead	-	Dead	Private - On Property	REMOVE
112	Norway Maple	Acer platanoides	21	Fair-Good	-	Grading within root zone due to proposed building	Private - On Property	REMOVE
113	Norway Maple	Acer platanoides	24	Fair-Good	-	Grading within root zone due to proposed building	Private - On Property	REMOVE
42A	Sugar Maple	Acer saccharum	35*	Fair-Good	-	-	Private - Neighbouring	SAVE
53A	Red Oak	Quercus rubra	24*	Fair-Good	-	-	Private - Neighbouring	SAVE
57A	Siberian Elm	Ulmus pumila	10, 14 (17)	Fair-Good	-	Minor Encroachment into TPZ due to grading	Private - Neighbouring	SAVE
65A	Siberian Elm	Ulmus pumila	42	Fair-Good	-	Minor Encroachment into TPZ due to grading	Private - Neighbouring	SAVE

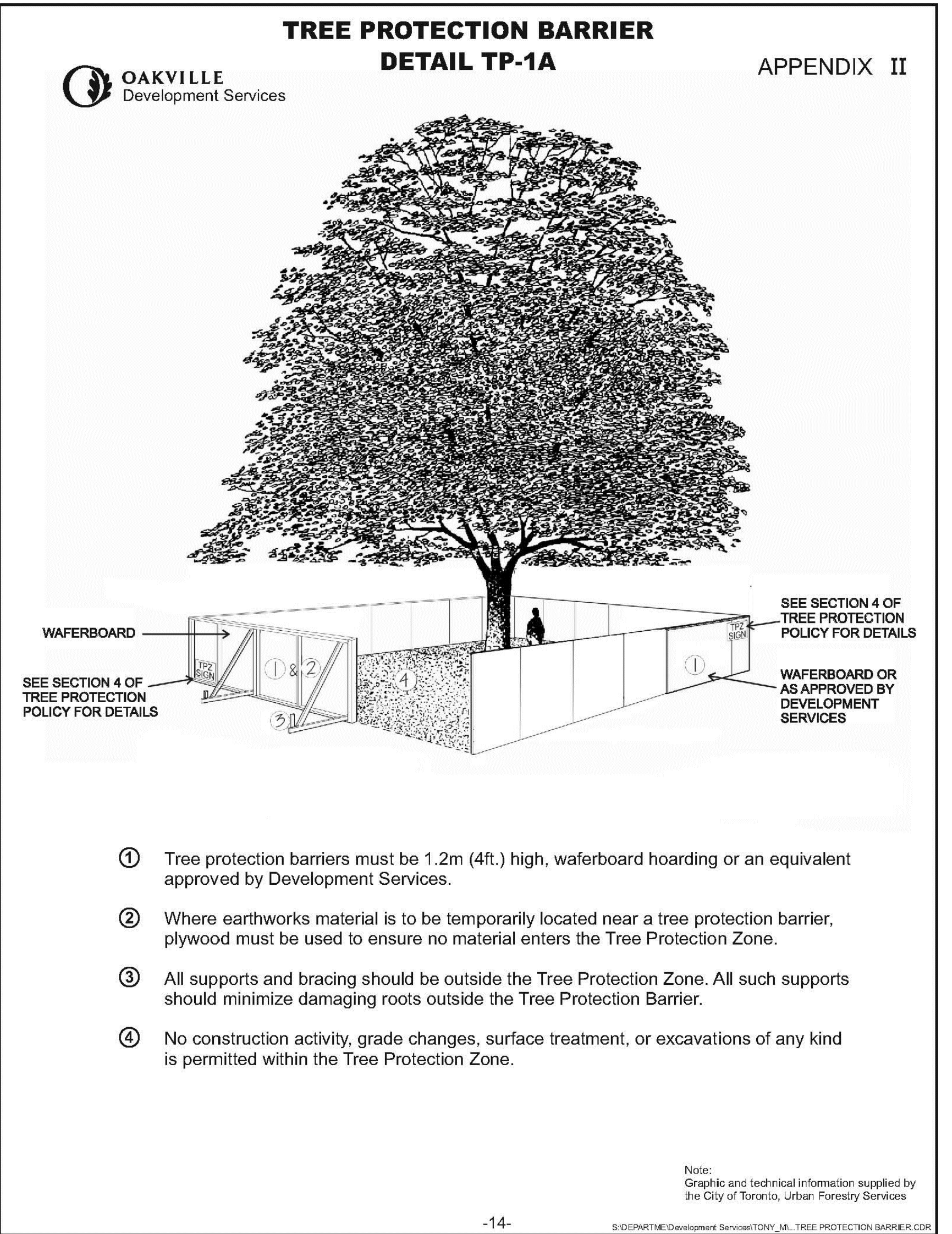

- Tree protection barriers must be 1.2m (4ft.) high, waferboard hoarding or an equivalent approved by Development Services.
- Where earthworks material is to be temporarily located near a tree protection barrier, plywood must be used to ensure no material enters the Tree Protection Zone.
- All supports and bracing should be outside the Tree Protection Zone. All such supports should minimize damaging roots outside the Tree Protection Barrier.
- No construction activity, grade changes, surface treatment, or excavations of any kind is permitted within the Tree Protection Zone.

NOT FOR CONSTRUCTION
 ISSUED FOR REVIEW & COMMENTS ONLY

NOTE:
 Vegetation inventory undertaken by Tom Bradley, ISA Certified Arborist (ON-1182A) on November 30, 2018.

Tree Protection Plan to be read in conjunction with Arborist Report (October 2019) prepared by:

Welwyn Consulting
 1222 Welwyn Drive
 Mississauga, Ontario L5J 3J3
 T: 905-301-2925
 E: welwyntrees@gmail.com

REVISIONS/ SUBMISSIONS

#	DATE	DESCRIPTION
4	2019-07-22	Issued for submission
5	2019-08-23	Issued for pricing
6	2019-10-16	Issued for resubmission (Urban and Forestry comments revision)
7	2019-11-06	Issued for submission
8	2021-09-20	Issued for review
9	2021-11-24	Issued for site instruction #1
10	2023-09-29	Issued for SPA amendment

STAMP



CLIENT
 Mataj Architects Inc.
 MUNICIPALITY
 Town of Oakville

PROJECT
 Ismail Office Building
 2176 Speers Road

MUNICIPAL FILE NUMBER
 SP.# 1627.041-01

SHEET
 Tree Protection Plan

L-2

adesso design inc.
 landscape architecture

69 John Street South, Suite 250
 Hamilton, ON L8N 2B9
 t. 905.526.8876
 www.adessodesigninc.ca

Tree Protection Fencing
 SCALE: NTS

D
 I

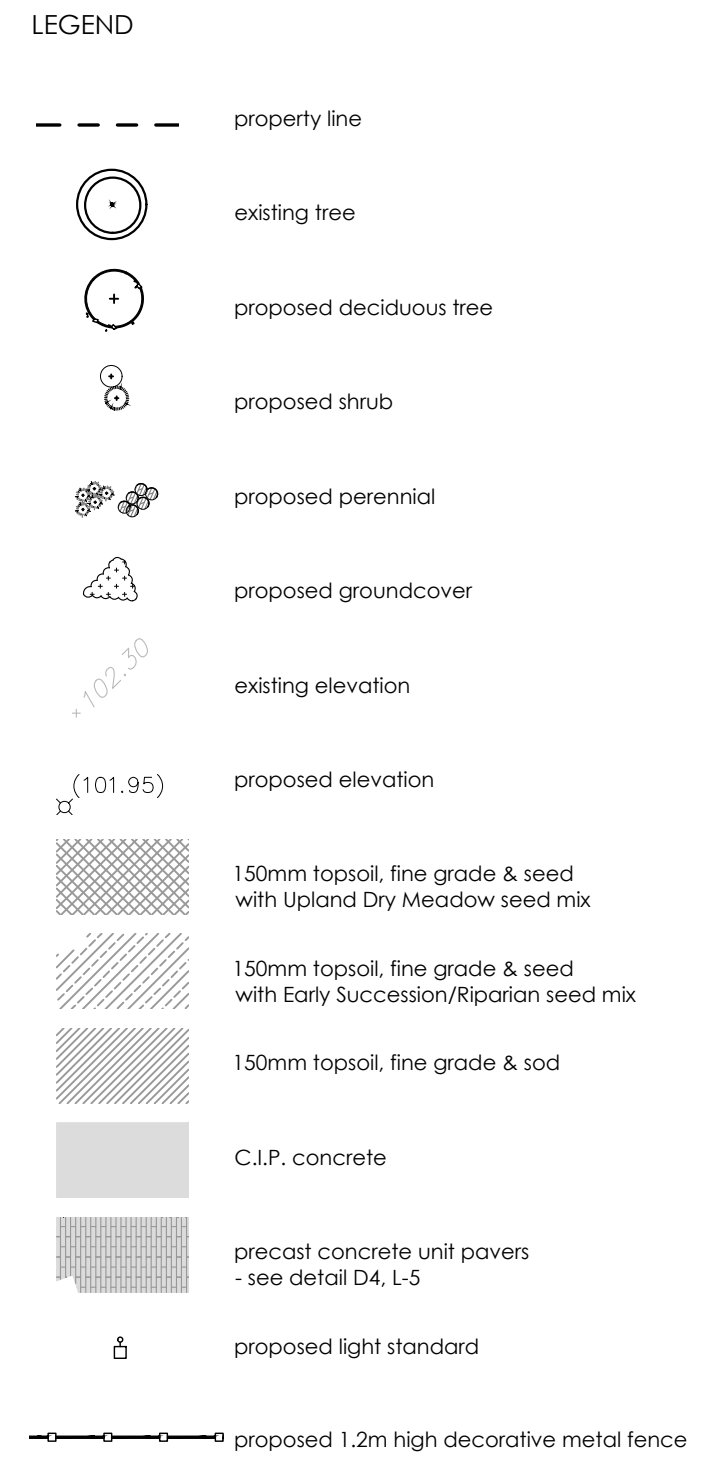
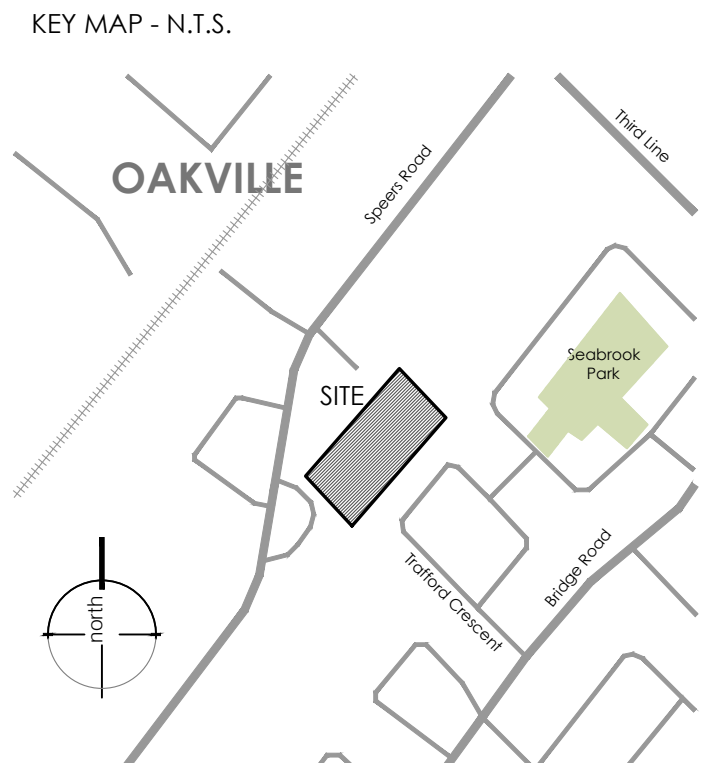
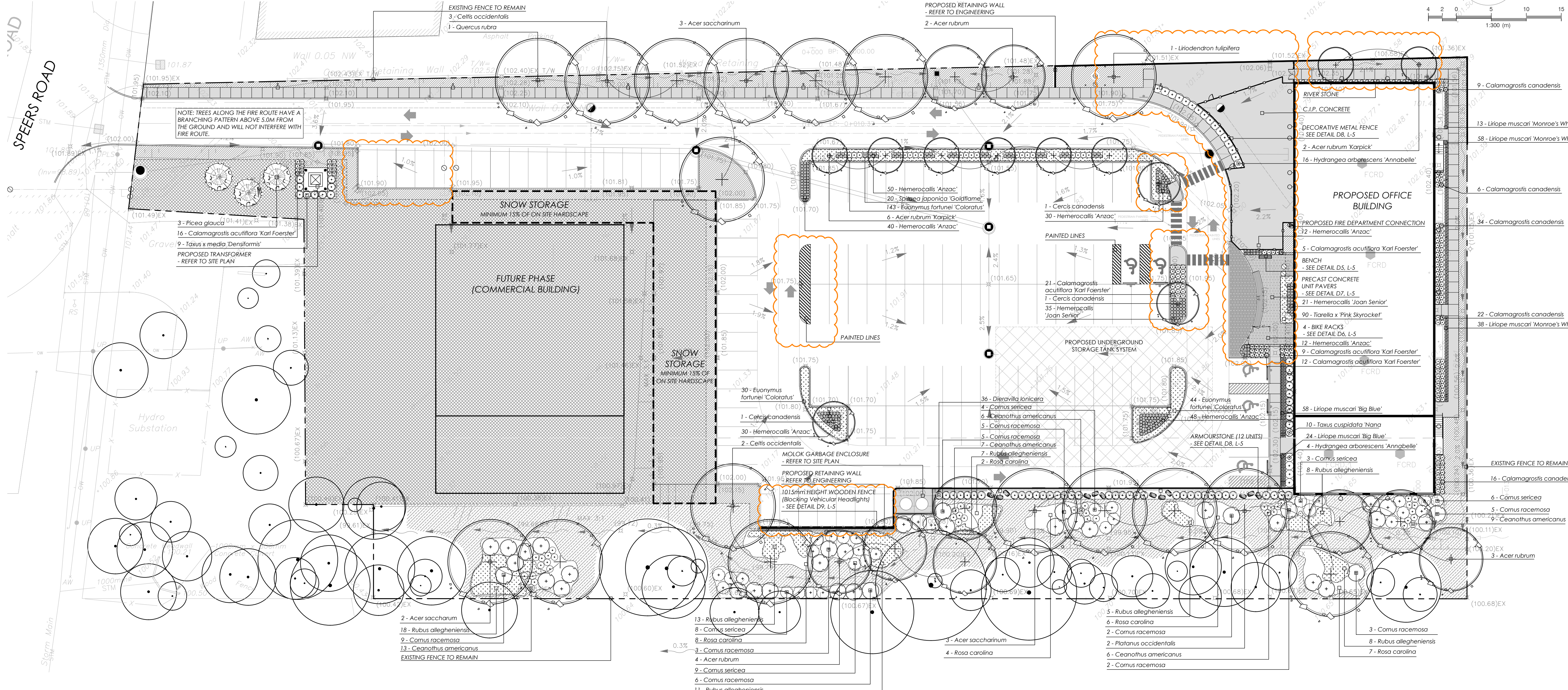

REVISIONS/ SUBMISSIONS

#	DATE	DESCRIPTION
4	2019-07-22	Issued for submission
5	2019-08-23	Issued for pricing
6	2019-10-16	Issued for resubmission (Urban and Forestry comments revision)
7	2019-11-06	Issued for submission
8	2020-03-05	Issued for Site Instruction
9	2021-09-20	Issued for review
10	2021-11-24	Issued for resubmission (L-1)
11	2023-09-29	Issued for SPA amendment

PLANT LIST

QNTY.	BOTANICAL NAME	COMMON NAME	CAL.	SIZE	COND.	MATURE HEIGHT (m)	MATURE SPREAD (m)	O.C. SPACING (m)	COMMENTS
TREES									
9	Acer rubrum	Red Maple	60mm		W.B.	15.0	12.0	10.0	
8	Acer rubrum 'Karpick'	Karpick Maple	60mm		W.B.	15.0	6.0	9.0	
6	Acer saccharum	Silver Maple	60mm		W.B.	20.0	18.0	10.0	
2	Acer saccharum	Sugar Maple	60mm		W.B.	25.0	18.0	10.0	
5	Celtis occidentalis	Common Hackberry	60mm		W.B.	18.0	16.0	10.0	
4	Cercis canadensis	Eastern Redbud	60mm		W.B.	10.0	8.0	-	
1	Liriodendron tulipifera	Tulip Tree	60mm		W.B.	20.0	15.0	10.0	
2	Platanus occidentalis	American Sycamore	60mm		W.B.	27.0	20.0	10.0	
3	Picea glauca	White Spruce	200cm		W.B.	20.0	6.0	-	
1	Quercus rubra	Red Oak	60mm		W.B.	22.0	20.0	10.0	Spring dig only
SHRUBS									
41	Ceanothus americanus	New Jersey Tea	40cm	#3 cont.	1.0	1.0	0.75	-	
38	Cornus racemosa	Gray Dogwood	50cm	#3 cont.	3.0	3.0	2.5	-	
30	Cornus sericea	Red Osier Dogwood	50cm	#3 cont.	1.75	2.0	1.75	-	
36	Dierilla lonicera	Bush Honeysuckle	50cm	#3 cont.	1.0	1.0	0.8	-	
217	Euonymus fortunei 'Coloratus'	Purpleleaf Wintercreeper	40cm	#2 cont.	0.3	1.25	0.9	-	
20	Hydrangea arborescens 'Annabelle'	Annabelle Hydrangea	50cm	#3 cont.	1.0	1.0	0.9	-	
27	Rosa carolina	Pasture Rose	30cm	#2 cont.	1.5	1.75	1.5	-	
10	Rubus allegheniensis	Allegheny Blackberry	30cm	#2 cont.	1.25	1.75	1.5	-	
20	Spiraea japonica 'Goldflame'	Goldflame Spiraea	40cm	#3 cont.	1.0	1.0	0.9	-	
10	Taxus cuspidata 'Nana'	Dwarf Japanese Yew	30cm	#3 cont.	1.0	1.25	1.1	-	
9	Taxus x media 'Densiformis'	Dense Yew	40cm	#3 cont.	1.25	1.5	1.1	-	
PERENNIALS/ GRASSES									
65	Calamagrostis acutiflora 'Karl Foerster'	Feather Reed Grass	#1 cont.	1.0	0.8	0.7	-	-	
87	Calamagrostis canadensis	Canada Bluejoint	#1 cont.	1.0	0.8	0.7	-	-	
222	Hemerocallis 'Anzac'	Daylily 'Anzac'	#1 cont.	0.65	0.5	0.45	-	-	
58	Hemerocallis 'Joan Senior'	Daylily 'Joan Senior'	#1 cont.	0.65	0.5	0.45	-	-	
82	Lilipoe muscari 'Big Blue'	Giant Turf Lily	#1 cont.	0.5	0.4	0.35	-	-	
109	Lilipoe muscari 'Monroe's White'	Giant Turf Lily	#1 cont.	0.5	0.4	0.35	-	-	
90	Tiarella x 'Pink Skyracke'	Foam Flower	#1 cont.	0.15	0.3	0.25	-	-	

LANDSCAPE NOTES:

- All work to be carried out in accordance with by-laws and codes having jurisdiction over site location.
- Complete all work to the satisfaction of the Landscape Architect.
- Report any changes, discrepancies or substitutions to the Landscape Architect for review. Obtain approval from the Landscape Architect before proceeding.
- It is the contractor's responsibility to determine existing service locations.
- Exact locations of plant material will be determined by placement of site services such as hydro vaults, meters, utilities roof rain water leaders, driveways, light standards, etc.
- All plant material locations to be staked or marked out and approved by Landscape Architect prior to installation.
- Supply all plant material in accordance with the Canadian Standards for Nursery Stock (8th ed.).
- Install plant material according to details shown.
- Supply and place mulch in accordance with Canadian Landscape Standard (Section 10, Mulching). Disturbed soil areas around trees and shrubs are to be covered with shredded conifer bark mulch such as 'Canada Red' or 'Gro-Bark' mulch, or approved equivalent. Alternative mulches must be approved by the Landscape Architect.
- Contractor to utilize layout dimensions where provided.
- Meadow/Open Field Sedge (Carex granularis) 20% New England Aster (Symphyotrichum novae-angliae) 10% Path Rush (Juncus tenuis) 10% Purple Stemmed Aster (Symphyotrichum puniceum) 1% Virgins Bower (Clematis virginiana) 4% Wild Bergamot (Monarda fistulosa) 4%
- *apply with Annual Oats (Avena sativa) nursecrop at 2kg/hectare.
- Supplied by: St. Williams Nursery & Ecological Centre (or approved equal) P: 1-519-886-9116 W: www.stwilliamsnursery.com
- All dimensions in meters unless otherwise noted.
- If discrepancies arise between plant material count shown on drawing and plant list, the drawing shall be considered correct.
- Contractor to provide minimum one (1) year warranty (including trees on municipal property) from date accepted on all work unless otherwise specified.
- Any site plan or grading and servicing shown is for information only. Refer to approved drawings.
- Not for construction unless stamped, signed and dated by Landscape Architect.
- Drawings not to be reproduced without written consent from Landscape Architect.
- Approval of landscape plan to be obtained from municipality.
- All plant material to be planted a minimum of 1.0m from any swales or ditches.
- For grading and servicing information refer to the consulting Engineer's drawing.
- For lighting information and power distribution refer to the electrical consultant's drawings.

TERRASED NOTES:

- Areas to be seeded with naturalization mix shall receive an application of naturalization seed at the rate of 25-30 kg/hectare or 2 kg/100m² for spot applications. In the following mixture:
Upland Dry Meadow Mix*
 Black-eyed Susan (Rudbeckia hirta) 15%
 Blue Wood Aster (Symphyotrichum cordifolius) 1%
 Canada Goldenrod (Solidago canadensis) 10%
 Common Milkweed (Asclepias syriaca) 9%
 Little Bluestem (Schizachyrium scoparium) 30%
 New England Aster (Aster novae-angliae) 15%
 Virgins Bower (Clematis virginiana) 5%
 Wild Bergamot (Monarda fistulosa) 15%
Early Succession/Riparian Mix*
 Black-eyed Susan (Rudbeckia hirta) 5%
 Blue Yervain (Verbena hastata) 10%
 Canada Anemone (Anemone canadensis) 1%
 Canada Goldenrod (Solidago canadensis) 4%
 Little Bluestem (Schizachyrium scoparium) 10%
 Common Milkweed (Asclepias syriaca) 5%
 Fowl Bluegrass (Poa palustris) 25%
 Meadow/Open Field Sedge (Carex granularis) 20%
 New England Aster (Symphyotrichum novae-angliae) 10%
 Path Rush (Juncus tenuis) 10%
 Purple Stemmed Aster (Symphyotrichum puniceum) 1%
 Virgins Bower (Clematis virginiana) 4%
 Wild Bergamot (Monarda fistulosa) 4%
- Contractor responsible for soil test to determine fertilizer rates. Results of soil test shall be provided to the Landscape Architect for review and approval.
- Hydraulic mulch to be approved by the Landscape Architect shall be applied at the rate of 2100kg per hectare.
- The contractor shall not carry out the work under adverse weather conditions such as high wind, frozen ground or ground covered with snow, ice or standing water.
- Grade sub-grade, eliminate uneven areas and low spots, ensure positive drainage. Remove debris, roots, branches, stones in excess of 50mm diameter and other deleterious materials. Remove subsoil that has been contaminated with oil, gasoline or calcium chloride, dispose of removed material as directed by Landscape Architect.
- Grade seed bed for terra-seeding to a uniform surface and remove vegetation which may interfere with seeding operations. Loosen soil to depth of 25mm minimum and remove stones and foreign material which protrude more than 75mm above the surface.
- All areas to be terra-seeded to receive 150mm of topsoil. See plan for locations.
- Seeded areas to be maintained by contractor ensuring adequate water, fertilizer, maintenance and repair until seeded areas are properly established.
- Latest date for seeding is October 15th. Areas seeded in fall will be accepted in following spring, one month after start of growing season provided acceptance conditions are fulfilled.

NOT FOR CONSTRUCTION
 ISSUED FOR REVIEW & COMMENTS ONLY

CLIENT
 Mataj Architects Inc.

MUNICIPALITY
 Town of Oakville

PROJECT
 Ismail Office Building
 2176 Speers Road

MUNICIPAL FILE NUMBER
 SP.#1627.041-01

SHEET
 Landscape Plan

adesso design inc.
 landscape architecture

99 John Street South, Suite 250
 Hamilton, ON L8N 2B9
 1.905.526.8876
 www.adessodesigninc.ca

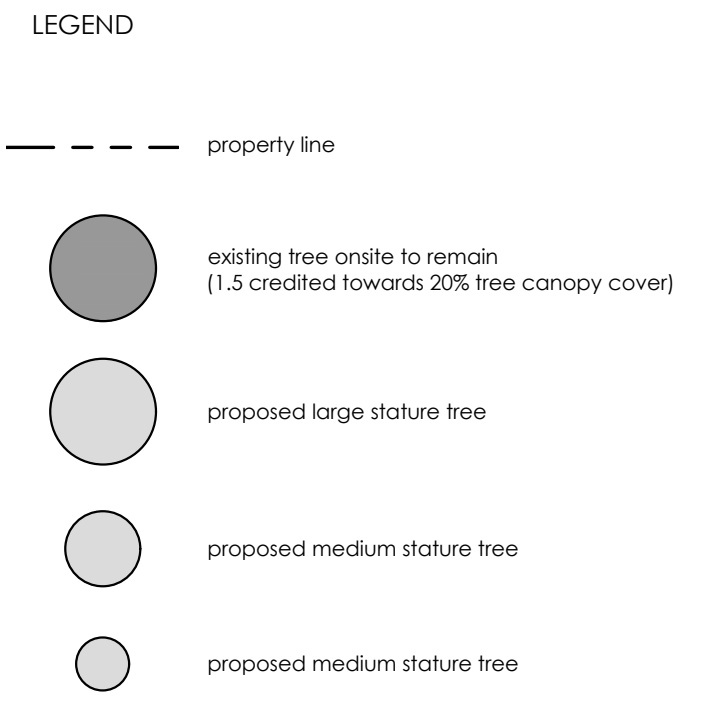
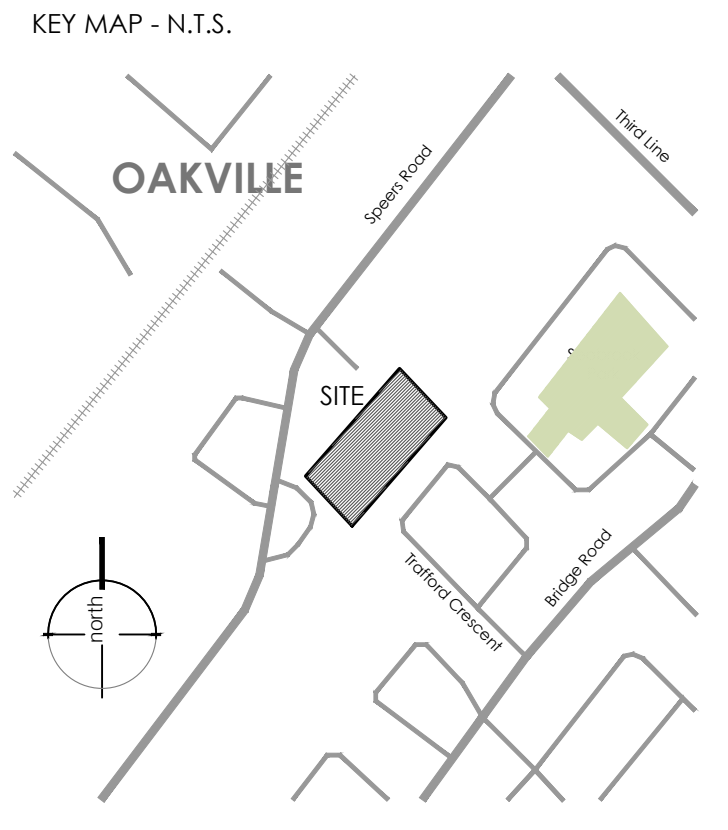
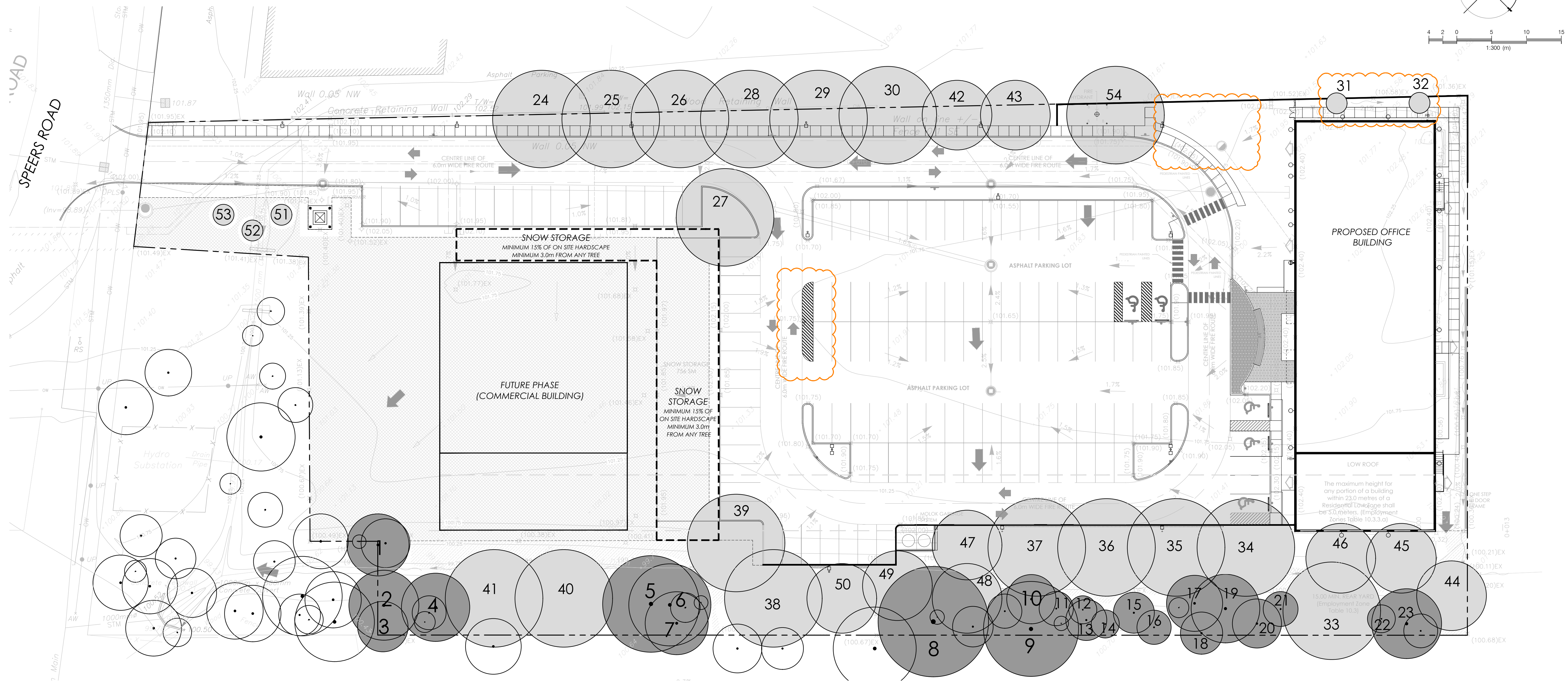

NOT FOR CONSTRUCTION
ISSUED FOR REVIEW & COMMENTS ONLY

REVISIONS/ SUBMISSIONS

#	DATE	DESCRIPTION
4	2019-07-22	Issued for submission
5	2019-08-23	Issued for pricing
6	2019-10-16	Issued for resubmission (Urban and Forestry comments revision)
7	2019-11-06	Issued for submission
8	2021-09-20	Issued for review
9	2021-11-24	Issued for site inspection #1
10	2023-09-29	Issued for SPA amendment



CLIENT
Mataj Architects Inc.
MUNICIPALITY
Town of Oakville
PROJECT
Ismail Office Building
2176 Speers Road

MUNICIPAL FILE NUMBER
SP.#1627.041-01

SHEET
Canopy Cover Plan

adesso design inc.
landscape architecture

69 John Street South, Suite 250
Hamilton, ON L8N 2B9
t. 905.526.8876
www.adessodesigninc.ca

CANOPY CALCULATION CHART

Tree#	Tree Species	# of trees	Soil Volume (meters cubed) per tree	Crown Area (meters squared) per tree	Canopy Area Subtotal (meters squared)
1	Existing Trees				
1	Crataegus crus-galli	1			62.27
2	Pinus strobus	1			67.92
3	Tilia americana	1			9.95
4	Pinus strobus	1			75.43
5	Ulmus pumila	1			150.76
6	Ulmus pumila	1			16.20
7	Carya ovata	1			8.60
8	Quercus rubra	1			197.16
9	Quercus rubra	1			145.89
10	Quercus rubra	1			4.38
11	Quercus rubra	1			0.44
12	Pinus strobus	1			1.68
13	Quercus rubra	1			21.28
14	Pinus strobus	1			5.90
15	Acer platanoides	1			27.11
16	Malus coronaria	1			13.83
17	Malus coronaria	1			26.76
18	Acer platanoides	1			12.88
19	Pinus strobus	1			76.16
20	Pinus strobus	1			16.68
21	Pinus strobus	1			19.63
22	Acer platanoides	1			1.67
23	Tilia americana	1			78.97
Subtotal of existing tree crown area (Overlapping canopies have not been counted twice)					1041.55
Subtotal of existing tree bonus factor 1.5					520.78

Tree#	Tree Species	# of trees	Soil Volume (meters cubed) per tree	Crown Area (meters squared) per tree	Canopy Area Subtotal (meters squared)
Proposed Large Stature Trees (14+m spread)					
24	Quercus rubra	1	30.11	154.00	154.00
25-26	Celtis occidentalis	2	17.33	154.00	252.77
27	Celtis occidentalis	1	51.03	154.00	154.00
28-30	Acer saccharinum	3	23.48	154.00	379.27
33	Platanus occidentalis	1	91.84	154.00	141.16
34	Platanus occidentalis	1	120.10	154.00	140.42
35-37	Acer saccharinum	3	86.69	154.00	354.47
38-39	Celtis occidentalis	2	114.70	154.00	276.78
40-41	Acer saccharum	2	142.88	154.00	255.62
54	Liriodendron tulipifera	1	32.73	154.00	154.00
Proposed Medium Stature Trees (10-13m spread)					
42-43	Acer rubrum	2	22.12	78.5	141.75
44-46	Acer rubrum	3	83.25	78.5	188.79
47-50	Acer rubrum	4	65.50	78.5	178.04
Proposed Small Stature Trees (3-9m spread)					
51-53	Picea glauca	3	54.27	7.0	21.00
31-32	Acer rubrum 'Karpick'	2	15.23	14	14
Total # of trees					54
Total Canopy (meters squared)					4,368.4
Canopy Summary					
Site Area			12,923.06 sqm		
Site Canopy Cover			33.8%		
Land use Canopy Cover Target			20.00%		
Parking Area Summary					
Total Parking Spaces Proposed			134		
Total # of Trees within Parking Lot Island			1		

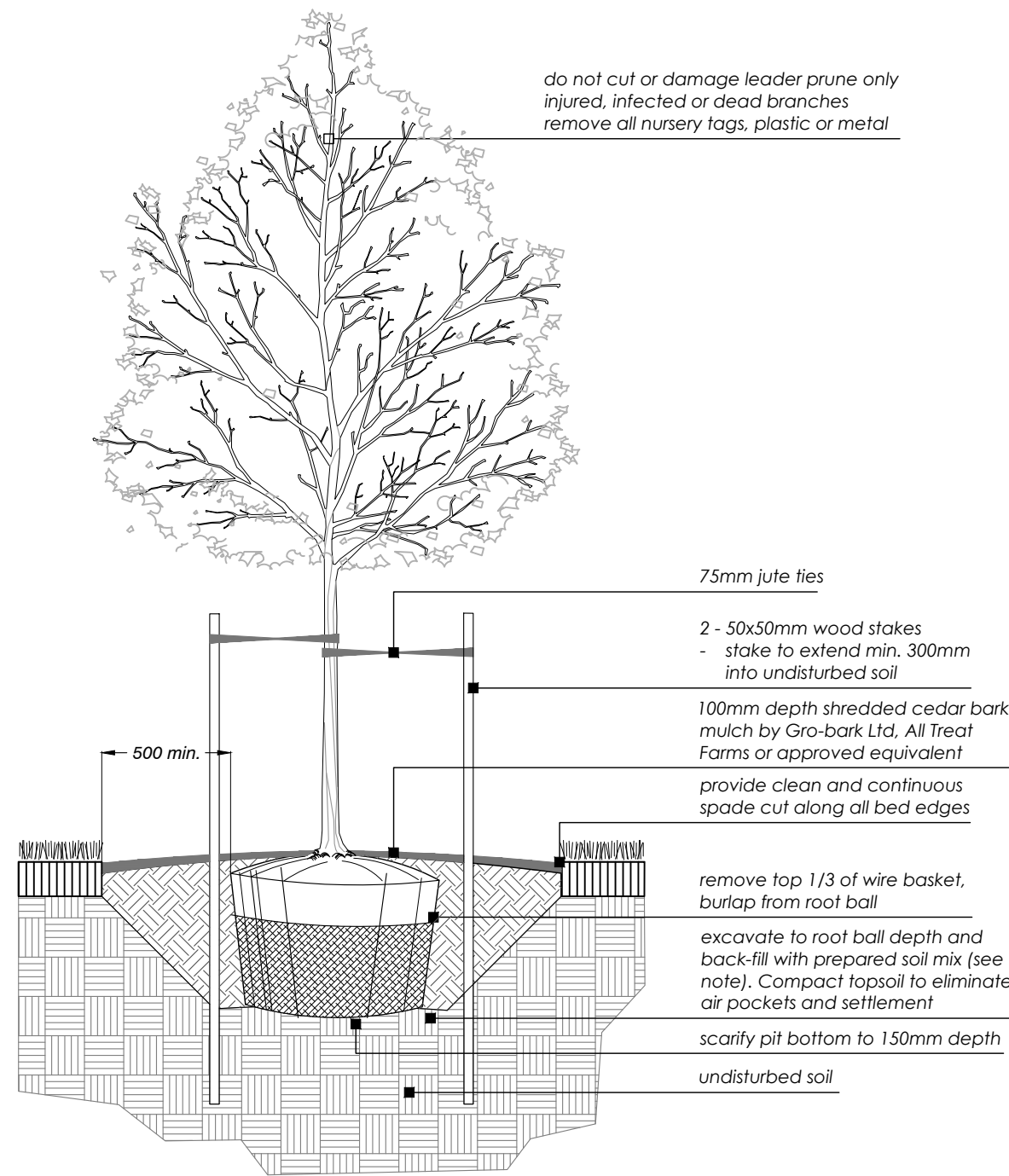

Balled & Burlapped/ Wire Basket Deciduous Tree

D 1

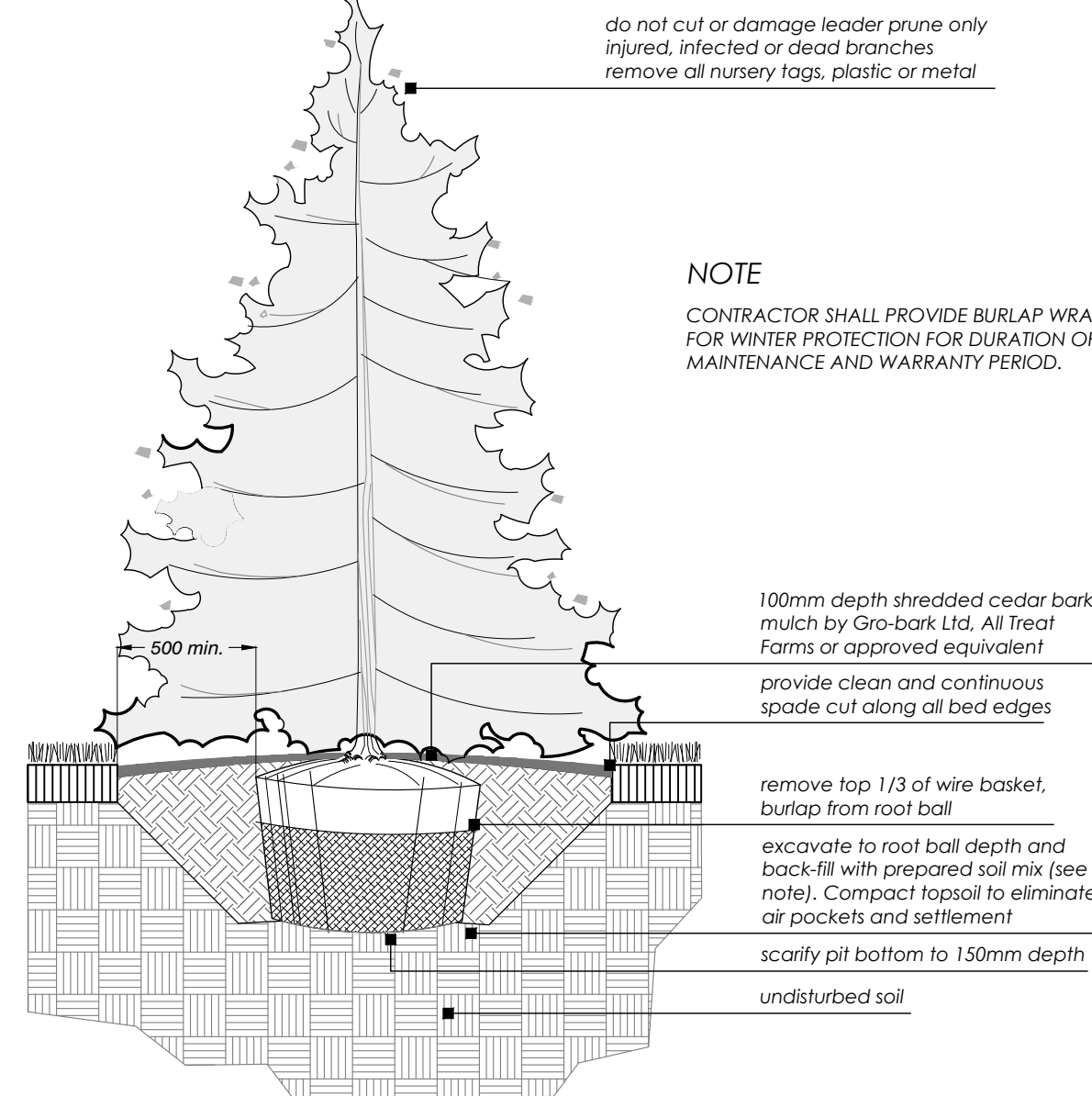

Balled & Burlapped/ Wire Basket Coniferous Tree

D 2

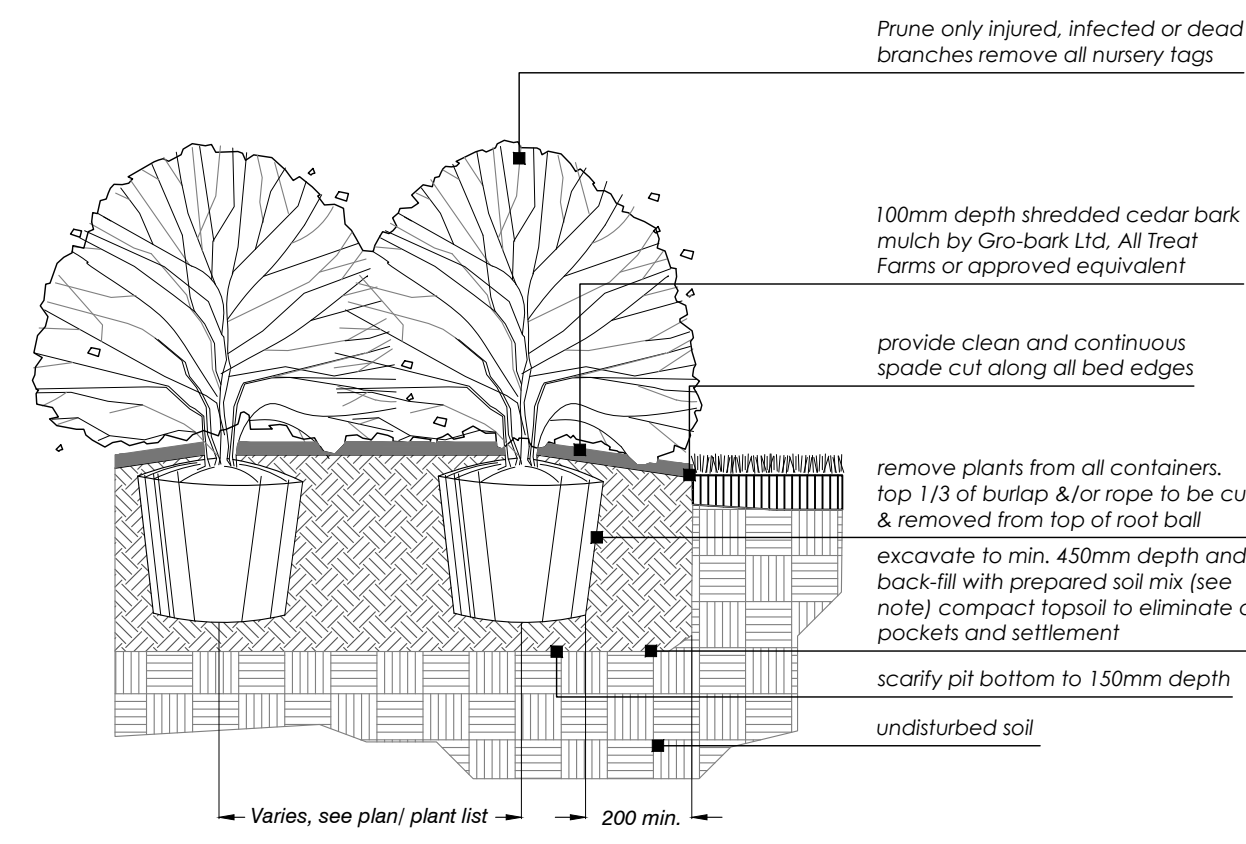

Container Grown Shrub

D 3

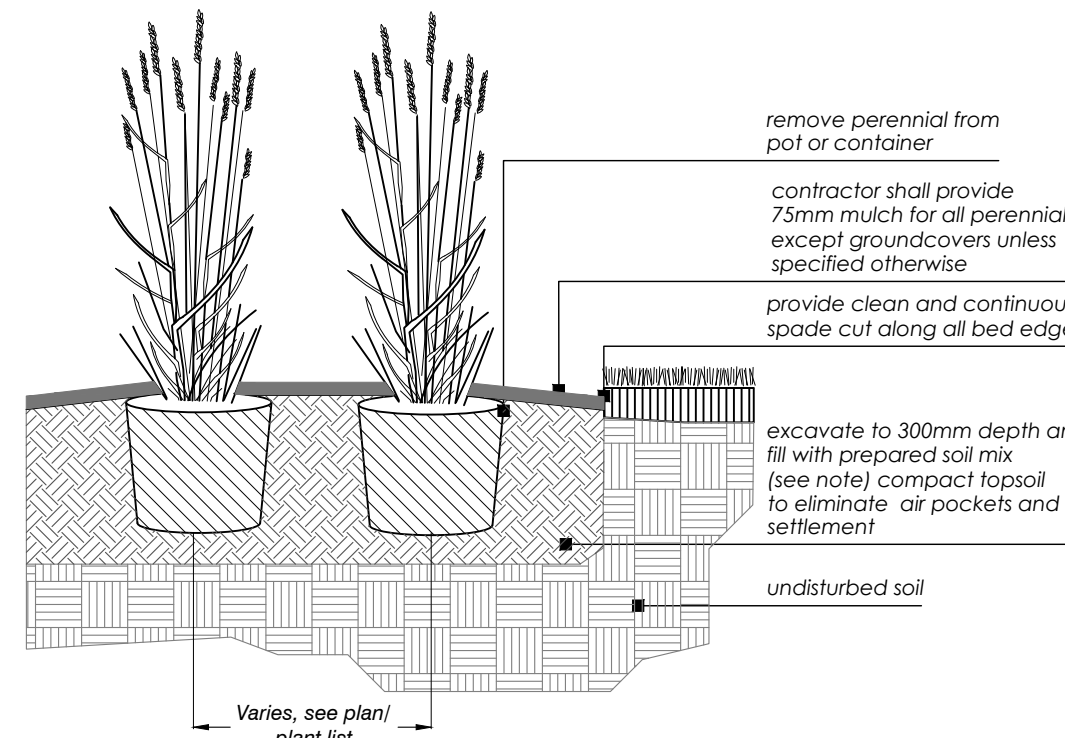

Container Grown Perennial

D 4

MAX. POST CENTRES 95.75" (2432mm)
PANEL WIDTH 90.50" (2299mm)

PANEL HEIGHT	PANEL WIDTH	POST CENTRES
UP TO 6FT. HIGH	90" (2286mm)	95" (2413mm)
7FT. AND HIGHER	69" (1753mm)	74" (1880mm)

NOTE: ENQUIRE ABOUT PANEL WIDTHS OF 90" (2299) FOR PANELS ABOVE 7' (2133) HIGH

PREPARATIONS:
POSTS: EXTRUDED MARINE ALUMINUM 6061-T6
POCKETS: PRIME ALUMINUM, NORTH AMERICAN PRODUCED

FINISH: SEVEN STAGE ELECTROLYTICALLY CERTIFIED PRETREATMENT AS PER ANMA 3004
SIXTY SEVEN ELECTROLYTICALLY APPLIED POWDER COAT - MIN THICKNESS 2.5 MILS

POSTS: 76mm x 76mm (3"x3") 188 WALL
OPTION: 102mm x 102mm (4"x4") 188 WALL

POST FLANGES: 152mm x 152mm x 6mm (6"x6"x1/2") OR 203mm x 203mm x 13mm (8"x8"x1/2")

POST CAP: PHRIMED DR. BALL

RAILS: 38mm x 64mm (1 1/2" x 2 1/2") 120 WALL

POCKETS: 19mm x 38mm (3/4" x 1 1/2") 120 WALL

INFILL: 152mm (6") DIA. CAST ALUMINUM RINGS

FITTINGS: 12GA. STAMPED MARINE GRADE ALUMINUM FINISH AS REQUIRED

WELDS: ALUMINUM - FULL BEAD ON PUBLIC SIDE - TRUCK WELD ON PRIVATE SIDE

COLOR: STANDARD COLORS ARE BLACK, GUN-BLACK, BROWN, GREEN, WHITE AND FOREST GREEN. (CUSTOM COLORS AVAILABLE UPON REQUEST)

WARRANTY: 20 YEAR LIMITED

NOTES: ALL TYPES OF GATES AVAILABLE TAMPER PROOF NUTS AVAILABLE

COMMENTS: TITLE: IRON EAGLE II ALUMINUM CANADIAN EAGLE II C/W PARTIAL RINGS

IRON EAGLE INDUSTRIES 1256 CARDIFF BLVD., MISSISSAUGA, ON L5S 1R1 www.ironeagleind.com info@ironeagleind.com TEL: 905.670-2558 FAX: 905.670-2538

DATE: JUN 12, 2018

1.2m High Decorative Metal Fence

D 8

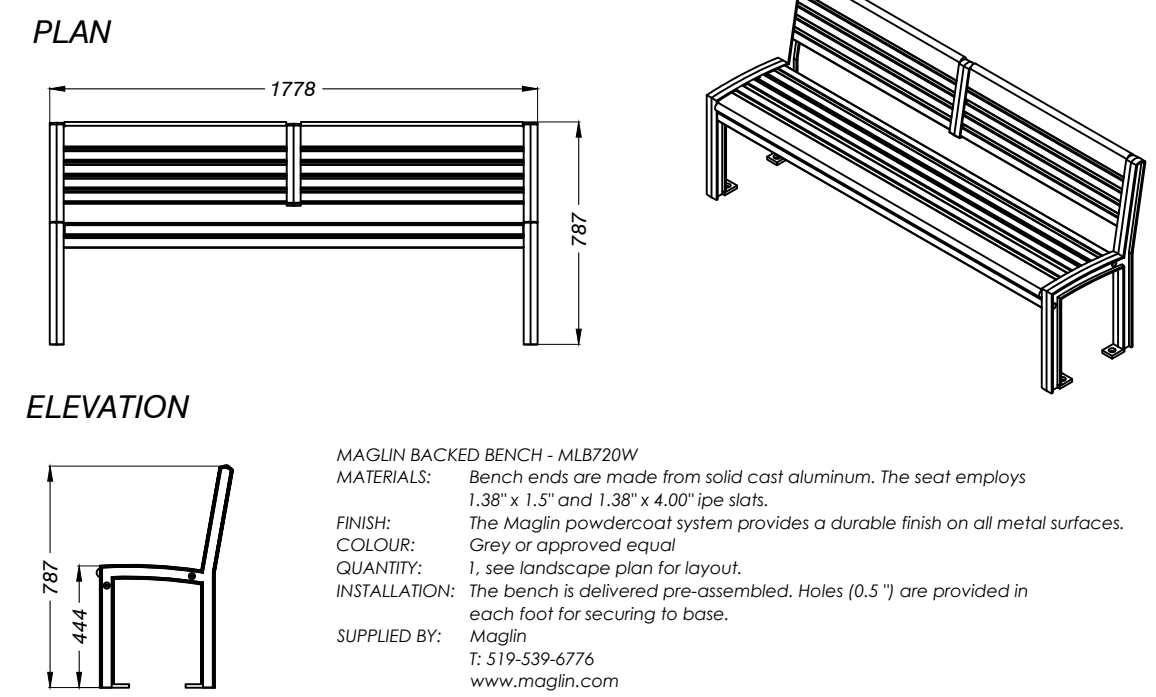

Backed Bench by Maglin (or approved equal)

D 5

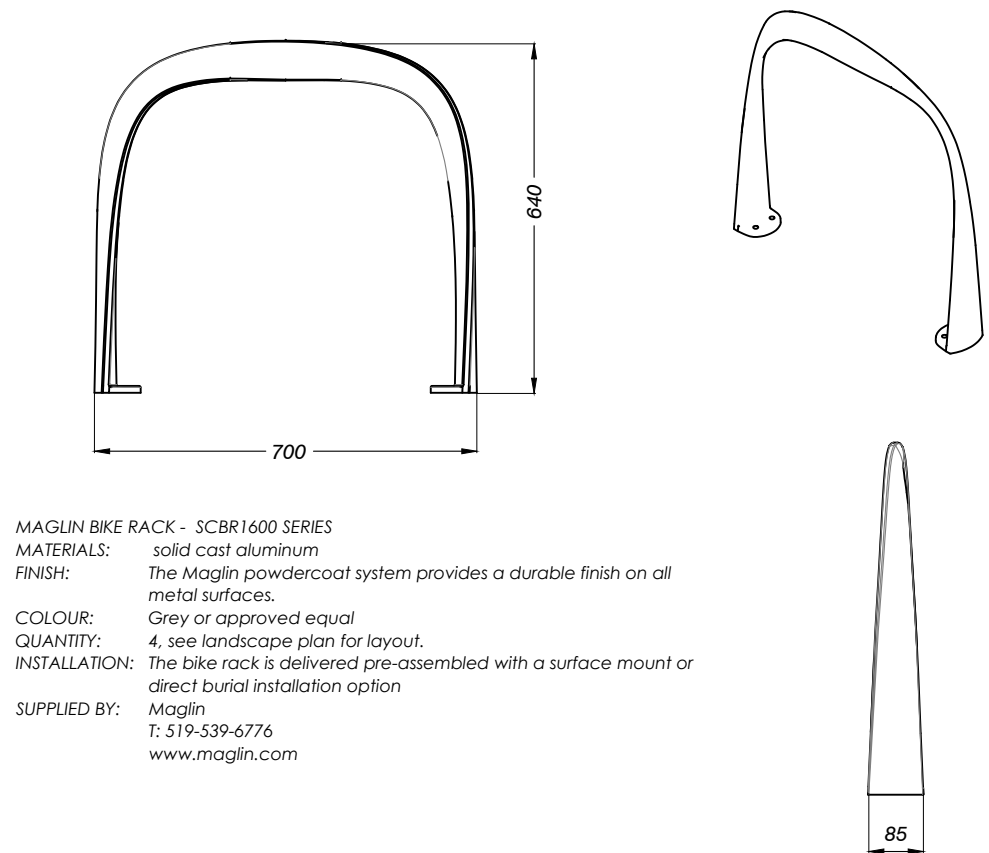

Bike Rack by Maglin (or approved equal)

D 6

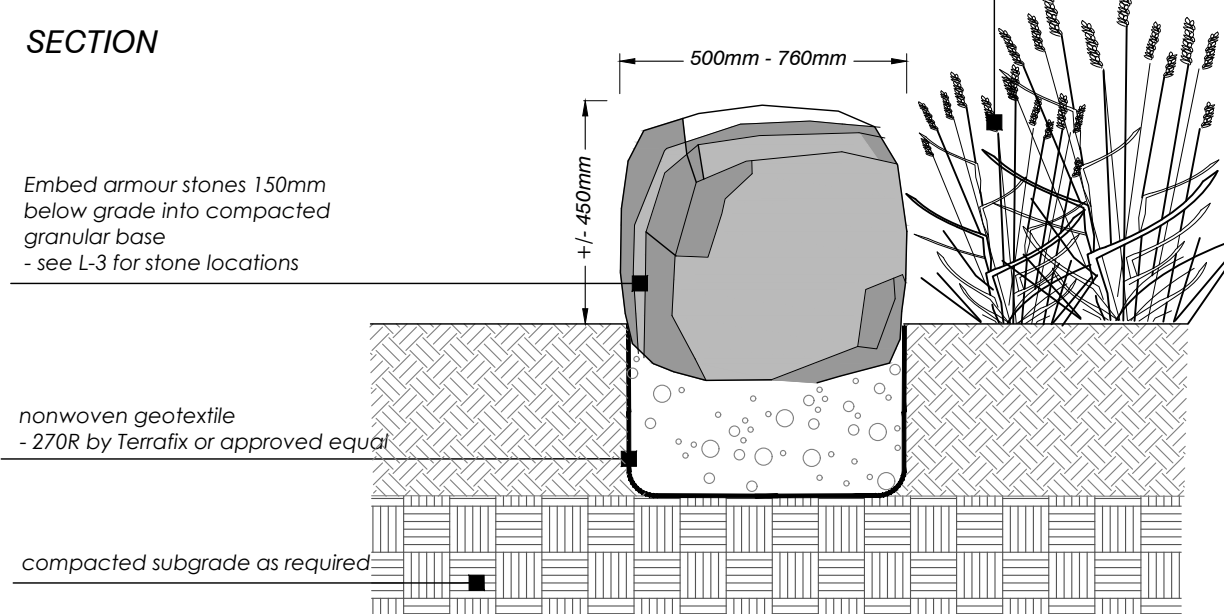

Amourstone

D 8

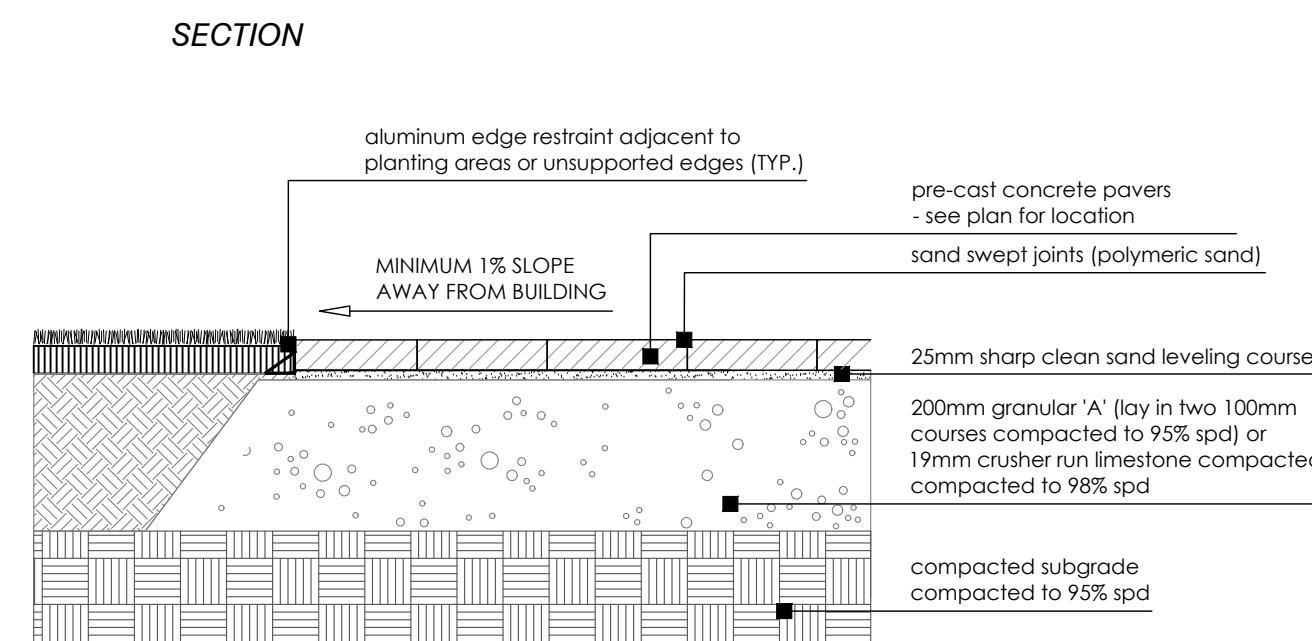

Precast Concrete Pavers

D 7

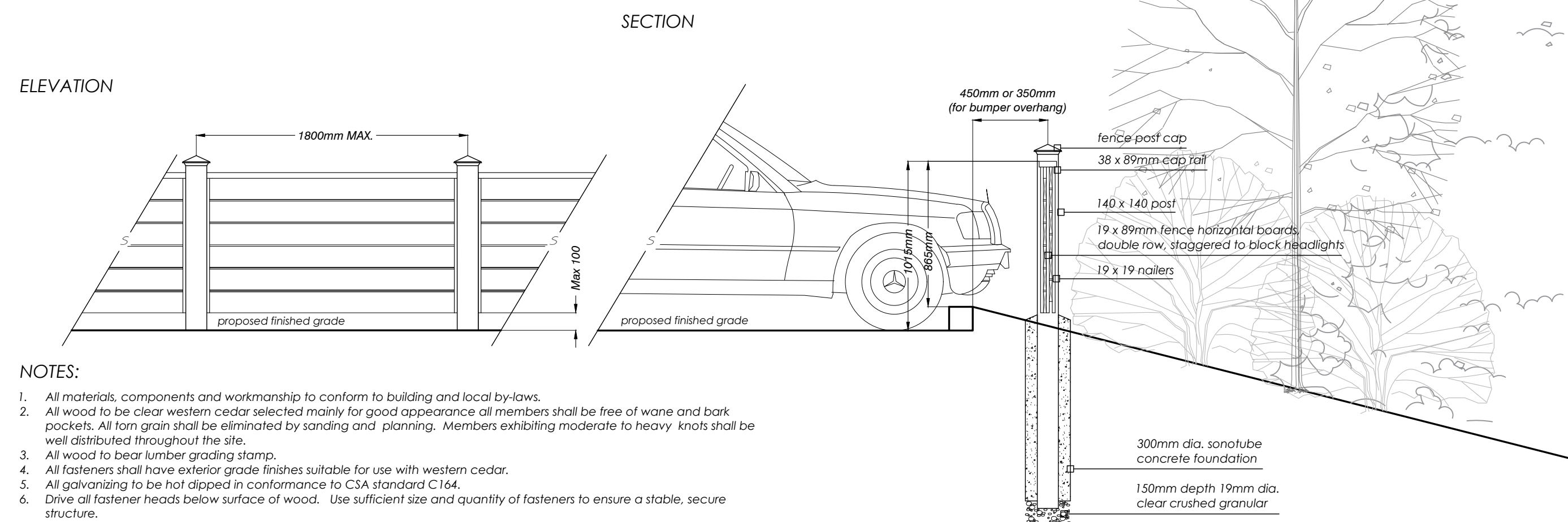

1015mm Height Wooden Fence (Blocking Vehicular Headlights)

D 9

- PLANTING NOTES:
- Soil mixture: four (4) parts native soil, one (1) part well rotted compost. If existing soil is not suitable provide triple mix topsoil or approved equal.
 - Saucer shall be soaked with water and mulched immediately following planting.
 - Massed shrubs shall be planted in continuous mulched beds unless otherwise noted.
 - Staking schedule:
 - < 30mm caliper size / 2500mm ht. - one stake
 - > 30mm caliper size / 2500mm ht. - two stakes
 - > 70mm caliper - three stakes
 - All support systems must be removed once tree is established.
 - All trees to be straight and planted vertically regardless of slope.
 - Top of root flare shall be positioned 50mm above grade.
 - 15cm topsoil for sod;
 - 30cm of topsoil for perennials;
 - 45cm of topsoil for shrubs;
 - 90cm of topsoil for trees

NOT FOR CONSTRUCTION
ISSUED FOR REVIEW & COMMENTS ONLY

REVISIONS/ SUBMISSIONS

#	DATE	DESCRIPTION
4	2019-07-22	Issued for submission
5	2019-08-23	Issued for pricing
6	2019-10-16	Issued for resubmission (Urban and Forestry comments revision)
7	2019-11-06	Issued for submission
8	2021-09-20	Issued for review
9	2021-11-24	Issued for site instruction #1
10	2023-09-29	Issued for SPA amendment



CLIENT
Mataj Architects Inc.
MUNICIPALITY
Town of Oakville

PROJECT
Ismail Office Building
2176 Speers Road

MUNICIPAL FILE NUMBER
SP.# 1627.041-01

SHEET
Details

adesso design inc.
landscape architecture

69 John Street South, Suite 250
Hamilton, ON L8N 2B9
t. 905.526.8876
www.adessodesigninc.ca

L-5