

LEGEND

- PROPOSED SODDED AREA
- PLANTING BED
- PROPOSED CONCRETE, REFER TO CIVIL PLANS
- HEAVY DUTY ASPHALT, REFER TO CIVIL PLANS
- CRUSH STONE GENERATOR YARD, REFER TO CIVIL PLANS
- EXISTING TREES
- EXISTING VEGETATION
- PROPOSED GRASS/PERENNIAL PLANTINGS
- PROPOSED SHRUBS
- PROPOSED DECIDUOUS TREES
- PROPOSED CONIFEROUS TREES
- PROPOSED ARMOUR STONES
- PROPERTY LINE
- PROPOSED FENCE - SEE CIVIL
- PROPOSED LIGHT POST - SEE ELEC.
- PEDESTRIAN CIRCULATION

GENERAL NOTES:

1. SEE SHEET L001 FOR FULL PROJECT NOTES.
2. ALL EXISTING AND PROPOSED DESIGN ELEMENTS TO BE VERIFIED BY CONTRACTOR PRIOR TO ANY WORK.
3. REFER TO ENGINEERING PACKAGE FOR ALL HARDSCAPE DETAILING AND INSTRUCTION. LANDSCAPE LAYOUT SHEETS DISPLAYING HARDSCAPE ARE FOR GRAPHIC INFORMATION ONLY.
4. SEE LAYOUT AND PLANTING SHEETS L200 AND L300 FOR ENLARGEMENTS.



A | 49



FOR PERMIT ONLY



CLIENT:
OAKVILLE
 OAKVILLE TRANSIT ELECTRIFICATION PROGRAM
 430 WYECROFT RD, OAKVILLE, ON L6K 2G7

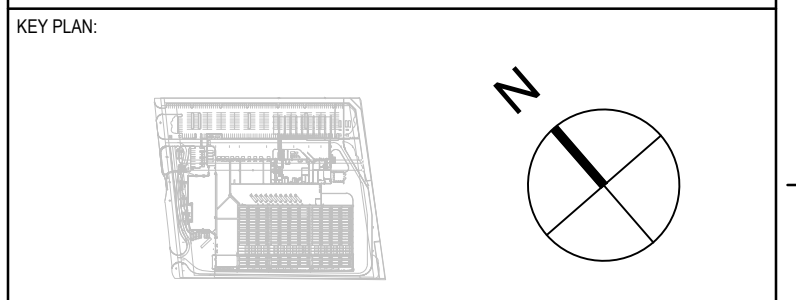

DISCLAIMER: THIS DRAWING AND DESIGN IS COPYRIGHT PROTECTED WHICH SHALL NOT BE USED, REPRODUCED OR REVISED WITHOUT WRITTEN PERMISSION BY ARCHITECTURE AT THE CONTRACTOR SHALL CHECK AND VERIFY ALL DIMENSIONS AND UTILITY LOCATIONS AND REPORT ALL ERRORS AND OMISSIONS PRIOR TO COMMENCING WORK. THIS DRAWING IS NOT TO BE SCALED.

ISSUED FOR - REVISION

NO.	REV	DATE	DESCRIPTION
12	0A	24-11-22	ISSUED FOR SITE PLAN APPLICATION
11	0A	24-11-19	ISSUED FOR 100% REVIEW EIC
10	0A	24-11-11	ISSUED FOR SITE PLAN REVIEW
09	0B	24-09-11	ISSUED FOR 100% REVIEW
08	0A	24-08-09	ISSUED FOR PERMIT
07	0A	24-08-07	ISSUED FOR 100% REVIEW
06	0A	24-07-12	ISSUED FOR 100% DESIGN REVIEW
05	0A	24-04-12	ISSUED FOR 60% REVIEW
04	0A	24-03-01	ISSUED FOR SITE PLAN APPLICATION
03	0A	24-02-29	ISSUED FOR 60% DESIGN

PROJECT NO: 221-04536-00 DATE: 2024/04/12

ORIGINAL SCALE: N/A

DESIGNED BY: JS/BK

DRAWN BY: BK/KL

CHECKED BY: JS

DISCIPLINE: **LANDSCAPE**

TITLE: **LANDSCAPE KEY PLAN**

SHEET NUMBER: **L100**

SHEET #: 03 OF 08

ISSUE: 12

DATE OF: NOV 22, 2024

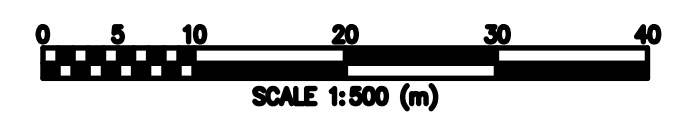

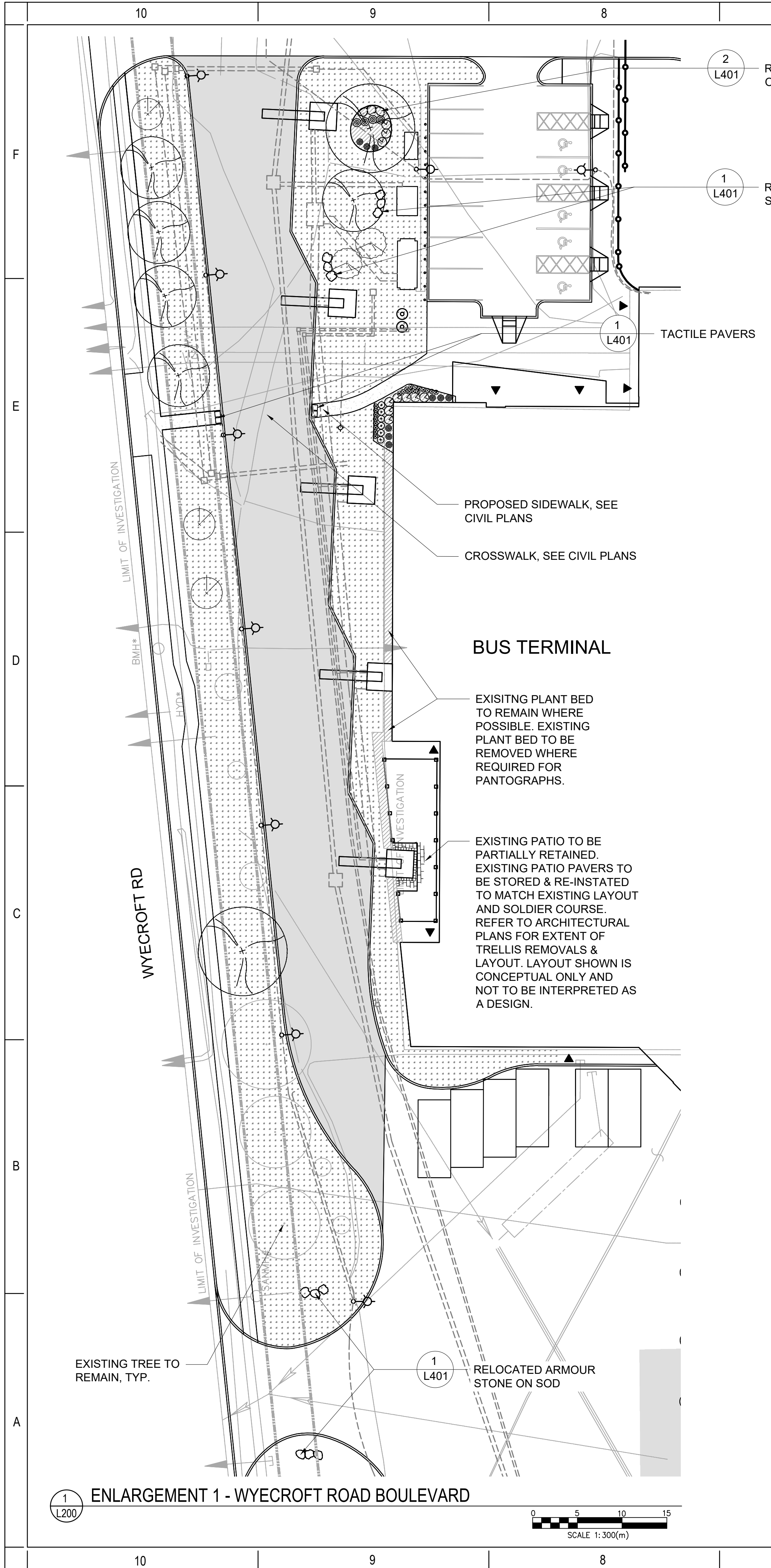

1 ENLARGEMENT 1 - WYECROFT ROAD BOULEVARD

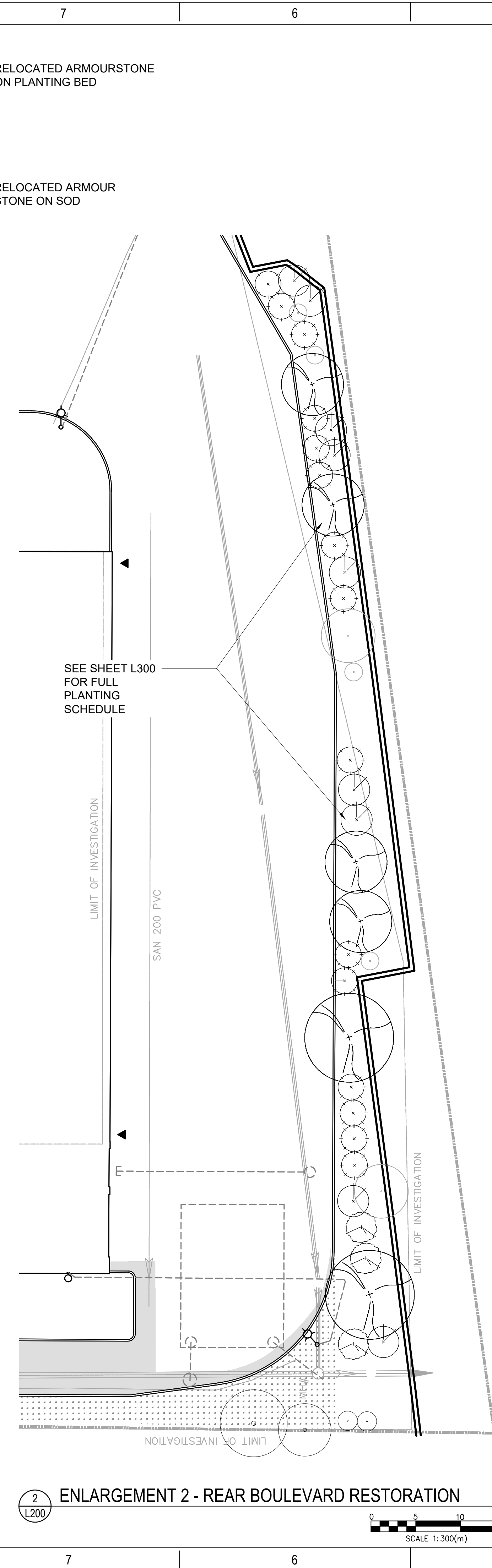
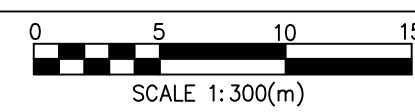

2 ENLARGEMENT 2 - REAR BOULEVARD RESTORATION

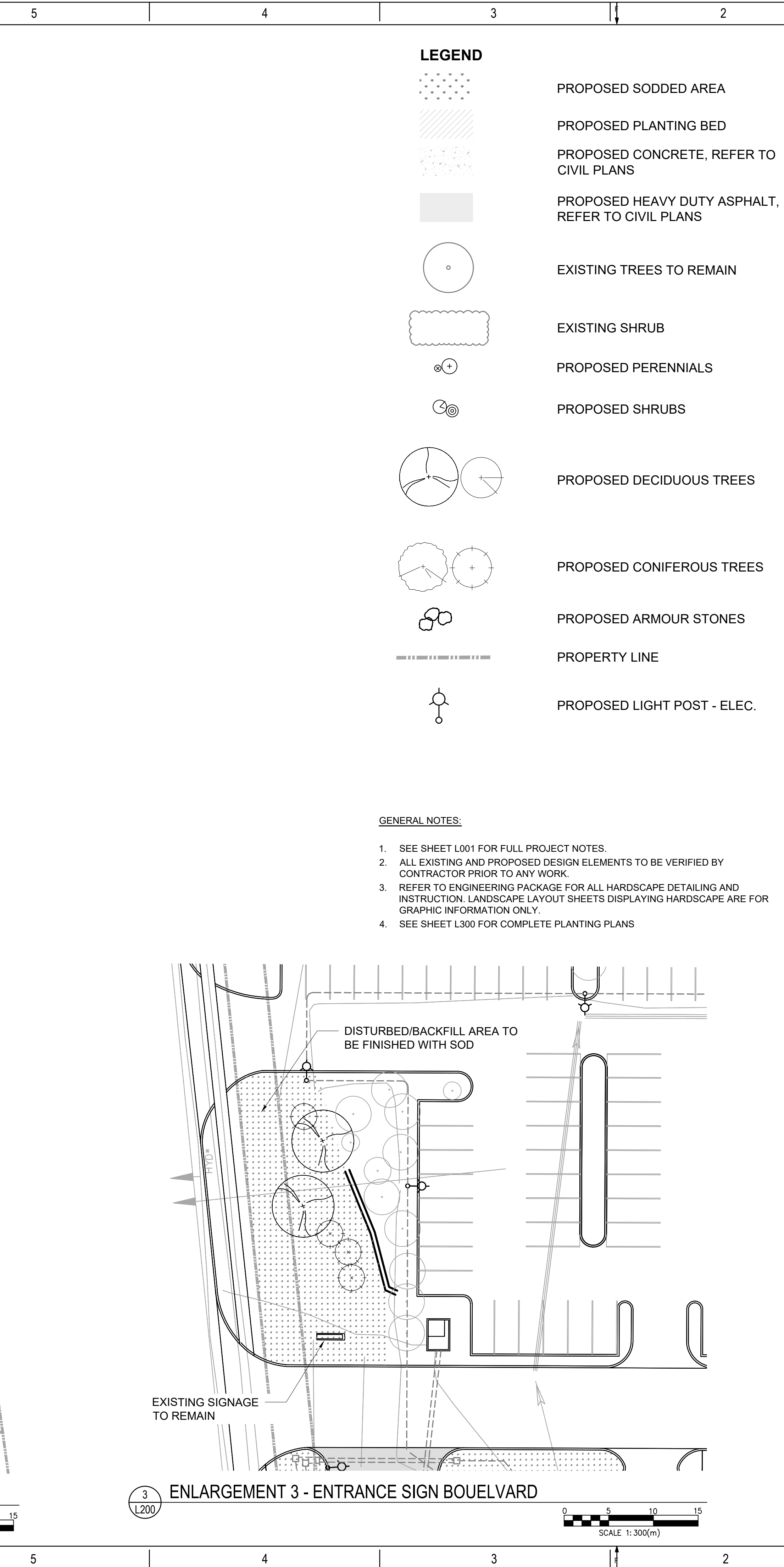
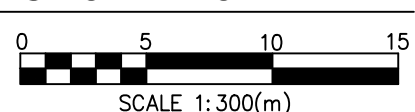

3 ENLARGEMENT 3 - ENTRANCE SIGN BOUELVARD

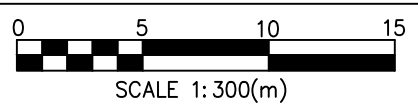

LEGEND

- PROPOSED SODDED AREA
- PROPOSED PLANTING BED
- PROPOSED CONCRETE, REFER TO CIVIL PLANS
- PROPOSED HEAVY DUTY ASPHALT, REFER TO CIVIL PLANS
- EXISTING TREES TO REMAIN
- EXISTING SHRUB
- PROPOSED PERENNIALS
- PROPOSED SHRUBS
- PROPOSED DECIDUOUS TREES
- PROPOSED CONIFEROUS TREES
- PROPOSED ARMOUR STONES
- PROPERTY LINE
- PROPOSED LIGHT POST - ELEC.

GENERAL NOTES:

1. SEE SHEET L001 FOR FULL PROJECT NOTES.
2. ALL EXISTING AND PROPOSED DESIGN ELEMENTS TO BE VERIFIED BY CONTRACTOR PRIOR TO ANY WORK.
3. REFER TO ENGINEERING PACKAGE FOR ALL HARDSCAPE DETAILING AND INSTRUCTION. LANDSCAPE LAYOUT SHEETS DISPLAYING HARDSCAPE ARE FOR GRAPHIC INFORMATION ONLY.
4. SEE SHEET L300 FOR COMPLETE PLANTING PLANS



OAKVILLE TRANSIT ELECTRIFICATION PROGRAM
430 WYECROFT RD, OAKVILLE, ON L6K 2G7

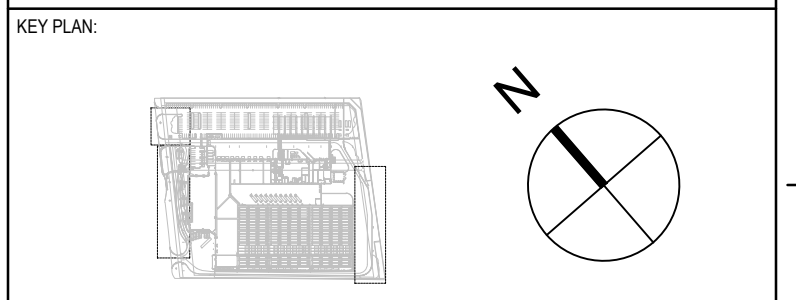

DISCLAIMER:
THIS DRAWING AND DESIGN IS COPYRIGHT PROTECTED WHICH SHALL NOT BE USED, REPRODUCED OR REVISED WITHOUT WRITTEN PERMISSION BY ARCHITECTURE. THE CONTRACTOR SHALL CHECK AND VERIFY ALL DIMENSIONS AND UTILITY LOCATIONS AND REPORT ALL ERRORS AND OMISSIONS PRIOR TO COMMENCING WORK. THIS DRAWING IS NOT TO BE SCALED.

ISSUED FOR - REVISION

NO.	REV	DATE	DESCRIPTION
11	0A	24-11-22	ISSUED FOR SITE PLAN APPLICATION
10	0A	24-11-19	ISSUED FOR 100% REVIEW EIC
09	0B	24-09-11	ISSUED FOR 100% REVIEW
08	0A	24-08-09	ISSUED FOR PERMIT
07	0A	24-08-07	ISSUED FOR 100% REVIEW
06	0A	24-07-12	ISSUED FOR 100% DESIGN REVIEW
05	0A	24-04-12	ISSUED FOR 60% REVIEW
04	0A	24-03-01	ISSUED FOR SITE PLAN APPLICATION
03	0A	24-02-29	ISSUED FOR 60% DESIGN

PROJECT NO: 221-04536-00 DATE: 2024/04/12

ORIGINAL SCALE: N/A

DESIGNED BY: JS/BK

DRAWN BY: BK/KL

CHECKED BY: JS

DISCIPLINE: LANDSCAPE

TITLE: LANDSCAPE LAYOUT PLAN

SHEET NUMBER: L200

SHEET # 04 OF 08

ISSUE 11

DATE OF: NOV 22, 2024

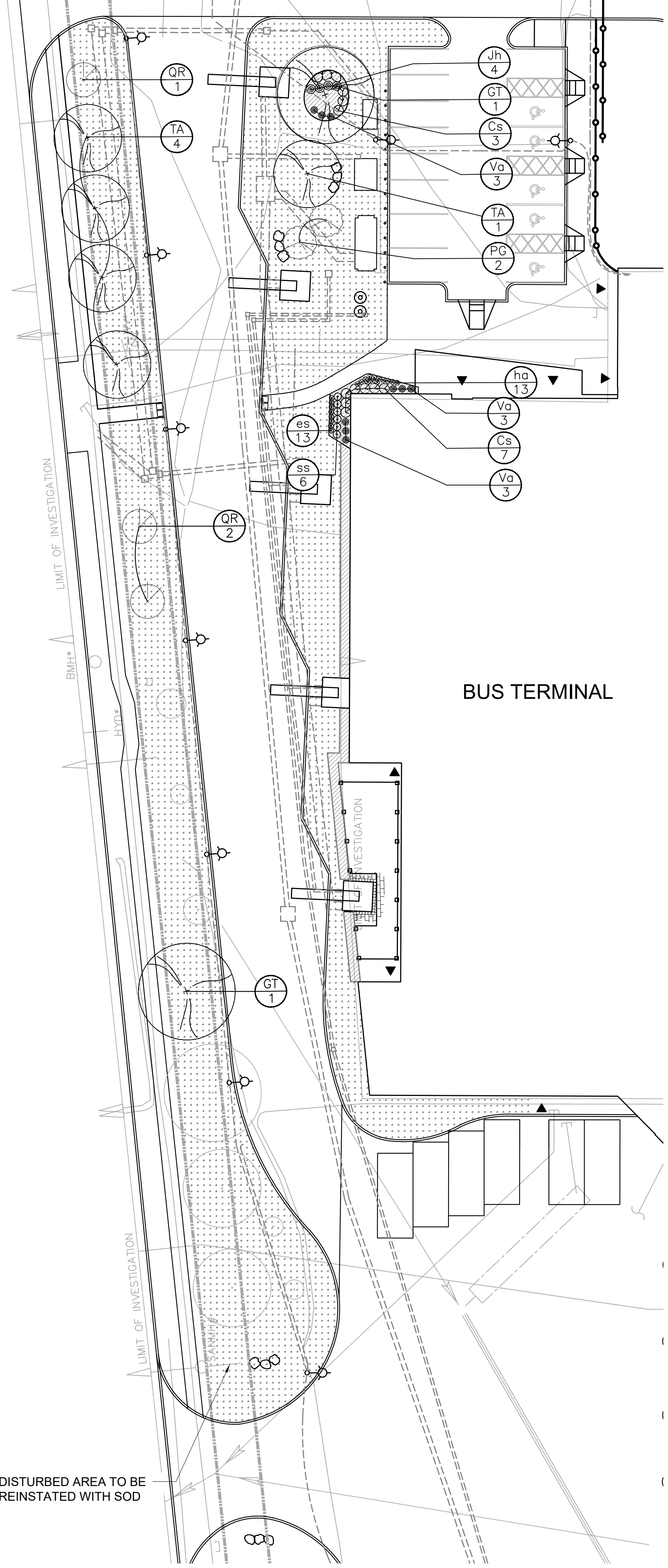

1 ENLARGEMENT 1 - WYECROFT ROAD BOULEVARD

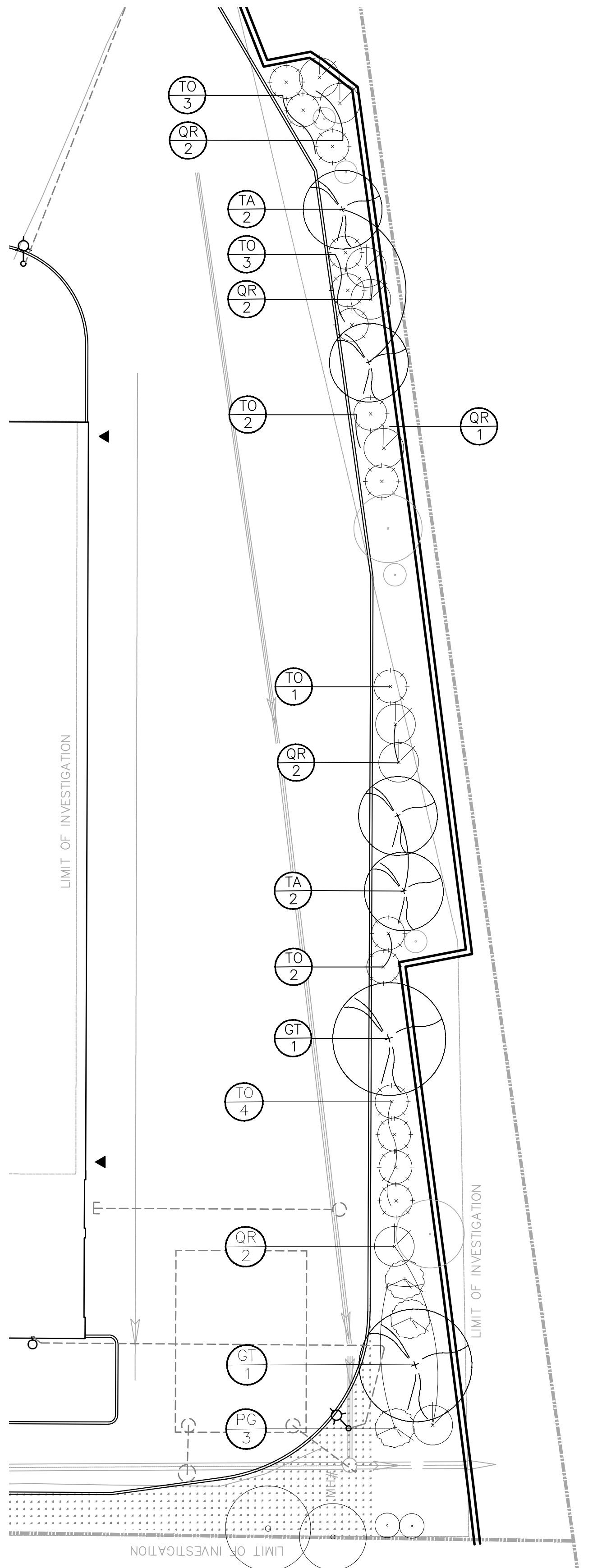
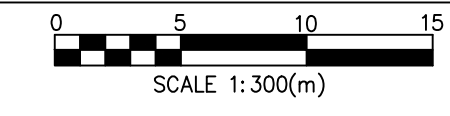

2 ENLARGEMENT 2 - REAR BOULEVARD RESTORATION

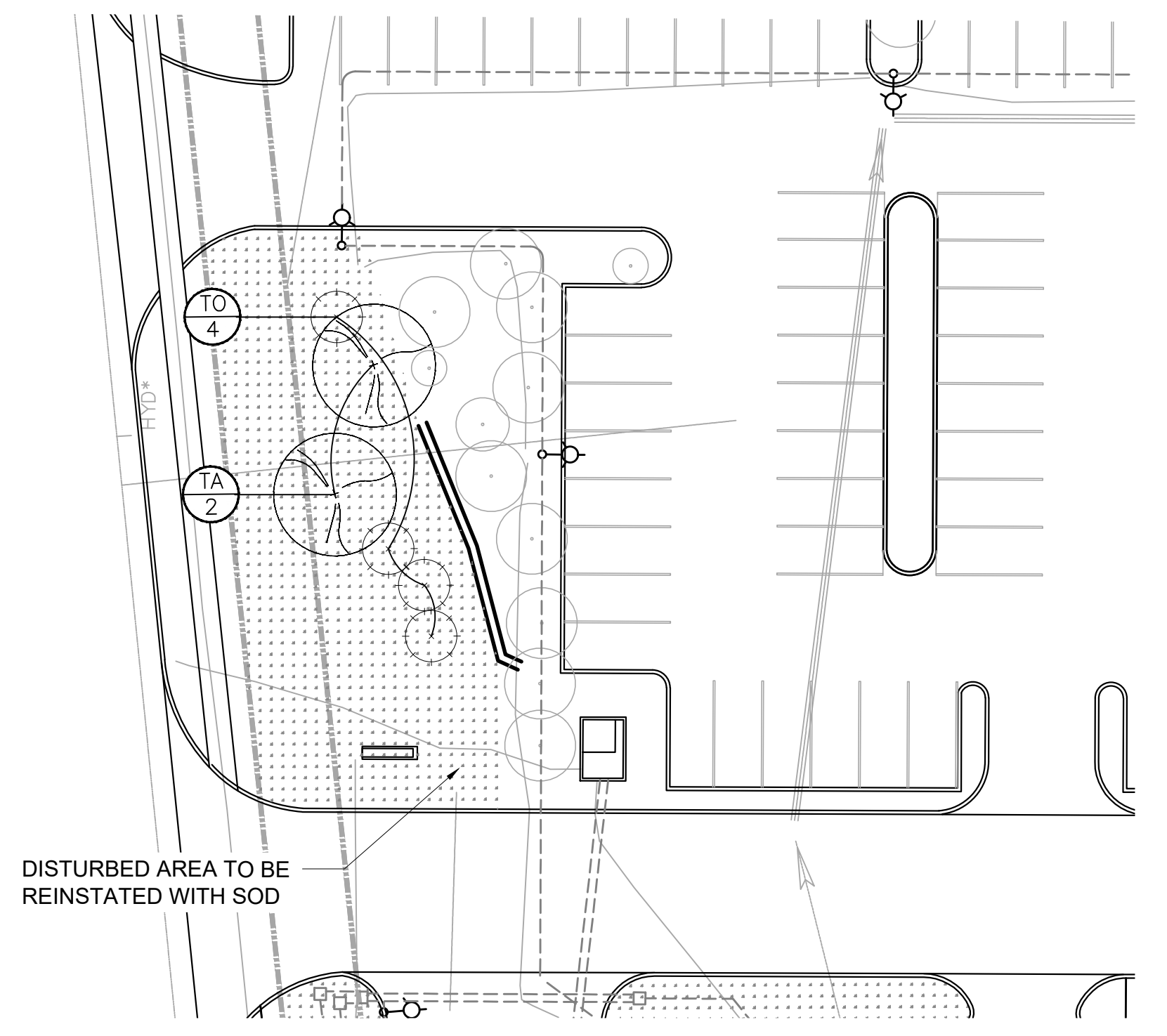
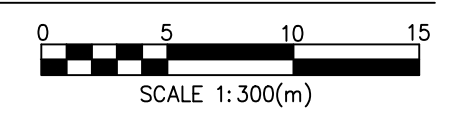

3 ENLARGEMENT 3 - ENTRANCE SIGN BOUlevard

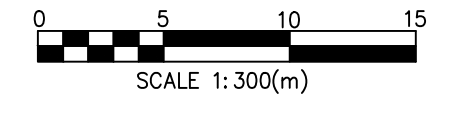

LEGEND

- PROPOSED SODDED AREA
- PROPOSED PLANTING BED
- PROPOSED CONCRETE, REFER TO CIVIL PLANS
- EXISTING TREES TO REMAIN
- EXISTING VEGETATION
- PROPOSED PERENNIALS
- PROPOSED SHRUBS
- PROPOSED SHRUBS
- PROPOSED DECIDUOUS TREES
- PROPOSED CONIFEROUS TREES
- PROPOSED ARMOUR STONES
- PROPERTY LINE
- PROPOSED LIGHT POST ELEC.

PLANT LIST

KEY	BOTANIC NAME	COMMON NAME	Qty.	Size	SPACING	REMARKS
DECIDUOUS TREES						
GT	Gleditsia triacanthos	Honey Locust	4	60mm Cal.	as shown	straight trunk, full crown
TA	Tilia americana	American Basswood	10	60mm Cal.	as shown	straight trunk, full crown
QR	Quercus robur fastigiata	Pyramidal English Oak	13	60mm Cal.	as shown	straight trunk, columnar
CONIFEROUS TREES						
PG	Picea glauca	White Spruce	5	1 m Ht.	as shown	Intact leader, full branches
TO	Thuja occidentalis	Eatern White Cedar	19	1 m Ht.	as shown	Intact leader, full branches
DECIDUOUS SHRUBS						
Cs	Cornus sericea	Red osier dogwood	10	3 gal	0.75-1.5m O.C.	3 stems min, full bushy
Va	Vaccinium angustifolium	Lowbush Blueberry	9	3 gal	0.6m O.C.	low groundcover
CONIFEROUS SHRUBS						
Jh	Juniperus horizontalis 'Prince of Wales'	Prince of Wales Juniper	4	3 gal	0.5 m O.C.	
GRASS AND SEDGES						
ss	Schizachyrium scoparium	Little Bluestem	6	1 gal	0.5 m O.C.	full vigorous specimen
PERENNIALS						
es	Echinacea Sombroero 'Salsa Red'	Salsa Red Coneflower	13	1 gal	0.5 m O.C.	full vigorous specimen
ha	Hemerocallis 'All Fired Up'	Reblooming Daylily	13	1 gal	0.5 m O.C.	full vigorous specimen

GENERAL NOTES:
 1. SEE SHEET L001 FOR FULL PROJECT NOTES.



FOR PERMIT ONLY



OAKVILLE TRANSIT ELECTRIFICATION PROGRAM
 430 WYECROFT RD, OAKVILLE, ON L6K 2G7

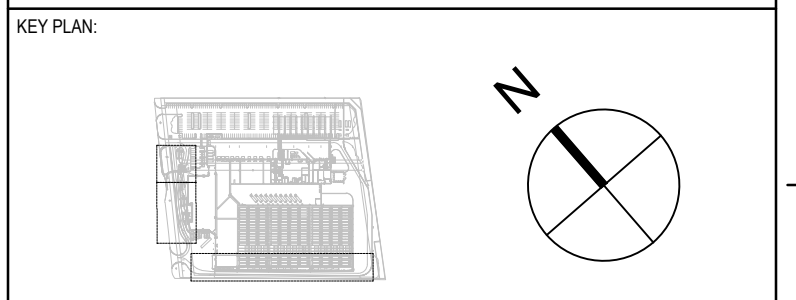

DISCLAIMER:
 THIS DRAWING AND DESIGN IS COPYRIGHT PROTECTED WHICH SHALL NOT BE USED, REPRODUCED OR REVISED WITHOUT WRITTEN PERMISSION BY ARCHITECTURE AT THE CONTRACTOR SHALL CHECK AND VERIFY ALL DIMENSIONS AND UTILITY LOCATIONS AND REPORT ALL ERRORS AND OMISSIONS PRIOR TO COMMENCING WORK. THIS DRAWING IS NOT TO BE SCALED.

ISSUED FOR REVISION:

NO.	REV.	DATE	DESCRIPTION
12	0A	24-11-22	ISSUED FOR SITE PLAN APPLICATION
11	0A	24-11-19	ISSUED FOR 100% REVIEW EIC
10	0A	24-09-19	ISSUED FOR SITE PLAN REVIEW
09	0B	24-09-11	ISSUED FOR 100% REVIEW
08	0A	24-08-09	ISSUED FOR PERMIT
07	0A	24-08-07	ISSUED FOR 100% REVIEW
06	0A	24-07-12	ISSUED FOR 100% DESIGN REVIEW
05	0A	24-04-12	ISSUED FOR 60% REVIEW
04	0A	24-03-01	ISSUED FOR SITE PLAN APPLICATION
03	0A	24-02-23	ISSUED FOR 60% DESIGN

PROJECT NO: 221-04536-00
 ORIGINAL SCALE: N/A
 DESIGNED BY: JS/BK
 DRAWN BY: BK/KL
 CHECKED BY: JS
 DISCIPLINE: LANDSCAPE
 TITLE: PLANTING PLAN
 SHEET NUMBER: L300
 SHEET #: 05 OF 08
 ISSUE: 12
 DATE OF: NOV 22, 2024

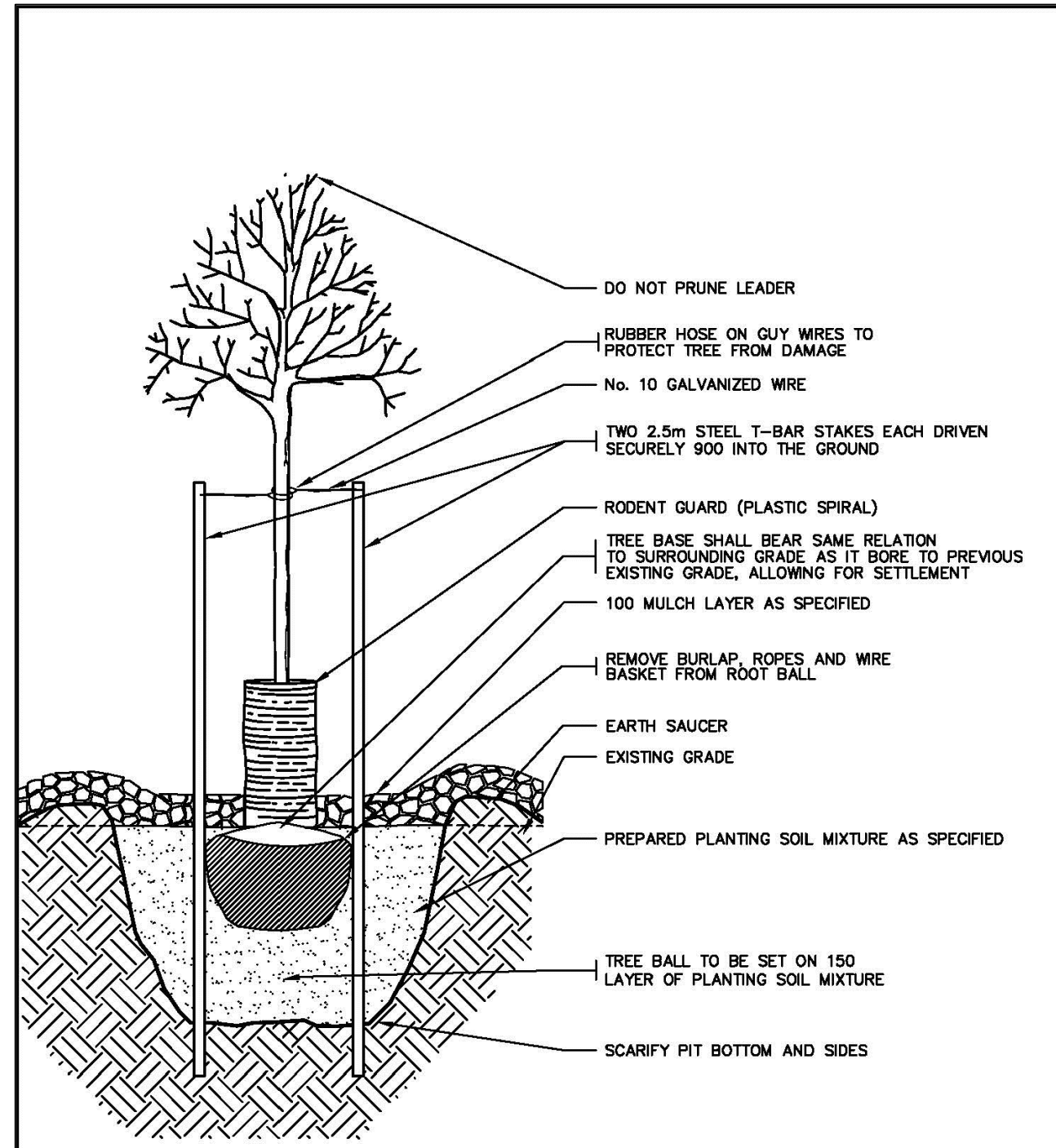

ALL DIMENSIONS IN MILLIMETERS UNLESS OTHERWISE NOTED
 THE REGIONAL MUNICIPALITY OF HALTON PUBLIC WORKS DEPARTMENT
 Date: January 2014 Rev. 1 NTS
DECIDUOUS TREE PLANTING 40mm, 50mm & 60mm CALLIPER
 REGION STANDARD RH 100.03

01 DECIDUOUS TREE PLANTING
L400

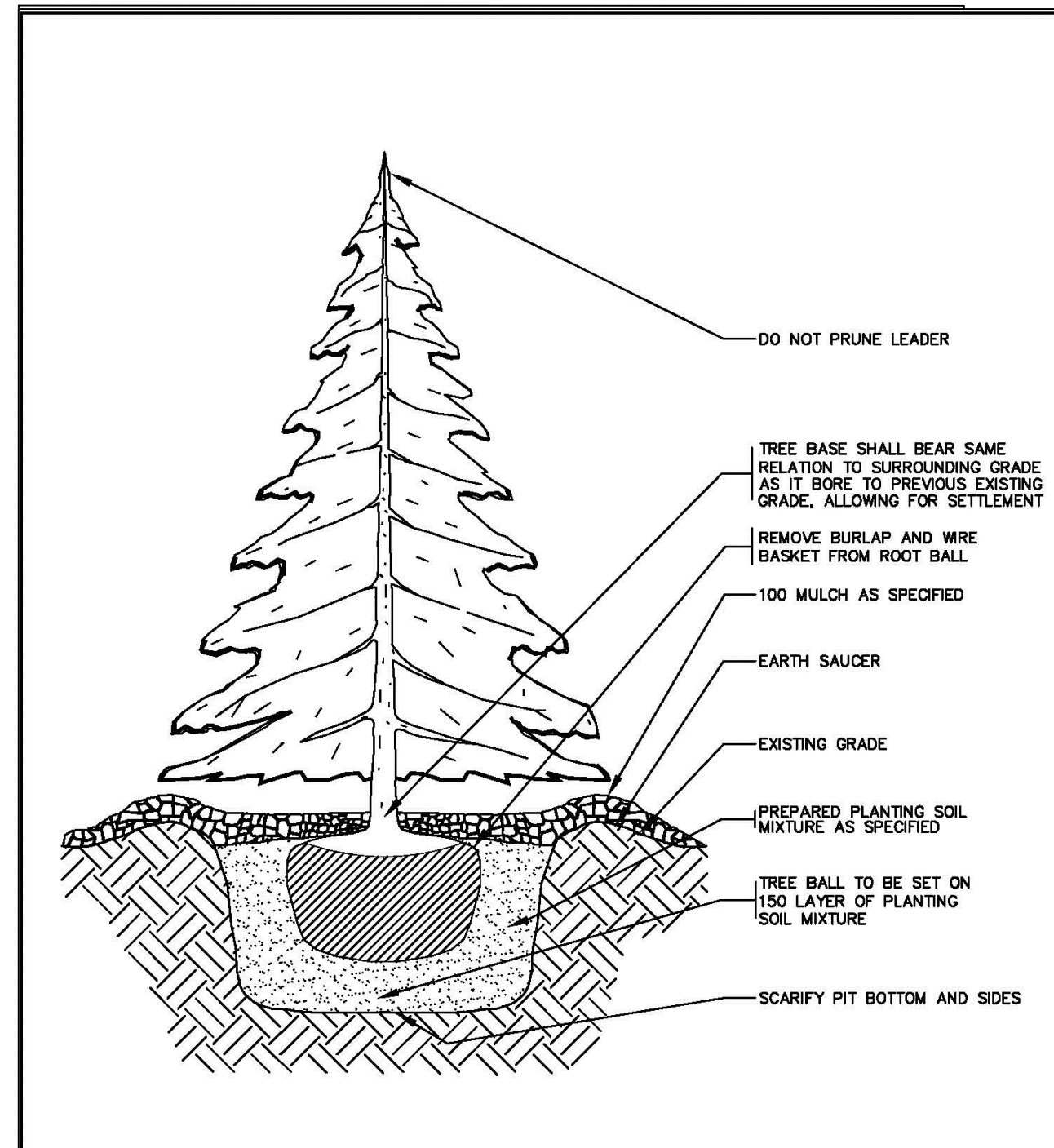

ALL DIMENSIONS IN MILLIMETERS UNLESS OTHERWISE NOTED
 THE REGIONAL MUNICIPALITY OF HALTON PUBLIC WORKS DEPARTMENT
 Date: January 2014 Rev. 1 NTS
CONIFEROUS TREE PLANTING 1.25m HEIGHT AND SMALLER
 REGION STANDARD RH 100.05

02 CONIFEROUS TREE PLANTING
L400

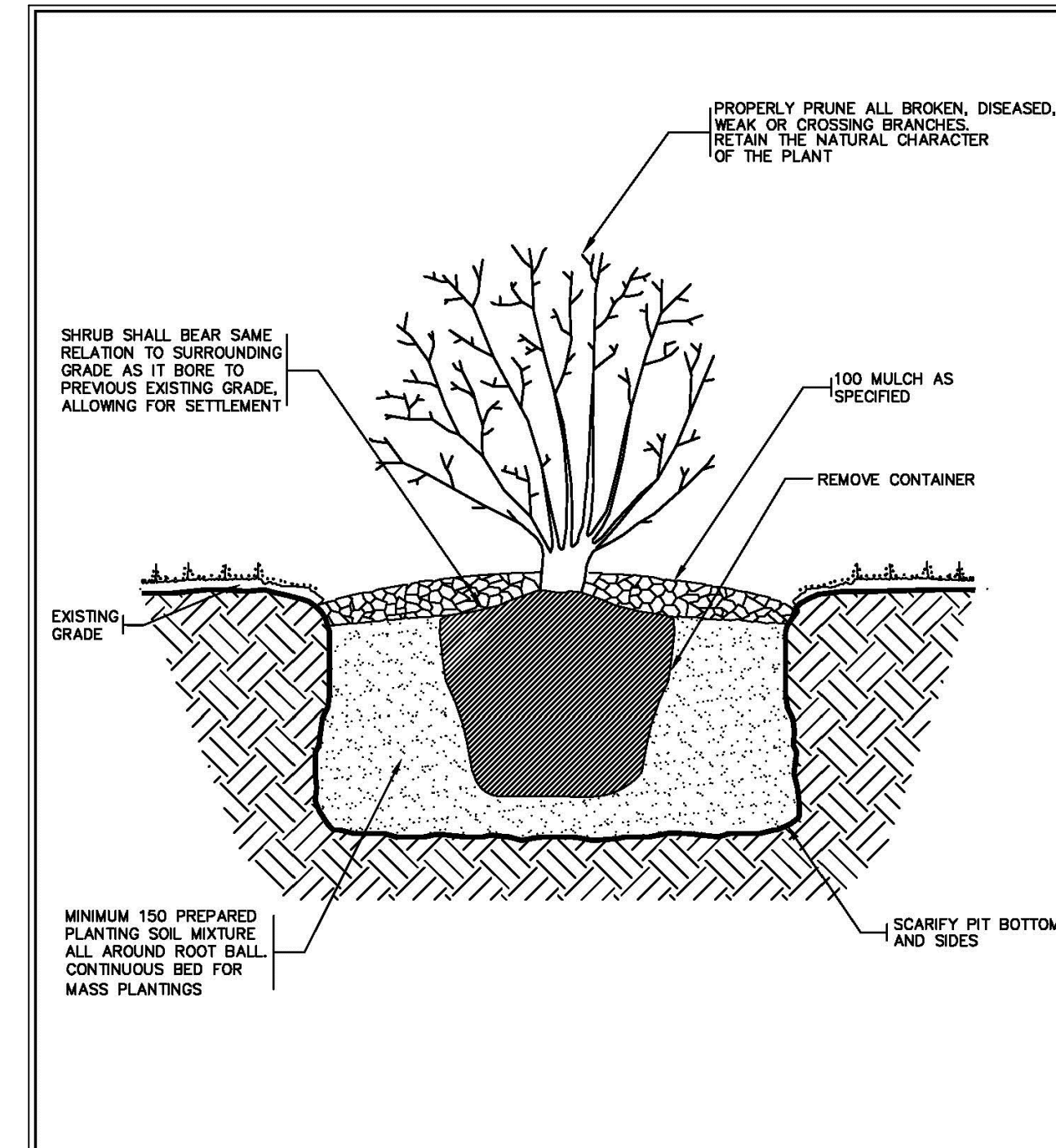

ALL DIMENSIONS IN MILLIMETERS UNLESS OTHERWISE NOTED
 THE REGIONAL MUNICIPALITY OF HALTON PUBLIC WORKS DEPARTMENT
 Date: January 2014 Rev. 1 NTS
SHRUB PLANTING POTTED
 REGION STANDARD RH 100.01

03 SHRUB PLANTING
L400

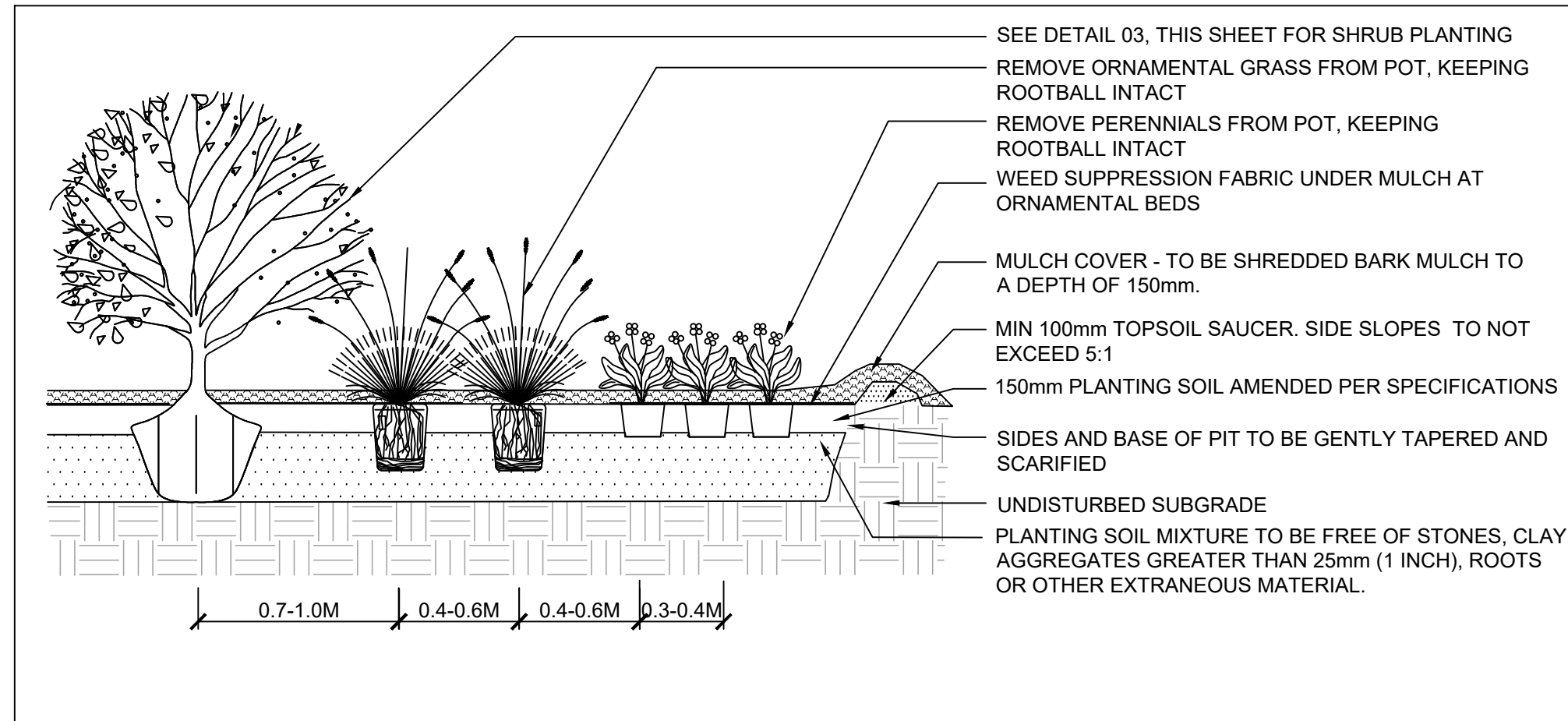

04 PERENNIAL PLANTING BED, TYP.
L400 NTS

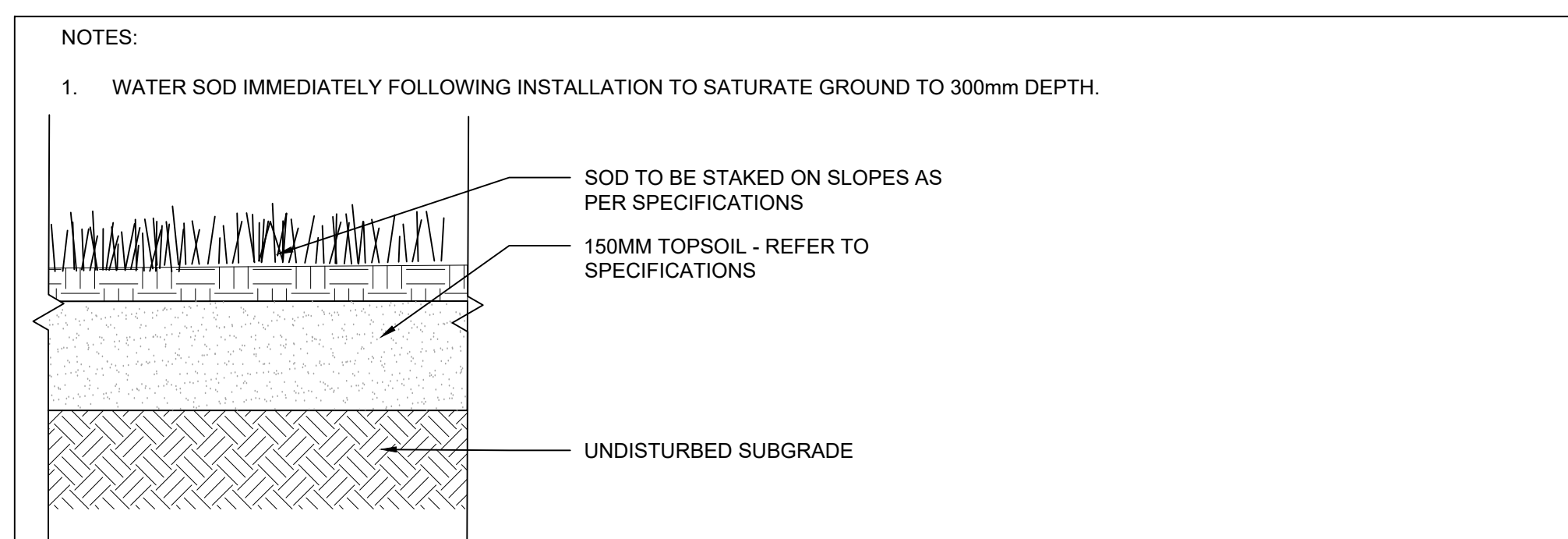

05 SOD DETAIL
L400 NTS

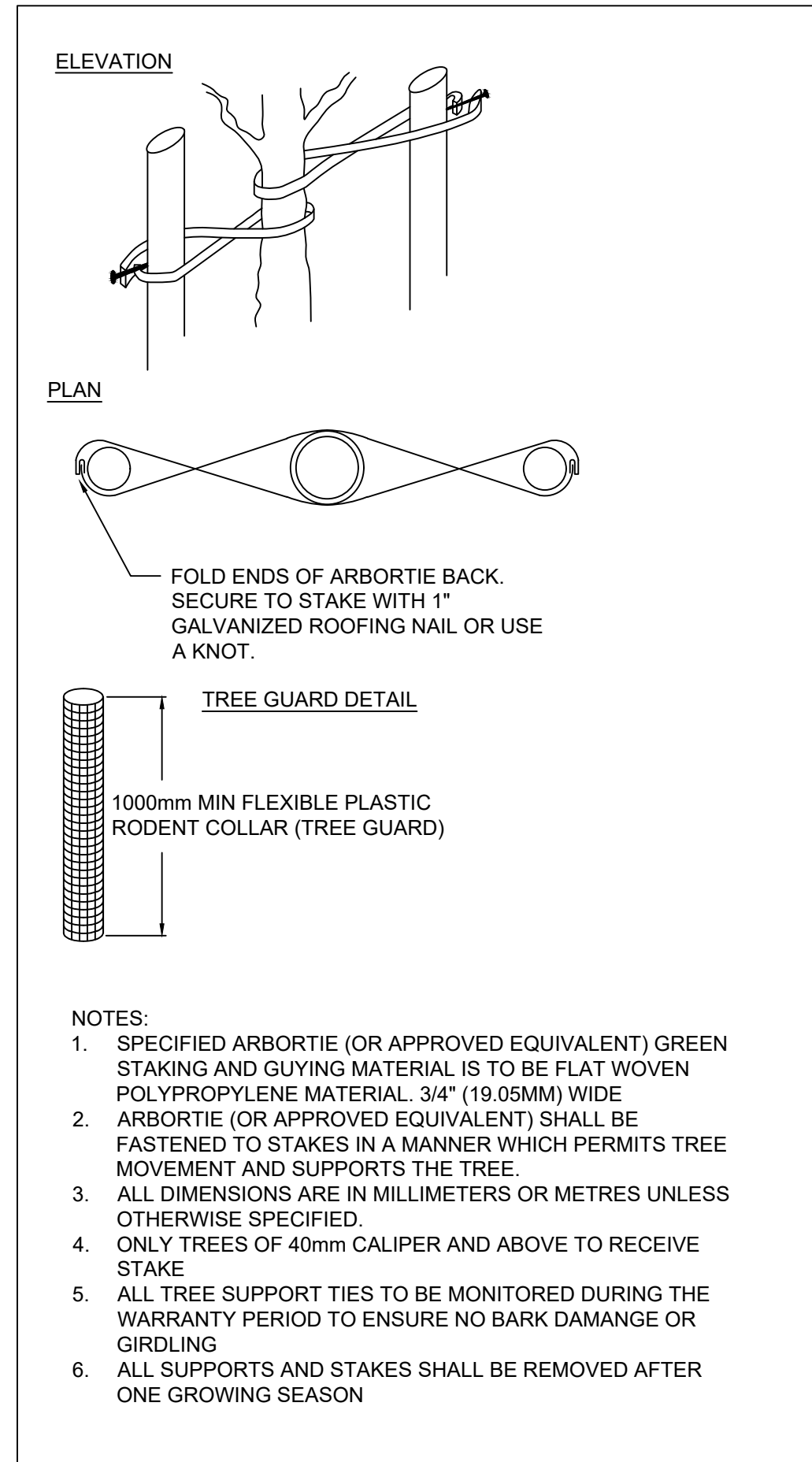

06 BIODEGRADABLE SUPPORT & STAKE, TYP.
L400 NTS

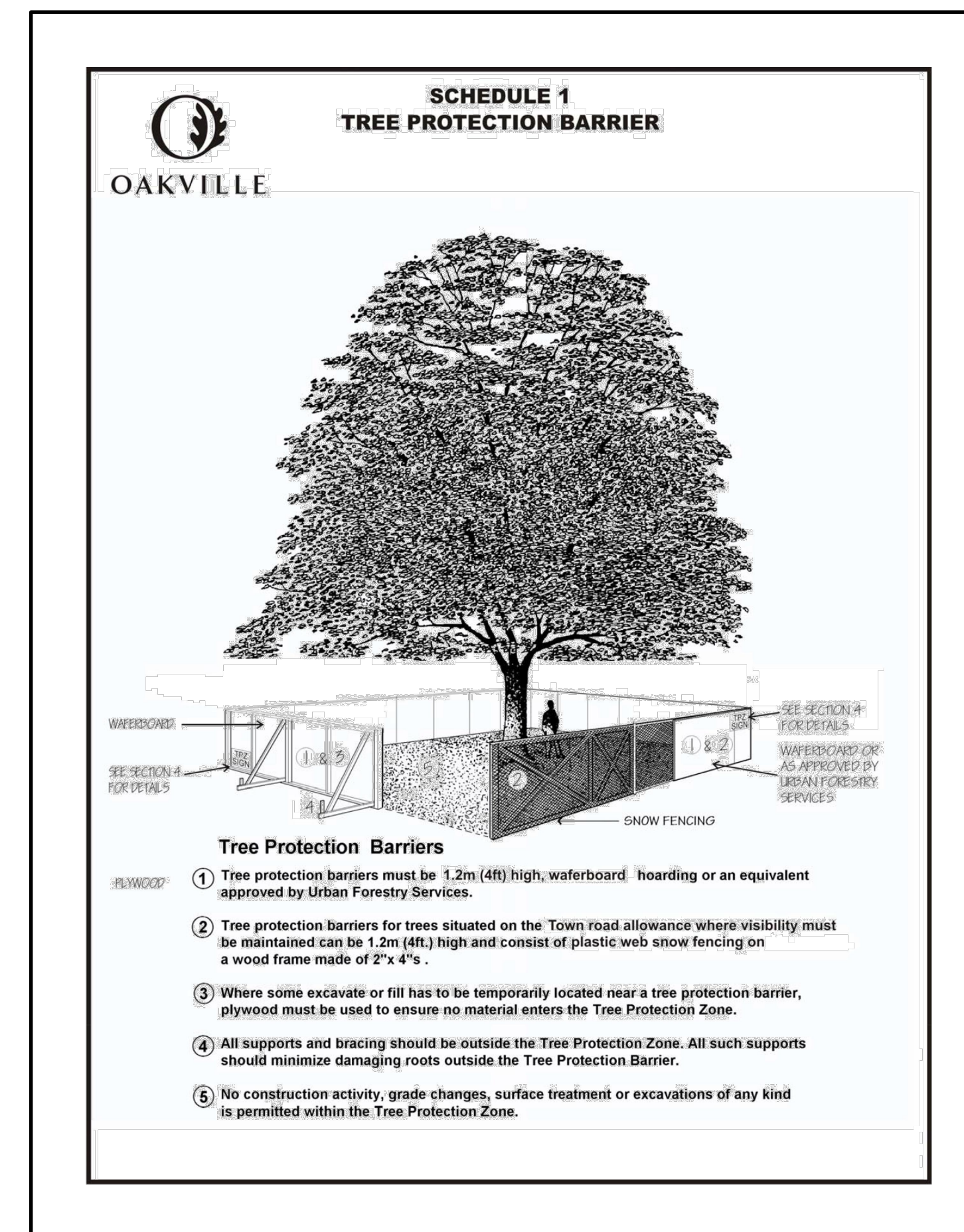

07 TREE PROTECTION FENCING, TYP.
L400 NTS



FOR PERMIT ONLY



OAKVILLE TRANSIT ELECTRIFICATION PROGRAM
 430 WYECROFT RD, OAKVILLE, ON L6K 2G7

DISCLAIMER: THIS DRAWING AND DESIGN IS COPYRIGHT PROTECTED WHICH SHALL NOT BE USED, REPRODUCED OR REVISED WITHOUT WRITTEN PERMISSION BY ARCHITECTURE AT THE CONTRACTOR SHALL CHECK AND VERIFY ALL DIMENSIONS AND UTILITY LOCATIONS AND REPORT ALL ERRORS AND OMISSIONS PRIOR TO COMMENCING WORK. THIS DRAWING IS NOT TO BE SCALED.

IS	REV	DATE	DESCRIPTION
12	0A	24-11-22	ISSUED FOR SITE PLAN APPLICATION
11	0A	24-11-19	ISSUED FOR 100% REVIEW EIC
10	0A	24-11-11	ISSUED FOR SITE PLAN REVIEW
09	0B	24-09-11	ISSUED FOR 100% REVIEW
08	0A	24-08-09	ISSUED FOR PERMIT
07	0A	24-08-07	ISSUED FOR 100% REVIEW
06	0A	24-07-12	ISSUED FOR 100% DESIGN REVIEW
05	0A	24-04-12	ISSUED FOR 60% REVIEW
04	0A	24-03-01	ISSUED FOR SITE PLAN APPLICATION

PROJECT NO: 221-04536-00
 ORIGINAL SCALE: N/A
 DATE: 2024/04/12
 DESIGNED BY: JS/BK
 DRAWN BY: BK/KL
 CHECKED BY: JS
 DISCIPLINE: LANDSCAPE
 TITLE: LANDSCAPE DETAILS
 SHEET NUMBER: L400
 SHEET #: 07 OF 08
 ISSUE #: 12
 DATE OF: NOV 22, 2024

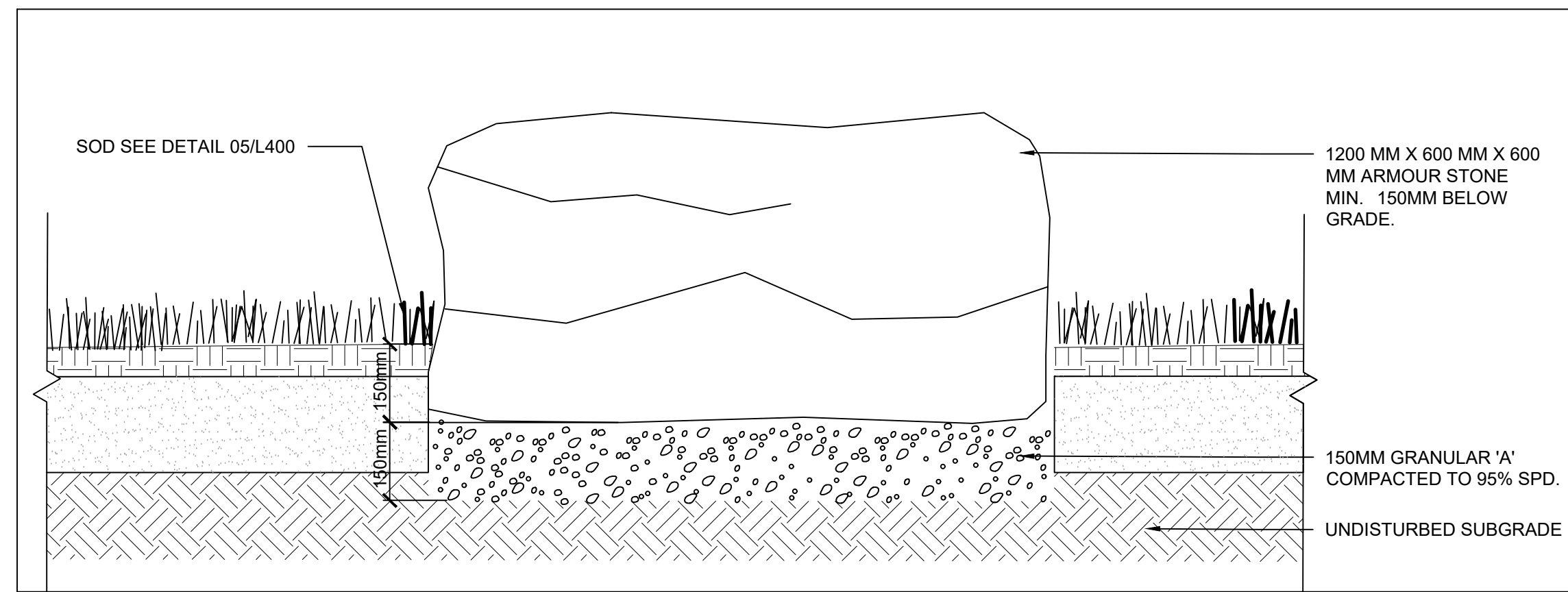

01 ARMOUR STONE ON SOD DETAIL

L401

NTS

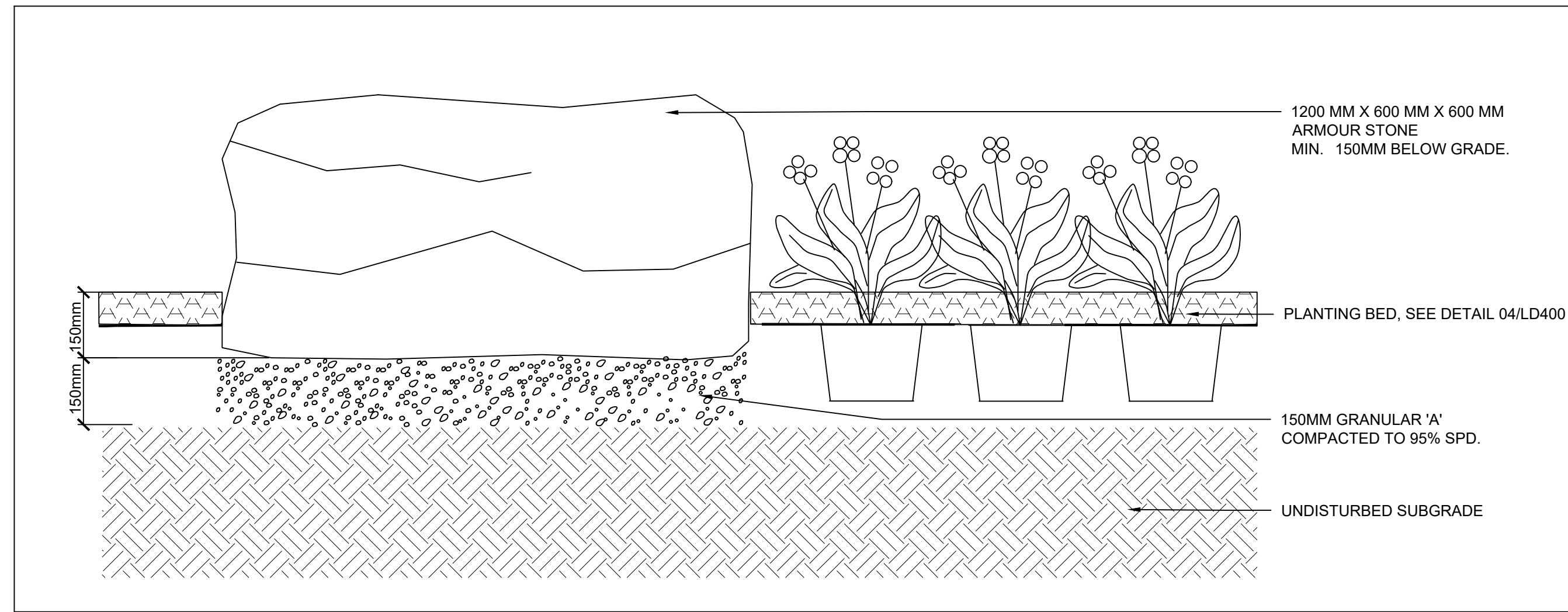

02 ARMOUR STONE ON PLANTING BED DETAIL

L401

NTS

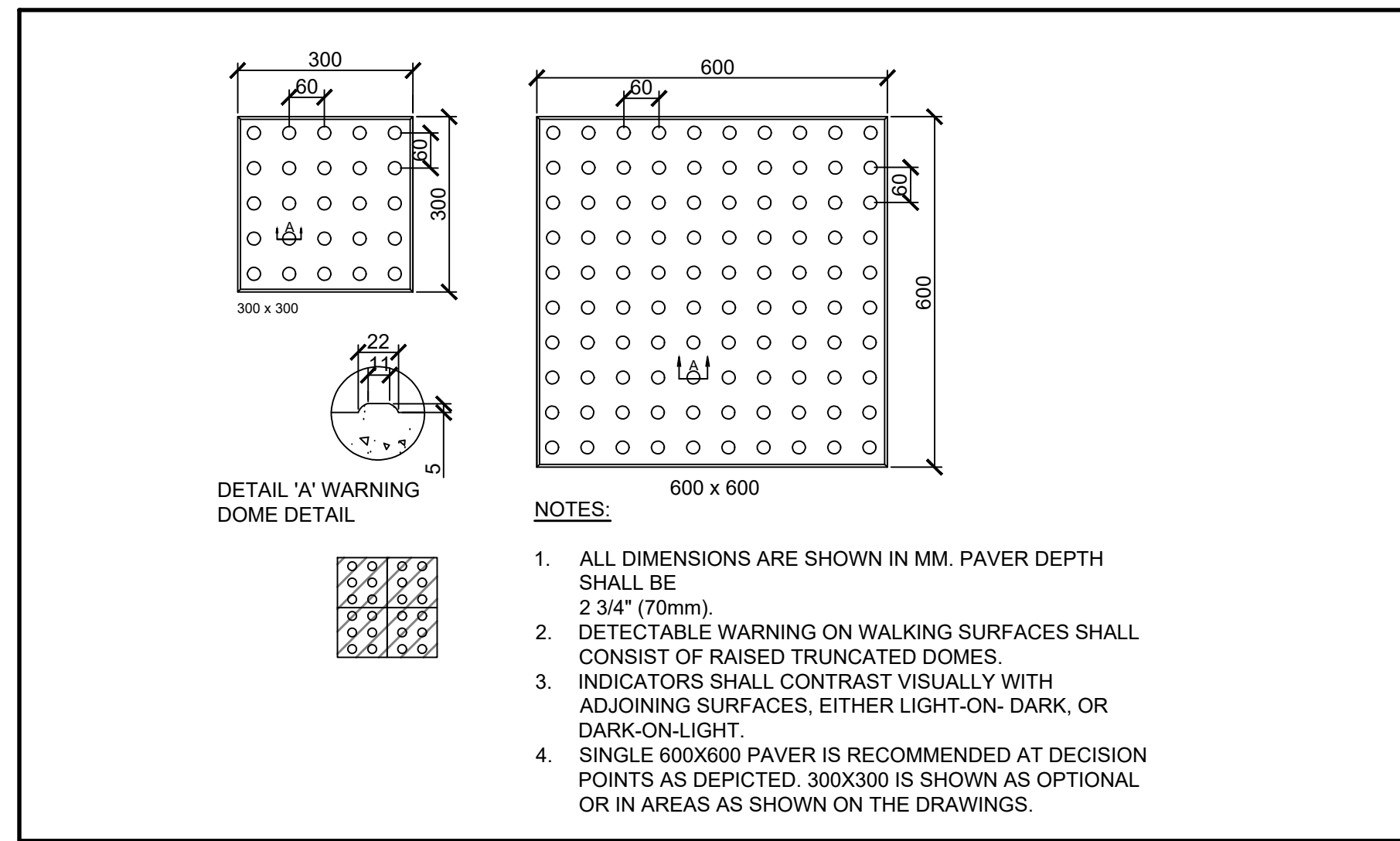

03 TACTILE PAVER

L401



A | 49



FOR PERMIT ONLY



OAKVILLE TRANSIT ELECTRIFICATION PROGRAM
430 WYECROFT RD, OAKVILLE, ON L6K 2G7

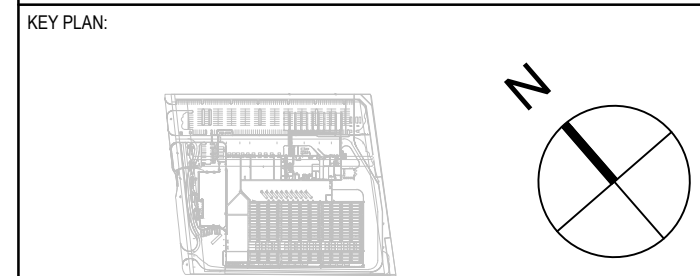

DISCLAIMER: THIS DRAWING AND DESIGN IS COPYRIGHT PROTECTED WHICH SHALL NOT BE USED, REPRODUCED OR REVISED WITHOUT WRITTEN PERMISSION BY ARCHITECTURE #4. THE CONTRACTOR SHALL CHECK AND VERIFY ALL DIMENSIONS AND UTILITY LOCATIONS AND REPORT ALL ERRORS AND OMISSIONS PRIOR TO COMMENCING WORK. THIS DRAWING IS NOT TO BE SCALED.

IS	REV	DATE	DESCRIPTION
12	0A	24-11-22	ISSUED FOR SITE PLAN APPLICATION
11	0A	24-11-19	ISSUED FOR 100% REVIEW EIC
10	0A	24-11-11	ISSUED FOR SITE PLAN REVIEW
09	0B	24-09-11	ISSUED FOR 100% REVIEW
08	0A	24-08-09	ISSUED FOR PERMIT
07	0A	24-08-07	ISSUED FOR 100% REVIEW
06	0A	24-07-12	ISSUED FOR 100% DESIGN REVIEW
05	0A	24-04-12	ISSUED FOR 60% REVIEW
04	0A	24-03-01	ISSUED FOR SITE PLAN APPLICATION

PROJECT NO: 221-04536-00 DATE: 2024/04/12

ORIGINAL SCALE: N/A

DESIGNED BY: JS/BK

DRAWN BY: BK/KL

CHECKED BY: JS

DISCIPLINE: LANDSCAPE

TITLE: LANDSCAPE DETAILS

SHEET NUMBER: L401

SHEET #: 08 OF 08

ISSUE #: 12

DATE OF: NOV 22, 2024